

RoHS COMPLIANT

ENTER DESCRIPTION IEC NO: 2012-0144 DRAWN: VITTHARAR CHKD: APPR: KPRASAD 2011/09/30 2011/10/10	QUALITY SYMBOLS ▽=0 ▽=0	GENERAL TOLERANCES (UNLESS SPECIFIED)		DIMENSION STYLE MM ONLY		SCALE 1:1	DESIGN UNITS METRIC	THIRD ANGLE PROJECTION	
		4 PLACES ± --- ± ---	mm	INCH	DRAWN BY	DATE	TITLE	CMC HEADER T3 INTERFACE - BK & BR 96/72 AND 96/96	
		3 PLACES ± --- ± ---			CHECKED BY	DATE		MOLEX INCORPORATED	
		2 PLACES ± 0.1 ± ---			APPROVED BY	DATE		MATERIAL NO. SD-36638-001	DOCUMENT NO. 1 OF 3
1 PLACE ± 0.2 ± ---			ANGULAR ± 1°		SEE TABLE		THIS DRAWING CONTAINS INFORMATION THAT IS PROPRIETARY TO MOLEX INCORPORATED AND SHOULD NOT BE USED WITHOUT WRITTEN PERMISSION		
DRAFT WHERE APPLICABLE MUST REMAIN WITHIN DIMENSIONS									

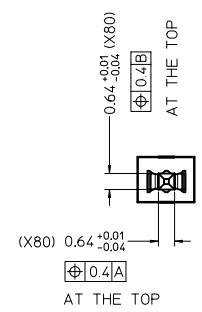

DETAIL 1
SCALE 10:1

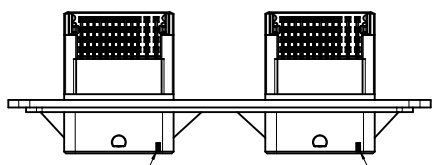
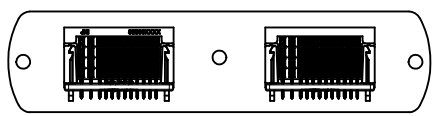
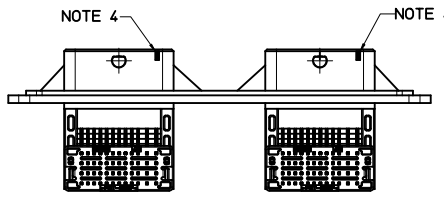
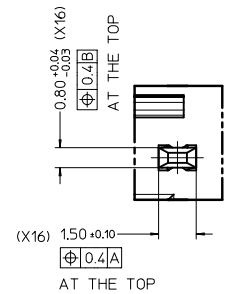

DETAIL 2
SCALE 10:1

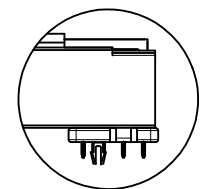

96/96 OR 96/72 MCM HEADER
WITH PCB SNAP LOCKING

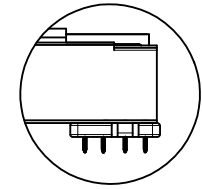

96/96 OR 96/72 MCM HEADER
WITHOUT PCB SNAP LOCKING

36638-0012	CMC HEADER, T3-BR & BN, WITH PCB SNAP LOCK, 96/96	BROWN	BLACK	L1 & M1	A1 TO H1, J1 & K1	D
36638-0011	CMC HEADER, T3-BR & BN, W/O PCB SNAP LOCK, 96/96			L2 & M2	A2 TO H2, J2 & K2	
36638-0010	CMC HEADER, T3-BR & BN, WITH PCB SNAP LOCK, 96/72	BROWN	BLACK	L3 & M3	A3 TO H3, J3 & K3	B
36638-0001	CMC HEADER, T3-BR & BN, W/O PCB SNAP LOCK, 96/72			L4 & M4	A4 TO H4, J4 & K4	
36638-0014	CMC HEADER, T3-BR & BN, W/O PCB SNAP LOCK, 96/72			L4 & M4	A4 TO H4, J4 & K4	
MOLEX PART NO.	PART DISCRPTION	LEFT MODULE	RIGHT MODULE	1.5 PIN	0.64 PIN	PCB LAYOUT TO BE REFERRED
		COLOUR CODE		CAVITIES TO BE USED		

5	GRID PLATE WITH PCB LOCK	PBT 30% GLASS FILLED	BLACK	0	2	0	2	0
4	GRID PLATE W/O PCB LOCK		BLACK	2	0	2	0	2
3	HOUSING		BLACK	1	1	1	1	1
2	PIN 1.50	CuZn30	NICKEL UNDERCOAT: 1.3µM TO 2.2µM	12	12	16	16	12
1	PIN 0.64	CuZn30	MATTE TIN OVERCOAT: 4µM TO 5µM	60	60	80	80	60
SL.NO	DESIGNATION	MATERIAL	FINISH	BOM QUANTITY				
				36638-0001	36638-0010	36638-0011	36638-0012	36638-0014

- NOTE:
1. PAINT BROWN PAINT[RoHS COMPLIANT] AT THE SPECIFIED AREA OF LEFT MODULE ON BOTH SIDES
 2. AREA FOR JXI AND MOLEX PART NUMBER REPRESENTATION.
 3. AREA FOR PLASTIC MATERIAL >PBT-30%GF< DESCRIPTION.
 4. PAINT WITH WHITE COLOR[RoHS COMPLIANT] AT SPECIFIED FOUR AREAS
 5. PART TO MEET SOLDERABILITY SPEC SMES-152
 6. PACKAGING SPECIFICATION: PK-36638-001
 7. FOR PART # 36638-0001 REFER PACKAGING SPEC:PK-36638-004

RoHS COMPLIANT

ENTER DESCRIPTION IEC NO: 2042-0144 DRAWN: VITARRAR CHKD: APPR: KPRASAD 2011/09/30 2011/10/10	QUALITY SYMBOLS	GENERAL TOLERANCES (UNLESS SPECIFIED)	DIMENSION STYLE	SCALE	DESIGN UNITS	THIRD ANGLE PROJECTION
	$\nabla=0$ $\nabla=0$	mm INCH 4 PLACES ± --- ± --- 3 PLACES ± --- ± --- 2 PLACES ± 0.1 ± --- 1 PLACE ± 0.2 ± --- ANGULAR ± 1°	MM ONLY	1:1	METRIC	
	DESCRIPTION	DRAFT WHERE APPLICABLE MUST REMAIN WITHIN DIMENSIONS	DRAWN BY: DKUMAR CHECKED BY: KPRASAD APPROVED BY: GJLOWE DATE: 20/12/2005 DATE: 20/12/2005 DATE: 20/12/2005	TITLE	CMC HEADER T3 INTERFACE - BK & BR 96/72 AND 96/96 MOLEX INCORPORATED	
			MATERIAL NO. SEE TABLE	DOCUMENT NO. SD-36638-001	SHEET NO. 2 OF 3	

THIS DRAWING CONTAINS INFORMATION THAT IS PROPRIETARY TO MOLEX INCORPORATED AND SHOULD NOT BE USED WITHOUT WRITTEN PERMISSION

PCB LAYOUT: A

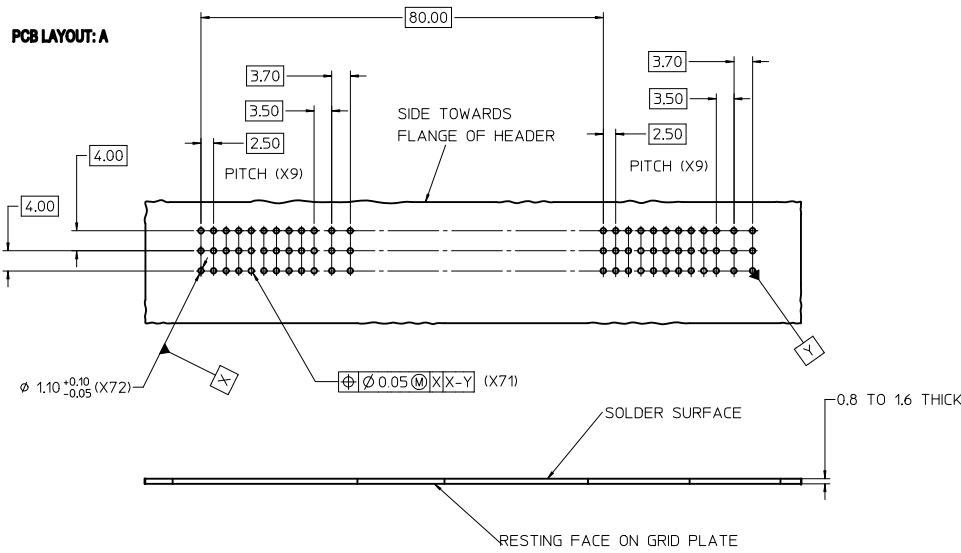

PCB LAYOUT: B

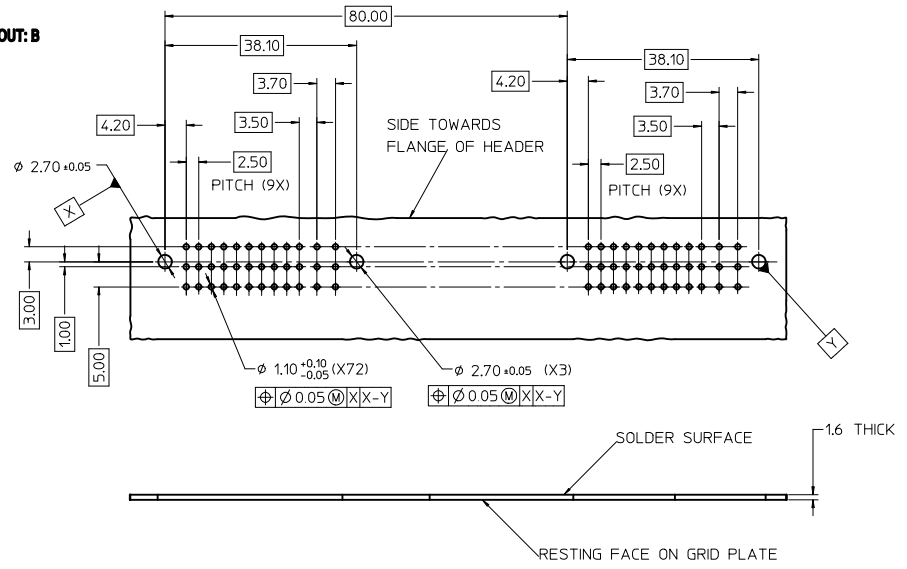

PCB LAYOUT: C

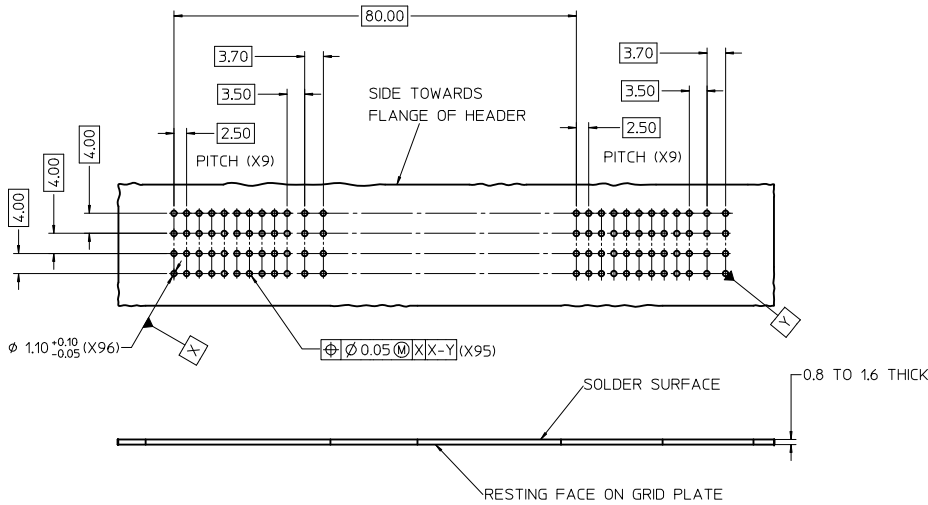

PCB LAYOUT: D

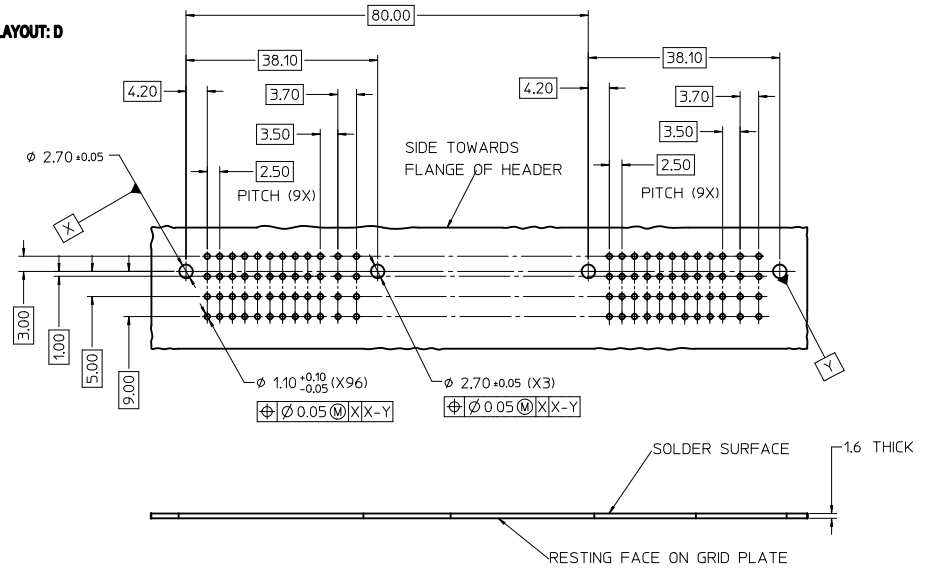

RoHS COMPLIANT

ENTER DESCRIPTION EC NO: 2012-044 DRN:VITARRAR 2011/09/30 CHKD: APPR:KPRASAD 2011/10/10	QUALITY SYMBOLS ▽=0 ▽=0	GENERAL TOLERANCES (UNLESS SPECIFIED) mm INCH 4 PLACES ± --- ± --- 3 PLACES ± --- ± --- 2 PLACES ± 0.1 ± --- 1 PLACE ± 0.2 ± --- ANGULAR ± 1 °	DIMENSION STYLE MM ONLY	SCALE 2:1	DESIGN UNITS METRIC	THIRD ANGLE PROJECTION
	DRAWN BY DKUMAR	DATE 20/12/2005	CHECKED BY KPRASAD	DATE 20/12/2005	TITLE CMC HEADER T3 INTERFACE - BK & BR 96/72 AND 96/96	
	APPROVED BY GJLOWE	DATE 20/12/2005	MATERIAL NO. SEE TABLE		DOCUMENT NO. SD-36638-001	
	DRAFT WHERE APPLICABLE MUST REMAIN WITHIN DIMENSIONS					

SHEET NO.
3 OF 3

MOLEX INCORPORATED
SD-36638-001

THIS DRAWING CONTAINS INFORMATION THAT IS PROPRIETARY TO MOLEX INCORPORATED AND SHOULD NOT BE USED WITHOUT WRITTEN PERMISSION

Данный компонент на территории Российской Федерации

Вы можете приобрести в компании MosChip.

Для оперативного оформления запроса Вам необходимо перейти по данной ссылке:

<http://moschip.ru/get-element>

Вы можете разместить у нас заказ для любого Вашего проекта, будь то серийное производство или разработка единичного прибора.

В нашем ассортименте представлены ведущие мировые производители активных и пассивных электронных компонентов.

Нашей специализацией является поставка электронной компонентной базы двойного назначения, продукции таких производителей как XILINX, Intel (ex.ALTERA), Vicor, Microchip, Texas Instruments, Analog Devices, Mini-Circuits, Amphenol, Glenair.

Сотрудничество с глобальными дистрибьюторами электронных компонентов, предоставляет возможность заказывать и получать с международных складов практически любой перечень компонентов в оптимальные для Вас сроки.

На всех этапах разработки и производства наши партнеры могут получить квалифицированную поддержку опытных инженеров.

Система менеджмента качества компании отвечает требованиям в соответствии с ГОСТ Р ИСО 9001, ГОСТ РВ 0015-002 и ЭС РД 009

Офис по работе с юридическими лицами:

105318, г.Москва, ул.Щербаковская д.3, офис 1107, 1118, ДЦ «Щербаковский»

Телефон: +7 495 668-12-70 (многоканальный)

Факс: +7 495 668-12-70 (доб.304)

E-mail: info@moschip.ru

Skype отдела продаж:

moschip.ru

moschip.ru_4

moschip.ru_6

moschip.ru_9