

Basic Version of Ribbon Connectors Solder Type

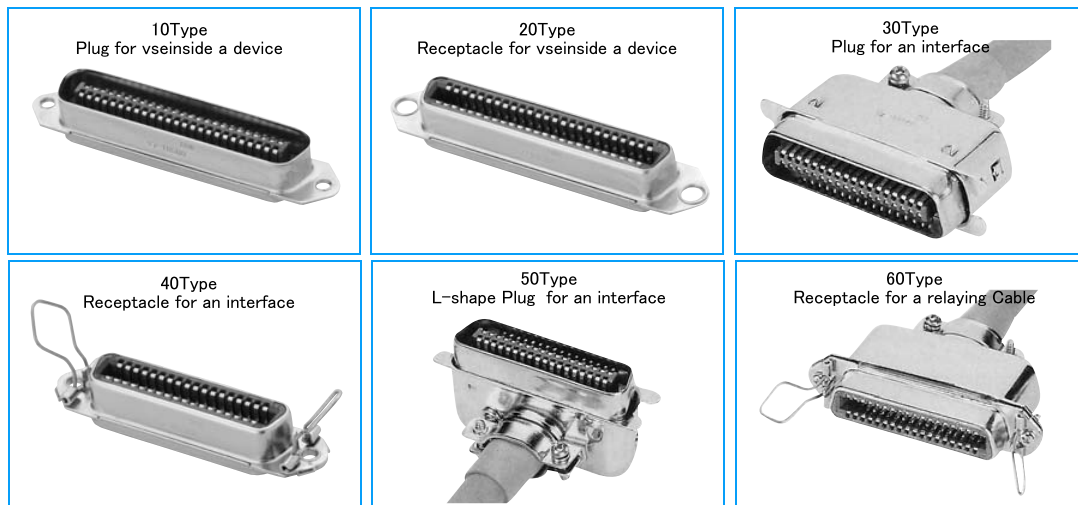

FEATURE

- 57 Series are the one that is basic of 57 family Connector. and have six type of the following
 - 57-10Type(Rack and Panel Plug)
 - 57-20Type(Rack and Panel Receptacle)
 - 57-30Type(Cable to Panel Plug)
 - 57-40Type(Panel Receptacle with Spring latches)
 - 57-50Type(L-shape Plug for an Interface)
 - 57-60Type(Cable to Cable Receptacle)

SPECIFICATION

| | |
|---------------------------------|---|
| Voltage Rating | 500V AC (r.m.s.) |
| Current Rating | 5A/Contact |
| Dielectric withstanding voltage | 1,200V AC (r.m.s.) for 1 minute |
| Contact Resistance | DC5Aで5mΩ max. |
| Insulation Resistance | 1,000MΩ min. at 500V DC |
| Operational temperature | -55°C to +105°C |
| Wire Accommodation | AWG#22 max. (Solid wire) AWG#24 max. (Standard wire) |

MATERIAL/FINISH

| P/N | MATERIAL/FINISH |
|-------------|--|
| Insulator | Diallyl phthalate resin (UL94V-0)/Blue |
| Contact | Copper alloy/Gold Plating |
| Shell | Brass/Nickel plating |
| Front Shell | Brass/Nickel Plating (20Type Application) |
| Boots | Vinyl Chloride(30, 50, 60Type Application) |

10Type : Rack and Panel Plug

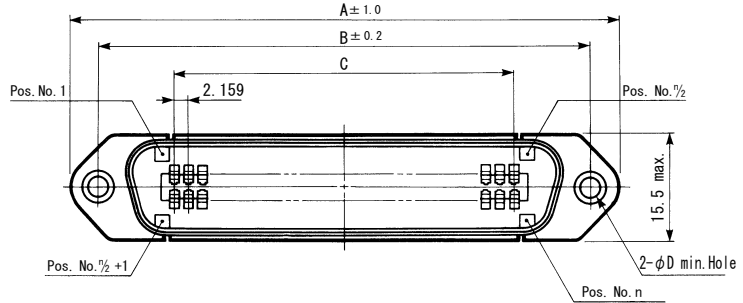

Solder cup type

Dip solder

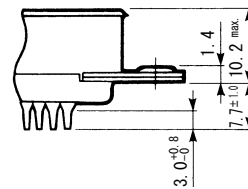
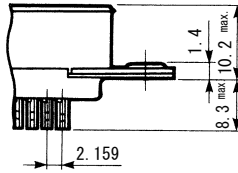
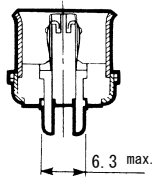

| No. of Contacts | Solder cup type | Dip solder | Size | | | |
|-----------------|-----------------|-------------|------|-------|--------|------|
| | | | A | B | C | D |
| 14 | 57-10140 | 57-10140-4 | 43.9 | 36.00 | 12.954 | 3.05 |
| 24 | 57-10240 | 57-10240-3 | 54.7 | 46.78 | 23.749 | 3.05 |
| 36 | 57-10360 | 57-10360-13 | 67.7 | 59.74 | 36.703 | 3.05 |
| 50 | 57-10500 | 57-10500-27 | 82.8 | 74.85 | 51.816 | 3.05 |

Panel Cut-Out Dimensions

Connector Front mount Type

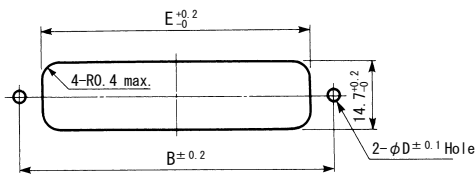

| No. of Contacts | B | D | E |
|-----------------|-------|-----|------|
| 14 | 36.00 | 3.3 | 23.9 |
| 24 | 46.78 | 3.3 | 34.7 |
| 36 | 59.74 | 3.3 | 47.7 |
| 50 | 74.85 | 3.3 | 62.8 |

PCB Mounting Dimensions

(PCB thickness : 1.6mm)

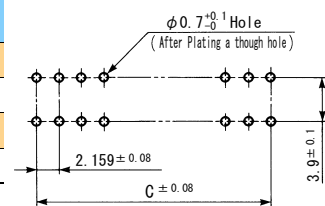

Connector Rear mount Type

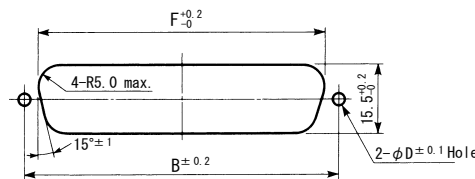

| No. of Contacts | B | D | F |
|-----------------|-------|-----|------|
| 14 | 36.00 | 3.2 | 29.3 |
| 24 | 46.78 | 3.2 | 40.1 |
| 36 | 59.74 | 3.2 | 53.0 |
| 50 | 74.85 | 3.2 | 68.2 |

| No. of Contacts | C |
|-----------------|--------|
| 14 | 12.954 |
| 24 | 23.749 |
| 36 | 36.703 |
| 50 | 51.816 |

Note : The Dimension is 16.2 Max. When Mating with 57FE-10Type Connector

20Type : Rack and Panel Receptacle

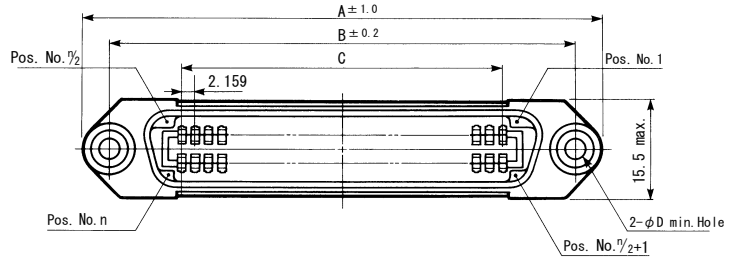

Solder cup type

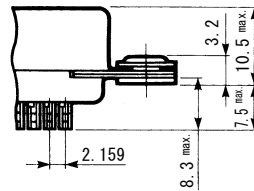
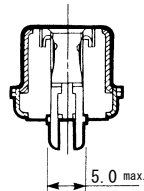

Dip solder

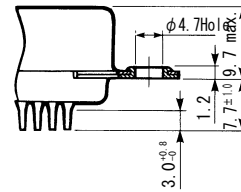

| No. of Contacts | Solder cup type | Dip solder | Size | | | |
|-----------------|-----------------|-------------|------|-------|--------|------|
| | | | A | B | C | D |
| 14 | 57-20140 | 57-20140-8 | 43.9 | 36.00 | 12.954 | 3.05 |
| 24 | 57-20240 | 57-20240-8 | 54.7 | 46.78 | 23.749 | 3.05 |
| 36 | 57-20360 | 57-20360-9 | 67.7 | 59.74 | 36.703 | 3.05 |
| 50 | 57-20500 | 57-20500-31 | 82.8 | 74.85 | 51.816 | 3.05 |

Panel Cut-Out Dimensions

● Connector Front mount Type

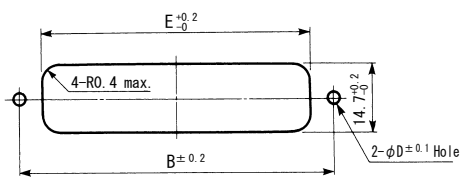

| No. of Contacts | B | D | E |
|-----------------|-------|-----|------|
| 14 | 36.00 | 3.3 | 25.3 |
| 24 | 46.78 | 3.3 | 36.1 |
| 36 | 59.74 | 3.3 | 49.1 |
| 50 | 74.85 | 3.3 | 64.1 |

PCB Mounting Dimensions (PCB thickness : 1.6mm)

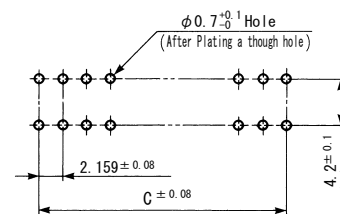

● Connector Rear mount Type

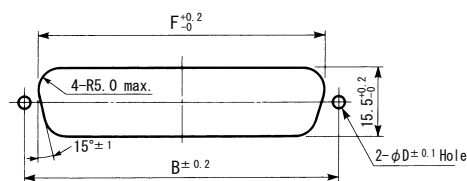

| No. of Contacts | B | D | F |
|-----------------|-------|-----|------|
| 14 | 36.00 | 3.2 | 29.3 |
| 24 | 46.78 | 3.2 | 40.1 |
| 36 | 59.74 | 3.2 | 53.0 |
| 50 | 74.85 | 3.2 | 68.2 |

| No. of Contacts | C |
|-----------------|--------|
| 14 | 12.954 |
| 24 | 23.749 |
| 36 | 36.703 |
| 50 | 51.816 |

Note : The Dimension is 16.2 Max. When Mating with 57FE-10Type Connector

GP-1B Connecters-Receptacle

57-20240-D35-CG

NO.OF.CONTACTS
24, 36, 50

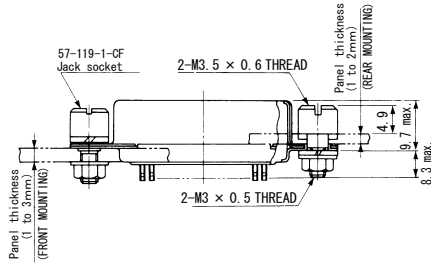
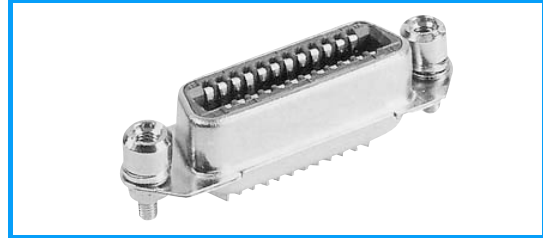

■ Panel Cut-Out Dimensions

● Connector Front mount Type

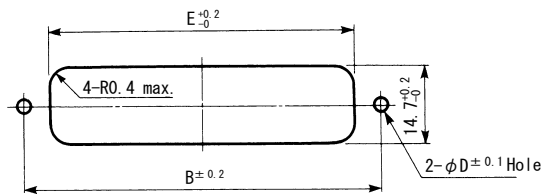

| No. of Contacts | B | D | E |
|-----------------|-------|-----|------|
| 24 | 46.78 | 4.8 | 36.1 |
| 36 | 59.74 | 4.8 | 49.1 |
| 50 | 74.85 | 4.8 | 64.1 |

● Connector Rear mount Type

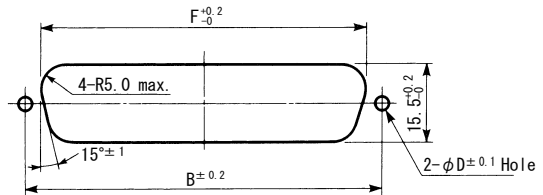

| No. of Contacts | B | D | F |
|-----------------|-------|-----|------|
| 24 | 46.78 | 4.8 | 40.1 |
| 36 | 59.74 | 4.8 | 53.0 |
| 50 | 74.85 | 4.8 | 68.2 |

Note : The Dimension is 16.2 Max. When Mating with 57FE-10Type Connector

57 Series

Unit : mm

30Type : Cable Hood to Straight Plug

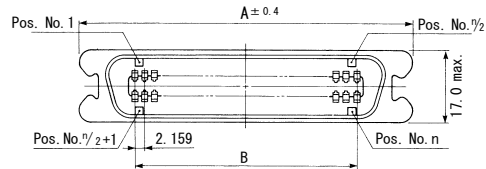
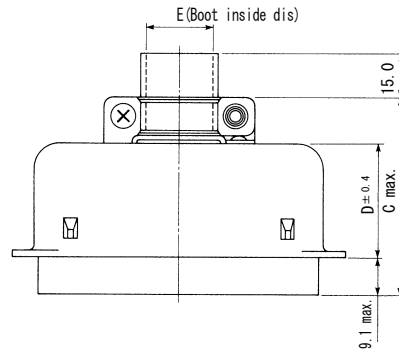
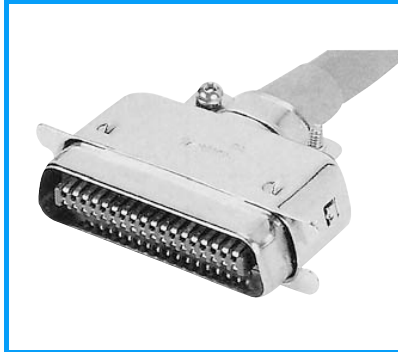

| No. of Contacts | Solder cup type | Size | | | | |
|-----------------|-----------------|------|--------|------|------|------------|
| | | A | B | C | D | E |
| 14 | 57-30140 | 37.8 | 12.954 | 41.4 | 21.4 | 6.5 × 9.8 |
| 24 | 57-30240 | 48.6 | 23.749 | 41.0 | 21.0 | 11.1 × 9.8 |
| 36 | 57-30360 | 61.6 | 36.703 | 43.0 | 23.0 | 13.9 × 9.8 |
| 50 | 57-30500 | 76.7 | 51.816 | 45.4 | 25.4 | 17.0 × 9.8 |

Cable to Panel-Screw Lock Type Plug

57-30240-D76

NO.OF.CONTACTS
14, 24, 36, 50

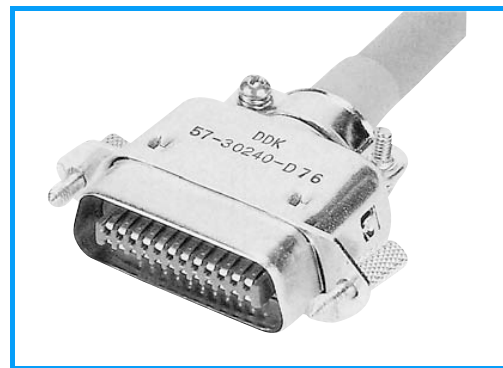
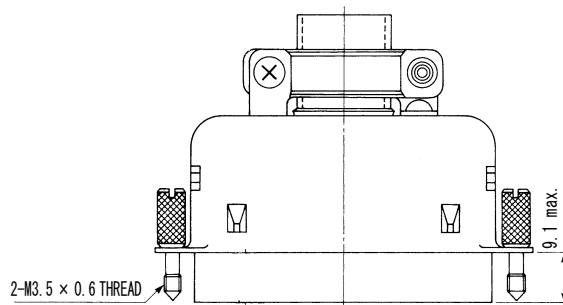

M

57

40Type : Panel Receptacle with Spring latches

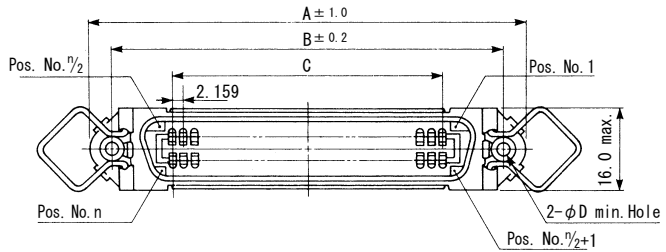

Solder cup type

Dip solder

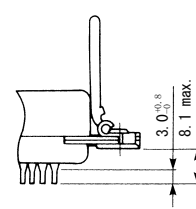
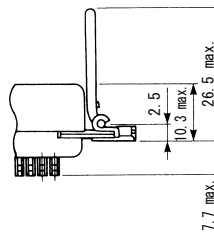

| No. of Contacts | Solder cup type | Dip solder | Size | | | |
|-----------------|-----------------|-------------|------|-------|--------|------|
| | | | A | B | C | D |
| 14 | 57-40140 | 57-40140-8 | 43.9 | 36.00 | 12.954 | 3.05 |
| 24 | 57-40240 | 57-40240-9 | 54.7 | 46.78 | 23.749 | 3.05 |
| 36 | 57-40360 | 57-40360-12 | 67.7 | 59.74 | 36.703 | 3.05 |
| 50 | 57-40500 | 57-40500-9 | 82.8 | 74.85 | 51.816 | 3.05 |

Panel Cut-Out Dimensions

Connector Front mount Type

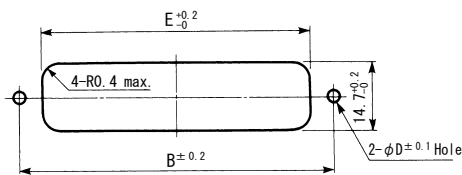

| No. of Contacts | B | D | E |
|-----------------|-------|-----|------|
| 14 | 36.00 | 3.3 | 23.9 |
| 24 | 46.78 | 3.3 | 34.7 |
| 36 | 59.74 | 3.3 | 47.7 |
| 50 | 74.85 | 3.3 | 62.8 |

PCB Mounting Dimensions

(PCB thickness :1.6mm)

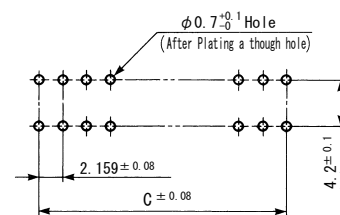

Connector Rear mount Type

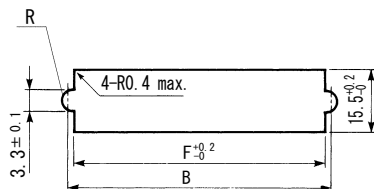

| No. of Contacts | B | F |
|-----------------|-------|-------|
| 14 | 36.00 | 35.30 |
| 24 | 46.78 | 46.08 |
| 36 | 59.74 | 59.04 |
| 50 | 74.85 | 74.15 |

| No. of Contacts | C |
|-----------------|--------|
| 14 | 12.954 |
| 24 | 23.749 |
| 36 | 36.703 |
| 50 | 51.816 |

Thickness=1.6mm max.

Unit : mm

SMT Type Ptacle

57-40500-D39-3F

NO.OF.CONTACTS
14, 24, 36, 50

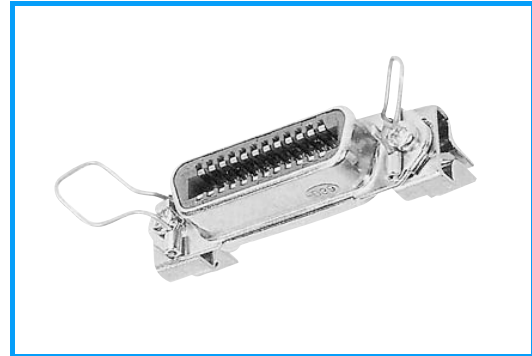
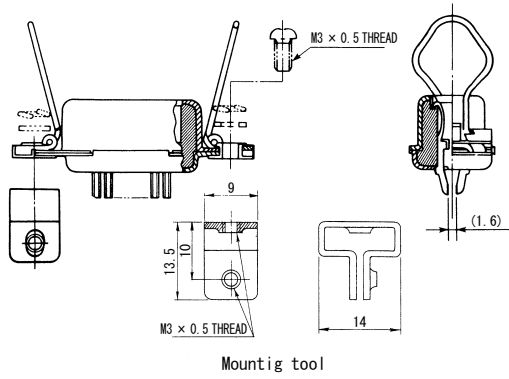

■ Panel Cut-Out Dimensions

● Connector Rear mount Type

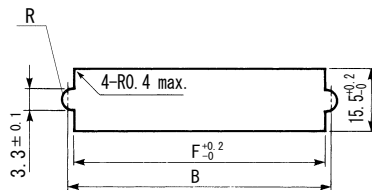

| No. of Contacts | B | F |
|-----------------|-------|-------|
| 14 | 36.00 | 35.30 |
| 24 | 46.78 | 46.08 |
| 36 | 59.74 | 59.04 |
| 50 | 74.85 | 74.15 |

Thickness=1.6mm max.

■ P.C.B. Mounting Dimensions (PCB thickness : 1.6mm)

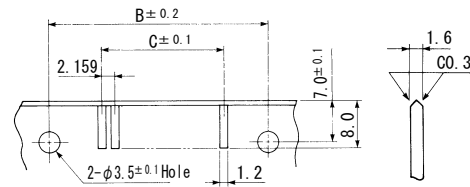

| No. of Contacts | B | C |
|-----------------|-------|--------|
| 14 | 36.00 | 12.954 |
| 24 | 46.78 | 23.749 |
| 36 | 59.74 | 36.703 |
| 50 | 74.85 | 51.816 |

90° Bent Spring Latch

57-40140-D87

NO.OF.CONTACTS
14, 24, 36, 50

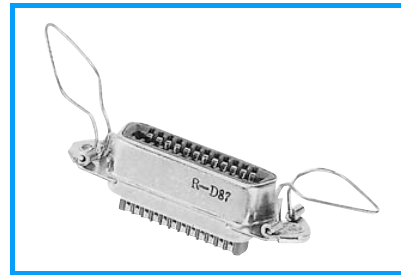
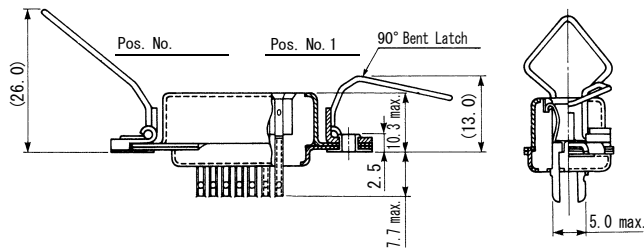

■ Panel Cut-Out Dimensions

● Connector Front mount Type

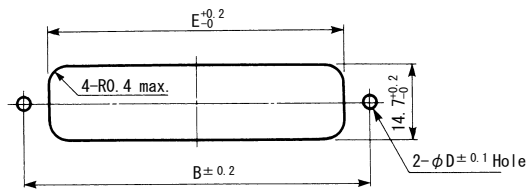

| No. of Contacts | B | D | E |
|-----------------|-------|-----|------|
| 14 | 36.00 | 3.3 | 23.9 |
| 24 | 46.78 | 3.3 | 34.7 |
| 36 | 59.74 | 3.3 | 47.7 |
| 50 | 74.85 | 3.3 | 62.8 |

● Connector Rear mount Type

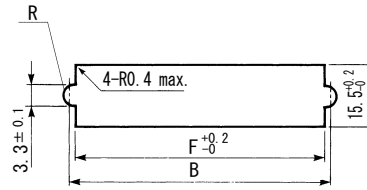

| No. of Contacts | B | F |
|-----------------|-------|-------|
| 14 | 36.00 | 35.30 |
| 24 | 46.78 | 46.08 |
| 36 | 59.74 | 59.04 |
| 50 | 74.85 | 74.15 |

Thickness=1.6mm max.

57 Series

Unit : mm

50Type : Cable to Panel Plug

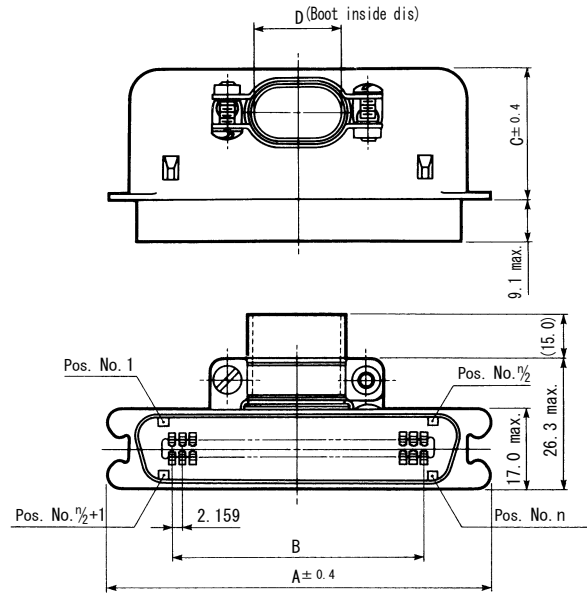
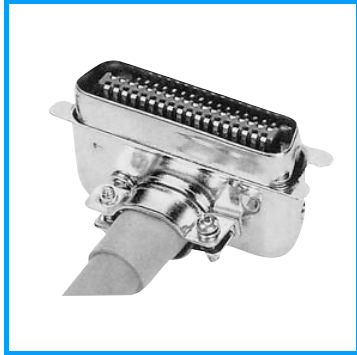

| No. of Contacts | Solder cup type | Size | | | |
|-----------------|-----------------|------|--------|------|-------------------|
| | | A | B | C | D |
| 14 | 57-50140 | 37.8 | 12.954 | 21.4 | 8.8 × 6.0 (Oval) |
| 24 | 57-50240 | 48.6 | 23.749 | 21.0 | φ 9.8 |
| 36 | 57-50360 | 61.6 | 36.703 | 23.0 | 13.9 × 9.8 (Oval) |
| 50 | 57-50500 | 76.7 | 51.816 | 25.4 | 17.0 × 9.8 (Oval) |

Unit : mm

■ 60Type : Cable to Cable Receptacles

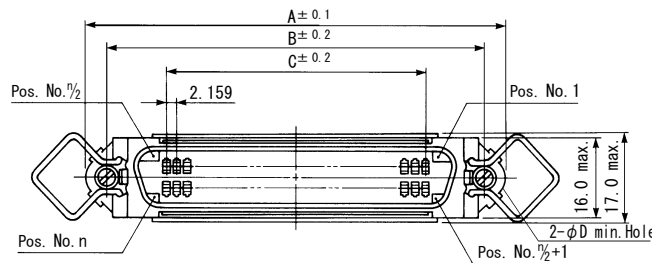
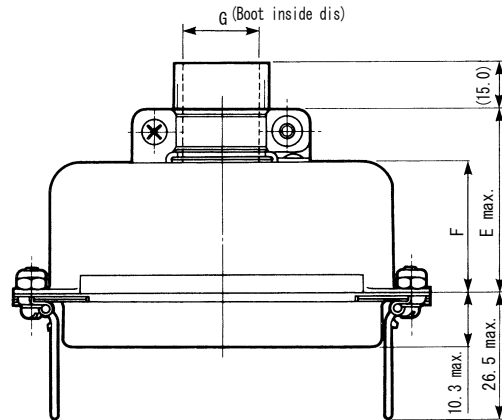
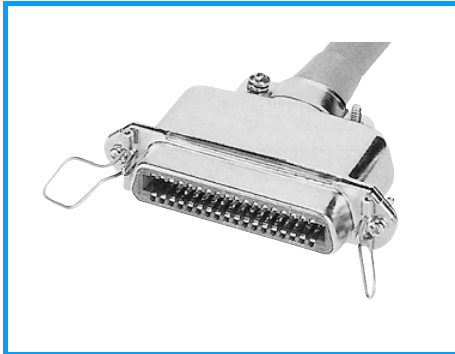

| No. of Contacts | Solder cup type | Size | | | | | | |
|-----------------|-----------------|------|-------|--------|------|------|------|-------------------|
| | | A | B | C | D | E | F | G |
| 14 | 57-60140 | 43.9 | 36.00 | 12.954 | 3.05 | 32.5 | 21.4 | 8.8 × 6.0 (Oval) |
| 24 | 57-60240 | 54.7 | 46.78 | 23.749 | 3.05 | 32.1 | 21.0 | φ 9.8 |
| 36 | 57-60360 | 67.7 | 59.74 | 36.703 | 3.05 | 34.1 | 23.0 | 13.9 × 9.8 (Oval) |
| 50 | 57-60500 | 82.8 | 74.85 | 51.816 | 3.05 | 36.5 | 25.4 | 17.0 × 9.8 (Oval) |

57 Series

Unit : mm

■ Dust Cap

Material : Polyethylene resin

Plug : Blue

Receptacle : Red

Plug(10, 30, 50Type)

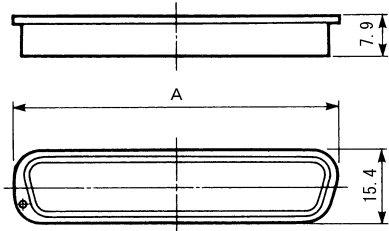

| No.of Contacts | P/N | A |
|----------------|--------|------|
| 14 | 57-14P | 29.6 |
| 24 | 57-24P | 40.4 |
| 36 | 57-36P | 53.2 |
| 50 | 57-50P | 58.6 |

Receptacles(20, 40, 60Type)

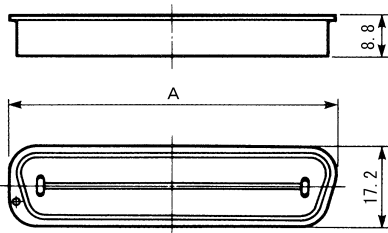

| No.of Contacts | P/N | A |
|----------------|--------|------|
| 14 | 57-14S | 30.0 |
| 24 | 57-24S | 42.0 |
| 36 | 57-36S | 53.8 |
| 50 | 57-50S | 69.0 |

Mated Dimensions-Rack and Panel Connectors

57-10 Type, 57-20 Type

The distance between panels which mounted 57-10 type (plug) and 57-20 type (receptacle) are different depend on the mounting position. Each panel distances are as follows.

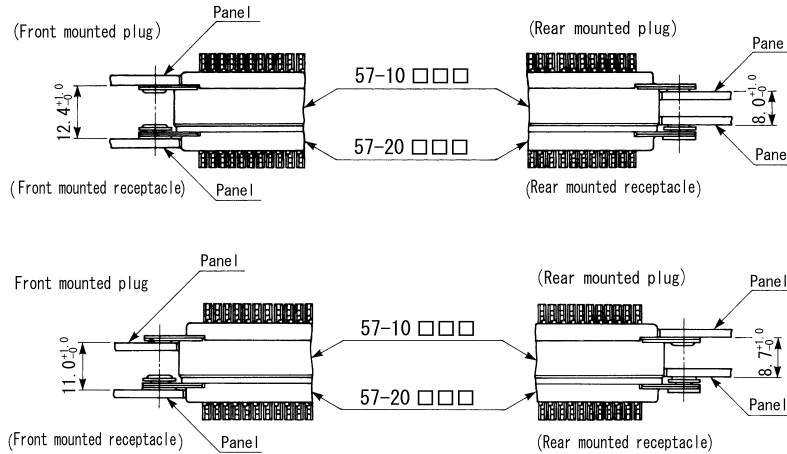

57-30Type, 57-40Type (Top Cable entry)

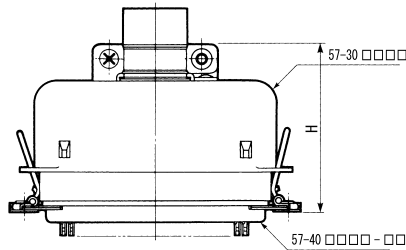

| No. of Contacts | H |
|-----------------|------|
| 14 | 42.5 |
| 24 | 42.0 |
| 36 | 44.0 |
| 50 | 46.7 |

57-40Type, 57-50Type (Side Cable entry)

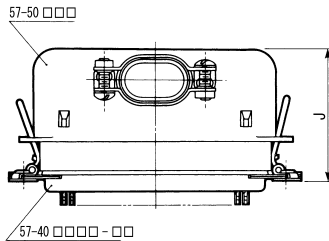

| No. of Contacts | J |
|-----------------|------|
| 14 | 32.5 |
| 24 | 32.0 |
| 36 | 34.0 |
| 50 | 36.5 |

57-30Type, 57-60Type (Mated dimensions)

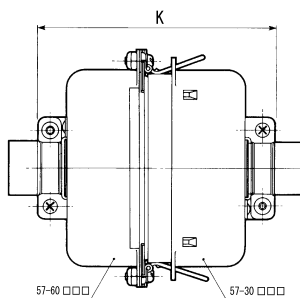

| Receptacle | | | Plug |
|------------|-----------------|------|----------|
| P/N | No. of Contacts | K | |
| 57-60140 | 14 | 74.0 | 57-30140 |
| 57-60240 | 24 | 73.1 | 57-30240 |
| 57-60360 | 36 | 77.7 | 57-30360 |
| 57-60500 | 50 | 81.9 | 57-30500 |

Данный компонент на территории Российской Федерации

Вы можете приобрести в компании MosChip.

Для оперативного оформления запроса Вам необходимо перейти по данной ссылке:

<http://moschip.ru/get-element>

Вы можете разместить у нас заказ для любого Вашего проекта, будь то серийное производство или разработка единичного прибора.

В нашем ассортименте представлены ведущие мировые производители активных и пассивных электронных компонентов.

Нашей специализацией является поставка электронной компонентной базы двойного назначения, продукции таких производителей как XILINX, Intel (ex.ALTERA), Vicor, Microchip, Texas Instruments, Analog Devices, Mini-Circuits, Amphenol, Glenair.

Сотрудничество с глобальными дистрибьюторами электронных компонентов, предоставляет возможность заказывать и получать с международных складов практически любой перечень компонентов в оптимальные для Вас сроки.

На всех этапах разработки и производства наши партнеры могут получить квалифицированную поддержку опытных инженеров.

Система менеджмента качества компании отвечает требованиям в соответствии с ГОСТ Р ИСО 9001, ГОСТ РВ 0015-002 и ЭС РД 009

Офис по работе с юридическими лицами:

105318, г.Москва, ул.Щербаковская д.3, офис 1107, 1118, ДЦ «Щербаковский»

Телефон: +7 495 668-12-70 (многоканальный)

Факс: +7 495 668-12-70 (доб.304)

E-mail: info@moschip.ru

Skype отдела продаж:

moschip.ru

moschip.ru_4

moschip.ru_6

moschip.ru_9