

Accessories Multimode Relay MT

- Snap-on mounting on DIN-rail
- Screw mounting
- Pozidrive screws with rising clamp terminals
- Logical layout of input/output connections
- White marking area
- Din-rail sockets and accessories: RoHS compliant (Directive 2002/95/EC)



F0235-A

MT DIN-rail sockets with screw-type terminals

MT 78 750 MT3 DIN-rail socket with screw-type terminals, 11-pin
MT 78 755 MT2 DIN rail socket with screw type terminals, 8-pin



F0103-A

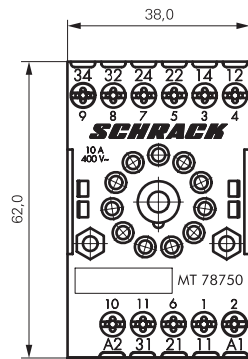

S0311-BA

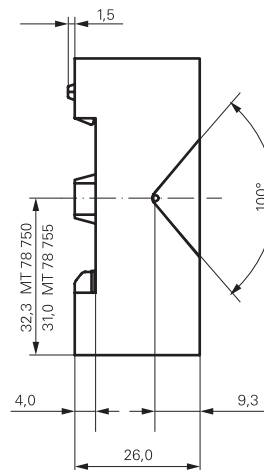

MT 78 750

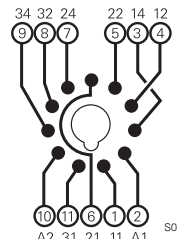

S0414-AB

MT 78 755

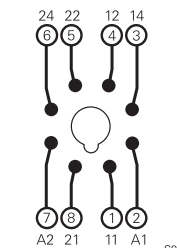

S0414-AC

MT 78 760 MT3 DIN-rail socket with screw-type terminals, 11-pin



F0103-A

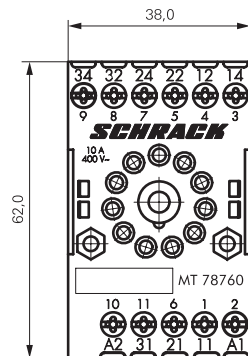

S0311-BB

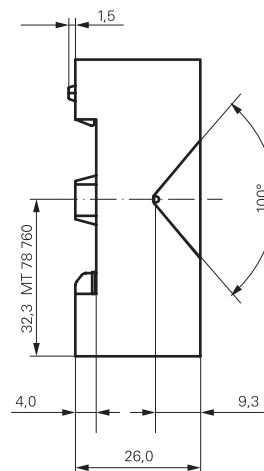

MT 78 760

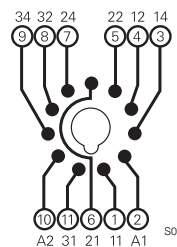

S0414-AA

Accessories Multimode Relay MT (Continued)

MT 78 740 MT3 DIN-rail socket with screw-type terminals, 11-pin
MT 78 745 MT2 DIN rail socket with screw type terminals, 8-pin



F0200-A

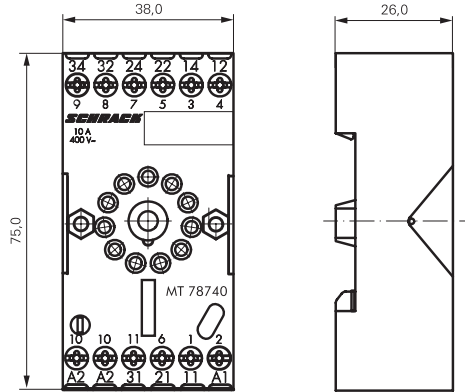

Socket system MT 78 740 and MT 78 745
 ■ 8/11 pin socket for MT2 / MT3
 ■ Double A2 screw for simple further connection of coil supply

S0366-A

Approvals

VDE REG.-Nr. 6182, cULus E135149

| Technical data | | MT 78 750/755/760/740/745 |
|---|--|---------------------------|
| Rated current | | 10 A |
| Rated voltage / max.switching voltage AC | | 240/400 VAC |
| Dielectric strength coil-contact circuit | | 2500 V _{rms} |
| open contact circuit | | 1500 V _{rms} |
| adjacent contact circuits | | 2500 V _{rms} |
| Clearance / creepage coil-contact circuit | | ≥ 2.8/4 mm |
| Material group of insulation parts | | ≥ IIIa |
| Insulation to IEC 60664-1 | | |
| Type of insulation coil-contact circuit | | basic |
| open contact circuit | | functional |
| adjacent contact circuits | | basic |
| Rated insulation voltage | | 250 V |
| Pollution degree | | 2 |
| Rated voltage system | | 230/400 V |
| Overvoltage category | | III |
| RoHS - Directive 2002/95/EC | | |
| DIN-rail sockets and retainers: | | compliant |
| Degree of protection DIN 40050 | | IP20 |
| Ambient temperature range | | -20...+80°C |
| Terminals | | screw |
| Terminal screw torque acc. IEC 61984 | | 0.5 Nm |
| max. | | 0.7 Nm |
| Wire cross section | | |
| single wire | | 2 x 2.5 mm ² |
| fine wire | | 2 x 2.5 mm ² |
| with bootlace crimp (DIN 46228/1) | | 2 x 1.5 mm ² |
| Insertion cycles | | A (10) |
| Max. Insertion Force total | | 100 N |
| Mounting distance | | 0, dense packing |
| Weight MT 78 750/760 | | 54 g |
| MT 78 755 | | 47 g |
| MT 78 740 | | 62 g |
| MT 78 745 | | 56 g |
| Packaging unit | | 25 pcs |

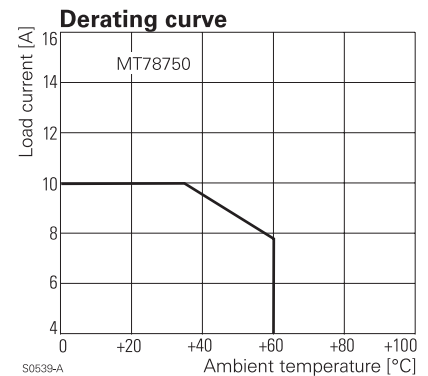

S0539-A

DIN-rail sockets with screw-type terminals

| Type | | Part Number |
|------------------|---|-------------|
| MT 78 750 | DIN-rail socket with screw-type terminals 11-pin | 1415035-1 |
| MT 78 755 | DIN-rail socket with screw-type terminals 8-pin | 3-1415035-1 |
| MT 78 760 | DIN-rail socket with screw-type terminals 11-pin | 8-1415034-1 |
| MT78 740 | DIN-rail socket with screw-type terminals, 11-pin | 8-1393163-3 |
| MT78 745 | DIN-rail socket with screw-type terminals, 8-pin | 8-1393163-4 |

Accessories for MT 78 750, MT 78 755, MT 78 760, MT 78 740, MT 78 745

| Type | Part Number |
|--|-------------|
| MT 28 800 Metal retaining clip MT | 8-1393163-0 |

LED and Protection modules for MT 78 740, MT 78 745

| Type | Part Number |
|--|-------------|
| MTM TO 0A0 Protection diode 1N4007 (A1+, A2-) | 7-1393163-6 |
| MTM U0 524 RC-network 6...24 VAC | 7-1393163-7 |
| MTM U0 730 RC-network 110...230 VAC | 7-1393163-8 |

LED

| | |
|---|-------------|
| MTM LO 024 red LED 24 VAC / VDC | 7-1393163-4 |
| MTM GO 024 green LED 24 VAC / VDC | 6-1419149-6 |
| MTM LO 730 red LED 110...230 VAC / VDC | 7-1393163-5 |
| MTM GO 730 green LED 110...230 VAC / VDC | 6-1419149-7 |

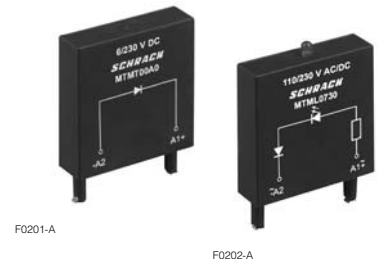

Function modules for MT 78 740, MT 78 745

| Type | Part Number |
|---------------------------------|-------------|
| MTM ZO W00 Delay ON | 7-1393163-9 |
| MTM FO W00 Multifunction | 7-1393163-3 |

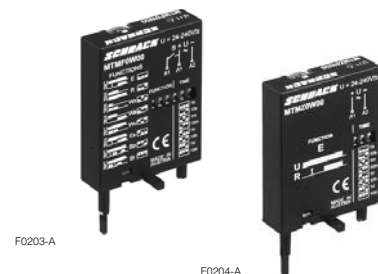

Technical data - Function modules

| | |
|-----------------------------|---|
| Nominal voltage | 24...240 VDC / VAC |
| Mains frequency | 48...63 Hz |
| Precision of time setting | + 0,5 % |
| Readiness for repetition | ≤ 0,5 % or 5 ms |
| Influence of temperature | ≤ 0,1 %/°C |
| Time range switchable | 0,05s...240h in 8 ranges |
| RoHS - Directive 2002/95/EC | compliant as per product date code 0515 |
| Ambient temperature | -25...+55 °C |

Function modules for MT 78 740, MT 78 745

| Function | Timing Diagram |
|--------------------------------------|----------------|
| Delay ON | |
| Delay OFF | |
| single shot leading edge | |
| single shot trailing edge | |
| Delay ON triggered by signal contact | |
| single shot | |
| flasher starting with pause | |
| flasher starting with pulse | |

Accessories Multimode Relay MT (Continued)

MT sockets for PCB and with solder terminals MT 78 602/603/612/613

MT 78 612 Socket 8-pin with solder terminals

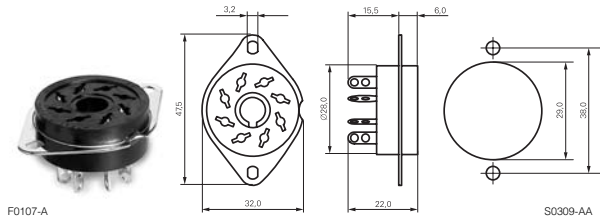

MT 78 613 Socket 11-pin with solder terminals

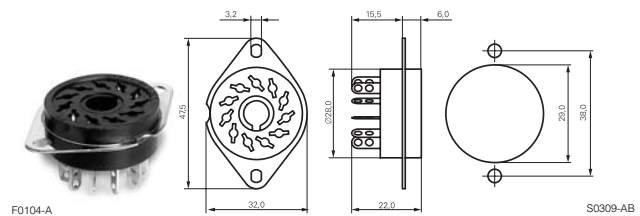

MT 78 602 Socket 8-pin with PCB terminals

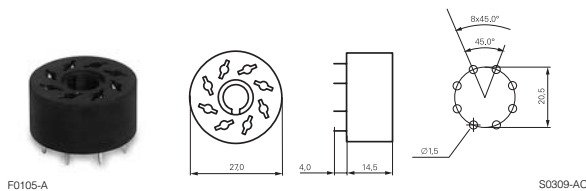

MT 78 603 Socket 11-pin with PCB terminals

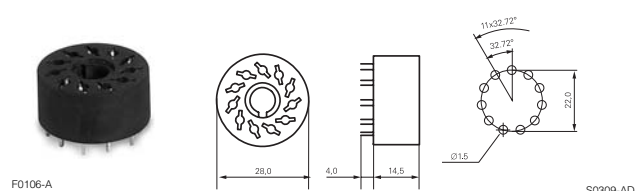

| Technical data | | MT 78 602/603/612/613 |
|---|---------------------------|---|
| Rated current | | 10 A |
| Rated voltage / max.switching voltage AC | | 240/400 VAC |
| Dielectric strength coil-contact circuit | open contact circuit | 2500 V _{rms} |
| | adjacent contact circuits | 1500 V _{rms} |
| | | 2500 V _{rms} |
| Clearance / creepage coil-contact circuit | | ≥ 2.8/4 mm |
| Material group of insulation parts | | ≥ IIIa |
| Insulation to IEC 60664-1 | | |
| Type of insulation coil-contact circuit | | basic |
| open contact circuit | | functional |
| adjacent contact circuits | | basic |
| Rated insulation voltage | | 250 |
| Pollution degree | | 2 |
| Rated voltage system | | 230/400 |
| Overvoltage category | | III |
| RoHS - Directive 2002/95/EC | | |
| MT 78 602, MT 78 603 | | compliant as per product date code 0517 |
| MT 78 612, MT 78 613 | | compliant as per product date code 0543 |
| Degree of protection DIN 40050 | | IP20 |
| Ambient temperature range | | -40...+70°C |
| Terminals | | pcb, solder terminals |
| Insertion cycles | | A (10) |
| Max. Insertion Force total | | 100 N |
| Mounting distance | | 0, dense packing |
| Resistance to soldering heat | | 270°C / 10 s |
| Weight | | 7 g |
| Packaging unit | | 25 pcs |

Sockets with solder and PCB terminals

| Type | Part Number |
|--|-------------|
| MT 78 612 Socket 8-pin with solder terminals | 7-1415043-1 |
| MT 78 613 Socket 11-pin with solder terminals | 8-1415043-1 |
| MT 78 602 Socket 8-pin with PCB terminals | 9-1415043-1 |
| MT 78 603 Socket 11-pin with PCB terminals | 1415044-1 |

Данный компонент на территории Российской Федерации

Вы можете приобрести в компании MosChip.

Для оперативного оформления запроса Вам необходимо перейти по данной ссылке:

<http://moschip.ru/get-element>

Вы можете разместить у нас заказ для любого Вашего проекта, будь то серийное производство или разработка единичного прибора.

В нашем ассортименте представлены ведущие мировые производители активных и пассивных электронных компонентов.

Нашей специализацией является поставка электронной компонентной базы двойного назначения, продукции таких производителей как XILINX, Intel (ex.ALTERA), Vicor, Microchip, Texas Instruments, Analog Devices, Mini-Circuits, Amphenol, Glenair.

Сотрудничество с глобальными дистрибьюторами электронных компонентов, предоставляет возможность заказывать и получать с международных складов практически любой перечень компонентов в оптимальные для Вас сроки.

На всех этапах разработки и производства наши партнеры могут получить квалифицированную поддержку опытных инженеров.

Система менеджмента качества компании отвечает требованиям в соответствии с ГОСТ Р ИСО 9001, ГОСТ РВ 0015-002 и ЭС РД 009

Офис по работе с юридическими лицами:

105318, г.Москва, ул.Щербаковская д.3, офис 1107, 1118, ДЦ «Щербаковский»

Телефон: +7 495 668-12-70 (многоканальный)

Факс: +7 495 668-12-70 (доб.304)

E-mail: info@moschip.ru

Skype отдела продаж:

moschip.ru

moschip.ru_4

moschip.ru_6

moschip.ru_9