

4S1 & 4SS-Series

Sub-Miniature & **Sealed** Sub-Miniature Slide Switches

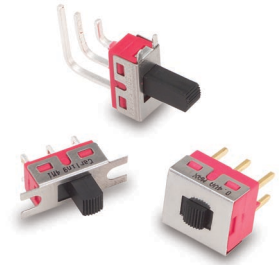

4M1-Series

Miniature Slide Switch

Specifications

Contact Rating refer to ordering scheme
 Electrical Life 30,000 make & break cycles at full load
 Contact Resistance. 10 mΩ max. initial @ 2-4 VDC
 100mA for both silver & gold plated contacts.
 Insulation Resistance 1000 MΩ min.
 Dielectric Strength 1500 Volts RMS @ sea level
 Operating Temperature . . . -30°C to +85°C
 Solder Heat Resistance. . . MIL-STD-202, Method 210
 Actuator Travel 25°

Materials

Case Diallyl phthalate (DAP) (UL 94V-0)
 Slide Handle. Nylon
 Housing. Stainless Steel
 Terminal Seal Epoxy

4S1-Series Ordering Scheme



| | | | |
|---|-----|------|-----|
| 1 SERIES 4S1 Sub-Miniature Slide Switch | | | |
| 2 POLES FSP single pole | | | |
| 3 CIRCUIT | | | |
| Switching Position: | | | |
| 1 | 2-1 | OPEN | 2-3 |
| 3 | ON | NONE | ON |
| | ON | OFF | ON |
| 4 TERMINATION | | | |
| M2 PCB | | | |
| M6 PC Mount, 90° horizontal | | | |

| | | |
|---|--|-------------------------------|
| 5 CONTACT | | |
| | <i>Material</i> | <i>Terminal Plating</i> |
| G | silver ¹ | gold over silver ³ |
| K | gold ² | tin-lead ⁴ |
| P | silver ¹ | tin-lead ⁴ |
| Q | silver ¹ | silver ¹ |
| R | gold ² | gold ² |
| | <i>Rating</i> | |
| | 3A@125VAC or 28VDC; 1.5A @ 250VAC | |
| | 0.4VA max. @20V max (AC/DC) | |
| | 3A@125VAC or 28VDC; 1.5A @ 250VAC | |
| | 3A@125VAC or 28VDC; 1.5A @ 250VAC | |
| | 0.4VA max. @20V max (AC/DC) | |
| NOTE: | | |
| Tin-lead option available with PC type terminations only. | | |
| 1 | Moveable contact & terminals: copper alloy, silver plate | |
| 2 | Moveable contact & terminals: copper alloy with gold plate over nickel plate | |
| 3 | Terminals: silver plate with outer layer in gold plating | |

| | |
|---------------------|------------|
| 6 EPOXY SEAL | |
| E | epoxy seal |

| | |
|--|--|
| 7 PACKAGING | |
| Switches are bulk packed, unless T/R is specified at the end of the part number. | |
| T/R tape reel - 500 pieces per reel | |

4SS-Series Ordering Scheme



| | | | | | | | | | | | | |
|---|------------|-------------|-------------|------------|----------|----|------|----|----------|----|-----|----|
| 1 SERIES 4SS Sealed Sub-Miniature Slide Switch | | | | | | | | | | | | |
| 2 POLES FSP single pole | | | | | | | | | | | | |
| 3 CIRCUIT Switching Position: <table style="width: 100%; border-collapse: collapse;"> <tr> <td style="width: 10%;"></td> <td style="width: 15%;"><i>2-1</i></td> <td style="width: 40%;"><i>OPEN</i></td> <td style="width: 35%;"><i>2-3</i></td> </tr> <tr> <td>1</td> <td>ON</td> <td>NONE</td> <td>ON</td> </tr> <tr> <td>3</td> <td>ON</td> <td>OFF</td> <td>ON</td> </tr> </table> | | <i>2-1</i> | <i>OPEN</i> | <i>2-3</i> | 1 | ON | NONE | ON | 3 | ON | OFF | ON |
| | <i>2-1</i> | <i>OPEN</i> | <i>2-3</i> | | | | | | | | | |
| 1 | ON | NONE | ON | | | | | | | | | |
| 3 | ON | OFF | ON | | | | | | | | | |
| 4 TERMINATION Termination options for switches with brick color actuators M2 PCB M6 PC Mount, 90° horizontal M7 PC Mount, 90° vertical Termination options for switches with white color actuators L6 Surface Mount, 90° flat S6 Surface Mount, 90° horizontal S7 Surface Mount, 90° vertical | | | | | | | | | | | | |

| | | | |
|--|---------------------|-------------------------|-----------------------------------|
| 5 CONTACT | | | |
| | <i>Material</i> | <i>Terminal Plating</i> | <i>Rating</i> |
| G | silver ¹ | gold over silver | 3A@125VAC or 28VDC; 1.5A @ 250VAC |
| K | gold ² | tin-lead ⁴ | 0.4VA max. @20V max (AC/DC) |
| P | silver ¹ | tin-lead | 3A@125VAC or 28VDC; 1.5A @ 250VAC |
| R | gold ² | gold ² | 0.4VA max. @20V max (AC/DC) |
| NOTE: | | | |
| Tin-lead option available with PC type terminations only. | | | |
| 1 Moveable contact & terminals: copper alloy, silver plate | | | |
| 2 Moveable contact & terminals: copper alloy with gold plate over nickel plate | | | |
| 3 Terminals: silver plate with outer layer in gold plating | | | |
| 4 Outer terminals: copper alloy with tin-lead over nickel plate | | | |

| |
|---------------------|
| 6 EPOXY SEAL |
| E epoxy seal |

| |
|---|
| 7 PACKAGING |
| Switches are bulk packed, unless T/R is specified at the end of the part number. |
| T/R tape reel - 500 pieces per reel |

4M1-Series Ordering Scheme

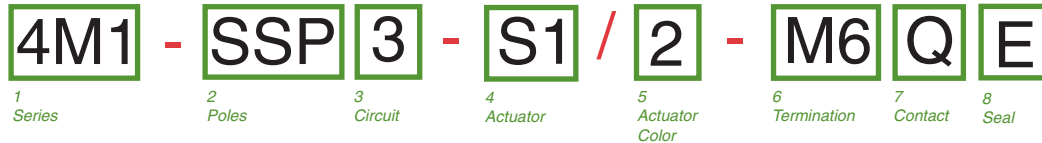

| | | | | | | | | | | | | |
|--|-----------------|-----------------|-----------------|-----------------|----------------|-----------------|----------------|----------------|----------|----|-----|----|
| 1 SERIES 4M1 Miniature Slide Switch | | | | | | | | | | | | |
| 2 POLES SSP single pole SDP double pole | | | | | | | | | | | | |
| 3 CIRCUIT Switching Position <table style="width: 100%; border-collapse: collapse;"> <tr> <td style="width: 10%;"></td> <td style="width: 15%;"><i>2-1, 5-4</i></td> <td style="width: 40%;"><i>OPEN</i></td> <td style="width: 35%;"><i>2-3, 5-6</i></td> </tr> <tr> <td>1</td> <td>ON</td> <td>NONE</td> <td>ON</td> </tr> <tr> <td>3</td> <td>ON</td> <td>OFF</td> <td>ON</td> </tr> </table> | | <i>2-1, 5-4</i> | <i>OPEN</i> | <i>2-3, 5-6</i> | 1 | ON | NONE | ON | 3 | ON | OFF | ON |
| | <i>2-1, 5-4</i> | <i>OPEN</i> | <i>2-3, 5-6</i> | | | | | | | | | |
| 1 | ON | NONE | ON | | | | | | | | | |
| 3 | ON | OFF | ON | | | | | | | | | |
| 4 ACTUATOR S1 .201 [5.10] high S2 .285 [7.25] high S3 .370 [9.40] high S4 .140 [3.55] high S5 .053 [1.35] high (for DPDT only) S6 .482 [12.25] high S7 .311 [7.90] high T1 .201 [5.10] high (for DPDT only) | | | | | | | | | | | | |
| 5 ACTUATOR COLOR¹ <table style="width: 100%; border-collapse: collapse;"> <tr> <td style="width: 25%;">1 white</td> <td style="width: 25%;">3 red</td> <td style="width: 25%;">5 yellow</td> <td style="width: 25%;">7 blue</td> </tr> <tr> <td>2 black</td> <td>4 orange</td> <td>6 green</td> <td>8 brown</td> </tr> </table> <p><small>1 White, black & red are standard. Other colors available for quantities of 5K or more.</small></p> | 1 white | 3 red | 5 yellow | 7 blue | 2 black | 4 orange | 6 green | 8 brown | | | | |
| 1 white | 3 red | 5 yellow | 7 blue | | | | | | | | | |
| 2 black | 4 orange | 6 green | 8 brown | | | | | | | | | |

| | |
|------------------------------------|---|
| 6 TERMINATION | |
| M1 Solder Lug | M5-3 Wire Wrap [10.80] |
| M2 PCB | M5-4 Wire Wrap [26.97] |
| M3 Quick Connect | M6 PC Mount, 90° horizontal |
| M5-1 Wire Wrap .750 [19.05] | M7 PC Mount, 90° vertical |
| M5-2 Wire Wrap [24.48] | VS2 PC Mount, U bracket, .620 mounting x .460 high |

| | | | |
|--|---------------------|-------------------------------|---------------------------------|
| 7 CONTACT | | | |
| | <i>Material</i> | <i>Terminal Plating</i> | <i>Rating</i> |
| G | silver ¹ | gold over silver ² | 5A@125VAC or 28VDC; 2A @ 250VAC |
| K | gold ² | tin-lead ⁴ | 0.4VA max. @20V max (AC/DC) |
| P | silver ¹ | tin-lead ⁴ | 5A@125VAC or 28VDC; 2A @ 250VAC |
| Q | silver ¹ | silver ¹ | 5A@125VAC or 28VDC; 2A @ 250VAC |
| R | gold ² | gold ² | 0.4VA max. @20V max (AC/DC) |
| NOTE: | | | |
| Tin-lead option available with PC type terminations only. | | | |
| 1 Moveable contact & terminals: copper alloy, silver plate | | | |
| 2 Moveable contact & terminals: copper alloy with gold plate over nickel plate | | | |
| 3 Terminals: silver plate with outer layer in gold plating | | | |
| 4 Outer terminals: copper alloy with tin-lead over nickel plate | | | |

| |
|---------------------|
| 8 EPOXY SEAL |
| E epoxy seal |

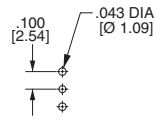
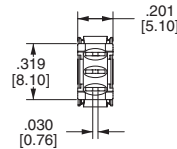
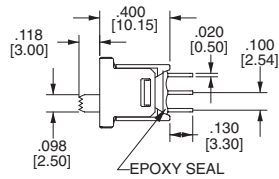
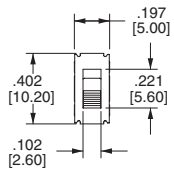
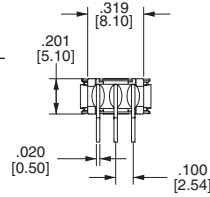
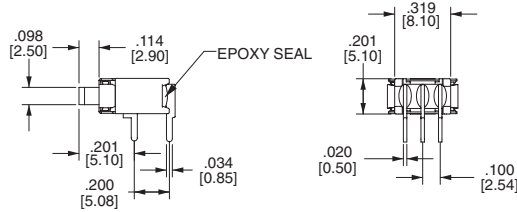
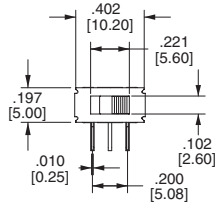
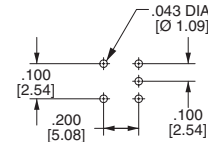
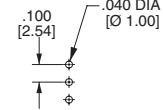
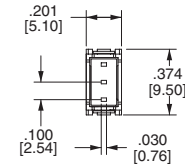
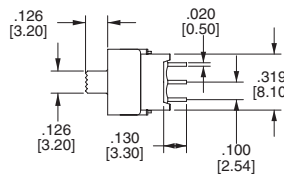
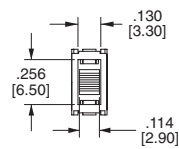
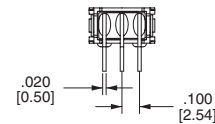
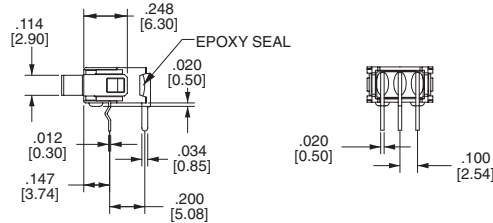
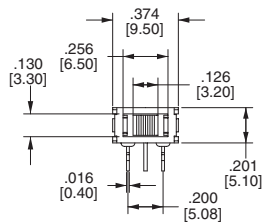
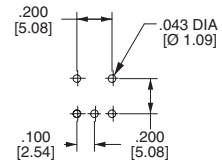
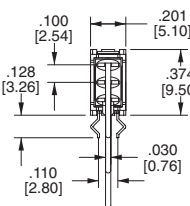
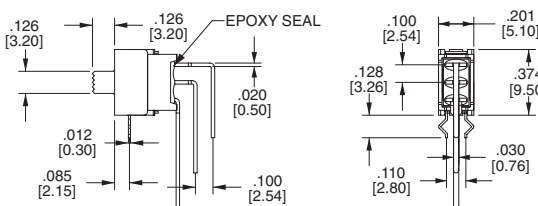
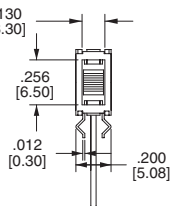
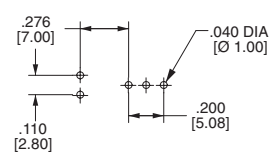
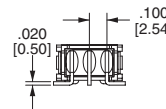
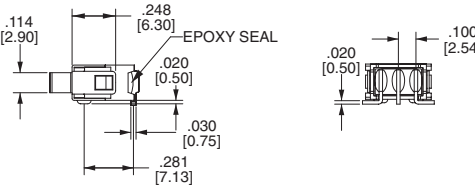
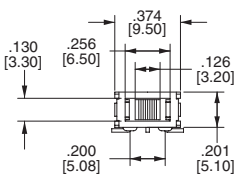
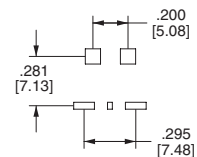
4S-Series Dimensional Specifications: in. [mm]
4S1-Series
TERMINATION
PC MOUNTING
M2

M6

PC MOUNTING

4SS-Series
TERMINATION
PC MOUNTING
M2

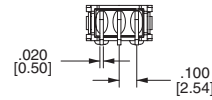
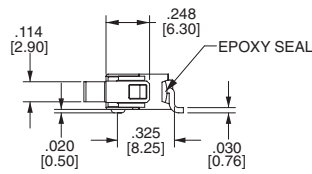
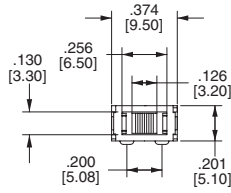
M6

PC MOUNTING

M7

PC MOUNTING

L6

PC MOUNTING

4SS-Series Dimensional Specifications: in. [mm]

TERMINATION

S6



PC MOUNTING

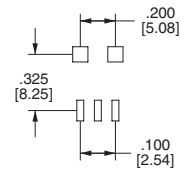

S7

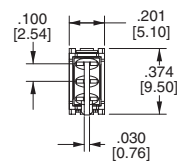
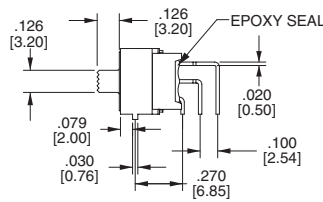
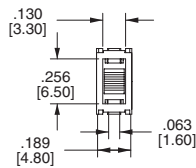

PC MOUNTING

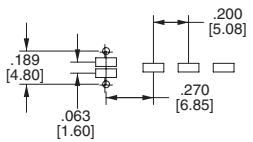

REEL TAPING

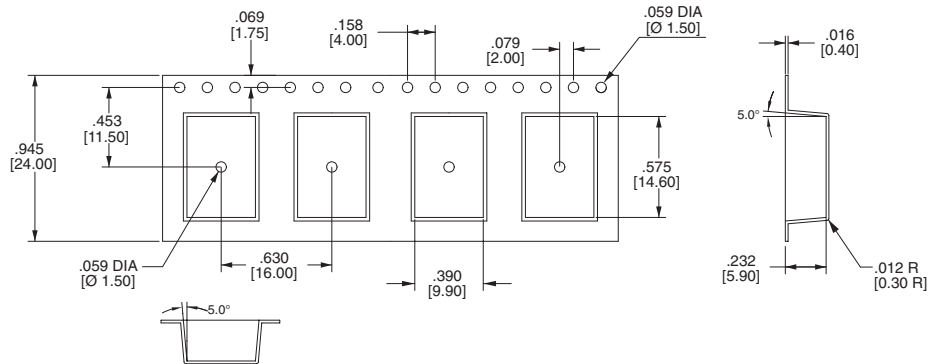

FOR S6,L6 ONLY

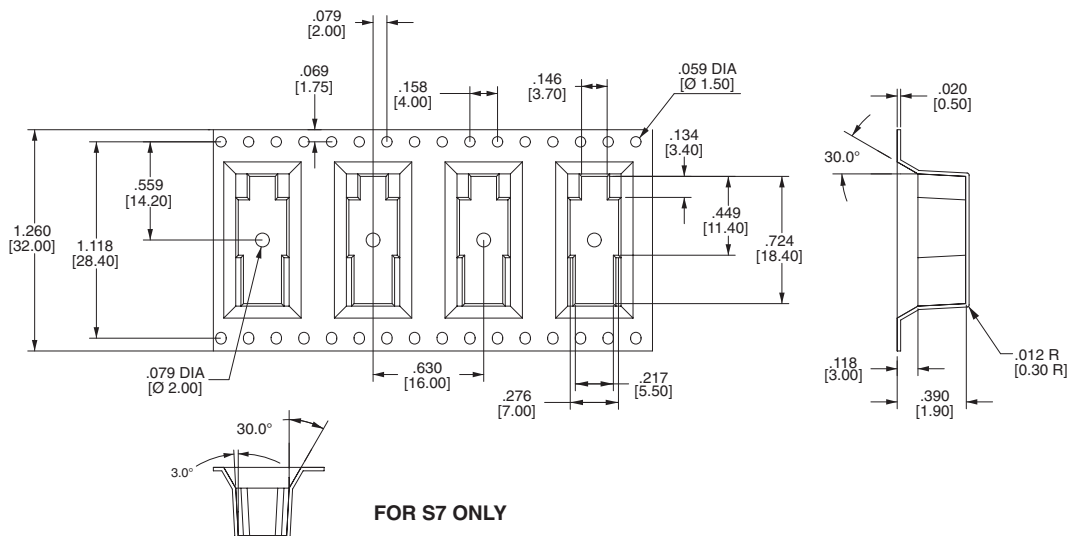

FOR S7 ONLY

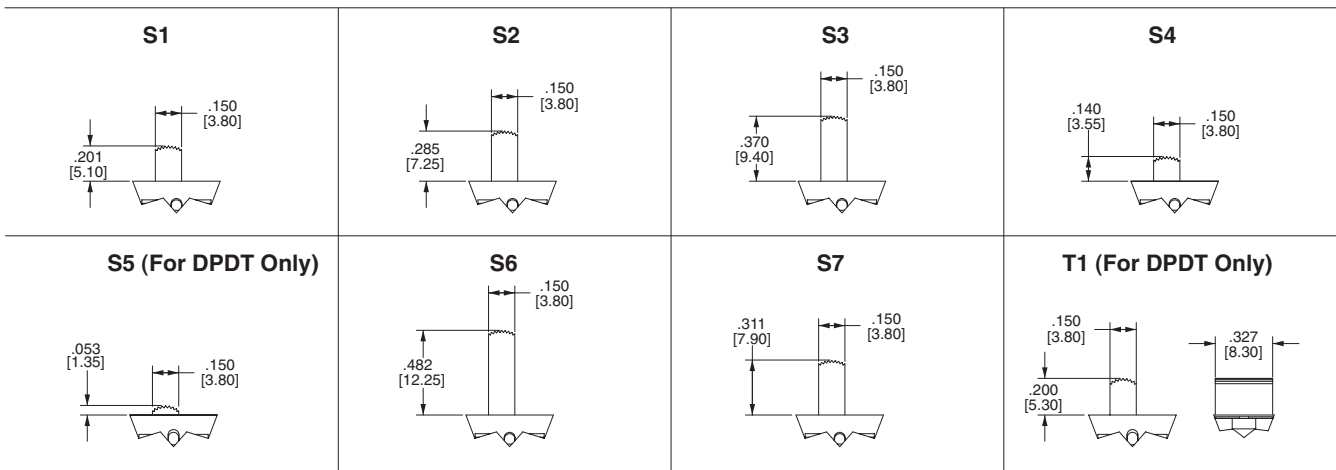
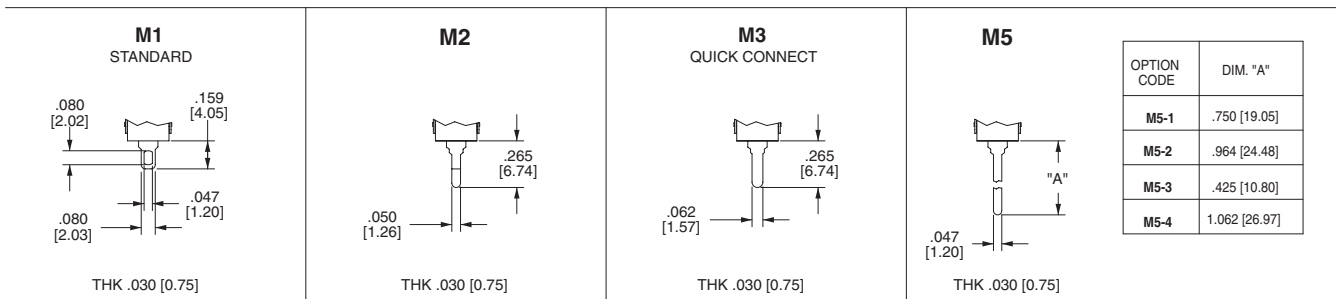
4M1-Series Dimensional Specifications: in. [mm]
ACTUATOR

TERMINATION

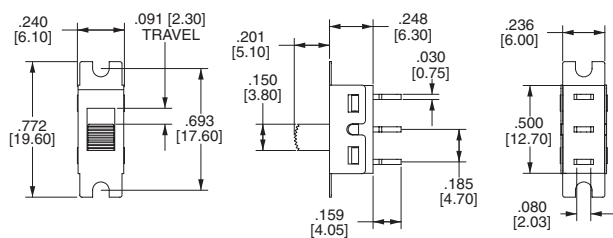
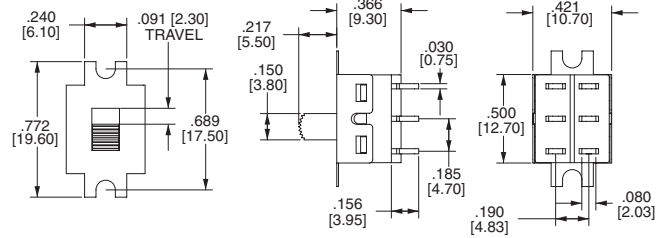
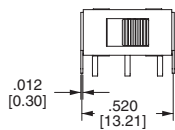
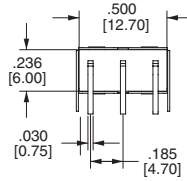
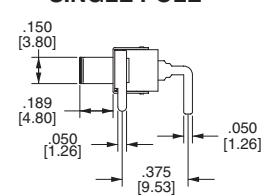
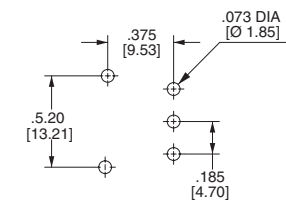
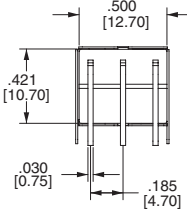
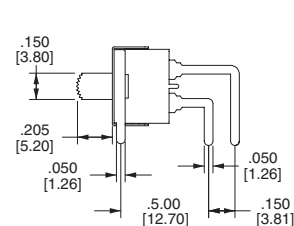
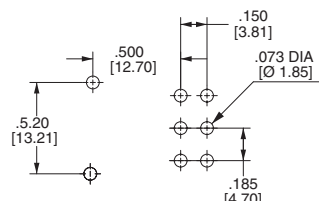
| OPTION CODE | DIM. "A" |
|-------------|---------------|
| M5-1 | .750 [19.05] |
| M5-2 | .964 [24.48] |
| M5-3 | .425 [10.80] |
| M5-4 | 1.062 [26.97] |

SINGLE POLE

DOUBLE POLE

M6

SINGLE POLE

PC MOUNTING

DOUBLE POLE

PC MOUNTING

4M1-Series Dimensional Specifications: in. [mm]

TERMINATION

M7

SINGLE POLE

PC MOUNTING

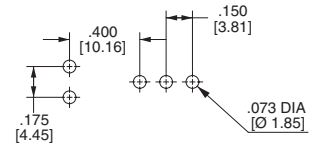
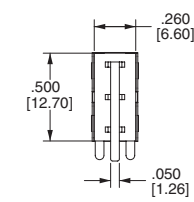
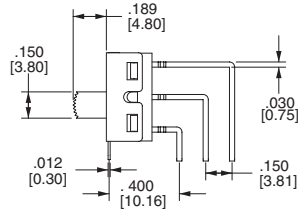
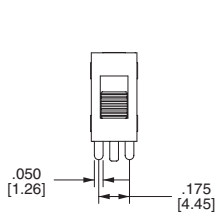

DOUBLE POLE

PC MOUNTING

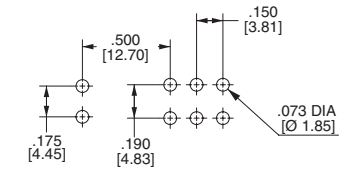
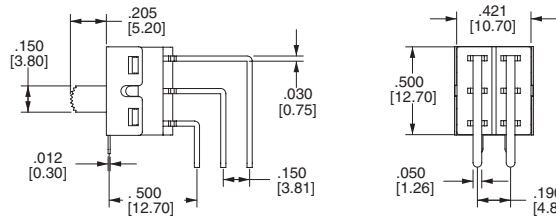
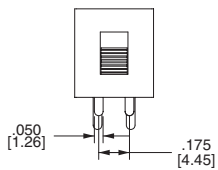

VS2

SINGLE POLE

PC MOUNTING

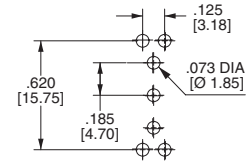
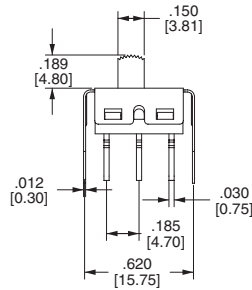
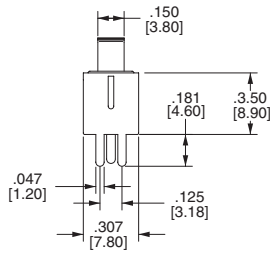

DOUBLE POLE

PC MOUNTING

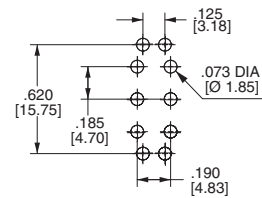
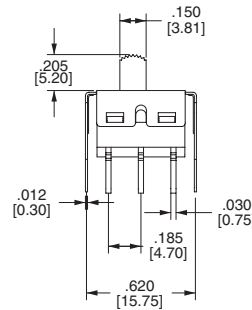
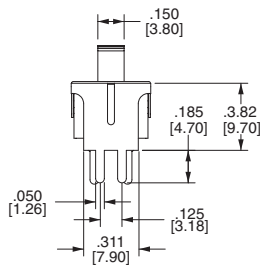

Данный компонент на территории Российской Федерации

Вы можете приобрести в компании MosChip.

Для оперативного оформления запроса Вам необходимо перейти по данной ссылке:

<http://moschip.ru/get-element>

Вы можете разместить у нас заказ для любого Вашего проекта, будь то серийное производство или разработка единичного прибора.

В нашем ассортименте представлены ведущие мировые производители активных и пассивных электронных компонентов.

Нашей специализацией является поставка электронной компонентной базы двойного назначения, продукции таких производителей как XILINX, Intel (ex.ALTERA), Vicor, Microchip, Texas Instruments, Analog Devices, Mini-Circuits, Amphenol, Glenair.

Сотрудничество с глобальными дистрибьюторами электронных компонентов, предоставляет возможность заказывать и получать с международных складов практически любой перечень компонентов в оптимальные для Вас сроки.

На всех этапах разработки и производства наши партнеры могут получить квалифицированную поддержку опытных инженеров.

Система менеджмента качества компании отвечает требованиям в соответствии с ГОСТ Р ИСО 9001, ГОСТ РВ 0015-002 и ЭС РД 009

Офис по работе с юридическими лицами:

105318, г.Москва, ул.Щербаковская д.3, офис 1107, 1118, ДЦ «Щербаковский»

Телефон: +7 495 668-12-70 (многоканальный)

Факс: +7 495 668-12-70 (доб.304)

E-mail: info@moschip.ru

Skype отдела продаж:

moschip.ru

moschip.ru_4

moschip.ru_6

moschip.ru_9