

### 4S1 & 4SS-Series

Sub-Miniature &  
**Sealed** Sub-Miniature  
Slide Switches

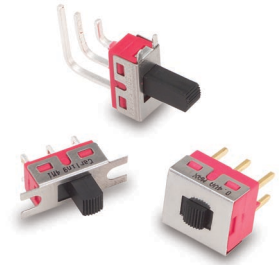

### 4M1-Series

Miniature Slide Switch

### Specifications

Contact Rating . . . . . refer to ordering scheme  
 Electrical Life . . . . . 30,000 make & break cycles at full load  
 Contact Resistance. . . . . 10 mΩ max. initial @ 2-4 VDC  
 100mA for both silver & gold plated contacts.  
 Insulation Resistance . . . . 1000 MΩ min.  
 Dielectric Strength . . . . . 1500 Volts RMS @ sea level  
 Operating Temperature . . . -30°C to +85°C  
 Solder Heat Resistance. . . MIL-STD-202, Method 210  
 Actuator Travel . . . . . 25°

#### Materials

Case . . . . . Diallyl phthalate (DAP) (UL 94V-0)  
 Slide Handle. . . . . Nylon  
 Housing. . . . . Stainless Steel  
 Terminal Seal . . . . . Epoxy

### 4S1-Series Ordering Scheme



<b>1 SERIES</b> 4S1 Sub-Miniature Slide Switch			
<b>2 POLES</b> FSP single pole			
<b>3 CIRCUIT</b>			
<b>Switching Position:</b>			
1	2-1	OPEN	2-3
3	ON	NONE	ON
	ON	OFF	ON
<b>4 TERMINATION</b>			
M2 PCB			
M6 PC Mount, 90° horizontal			

<b>5 CONTACT</b>		
	<i>Material</i>	<i>Terminal Plating</i>
<b>G</b>	silver <sup>1</sup>	gold over silver <sup>3</sup>
<b>K</b>	gold <sup>2</sup>	tin-lead <sup>4</sup>
<b>P</b>	silver <sup>1</sup>	tin-lead <sup>4</sup>
<b>Q</b>	silver <sup>1</sup>	silver <sup>1</sup>
<b>R</b>	gold <sup>2</sup>	gold <sup>2</sup>
	<i>Rating</i>	
	3A@125VAC or 28VDC; 1.5A @ 250VAC	
	0.4VA max. @20V max (AC/DC)	
	3A@125VAC or 28VDC; 1.5A @ 250VAC	
	3A@125VAC or 28VDC; 1.5A @ 250VAC	
	0.4VA max. @20V max (AC/DC)	
NOTE:		
Tin-lead option available with PC type terminations only.		
1	Moveable contact & terminals: copper alloy, silver plate	
2	Moveable contact & terminals: copper alloy with gold plate over nickel plate	
3	Terminals: silver plate with outer layer in gold plating	

<b>6 EPOXY SEAL</b>	
E	epoxy seal

<b>7 PACKAGING</b>	
Switches are bulk packed, unless T/R is specified at the end of the part number.	
T/R tape reel - 500 pieces per reel	

## 4SS-Series Ordering Scheme



<b>1 SERIES</b> 4SS Sealed Sub-Miniature Slide Switch												
<b>2 POLES</b> FSP single pole												
<b>3 CIRCUIT</b> <b>Switching Position:</b>												
<table border="0"> <tr> <td></td> <td>2-1</td> <td>OPEN</td> <td>2-3</td> </tr> <tr> <td>1</td> <td>ON</td> <td>NONE</td> <td>ON</td> </tr> <tr> <td>3</td> <td>ON</td> <td>OFF</td> <td>ON</td> </tr> </table>		2-1	OPEN	2-3	1	ON	NONE	ON	3	ON	OFF	ON
	2-1	OPEN	2-3									
1	ON	NONE	ON									
3	ON	OFF	ON									
<b>4 TERMINATION</b> Termination options for switches with brick color actuators M2 PCB M6 PC Mount, 90° horizontal M7 PC Mount, 90° vertical Termination options for switches with white color actuators L6 Surface Mount, 90° flat S6 Surface Mount, 90° horizontal S7 Surface Mount, 90° vertical												

<b>5 CONTACT</b>															
<table border="0"> <tr> <th>Material</th> <th>Terminal Plating</th> <th>Rating</th> </tr> <tr> <td>G silver<sup>1</sup></td> <td>gold over silver</td> <td>3A@125VAC or 28VDC; 1.5A @ 250VAC</td> </tr> <tr> <td>K gold<sup>2</sup></td> <td>tin-lead<sup>4</sup></td> <td>0.4VA max. @20V max (AC/DC)</td> </tr> <tr> <td>P silver<sup>1</sup></td> <td>tin-lead</td> <td>3A@125VAC or 28VDC; 1.5A @ 250VAC</td> </tr> <tr> <td>R gold<sup>2</sup></td> <td>gold<sup>2</sup></td> <td>0.4VA max. @20V max (AC/DC)</td> </tr> </table>	Material	Terminal Plating	Rating	G silver <sup>1</sup>	gold over silver	3A@125VAC or 28VDC; 1.5A @ 250VAC	K gold <sup>2</sup>	tin-lead <sup>4</sup>	0.4VA max. @20V max (AC/DC)	P silver <sup>1</sup>	tin-lead	3A@125VAC or 28VDC; 1.5A @ 250VAC	R gold <sup>2</sup>	gold <sup>2</sup>	0.4VA max. @20V max (AC/DC)
Material	Terminal Plating	Rating													
G silver <sup>1</sup>	gold over silver	3A@125VAC or 28VDC; 1.5A @ 250VAC													
K gold <sup>2</sup>	tin-lead <sup>4</sup>	0.4VA max. @20V max (AC/DC)													
P silver <sup>1</sup>	tin-lead	3A@125VAC or 28VDC; 1.5A @ 250VAC													
R gold <sup>2</sup>	gold <sup>2</sup>	0.4VA max. @20V max (AC/DC)													
NOTE: Tin-lead option available with PC type terminations only. 1 Moveable contact & terminals: copper alloy, silver plate 2 Moveable contact & terminals: copper alloy with gold plate over nickel plate 3 Terminals: silver plate with outer layer in gold plating 4 Outer terminals: copper alloy with tin-lead over nickel plate															

<b>6 EPOXY SEAL</b> E epoxy seal
-------------------------------------

<b>7 PACKAGING</b> Switches are bulk packed, unless T/R is specified at the end of the part number. T/R tape reel - 500 pieces per reel
---

## 4M1-Series Ordering Scheme

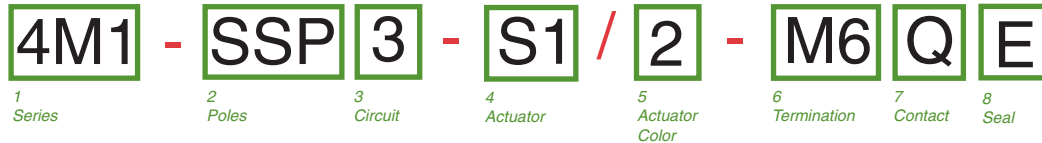

<b>1 SERIES</b> 4M1 Miniature Slide Switch																
<b>2 POLES</b> SSP single pole      SDP double pole																
<b>3 CIRCUIT</b> <b>Switching Position</b>																
<table border="0"> <tr> <td></td> <td>2-1, 5-4</td> <td>OPEN</td> <td>2-3, 5-6</td> </tr> <tr> <td>1</td> <td>ON</td> <td>NONE</td> <td>ON</td> </tr> <tr> <td>3</td> <td>ON</td> <td>OFF</td> <td>ON</td> </tr> </table>		2-1, 5-4	OPEN	2-3, 5-6	1	ON	NONE	ON	3	ON	OFF	ON				
	2-1, 5-4	OPEN	2-3, 5-6													
1	ON	NONE	ON													
3	ON	OFF	ON													
<b>4 ACTUATOR</b>																
<table border="0"> <tr> <td>S1</td> <td>.201 [5.10] high</td> </tr> <tr> <td>S2</td> <td>.285 [7.25] high</td> </tr> <tr> <td>S3</td> <td>.370 [9.40] high</td> </tr> <tr> <td>S4</td> <td>.140 [3.55] high</td> </tr> <tr> <td>S5</td> <td>.053 [1.35] high (for DPDT only)</td> </tr> <tr> <td>S6</td> <td>.482 [12.25] high</td> </tr> <tr> <td>S7</td> <td>.311 [7.90] high</td> </tr> <tr> <td>T1</td> <td>.201 [5.10] high (for DPDT only)</td> </tr> </table>	S1	.201 [5.10] high	S2	.285 [7.25] high	S3	.370 [9.40] high	S4	.140 [3.55] high	S5	.053 [1.35] high (for DPDT only)	S6	.482 [12.25] high	S7	.311 [7.90] high	T1	.201 [5.10] high (for DPDT only)
S1	.201 [5.10] high															
S2	.285 [7.25] high															
S3	.370 [9.40] high															
S4	.140 [3.55] high															
S5	.053 [1.35] high (for DPDT only)															
S6	.482 [12.25] high															
S7	.311 [7.90] high															
T1	.201 [5.10] high (for DPDT only)															
<b>5 ACTUATOR COLOR<sup>1</sup></b>																
<table border="0"> <tr> <td>1 white</td> <td>3 red</td> <td>5 yellow</td> <td>7 blue</td> <td>9 gray</td> </tr> <tr> <td>2 black</td> <td>4 orange</td> <td>6 green</td> <td>8 brown</td> <td></td> </tr> </table> <p>1 White, black &amp; red are standard. Other colors available for quantities of 5K or more.</p>	1 white	3 red	5 yellow	7 blue	9 gray	2 black	4 orange	6 green	8 brown							
1 white	3 red	5 yellow	7 blue	9 gray												
2 black	4 orange	6 green	8 brown													

<b>6 TERMINATION</b>	<b>M5-3</b> Wire Wrap [10.80]
M1 Solder Lug	<b>M5-4</b> Wire Wrap [26.97]
M2 PCB	<b>M6</b> PC Mount, 90° horizontal
M3 Quick Connect	<b>M7</b> PC Mount, 90° vertical
M5-1 Wire Wrap .750 [19.05]	<b>VS2</b> PC Mount, U bracket, .620 mounting x .460 high
M5-2 Wire Wrap [24.48]	

<b>7 CONTACT</b>																								
<table border="0"> <tr> <th>Material</th> <th>Terminal Plating</th> <th>Rating</th> <th>Approvals</th> </tr> <tr> <td>G silver<sup>1</sup></td> <td>gold over silver<sup>2</sup></td> <td>5A@125VAC or 28VDC; 2A @ 250VAC</td> <td>UL, CSA</td> </tr> <tr> <td>K gold<sup>2</sup></td> <td>tin-lead<sup>4</sup></td> <td>0.4VA max. @20V max (AC/DC)</td> <td></td> </tr> <tr> <td>P silver<sup>1</sup></td> <td>tin-lead<sup>4</sup></td> <td>5A@125VAC or 28VDC; 2A @ 250VAC</td> <td>UL, CSA</td> </tr> <tr> <td>Q silver<sup>1</sup></td> <td>silver<sup>1</sup></td> <td>5A@125VAC or 28VDC; 2A @ 250VAC</td> <td>UL, CSA</td> </tr> <tr> <td>R gold<sup>2</sup></td> <td>gold<sup>2</sup></td> <td>0.4VA max. @20V max (AC/DC)</td> <td></td> </tr> </table>	Material	Terminal Plating	Rating	Approvals	G silver <sup>1</sup>	gold over silver <sup>2</sup>	5A@125VAC or 28VDC; 2A @ 250VAC	UL, CSA	K gold <sup>2</sup>	tin-lead <sup>4</sup>	0.4VA max. @20V max (AC/DC)		P silver <sup>1</sup>	tin-lead <sup>4</sup>	5A@125VAC or 28VDC; 2A @ 250VAC	UL, CSA	Q silver <sup>1</sup>	silver <sup>1</sup>	5A@125VAC or 28VDC; 2A @ 250VAC	UL, CSA	R gold <sup>2</sup>	gold <sup>2</sup>	0.4VA max. @20V max (AC/DC)	
Material	Terminal Plating	Rating	Approvals																					
G silver <sup>1</sup>	gold over silver <sup>2</sup>	5A@125VAC or 28VDC; 2A @ 250VAC	UL, CSA																					
K gold <sup>2</sup>	tin-lead <sup>4</sup>	0.4VA max. @20V max (AC/DC)																						
P silver <sup>1</sup>	tin-lead <sup>4</sup>	5A@125VAC or 28VDC; 2A @ 250VAC	UL, CSA																					
Q silver <sup>1</sup>	silver <sup>1</sup>	5A@125VAC or 28VDC; 2A @ 250VAC	UL, CSA																					
R gold <sup>2</sup>	gold <sup>2</sup>	0.4VA max. @20V max (AC/DC)																						
NOTE: Tin-lead option available with PC type terminations only. 1 Moveable contact & terminals: copper alloy, silver plate 2 Moveable contact & terminals: copper alloy with gold plate over nickel plate 3 Terminals: silver plate with outer layer in gold plating 4 Outer terminals: copper alloy with tin-lead over nickel plate																								

<b>8 EPOXY SEAL</b> E      epoxy seal
---------------------------------------

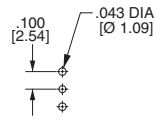
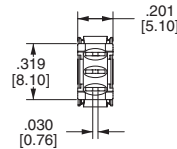
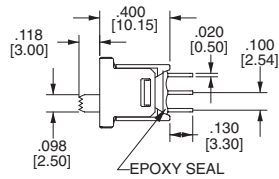
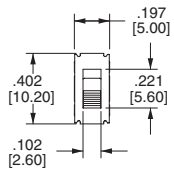
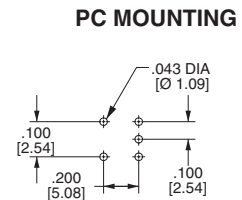
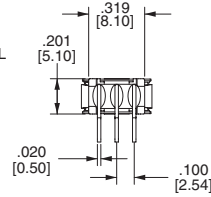
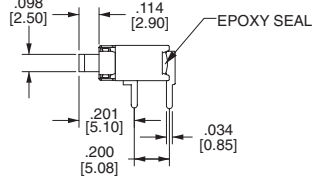
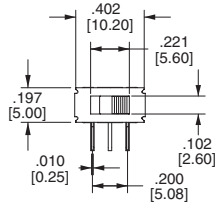
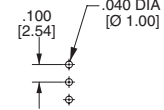
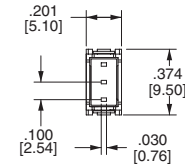
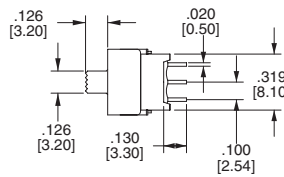
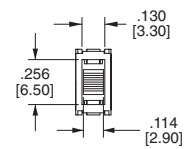
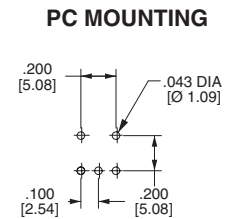
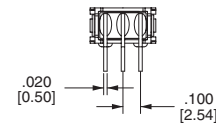
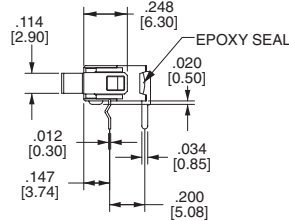
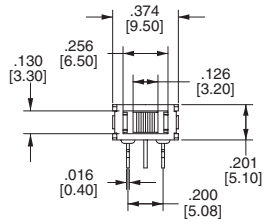
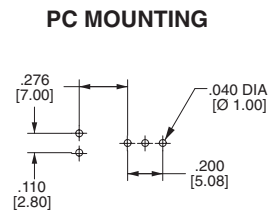
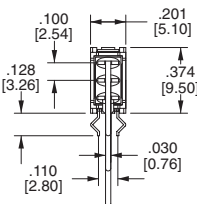
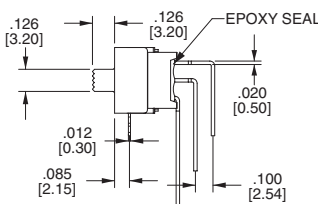
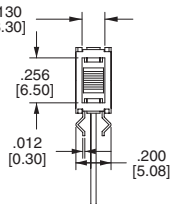
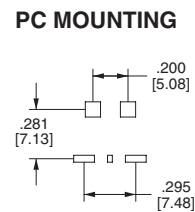
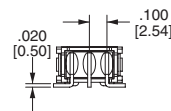
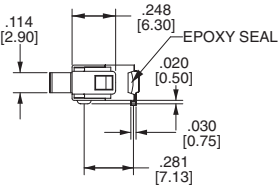
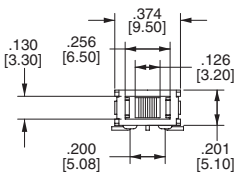
**4S-Series Dimensional Specifications: in. [mm]**
**4S1-Series**
**TERMINATION**
**PC MOUNTING**
**M2**

**M6**

**4SS-Series**
**TERMINATION**
**PC MOUNTING**
**M2**

**M6**

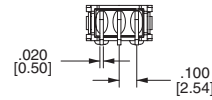
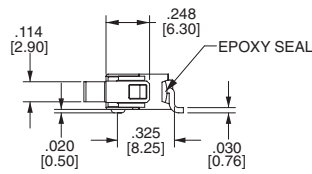
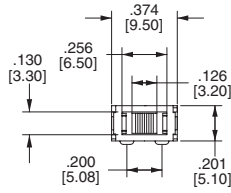
**M7**

**L6**

**4SS-Series Dimensional Specifications: in. [mm]**

**TERMINATION**

**S6**



**PC MOUNTING**

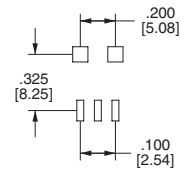

**S7**

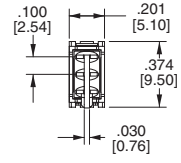
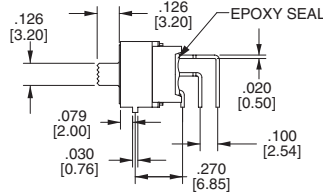
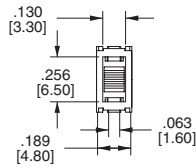

**PC MOUNTING**

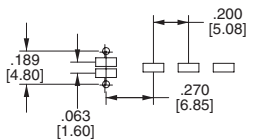

**REEL TAPING**

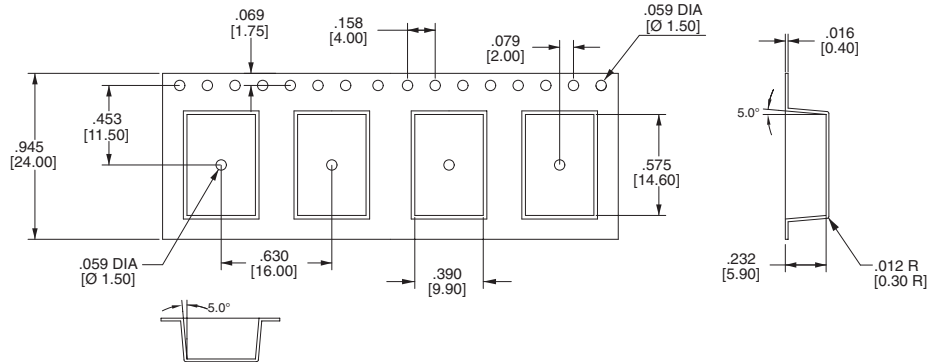

**FOR S6,L6 ONLY**

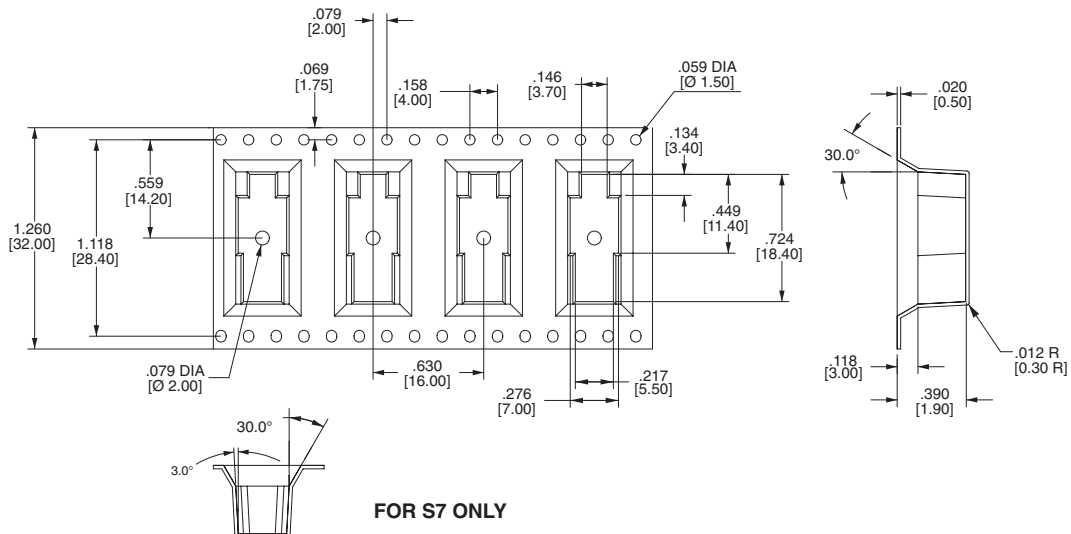

**FOR S7 ONLY**

## 4M1-Series Dimensional Specifications: in. [mm]

### ACTUATOR

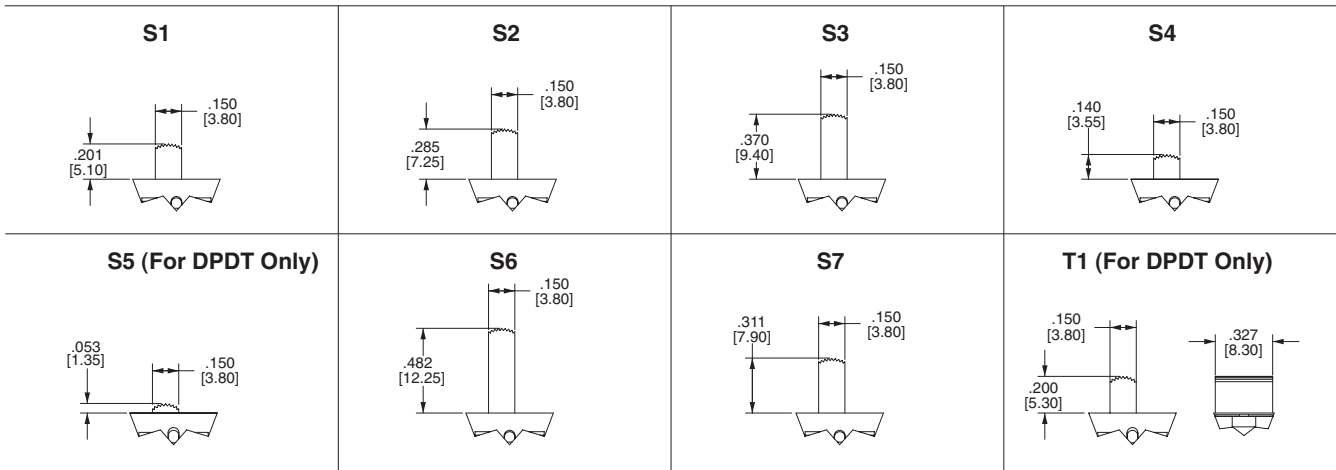

### TERMINATION

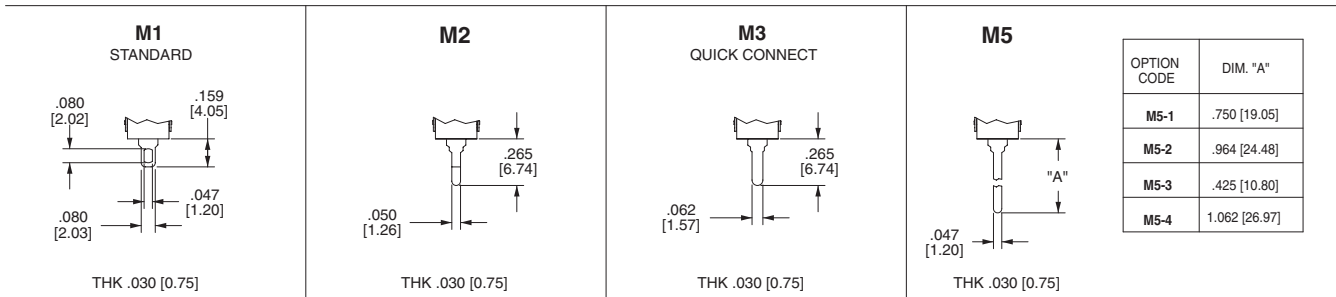

### SINGLE POLE

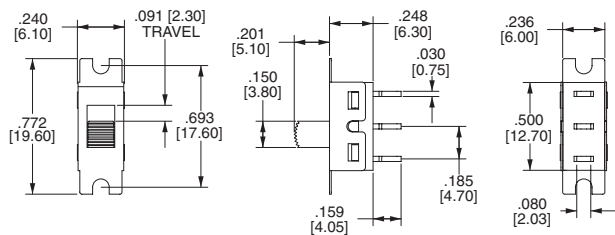

### DOUBLE POLE

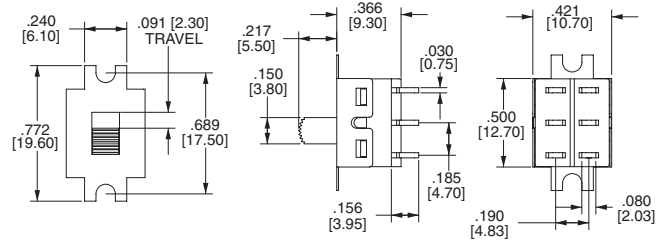

### M6

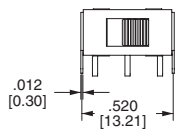

### SINGLE POLE

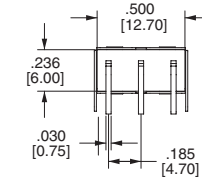
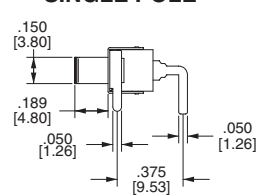

### PC MOUNTING

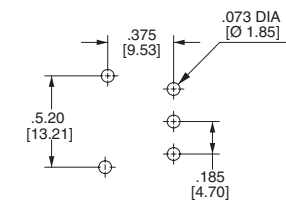

### DOUBLE POLE

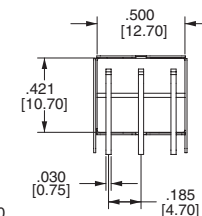
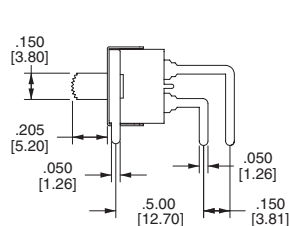

### PC MOUNTING

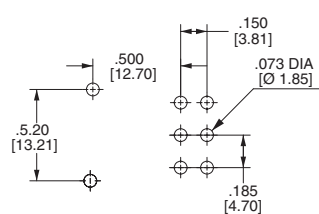

**4M1-Series Dimensional Specifications: in. [mm]**

**TERMINATION**

**M7**

**SINGLE POLE**

**PC MOUNTING**

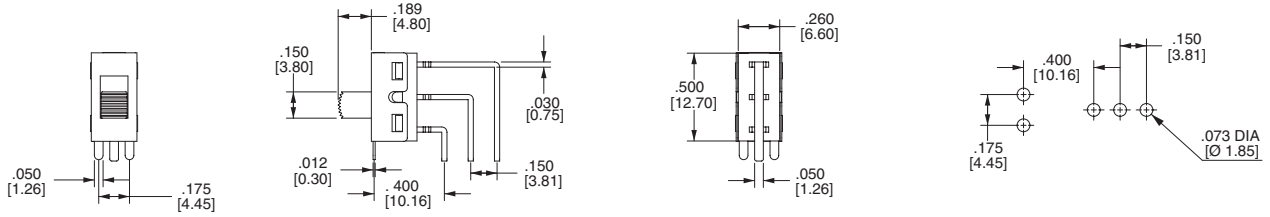

**DOUBLE POLE**

**PC MOUNTING**

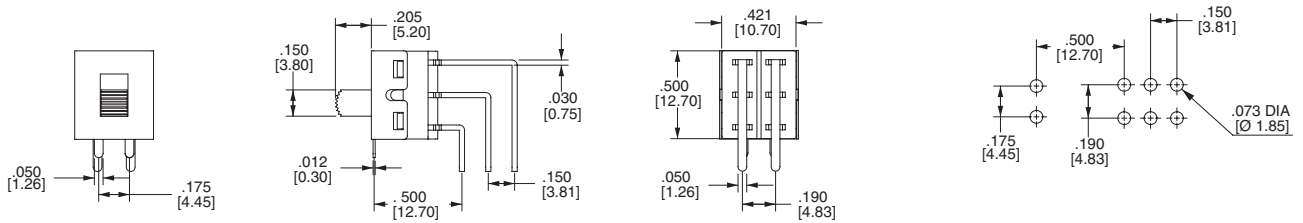

**VS2**

**SINGLE POLE**

**PC MOUNTING**

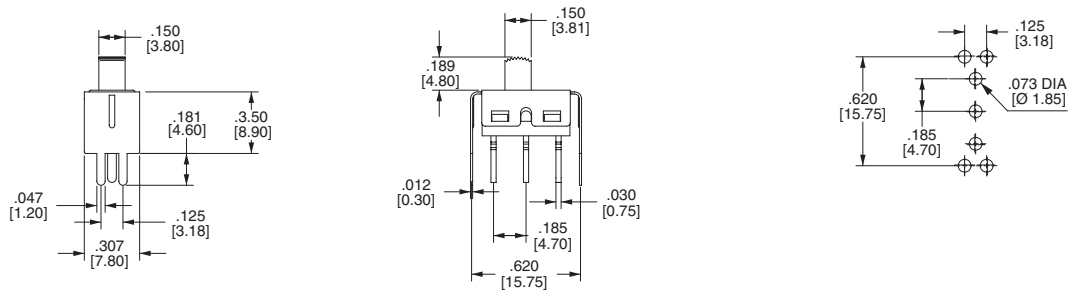

**DOUBLE POLE**

**PC MOUNTING**

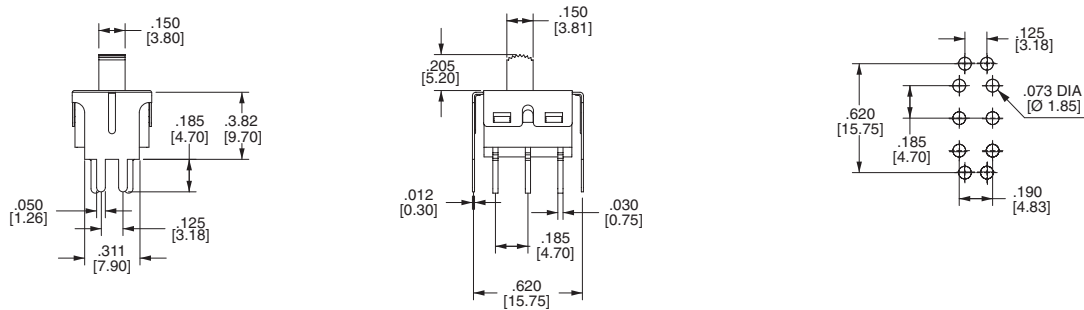

## Данный компонент на территории Российской Федерации

### Вы можете приобрести в компании MosChip.

Для оперативного оформления запроса Вам необходимо перейти по данной ссылке:

<http://moschip.ru/get-element>

Вы можете разместить у нас заказ для любого Вашего проекта, будь то серийное производство или разработка единичного прибора.

В нашем ассортименте представлены ведущие мировые производители активных и пассивных электронных компонентов.

Нашей специализацией является поставка электронной компонентной базы двойного назначения, продукции таких производителей как XILINX, Intel (ex.ALTERA), Vicor, Microchip, Texas Instruments, Analog Devices, Mini-Circuits, Amphenol, Glenair.

Сотрудничество с глобальными дистрибьюторами электронных компонентов, предоставляет возможность заказывать и получать с международных складов практически любой перечень компонентов в оптимальные для Вас сроки.

На всех этапах разработки и производства наши партнеры могут получить квалифицированную поддержку опытных инженеров.

Система менеджмента качества компании отвечает требованиям в соответствии с ГОСТ Р ИСО 9001, ГОСТ РВ 0015-002 и ЭС РД 009

### Офис по работе с юридическими лицами:

105318, г.Москва, ул.Щербаковская д.3, офис 1107, 1118, ДЦ «Щербаковский»

Телефон: +7 495 668-12-70 (многоканальный)

Факс: +7 495 668-12-70 (доб.304)

E-mail: [info@moschip.ru](mailto:info@moschip.ru)

Skype отдела продаж:

moschip.ru

moschip.ru\_4

moschip.ru\_6

moschip.ru\_9