

Advance Information
HTM1735
Compliant with RoHS recommendations
ANALOG VOLTAGE RELATIVE HUMIDITY AND TEMPERATURE MODULE

Based on the rugged HS1101LF humidity sensor, HTM1735 is a dedicated humidity and temperature transducer designed for OEM applications where a reliable and accurate measurement is needed. Direct interface with a micro-controller is made possible with the module's humidity linear voltage and direct NTC outputs. HTM1735 is designed for an optimized board to board connection.

Main features

- **Suitable for direct board assembly**
- **Product free from Lead, Cr (6+), Cd and Hg**
- Not affected by repeated condensations
- **Full interchangeability**
- High reliability and long term stability
- **Typical 1 to 3.6 Volt DC output for 0 to 100% RH at 5 V DC supply**
- **Humidity calibrated within +/- 2% RH @ 55% RH**
- **Temperature measurement through NTC 10 kΩ +/- 3% direct output**
- * Ratiometric to voltage supply within the specified range

Maximum ratings

| Ratings | Symbol | Value | Unit |
|-------------------------------|-------------------|--------------|-----------------|
| Storage Temperature | T _{stg} | - 40 to +105 | °C |
| Supply Voltage (Peak) | V _{cc} | 7 | V _{dc} |
| Humidity Operating Range | RH | 0 to 100 | %RH |
| Temperature Operating Range | T _a | -40 to +100 | °C |
| Maximum Output Current (Peak) | I _{peak} | 5 | mA |
| Maximum Power | P _d | 20 | mW |

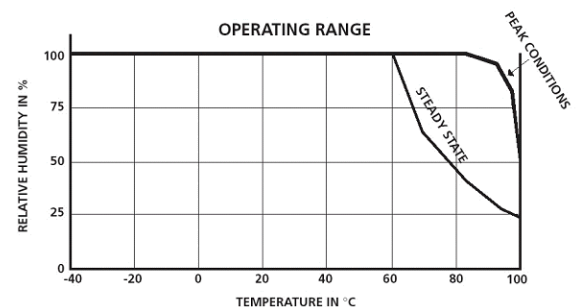

Electrical characteristics

 (@T=23°C, @V_{cc}=5V, R_L>1MΩ unless otherwise noted)

| Characteristics | Symbol | Min | Typ | Max | Unit |
|---|------------------|------|-------|------|-----------------|
| Humidity Measuring Range | RH | 0 | | 100 | %RH |
| Relative Humidity Accuracy (10% to 95%RH) | | | ±3 | ±5 | %RH |
| Voltage Supply* | V _{cc} | 4.75 | 5 | 5.25 | V _{dc} |
| Nominal Output @55%RH | V _{out} | 2.42 | 2.48 | 2.54 | V |
| Current Consumption | I _{cc} | | 2.8 | 4 | mA |
| Temperature coefficient (10 to 50°C) | T _{cc} | | -0.05 | -0.1 | %RH/°C |
| Humidity Average Sensitivity | ΔmV/RH | | +26 | | mV/%RH |
| NTC nominal output @25°C / Tolerance +/-3% | R | 9.7 | 10 | 10.3 | kΩ |
| Recovery time after 150 hours of condensation | t | | 10 | | s |
| Humidity hysteresis | | | +/-1 | | %RH |
| Output impedance | Z | | 70 | | Ω |
| Sink current capability (R _L = 33 kOhms) | I | | | 150 | μA |
| Warm up time | t _w | | 200 | | ms |
| Humidity Resolution | | | 0.4 | | %RH |

Advance Information
Measurement Conditions

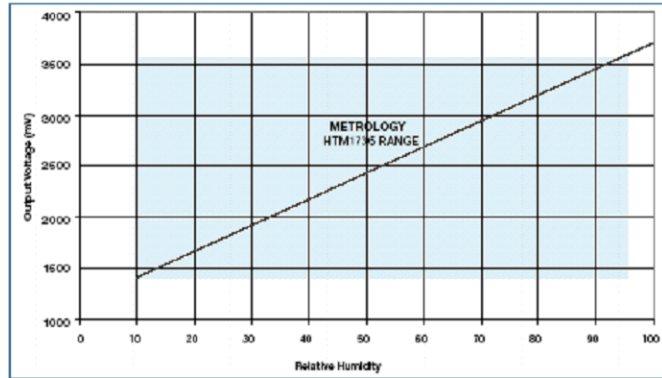
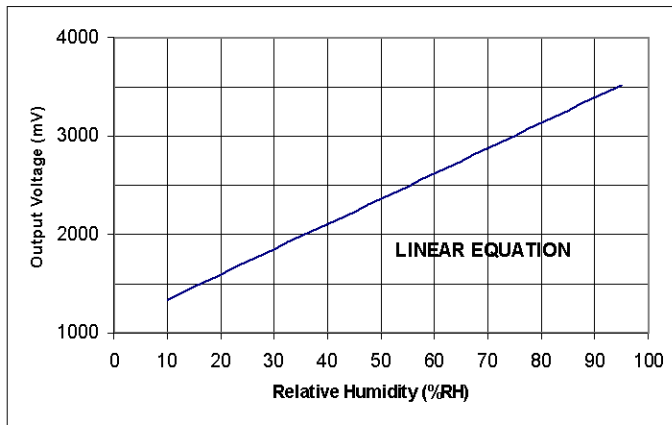
- HTM1735 is specified for accurate measurements within 10 to 95 %RH.
- Excursion out of this range (< 10% or > 95% RH, including condensation) does not affect the reliability of HTM1735 characteristics

HTM1735 Modeled Linear Voltage Output (Vcc=5V)

Reference Output Values

| RH (%) | Vout (mV) | RH (%) | Vout (mV) |
|--------|-----------|--------|-----------|
| 10 | 1325 | 55 | 2480 |
| 15 | 1465 | 60 | 2605 |
| 20 | 1600 | 65 | 2730 |
| 25 | 1735 | 70 | 2860 |
| 30 | 1860 | 75 | 2990 |
| 35 | 1990 | 80 | 3125 |
| 40 | 2110 | 85 | 3260 |
| 45 | 2235 | 90 | 3405 |
| 50 | 2360 | 95 | 3555 |

LINEAR EQUATION

$$V_{out} = 25.68RH + 1079$$

$$RH = 0.03892 V_{out} - 41.98$$

with V_{out} in mV and RH in %

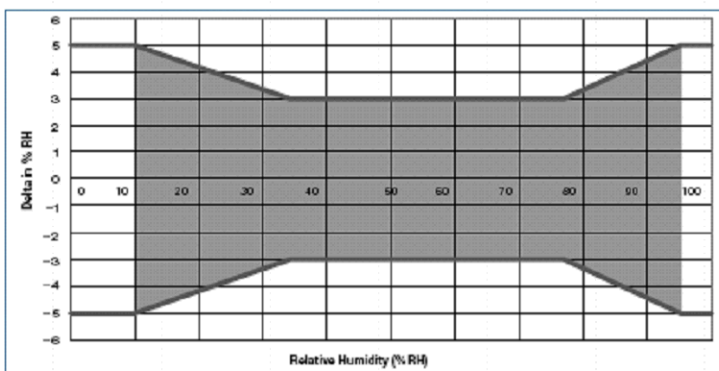
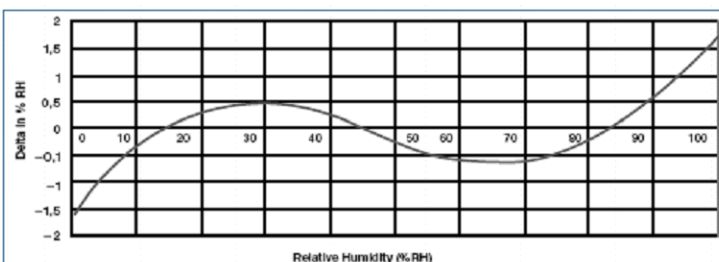
Error Budget Conditions and Linearity Error

HTM1735 ERROR LIMITS

HTM1735 LINEARITY ERRORS

Advance Information
CHARACTERISTICS
Temperature sensor (T_a = 25°C)

| Characteristics | Symbol | Min. | Typ. | Max. | Unit. |
|------------------------------|----------------|------|------|------|-------|
| Nominal resistance @ 25°C | | | 10 | | kΩ |
| Beta value : B25/100 | B | 3600 | 3730 | 3800 | |
| Temperature measuring range | T _a | - 30 | | 80 | °C |
| Nominal Resistance Tolerance | R _n | | 2 | 3 | % |
| B value tolerance | B | | 3 | | % |
| Response Time | τ | | 10 | | s |

Typical temperature output

Depending on the needed temperature measurement range and associated accuracy, we suggest two methods to access to the NTC resistance values.

$$R_T = R_n \times e^{B \left(\frac{1}{T} - \frac{1}{T_n} \right)}$$

R_T NTC resistance in Ω at temperature T in K

R_n NTC resistance in Ω at rated temperature in K

T, T_n Temperature in K

B B value, material-specific constant of the NTC thermistor

e Base of natural logarithm (e = 2.71828)

The actual characteristic of an NTC thermistor can, however, only be roughly described by the exponential relation, as the material parameter B in reality also depends on temperature. So this approach is only suitable for describing a restricted range around the rated temperature or resistance with sufficient accuracy.

② For practical applications a more precise description of the real R/T curve may be required. Either more complicated approaches (e.g. the Steinhart-Hart equation) are used or the resistance/temperature relation as given in tabulated form. The below table has been experimentally determined with utmost accuracy for temperature increments of 1 degree.

| Temperature °C | Resistance (ohm) | Max. Deviation | Temperature °C | Resistance (ohm) | Max. Deviation | Temperature °C | Resistance (ohm) | Max. Deviation | Temperature °C | Resistance (ohm) | Max. Deviation |
|----------------|------------------|----------------|----------------|------------------|----------------|----------------|------------------|----------------|----------------|------------------|----------------|
| -30 | 144790 | 16636 | -2 | 33100 | 2230 | 26 | 9600 | 300 | 54 | 3360 | 213 |
| -29 | 136664 | 15444 | -1 | 31557 | 2078 | 27 | 9218 | 300 | 55 | 3237 | 208 |
| -28 | 129054 | 14343 | 0 | 30029 | 1932 | 28 | 8853 | 299 | 56 | 3126 | 204 |
| -27 | 121925 | 13325 | 1 | 28627 | 1799 | 29 | 8506 | 297 | 57 | 3019 | 200 |
| -26 | 115243 | 12383 | 2 | 27299 | 1675 | 30 | 8178 | 296 | 58 | 2917 | 197 |
| -25 | 109030 | 11516 | 3 | 26042 | 1560 | 31 | 7866 | 294 | 59 | 2819 | 193 |
| -24 | 103115 | 10705 | 4 | 24852 | 1452 | 32 | 7568 | 292 | 60 | 2720 | 189 |
| -23 | 97565 | 9953 | 5 | 23773 | 1355 | 33 | 7283 | 290 | 61 | 2629 | 185 |
| -22 | 92354 | 9257 | 6 | 22708 | 1261 | 34 | 7011 | 287 | 62 | 2542 | 182 |
| -21 | 87460 | 8612 | 7 | 21698 | 1174 | 35 | 6734 | 284 | 63 | 2458 | 178 |
| -20 | 82923 | 8020 | 8 | 20739 | 1093 | 36 | 6484 | 281 | 64 | 2378 | 175 |
| -19 | 78581 | 7463 | 9 | 19829 | 1017 | 37 | 6244 | 278 | 65 | 2304 | 171 |
| -18 | 74497 | 6947 | 10 | 18959 | 946 | 38 | 6015 | 275 | 66 | 2229 | 168 |
| -17 | 70655 | 6468 | 11 | 18128 | 879 | 39 | 5796 | 271 | 67 | 2158 | 165 |
| -16 | 67039 | 6023 | 12 | 17338 | 817 | 40 | 5575 | 267 | 68 | 2089 | 161 |
| -15 | 63591 | 5606 | 13 | 16588 | 759 | 41 | 5373 | 264 | 69 | 2022 | 158 |
| -14 | 60381 | 5222 | 14 | 15876 | 705 | 42 | 5180 | 260 | 70 | 1960 | 155 |
| -13 | 57356 | 4865 | 15 | 15207 | 654 | 43 | 4995 | 257 | 71 | 1898 | 152 |
| -12 | 54503 | 4533 | 16 | 14569 | 607 | 44 | 4817 | 253 | 72 | 1839 | 149 |
| -11 | 51813 | 4225 | 17 | 13962 | 563 | 45 | 4636 | 248 | 73 | 1782 | 146 |
| -10 | 49204 | 3932 | 18 | 13384 | 522 | 46 | 4473 | 245 | 74 | 1727 | 143 |
| -9 | 46767 | 3662 | 19 | 12834 | 484 | 47 | 4316 | 241 | 75 | 1673 | 140 |
| -8 | 44467 | 3411 | 20 | 12280 | 447 | 48 | 4166 | 237 | 76 | 1622 | 138 |
| -7 | 42296 | 3177 | 21 | 11777 | 413 | 49 | 4021 | 233 | 77 | 1573 | 135 |
| -6 | 40247 | 2960 | 22 | 11297 | 382 | 50 | 3874 | 229 | 78 | 1526 | 132 |
| -5 | 38279 | 2756 | 23 | 10840 | 353 | 51 | 3737 | 225 | 79 | 1480 | 130 |
| -4 | 36455 | 2568 | 24 | 10404 | 325 | 52 | 3606 | 221 | 80 | 1432 | 127 |
| -3 | 34731 | 2393 | 25 | 10000 | 300 | 53 | 3481 | 217 | | | |

Advance Information
Resistance to physical and chemical stresses

- HTM1735 has passed through qualification processes of HUMIREL including vibration, shock, storage, high temperature and humidity.
- HTM1735 contains circuits to protect its inputs and outputs against Electrostatic discharges (ESD) up to $\pm 15\text{kV}$, air discharge.
- Additional tests under harsh chemical conditions demonstrate good operation in presence of salt atmosphere, SO_2 (0.5%), H_2S (0.5%), O_3 , NO_x , NO , CO , CO_2 , Softener, Soap, Toluene, acids (H_2SO_4 , HNO_3 , HCl), HMDS, Insecticide, Cigarette smoke, a non exhaustive list.
- HTM1735 is not light sensitive.

Specific Precaution

- HTM1735 is not protected against reversed polarity - Check carefully when connecting the device.

Pin Out Assignment and Package Outline
Pin Out Assignment

| Pin | Function |
|-----|----------------------|
| 1 | NTC - Temperature |
| 2 | Ground |
| 3 | Vcc - Voltage supply |
| 4 | Vout - Humidity |

HTM1735 STD Package Outline
Package Outline

| Dim | Min (mm) | Max (mm) |
|-----|---------------|----------|
| A | 34 | 36 |
| B | 12.5 | 13.5 |
| C | 30.25 Typical | |
| D | 5.08 Typical | |
| E | 13.1 Typical | |

Footprint Outline

| Dim | Min (mm) | Max (mm) |
|-----|----------------------------|----------|
| A | 34 | 36 |
| B | 12.5 | 13.5 |
| D | 5.08 Typical | |
| F | 2.36 Typical | |
| G | 3.94 Typical | |
| H | $\varnothing 1.02$ Typical | |

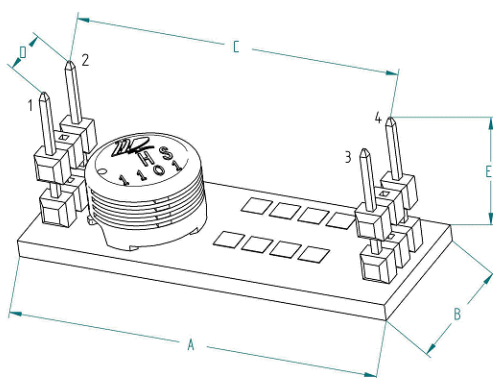
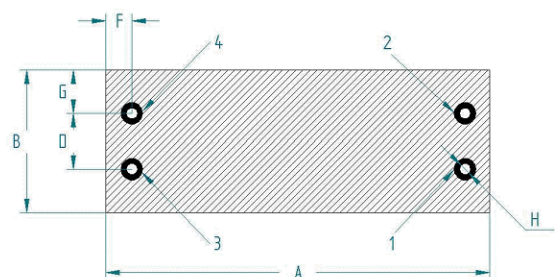
3D VIEW

FOOT PRINT (TOPVIEW)

Advance Information
HTM1735 SMD Package Outline
Package Outline

| Dim | Min (mm) | Max (mm) |
|-----|---------------|----------|
| A | 34 | 36 |
| B | 12.5 | 13.5 |
| C | 30.25 Typical | |
| D | 5.08 Typical | |
| E | 6.65 Typical | |

Footprint Outline

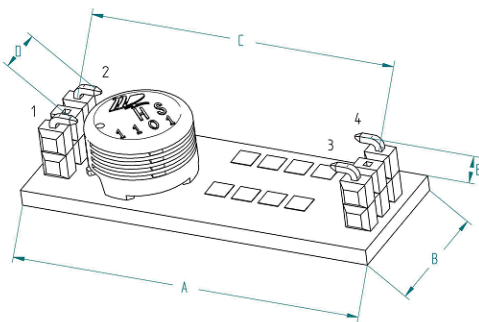
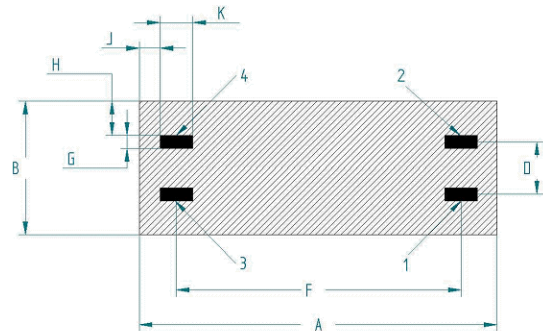
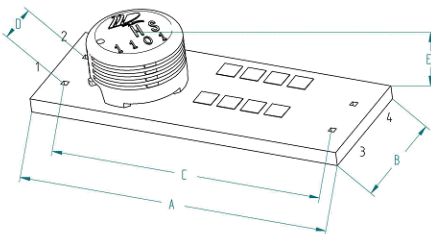
| Dim | Min (mm) | Max (mm) |
|-----|---------------|----------|
| F | 27.81 Typical | |
| G | 1.27 Typical | |
| H | 3.33 Typical | |
| J | 2.04 Typical | |
| K | 3.18 Typical | |

3D VIEW

FOOT PRINT (TOPVIEW)

HTM1735 SR Package Outline

3D View
Package Outline

| Dim | Min (mm) | Max (mm) |
|-----|---------------|----------|
| A | 34 | 36 |
| B | 12.5 | 13.5 |
| C | 30.25 Typical | |
| D | 5.08 Typical | |
| E | 6.2 Typical | |

ORDERING INFORMATION:
HPP805D033 for HTM1735 STD (through hole board to board connection)
HPP805D034 for HTM1735 SR (with holes for customized wiring)
HPP805D035 for HTM1735 SMD (SMD board to board connection)

Note: HTM1735 series replace HTM1505 series and are fully compatible with mechanical, electrical and metrological specifications.

The information in this sheet has been carefully reviewed and is believed to be accurate; however, no responsibility is assumed for inaccuracies. Furthermore, this information does not convey to the purchaser of semiconductor devices any license under the patent rights to the manufacturer. Humirel reserves the right to make changes without further notice to any product herein. Humirel makes no warranty, representation of guarantee regarding the suitability of its product for any particular purpose, nor does Humirel assume any liability arising out of the application or use of any product or circuit and specifically disclaims any and all liability, including without limitation consequential or incidental damages. « Typical » parameters can and do vary in different applications. All operating parameters, including « Typical » must be validated for each customer applications by customer's technical experts. Humirel does not convey any license under its patent rights nor the rights of others. Humirel products are not designed, intended, or authorized for use as components in systems intended for surgical implant into the body, or other application intended to support or sustain life, or for any application in which the failure of the Humirel product could create a situation where personal injury or death may occur. Should buyer purchase or use Humirel products for any such unintended or unauthorized application, Buyer shall indemnify and hold Humirel and its officers, employees, subsidiaries, affiliates and distributors harmless against all claims, costs, damages and expenses, and reasonable attorney fees arising out of, directly or indirectly, any claim of personal injury or death associated with such unintended or unauthorized use, even if claim alleges that Humirel was negligent regarding the design or manufacture of the part. Humirel is a registered trade mark of Humirel.

email: sales@humirel.com

Данный компонент на территории Российской Федерации

Вы можете приобрести в компании MosChip.

Для оперативного оформления запроса Вам необходимо перейти по данной ссылке:

<http://moschip.ru/get-element>

Вы можете разместить у нас заказ для любого Вашего проекта, будь то серийное производство или разработка единичного прибора.

В нашем ассортименте представлены ведущие мировые производители активных и пассивных электронных компонентов.

Нашей специализацией является поставка электронной компонентной базы двойного назначения, продукции таких производителей как XILINX, Intel (ex.ALTERA), Vicor, Microchip, Texas Instruments, Analog Devices, Mini-Circuits, Amphenol, Glenair.

Сотрудничество с глобальными дистрибьюторами электронных компонентов, предоставляет возможность заказывать и получать с международных складов практически любой перечень компонентов в оптимальные для Вас сроки.

На всех этапах разработки и производства наши партнеры могут получить квалифицированную поддержку опытных инженеров.

Система менеджмента качества компании отвечает требованиям в соответствии с ГОСТ Р ИСО 9001, ГОСТ РВ 0015-002 и ЭС РД 009

Офис по работе с юридическими лицами:

105318, г.Москва, ул.Щербаковская д.3, офис 1107, 1118, ДЦ «Щербаковский»

Телефон: +7 495 668-12-70 (многоканальный)

Факс: +7 495 668-12-70 (доб.304)

E-mail: info@moschip.ru

Skype отдела продаж:

moschip.ru

moschip.ru_4

moschip.ru_6

moschip.ru_9