

**Features**

- Epitaxial Planar Die Construction
- Complementary PNP Type Available (2DB1188)
- Ideally Suited for Automated Assembly Processes
- Ideal for Medium Power Switching or Amplification Applications
- **Lead Free By Design/RoHS Compliant (Note 1)**
- **"Green" Device (Note 2)**

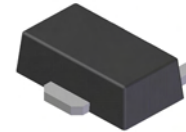

SOT89-3L

**Mechanical Data**

- Case: SOT89-3L
- Case Material: Molded Plastic, "Green" Molding Compound. UL Flammability Classification Rating 94V-0
- Moisture Sensitivity: Level 1 per J-STD-020C
- Terminals: Finish — Matte Tin annealed over Copper leadframe (Lead Free Plating). Solderable per MIL-STD-202, Method 208
- Marking & Type Code Information: See Page 3
- Ordering Information: See Page 3
- Weight: 0.072 grams (approximate)

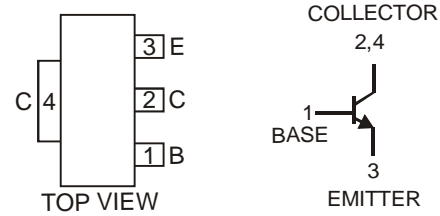

Schematic and Pin Configuration

**Maximum Ratings** @T<sub>A</sub> = 25°C unless otherwise specified

| Characteristic               | Symbol           | Value | Unit |
|------------------------------|------------------|-------|------|
| Collector-Base Voltage       | V <sub>CB0</sub> | 40    | V    |
| Collector-Emitter Voltage    | V <sub>CEO</sub> | 32    | V    |
| Emitter-Base Voltage         | V <sub>EBO</sub> | 5     | V    |
| Peak Pulse Current           | I <sub>CM</sub>  | 2.5   | A    |
| Continuous Collector Current | I <sub>C</sub>   | 2     | A    |

**Thermal Characteristics**

| Characteristic   | Symbol                            | Value       | Unit |
|--|-----------------------------------|-------------|------|
| Power Dissipation (Note 3) @ T <sub>A</sub> = 25°C                           | P <sub>D</sub>                    | 1           | W    |
| Thermal Resistance, Junction to Ambient Air (Note 3) @ T <sub>A</sub> = 25°C | R <sub>θJA</sub>                  | 125         | °C/W |
| Operating and Storage Temperature Range                                      | T <sub>j</sub> , T <sub>STG</sub> | -55 to +150 | °C   |

**Electrical Characteristics** @T<sub>A</sub> = 25°C unless otherwise specified

| Characteristic                       | Symbol               | Min      | Typ | Max | Unit | Conditions   |
|--------------------------------------|----------------------|----------|-----|-----|------|--|
| <b>OFF CHARACTERISTICS (Note 4)</b>  |                      |          |     |     |      |  |
| Collector-Base Breakdown Voltage     | V <sub>(BR)CBO</sub> | 40       | —   | —   | V    | I <sub>C</sub> = 50μA, I <sub>E</sub> = 0                |
| Collector-Emitter Breakdown Voltage  | V <sub>(BR)CEO</sub> | 32       | —   | —   | V    | I <sub>C</sub> = 1mA, I <sub>B</sub> = 0                 |
| Emitter-Base Breakdown Voltage       | V <sub>(BR)EBO</sub> | 5        | —   | —   | V    | I <sub>E</sub> = 50μA, I <sub>C</sub> = 0                |
| Collector Cut-Off Current            | I <sub>CBO</sub>     | —        | —   | 1   | μA   | V <sub>CB</sub> = 20V, I <sub>E</sub> = 0                |
| Emitter Cut-Off Current              | I <sub>EBO</sub>     | —        | —   | 1   | μA   | V <sub>EB</sub> = 4V, I <sub>C</sub> = 0                 |
| <b>ON CHARACTERISTICS (Note 4)</b>   |                      |          |     |     |      |  |
| Collector-Emitter Saturation Voltage | V <sub>CE(SAT)</sub> | —        | 0.3 | 0.8 | V    | I <sub>C</sub> = 2A, I <sub>B</sub> = 0.2A               |
| DC Current Gain                      | h <sub>FE</sub>      | 2DD1766P | 82  | —   | 180  | V <sub>CE</sub> = 3V, I <sub>C</sub> = 0.5A              |
|                                      |                      | 2DD1766Q | 120 | —   | 270  |  |
|                                      |                      | 2DD1766R | 180 | —   | 390  |  |
| <b>SMALL SIGNAL CHARACTERISTICS</b>  |                      |          |     |     |      |  |
| Transition Frequency                 | f <sub>T</sub>       | —        | 220 | —   | MHz  | V <sub>CE</sub> = 5V, I <sub>E</sub> = -50mA, f = 100MHz |
| Output Capacitance                   | C <sub>ob</sub>      | —        | 13  | —   | pF   | V <sub>CB</sub> = 10V, I <sub>E</sub> = 0, f = 1MHz      |

- Notes:
1. No purposefully added lead.
  2. Diodes Inc.'s "Green" policy can be found on our website at [http://www.diodes.com/products/lead\\_free/index.php](http://www.diodes.com/products/lead_free/index.php).
  3. Device mounted on FR-4 PCB; pad layout as shown on page 4 or in Diodes Inc. suggested pad layout document AP02001, which can be found on our website at <http://www.diodes.com/datasheets/ap02001.pdf>.
  4. Measured under pulsed conditions. Pulse width = 300μs. Duty cycle ≤2%.

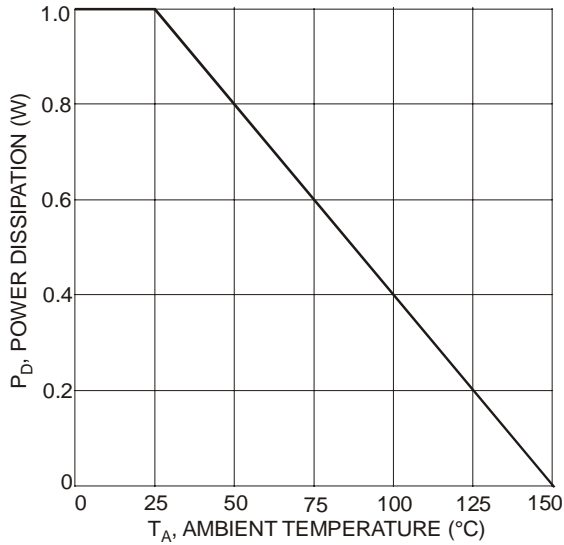

Fig. 1 Power Dissipation vs. Ambient Temperature (Note 3)

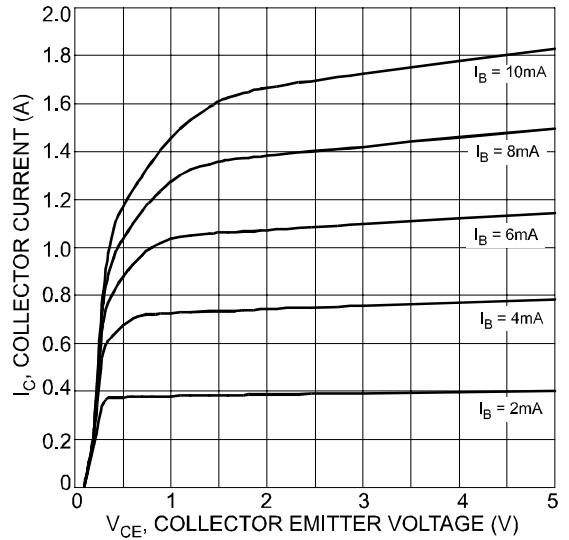

Fig. 2 Typical Collector Current vs. Collector-Emitter Voltage

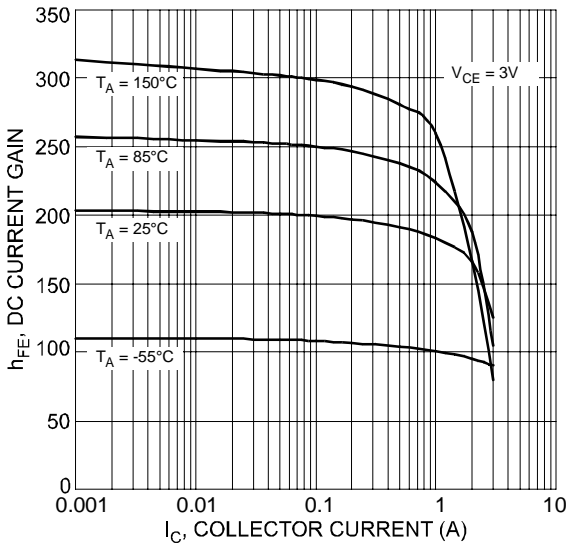

Fig. 3 Typical DC Current Gain vs. Collector Current (2DD1766Q)

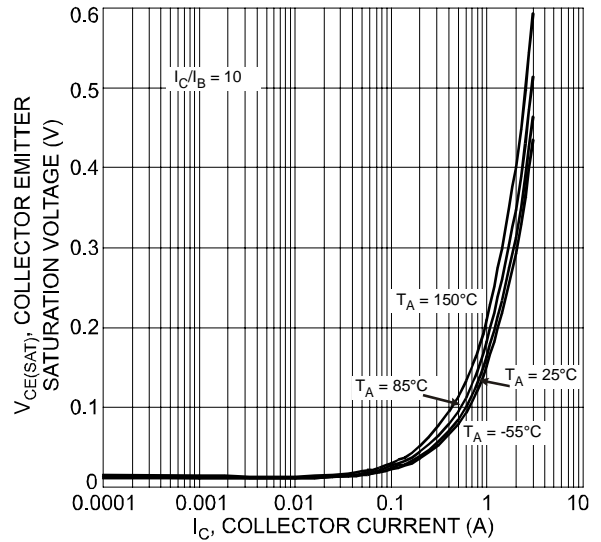

Fig. 4 Typical Collector-Emitter Saturation Voltage vs. Collector Current

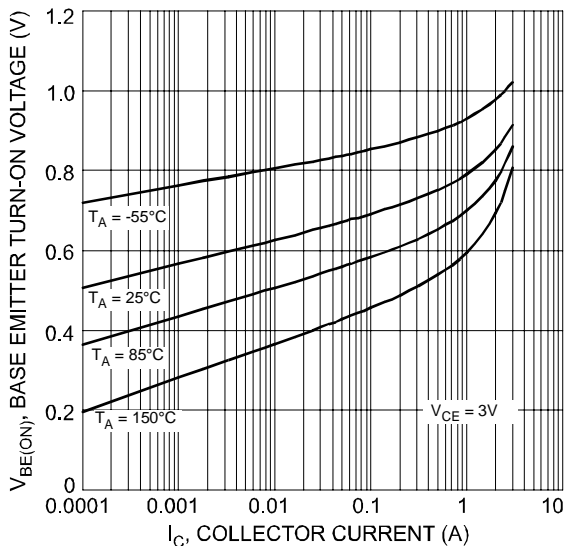

Fig. 5 Typical Base-Emitter Turn-On Voltage vs. Collector Current

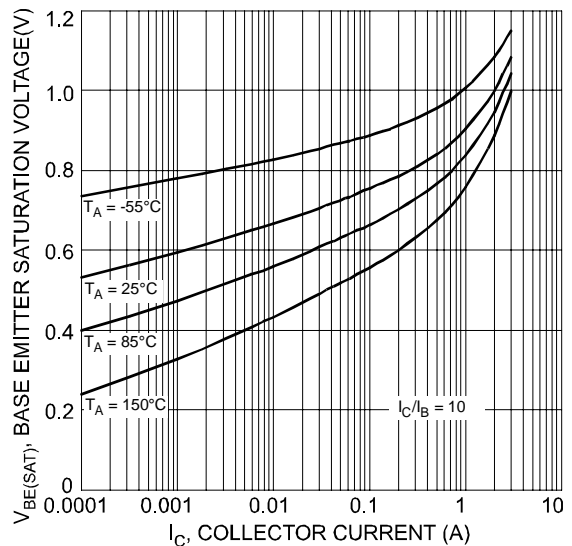

Fig. 6 Typical Base-Emitter Saturation Voltage vs. Collector Current

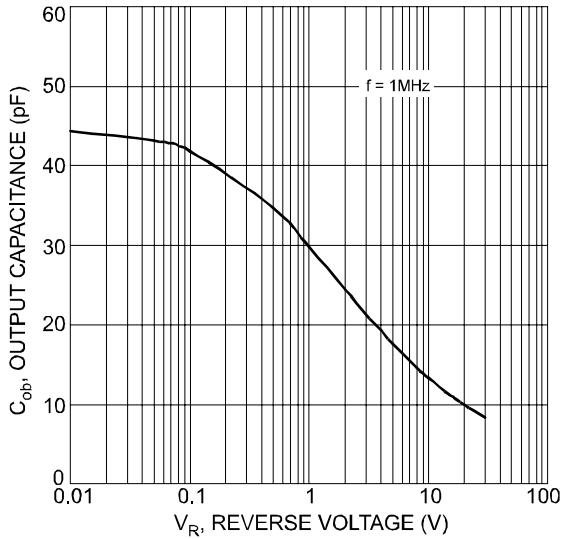

Fig. 7 Typical Output Capacitance Characteristics

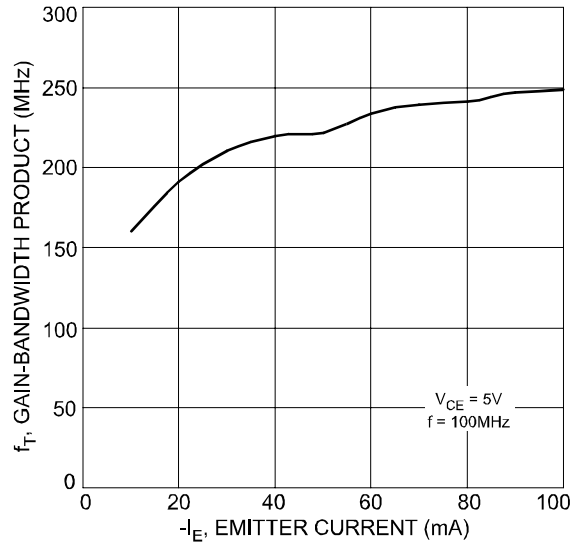

Fig. 8 Typical Gain-Bandwidth Product vs. Emitter Current

## Ordering Information (Note 5)

| Device      | Packaging | Shipping         |
|-------------|-----------|------------------|
| 2DD1766P-13 | SOT89-3L  | 2500/Tape & Reel |
| 2DD1766Q-13 | SOT89-3L  | 2500/Tape & Reel |
| 2DD1766R-13 | SOT89-3L  | 2500/Tape & Reel |

Notes: 5. For packaging details, go to our website at <http://www.diodes.com/ap02007.pdf>.

## Marking Information

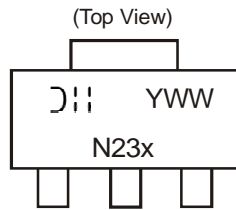

N23x = Product Type Marking Code:  
 Where N23P = 2DD1766P  
 N23Q = 2DD1766Q  
 N23R = 2DD1766R  
 YWW = Date Code Marking  
 Y = Last digit of year ex: 7 = 2007  
 WW = Week code 01 - 52

## Package Outline Dimensions

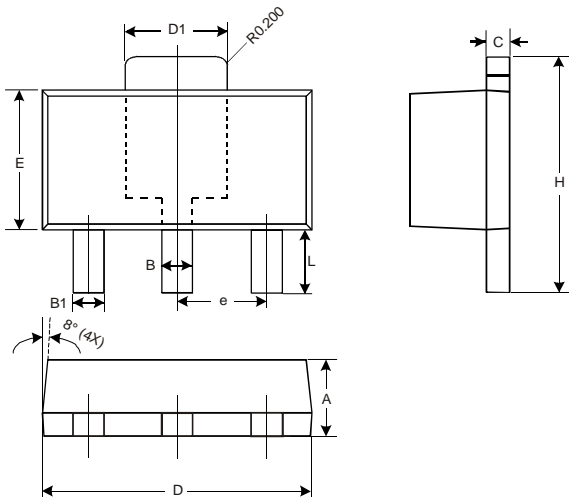

| SOT89-3L             |      |      |      |
|----------------------|------|------|------|
| Dim                  | Min  | Max  | Typ  |
| A                    | 1.40 | 1.60 | 1.50 |
| B                    | 0.45 | 0.55 | 0.50 |
| B1                   | 0.37 | 0.47 | 0.42 |
| C                    | 0.35 | 0.43 | 0.38 |
| D                    | 4.40 | 4.60 | 4.50 |
| D1                   | 1.50 | 1.70 | 1.60 |
| E                    | 2.40 | 2.60 | 2.50 |
| e                    | —    | —    | 1.50 |
| H                    | 3.95 | 4.25 | 4.10 |
| L                    | 0.90 | 1.20 | 1.05 |
| All Dimensions in mm |      |      |      |

## Suggested Pad Layout

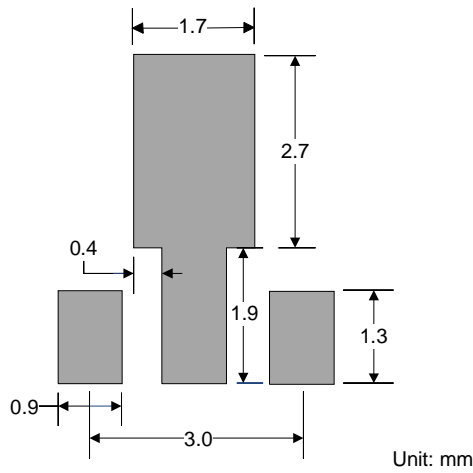

Unit: mm

### IMPORTANT NOTICE

Diodes Incorporated and its subsidiaries reserve the right to make modifications, enhancements, improvements, corrections or other changes without further notice to any product herein. Diodes Incorporated does not assume any liability arising out of the application or use of any product described herein; neither does it convey any license under its patent rights, nor the rights of others. The user of products in such applications shall assume all risks of such use and will agree to hold Diodes Incorporated and all the companies whose products are represented on our website, harmless against all damages.

### LIFE SUPPORT

Diodes Incorporated products are not authorized for use as critical components in life support devices or systems without the expressed written approval of the President of Diodes Incorporated.

## Данный компонент на территории Российской Федерации

### Вы можете приобрести в компании MosChip.

Для оперативного оформления запроса Вам необходимо перейти по данной ссылке:

<http://moschip.ru/get-element>

Вы можете разместить у нас заказ для любого Вашего проекта, будь то серийное производство или разработка единичного прибора.

В нашем ассортименте представлены ведущие мировые производители активных и пассивных электронных компонентов.

Нашей специализацией является поставка электронной компонентной базы двойного назначения, продукции таких производителей как XILINX, Intel (ex.ALTERA), Vicor, Microchip, Texas Instruments, Analog Devices, Mini-Circuits, Amphenol, Glenair.

Сотрудничество с глобальными дистрибьюторами электронных компонентов, предоставляет возможность заказывать и получать с международных складов практически любой перечень компонентов в оптимальные для Вас сроки.

На всех этапах разработки и производства наши партнеры могут получить квалифицированную поддержку опытных инженеров.

Система менеджмента качества компании отвечает требованиям в соответствии с ГОСТ Р ИСО 9001, ГОСТ РВ 0015-002 и ЭС РД 009

### Офис по работе с юридическими лицами:

105318, г.Москва, ул.Щербаковская д.3, офис 1107, 1118, ДЦ «Щербаковский»

Телефон: +7 495 668-12-70 (многоканальный)

Факс: +7 495 668-12-70 (доб.304)

E-mail: [info@moschip.ru](mailto:info@moschip.ru)

Skype отдела продаж:

moschip.ru

moschip.ru\_4

moschip.ru\_6

moschip.ru\_9