

# Multi-Turn Precision Potentiometer

## Model 7380 Series



### Features:

- 7/8" diameter
- 3-turn
- Wirewound



## Model Styles

|   |                          |
|---|--------------------------|
| 7381                                    | 1/8" Shaft, 1/4" Bushing |
| 7383                                    | 1/8" Shaft, Servo        |
| 7386                                    | 1/4" Shaft, 3/8" Bushing |
| 7388 (for heavy side load applications) | 1/4" Shaft, 3/8" Bushing |

## Electrical

|   |  |
|---|--|
| Resistance Range                        | 100 to 30K ohms  |
| Standard Resistance Tolerance           | ±5%  |
| Minimum Practical Resistance Tolerance  | ±1%  |
| Independent Linearity <sup>2</sup>      | ±0.30% (<500 ohms), ±0.25% (≥500 ohms)                 |
| Minimum Practical Independent Linearity | ±0.30% (<500 ohms), ±0.20% (≥500 ohms)                 |
| Power Rating                            | 1.5 Watts at 70°C, derating to 0 at 125°C              |
| Dielectric Strength                     | 1,000 V rms  |
| Insulation Resistance                   | 1,000 Megohms minimum                                  |
| Noise                                   | 100 ohms maximum                                       |
| Actual Electrical Travel                | 1080° +10° -0° (>100 ohms), 1080° +10° -5° (≤100 ohms) |
| End Voltage                             | maximum 0.25% of input voltage                         |
| Tap Tolerance                           | ±3°  |

## Environmental

|  |   |
|--|---|
| Operating Temperature Range                    | -40°C to +125°C dynamic, -55°C to +125°C static                       |
| Temperature Cycling                            | 5 cycles, -55°C to +125°C, maximum 5% ΔR                              |
| Shock  | 6 ms Saw-tooth, 100 G's, 0.1 ms maximum discontinuity                 |
| Vibration                                      | 15 G's, 10 to 2,000 Hz, maximum 5% ΔR, 0.1 ms maximum discontinuity   |
| Moisture Resistance                            | Five 24 hour cycles, maximum 3% ΔR                                    |
| High Temperature Exposure                      | 1,000 hours at 125°C, maximum 5% ΔR                                   |
| Rotational Load Life (1 lb side load for 7388) | 300K shaft revolutions + 900 hours at 1.5 Watts & 70°C, maximum 5% ΔR |
| Ingress Protection Rating (IP Code)            | IP50, IP66 available as option (feature code ES)                      |

### General Note

TT Electronics reserves the right to make changes in product specification without notice or liability. All information is subject to TT Electronics' own data and is considered accurate at time of going to print.

© TT electronics plc

TT Electronics | BI Technologies  
413 Rood RD, Suite 7  
Calexico, CA 92231  
Ph: +1 714 447 2345  
[www.ttelectronics.com/bi-technologies](http://www.ttelectronics.com/bi-technologies)

# Multi-Turn Precision Potentiometer

## Model 7380 Series



### Mechanical

|   |                   |                           |
|---|-------------------|---------------------------|
| Total Mechanical Travel                                 |                   | 1080° +15° -0°            |
| Number of Gangs   |                   | 2 maximum                 |
| Weight (single gang)                                    |                   | 0.75 oz. nominal          |
| Backlash  |                   | 1° maximum                |
|   | <b>7381, 7386</b> | <b>7383</b>               |
| Static Stop Strength                                    | maximum           | 48 oz.-in. / 36 oz.-in.   |
| Panel Nut Tightening Torque                             | maximum           | 25 lb.-in. / n/a          |
| Shaft End Play  | maximum           | 0.010" / 0.005"           |
| Shaft Runout  | maximum T.I.R.    | 0.003" / 0.002"           |
| Pilot Diameter Runout                                   | maximum T.I.R.    | 0.004" / 0.002"           |
| Lateral Runout  | maximum T.I.R.    | 0.005" / 0.004"           |
| Shaft Radial Play                                       | maximum           | 0.003" / 0.002"           |
| Start/Run Torque (per gang, ES option adds 0.5 oz.-in.) | maximum           | 1.2 oz.-in. / 0.9 oz.-in. |

### Ordering Information

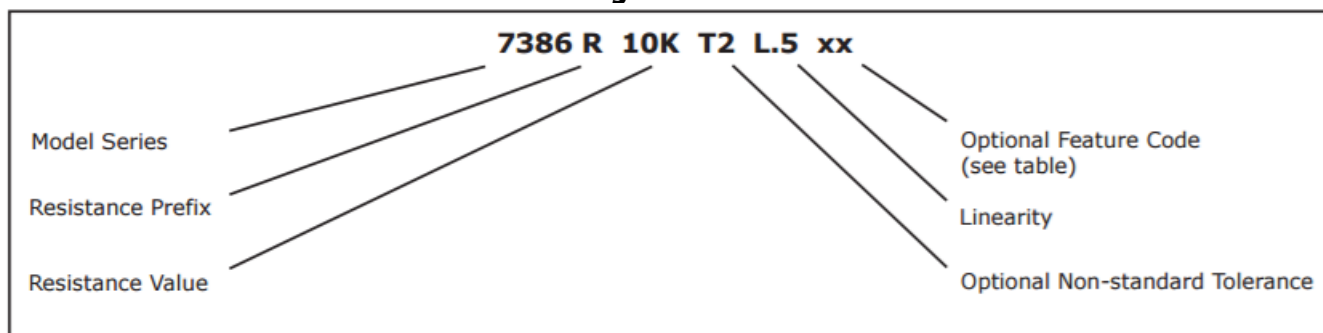

#### FEATURE CODES

|  |    |
|--|----|
| Center Tap   | CT |
| Linearity Tape   | LT |
| Flatted Shaft  | FS |
| Slotted Shaft (standard on single cup 7386 without RS feature)         | SS |
| Rear Shaft Extension (7381, 7386 single cup only)                      | RS |
| Shaft Lock (7386 only)   | SL |
| High Torque 2-6 oz.-in. (7386 only)                                    | HT |
| Additional Gang  | 2G |
| Gold Plated Solder Lug Terminals (see optional terminal configuration) | FT |
| Seal (IP66) 7386 or 7388 only  | ES |

When multiple Feature codes are used the P/N shall be in the same sequence as listed in this table (top to bottom).

#### STANDARD RESISTANCE VALUES

| Total Resistance (Ohms) | Theoretical Resolution (% nominal) | Tempco of wire (ppm/°C) |
|-------------------------|------------------------------------|-------------------------|
| 100                     | 0.059                              | ±20                     |
| 200                     | 0.037                              | ±20                     |
| 500                     | 0.030                              | ±20                     |
| 1K                      | 0.024                              | ±20                     |
| 2K                      | 0.020                              | ±20                     |
| 5K                      | 0.018                              | ±20                     |
| 10K                     | 0.017                              | ±20                     |
| 20K                     | 0.016                              | ±20                     |

#### General Note

TT Electronics reserves the right to make changes in product specification without notice or liability. All information is subject to TT Electronics' own data and is considered accurate at time of going to print.

# Multi-Turn Precision Potentiometer

## Model 7380 Series



### CIRCUIT DIAGRAM



### MATCHING TURNS COUNTING DIALS

**7381: RBJ, 2601, 2641**

**7386: RB, 2126, 2606, 2606S, 2607, 2607S, 2626, 2627, 2646, 2646S, 2647, 2647S**

### OUTLINE DRAWINGS

**Models 7381 & 7386**  
**Bushing Mount with Sleeve Bearing**

| Dim. | 7381   | 7386   |
|------|--|--|
| A    | $\frac{.688 \pm .013}{17.475 \pm 0.787}$         | $\frac{.812 \pm .031}{20.625 \pm 0.787}$         |
| B    | $\frac{.1248 \pm .0000}{3.1699 \pm 0.0076}$ Dia. | $\frac{.2500 \pm .0000}{6.3500 \pm 0.0127}$ Dia. |
| C    | $\frac{.281 \pm .000}{7.137 \pm 0.051}$ Dia.     | $\frac{.406 \pm .000}{10.312 \pm 0.051}$ Dia.    |
| D    | 1/4-32 UNEF Thread                               | 3/8-32 UNEF Thread                               |

Technical drawing details include:  
 - Mounting Surface  
 - Slider  
 - CCW  
 - CW  
 - Chamfer .016/0.41 Max. x 45°  
 - Slot: .032±.005/0.813±0.127 Wide X .032±.010-.000/0.813±0.254-0.000 Deep (Not on Rear Shaft Models)  
 - 75° Max. angle  
 - .625 R Max. radius  
 - .875±.016 Dia. dimension

General Note  
 TT Electronics reserves the right to make changes in product specification without notice or liability. All information is subject to TT Electronics' own data and is considered accurate at time of going to print.

© TT electronics plc

TT Electronics | BI Technologies  
 413 Rood RD, Suite 7  
 Calexico, CA 92231  
 Ph: +1 714 447 2345  
[www.ttelectronics.com/bi-technologies](http://www.ttelectronics.com/bi-technologies)

# Multi-Turn Precision Potentiometer

## Model 7380 Series



### Optional Terminal Configuration

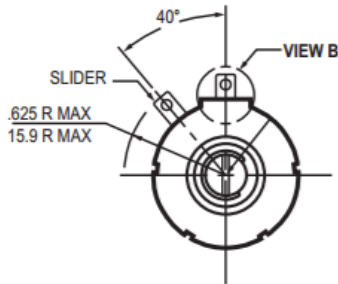

Use Special Feature Code "FT" to order.

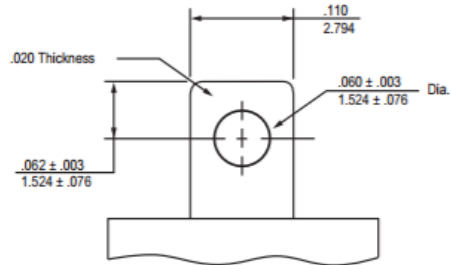

Enlarged View B

### Model 7383 Servo Mount with Ball Bearing

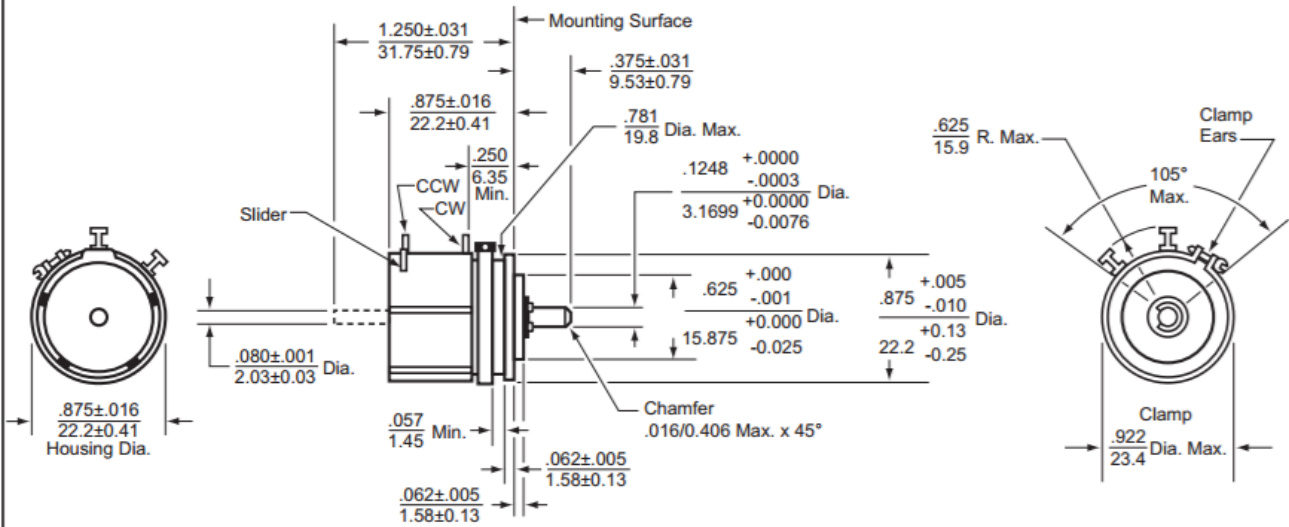

### Optional Terminal Configuration

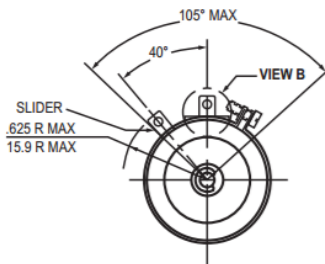

Use Special Feature Code "FT" to order.

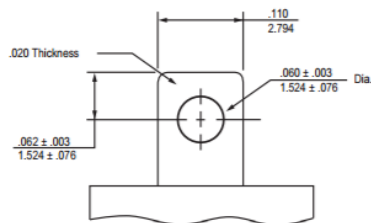

Enlarged View B

#### General Note

TT Electronics reserves the right to make changes in product specification without notice or liability. All information is subject to TT Electronics' own data and is considered accurate at time of going to print.

© TT electronics plc

TT Electronics | BI Technologies  
 413 Rood RD, Suite 7  
 Calexico, CA 92231  
 Ph: +1 714 447 2345  
[www.ttelectronics.com/bi-technologies](http://www.ttelectronics.com/bi-technologies)

## Данный компонент на территории Российской Федерации

### Вы можете приобрести в компании MosChip.

Для оперативного оформления запроса Вам необходимо перейти по данной ссылке:

<http://moschip.ru/get-element>

Вы можете разместить у нас заказ для любого Вашего проекта, будь то серийное производство или разработка единичного прибора.

В нашем ассортименте представлены ведущие мировые производители активных и пассивных электронных компонентов.

Нашей специализацией является поставка электронной компонентной базы двойного назначения, продукции таких производителей как XILINX, Intel (ex.ALTERA), Vicor, Microchip, Texas Instruments, Analog Devices, Mini-Circuits, Amphenol, Glenair.

Сотрудничество с глобальными дистрибьюторами электронных компонентов, предоставляет возможность заказывать и получать с международных складов практически любой перечень компонентов в оптимальные для Вас сроки.

На всех этапах разработки и производства наши партнеры могут получить квалифицированную поддержку опытных инженеров.

Система менеджмента качества компании отвечает требованиям в соответствии с ГОСТ Р ИСО 9001, ГОСТ РВ 0015-002 и ЭС РД 009

### Офис по работе с юридическими лицами:

105318, г.Москва, ул.Щербаковская д.3, офис 1107, 1118, ДЦ «Щербаковский»

Телефон: +7 495 668-12-70 (многоканальный)

Факс: +7 495 668-12-70 (доб.304)

E-mail: [info@moschip.ru](mailto:info@moschip.ru)

Skype отдела продаж:

moschip.ru

moschip.ru\_4

moschip.ru\_6

moschip.ru\_9