

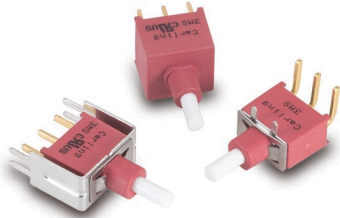

**3MN-Series**  
**Snap-Action** Miniature Pushbutton Switch

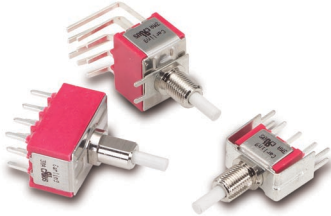

**3MS-Series**  
**Sealed Snap-Action** Miniature Pushbutton Switch



**3MA-Series**  
**Alternate Action** Miniature Pushbutton Switch

### Specifications

Contact Rating . . . . .	refer to ordering scheme
Electrical Life . . . . .	50,000 make & break cycles @ full load
Contact Resistance. . . . .	<i>3MN &amp; 3MA-Series:</i> 10 mΩ max. initial @ 2-4 VDC 100mA for both silver & gold plated contacts. <i>3MS-Series:</i> 50 mΩ max. initial @ 2-4 VDC 100mA for both silver & gold plated contacts.
Insulation Resistance . . .	1000 MΩ min.
Dielectric Strength . . . . .	1500 Volts RMS @ sea level
Operating Temperature . . .	-30°C to +85°C
Index of Protection . . . . .	<i>3MS -Series:</i> IP68
Cap Installation Support . .	<i>3MS-Series:</i> 10 lbs. max.
Solder Heat Resistance. . .	MIL-STD-202, Method 210
Actuator Travel . . . . .	.25°

### Materials

Case . . . . .	<i>3MN &amp; 3MA-Series:</i> Diallyl phthalate (DAP) (UL 94V-0) <i>3MS-Series:</i> Glass filled nylon 6/6, flame retardant, heat stabilized (UL 94V-0)
Plunger. . . . .	<i>3MN-Series:</i> Thermoplastic polyester, black <i>3MS &amp; 3MA-Series:</i> Glass filled nylon or glass filled polyester (UL 94V-0)
Bushing . . . . .	<i>3MN-Series:</i> Brass, nickel plated <i>3MA-Series:</i> Zinc, nickel plated
Housing. . . . .	<i>3MN &amp; 3MA-Series:</i> Stainless Steel
Switch Support Retainer . .	<i>3MS-Series:</i> Stainless Steel
Terminal Seal . . . . .	Epoxy

### 3M-Series Optional Cap

To order a cap assembled on a switch, specify the switch number followed by the cap part number and the word "assembled".

Ex: 3MN-SP-7-P2-B6-M6QE-C13ASSEMBLED

To order caps in bulk, specify the Series, followed by the cap. Ex.) 3MN-C13



<p><b>1 SERIES OR SWITCH CATALOG NUMBER</b> 3MN, 3MS or 3MA</p>	<p><b>3 CAP COLOR</b></p> <table border="0" style="width: 100%;"> <tr> <td>1 white</td> <td>5 yellow</td> </tr> <tr> <td>2 black</td> <td>6 green</td> </tr> <tr> <td>3 red</td> <td>7 blue</td> </tr> <tr> <td>4 orange</td> <td></td> </tr> </table> <p><small>1 Black, white &amp; red standard. Other colors available. Consult factory.</small></p>	1 white	5 yellow	2 black	6 green	3 red	7 blue	4 orange	
1 white	5 yellow								
2 black	6 green								
3 red	7 blue								
4 orange									
<p><b>2 CAP SIZE</b></p> <table border="0" style="width: 100%;"> <tr> <td><b>C1</b> round 7.6mm dia.</td> <td><b>C5</b> round 14.5mm dia.</td> </tr> <tr> <td><b>C2</b> round 9.35 mm dia.</td> <td>(for 3MA w/ PL bushing)</td> </tr> <tr> <td><b>C3</b> square 11.7 x 11.7mm</td> <td><b>C6</b> brass chrome plated</td> </tr> <tr> <td><b>C4</b> round 5mm dia.</td> <td>(for 3MA w/ PD bushing)</td> </tr> </table>	<b>C1</b> round 7.6mm dia.	<b>C5</b> round 14.5mm dia.	<b>C2</b> round 9.35 mm dia.	(for 3MA w/ PL bushing)	<b>C3</b> square 11.7 x 11.7mm	<b>C6</b> brass chrome plated	<b>C4</b> round 5mm dia.	(for 3MA w/ PD bushing)	
<b>C1</b> round 7.6mm dia.	<b>C5</b> round 14.5mm dia.								
<b>C2</b> round 9.35 mm dia.	(for 3MA w/ PL bushing)								
<b>C3</b> square 11.7 x 11.7mm	<b>C6</b> brass chrome plated								
<b>C4</b> round 5mm dia.	(for 3MA w/ PD bushing)								



3MS-Series Ordering Scheme

**3MS** - **WSP** **7** - **P1** - **B1** - **M6** **Q** **E**

1 Series      2 Poles      3 Circuit      4 Actuator      5 Bushing      6 Termination      7 Contact      8 Seal

<b>1 SERIES</b> <b>3MS</b> Sealed Snap-Action Miniature Pushbutton Switch	<b>6 TERMINATION</b>																					
<b>2 POLES</b> <b>WSP</b> single pole <b>WDP</b> double pole	<b>M1</b> Solder Lug <b>M2</b> PCB <b>M6</b> PC Mount, 90° horizontal <b>M61</b> Snap-In, 90° horizontal <b>M7</b> PC Mount, 90° vertical <b>M71</b> Snap-In, 90° vertical <b>VS2</b> PC Mount, U bracket, .620 mounting x .460 high	<b>VS21</b> Snap-In, U bracket, .620 mounting x .460 high <b>VS3</b> PC Mount, U bracket, .620 mounting x .630 high <b>VS4</b> PC Mount, U bracket, .750 mounting x .460 high <b>VS5</b> PC Mount, U bracket, .750 mounting x .630 high																				
<b>3 CIRCUIT</b> ( ) - momentary <b>7</b> ON      (ON)	<b>7 CONTACT</b>																					
<b>4 ACTUATOR</b> <b>P1</b> .173" plunger (for B1 bushing); .276" (for B4 bushing) <b>P2</b> .220" plunger (for B1 bushing); .327" (for B4 bushing) <b>P3</b> .087" plunger (for B1 bushing); .193" (for B4 bushing)	<table border="0"> <thead> <tr> <th></th> <th>Material</th> <th>Terminal Plating</th> <th>Rating</th> <th>Approvals</th> </tr> </thead> <tbody> <tr> <td><b>G</b></td> <td>silver<sup>1</sup></td> <td>gold over silver<sup>3</sup></td> <td>1A@120VAC or 28VDC</td> <td>UL, CUL IP68</td> </tr> <tr> <td><b>Q</b></td> <td>silver<sup>1</sup></td> <td>silver<sup>1</sup></td> <td>1A@120VAC or 28VDC</td> <td>UL, CUL IP68</td> </tr> <tr> <td><b>R</b></td> <td>gold<sup>2</sup></td> <td>gold<sup>2</sup></td> <td>0.4VA max. @20V max (AC/DC)</td> <td>IP68</td> </tr> </tbody> </table> <p>NOTE: Tin-lead option available with PC type terminations only. 1 Moveable contact &amp; terminals: copper alloy, silver plate 2 Moveable contact &amp; terminals: copper alloy with gold plate over nickel plate 3 Terminals: silver plate with outer layer in gold plating</p>			Material	Terminal Plating	Rating	Approvals	<b>G</b>	silver <sup>1</sup>	gold over silver <sup>3</sup>	1A@120VAC or 28VDC	UL, CUL IP68	<b>Q</b>	silver <sup>1</sup>	silver <sup>1</sup>	1A@120VAC or 28VDC	UL, CUL IP68	<b>R</b>	gold <sup>2</sup>	gold <sup>2</sup>	0.4VA max. @20V max (AC/DC)	IP68
	Material	Terminal Plating	Rating	Approvals																		
<b>G</b>	silver <sup>1</sup>	gold over silver <sup>3</sup>	1A@120VAC or 28VDC	UL, CUL IP68																		
<b>Q</b>	silver <sup>1</sup>	silver <sup>1</sup>	1A@120VAC or 28VDC	UL, CUL IP68																		
<b>R</b>	gold <sup>2</sup>	gold <sup>2</sup>	0.4VA max. @20V max (AC/DC)	IP68																		
<b>5 BUSHING</b> <b>B1</b> Threaded <b>B4</b> Unthreaded	<b>7 EPOXY SEAL</b> <b>E</b> epoxy seal																					

3MA-Series Ordering Scheme

with Square Actuator **3MA** - **SP** - **1** - **AP2** / **3** **2** - **M6** **Q** **E**

1 Series      2 Poles      3 Circuit      4 Actuator      5A Actuator Color      5B Frame Color      6 Termination      7 Contact      8 Seal

with Plunger Actuator **3MA** - **SP** - **1** - **PD** - **BD** - **M6** **Q** **E**

1 Series      2 Poles      3 Circuit      4 Actuator      5 Bushing      6 Termination      7 Contact      8 Seal

<b>1 SERIES</b> <b>3MA</b> Alternate-Action Miniature Pushbutton Switch	<b>6 TERMINATION</b>																															
<b>2 POLES</b> <b>SP</b> single pole <b>DP</b> double pole <b>3P</b> three pole <b>4P</b> four pole	<b>M1</b> Solder Lug <b>M2</b> PCB <b>M5-1</b> Wire Wrap .750 [19.05] <b>M5-2</b> Wire Wrap .964 [24.48] <b>M5-3</b> Wire Wrap .425 [10.80] <b>M5-4</b> Wire Wrap 1.062 [26.87] <b>M6</b> PC Mount, 90° horizontal <b>M7</b> PC Mount, 90° vertical	<b>VS2</b> PC Mount, U bracket, .620 mounting x .460 high <b>VS3</b> PC Mount, U bracket, .620 mounting x .630 high <b>VS4</b> PC Mount, U bracket, .750 mounting x .460 high <b>VS5</b> PC Mount, U bracket, .750 mounting x .630 high																														
<b>3 CIRCUIT</b> ( ) - momentary <b>Switching Position:</b> 2-3, 5-6, 8-9, 11-12 <b>1</b> ON <b>2</b> ON	<b>7 CONTACT</b>																															
<b>4 ACTUATOR</b> <b>SQUARE ACTUATOR</b> (use with Color Options in Selection 5A & 5B.) <b>AP1</b> square with no frame <b>AP2</b> square raised above frame <b>PLUNGER ACTUATOR</b> (use with Bushing Options in Selection 5) <b>PA</b> .118 dia. x .299" plunger length <b>PI</b> .118 dia. x .244" plunger length <b>PL</b> .118 dia. x .327" plunger length <b>PC</b> .315" dia. brass chrome plated plunger (for BD bushing only) <b>PD</b> .242" dia. brass chrome plated plunger (for BD bushing only)	<table border="0"> <thead> <tr> <th></th> <th>Material</th> <th>Terminal Plating</th> <th>Rating</th> <th>Approvals</th> </tr> </thead> <tbody> <tr> <td><b>G</b></td> <td>silver<sup>1</sup></td> <td>gold over silver<sup>3</sup></td> <td>6A@125VAC or 28VDC, 3A@250VAC</td> <td>UL, CUL</td> </tr> <tr> <td><b>K</b></td> <td>gold<sup>2</sup></td> <td>tin-lead<sup>4</sup></td> <td>6A@125VAC or 28VDC</td> <td>UL, CUL</td> </tr> <tr> <td><b>P</b></td> <td>silver<sup>1</sup></td> <td>tin-lead<sup>4</sup></td> <td>6A@125VAC or 28VDC, 3A@250VAC</td> <td>UL, CUL</td> </tr> <tr> <td><b>Q</b></td> <td>silver<sup>1</sup></td> <td>silver<sup>1</sup></td> <td>6A@125VAC or 28VDC, 3A@250VAC</td> <td>UL, CUL</td> </tr> <tr> <td><b>R</b></td> <td>gold<sup>2</sup></td> <td>gold<sup>2</sup></td> <td>0.4VA max. @20V max (AC/DC)</td> <td></td> </tr> </tbody> </table> <p>NOTE: Tin-lead option available with PC type terminations only. 1 Moveable contact &amp; terminals: copper alloy, silver plate 2 Moveable contact &amp; terminals: copper alloy with gold plate over nickel plate 3 Terminals: silver plate with outer layer in gold plating 4 Outer terminals: copper alloy with tin-lead over nickel plate</p>			Material	Terminal Plating	Rating	Approvals	<b>G</b>	silver <sup>1</sup>	gold over silver <sup>3</sup>	6A@125VAC or 28VDC, 3A@250VAC	UL, CUL	<b>K</b>	gold <sup>2</sup>	tin-lead <sup>4</sup>	6A@125VAC or 28VDC	UL, CUL	<b>P</b>	silver <sup>1</sup>	tin-lead <sup>4</sup>	6A@125VAC or 28VDC, 3A@250VAC	UL, CUL	<b>Q</b>	silver <sup>1</sup>	silver <sup>1</sup>	6A@125VAC or 28VDC, 3A@250VAC	UL, CUL	<b>R</b>	gold <sup>2</sup>	gold <sup>2</sup>	0.4VA max. @20V max (AC/DC)	
	Material	Terminal Plating	Rating	Approvals																												
<b>G</b>	silver <sup>1</sup>	gold over silver <sup>3</sup>	6A@125VAC or 28VDC, 3A@250VAC	UL, CUL																												
<b>K</b>	gold <sup>2</sup>	tin-lead <sup>4</sup>	6A@125VAC or 28VDC	UL, CUL																												
<b>P</b>	silver <sup>1</sup>	tin-lead <sup>4</sup>	6A@125VAC or 28VDC, 3A@250VAC	UL, CUL																												
<b>Q</b>	silver <sup>1</sup>	silver <sup>1</sup>	6A@125VAC or 28VDC, 3A@250VAC	UL, CUL																												
<b>R</b>	gold <sup>2</sup>	gold <sup>2</sup>	0.4VA max. @20V max (AC/DC)																													
<b>5A ACTUATOR COLOR &amp; 5B FRAME COLOR</b> <sup>1,2</sup> <b>1</b> white <b>4</b> orange <b>7</b> blue <b>2</b> black <b>5</b> yellow <b>8</b> brown <b>3</b> red <b>6</b> green <b>9</b> gray	<b>8 EPOXY SEAL</b> <b>E</b> epoxy seal																															
<b>5 BUSHING</b> <b>BD</b> Big bushing for PC, PD actuator 15/32" <b>B10</b> Threaded 1/4 - 40 <b>B20</b> Unthreaded <b>B21</b> Unthreaded with flat NOTE: For CAP options, see ordering scheme on page 35.																																

## 3MN-Series Dimensional Specifications: in. [mm]

### PLUNGER

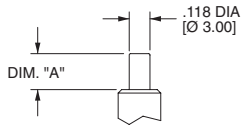

OPTION CODE	DIM. "A"
P0	.000 [0.00]
P1	.205 [5.20]
P2	.079 [2.00]

FOR B10,B11,B20,B21 ONLY

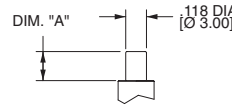

OPTION CODE	DIM. "A"
P0	.098 [2.50]
P1	.295 [7.50]
P2	.165 [4.20]

FOR B6 ONLY

### ACTUATOR

#### AP1

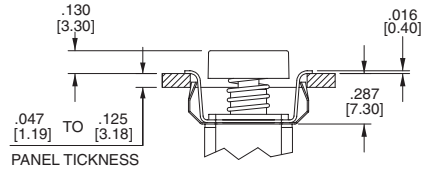
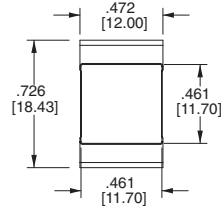

#### PANEL MOUNTING

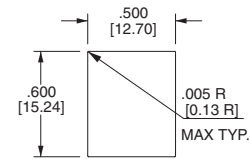

#### AP2

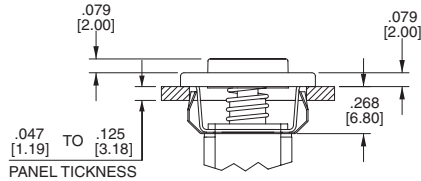
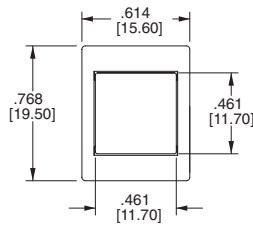

#### PANEL MOUNTING

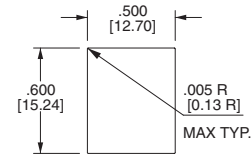

#### AP3

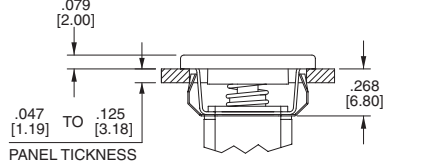
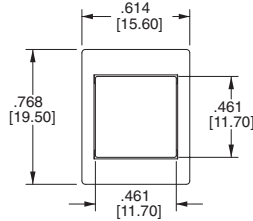

### BUSHING

**B10**  
STANDARD KEYWAY  
THREADED SHOWN

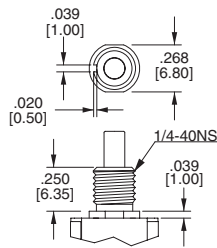

**B20**  
STANDARD KEYWAY  
NON-THREADED

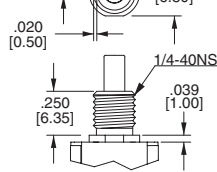

**B11**  
THREADED SHOWN  
WITH FLAT

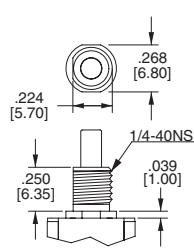

**B21**  
NON-THREADED  
WITH FLAT

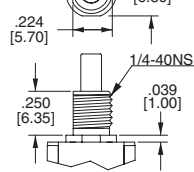

**B6**  
NON-THREADED  
(FOR TERMINATION  
OPTIONS VS6-VS9 ONLY)

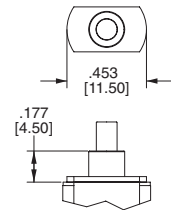

### CAP

#### C1

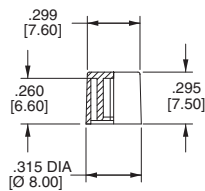

#### C2

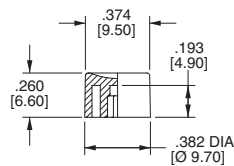

#### C3

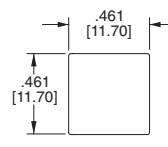

#### C4

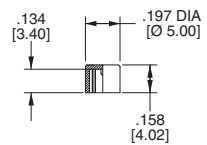

## 3MN-Series Dimensional Specifications: in. [mm]

### TERMINATION

**M1**

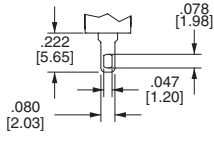

THK .030 [0.75]

**M2**

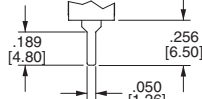

THK .030 [0.75]

**M5**

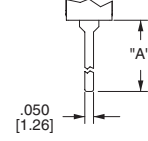

THK .030 [0.75]

OPTION CODE	DIM. "A"
M5-1	.750 [19.05]
M5-3	.425 [10.80]

### SINGLE POLE

### DOUBLE POLE

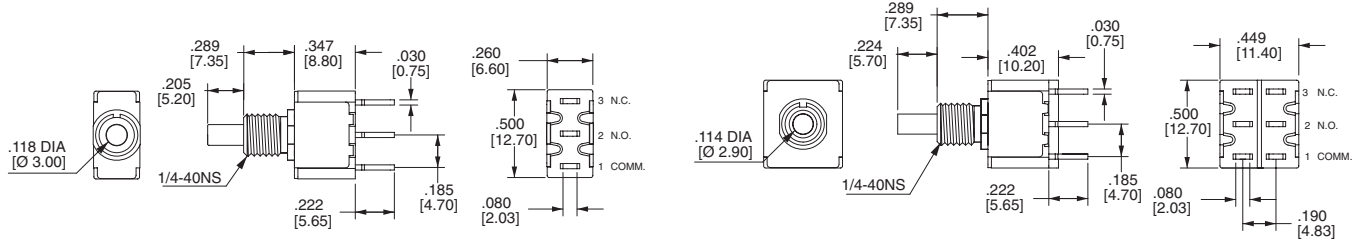

**M6**

### SINGLE POLE

### PC MOUNTING

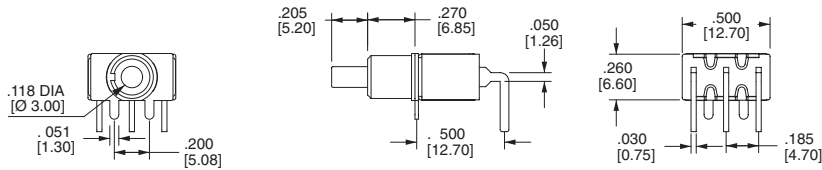

### DOUBLE POLE

### PC MOUNTING

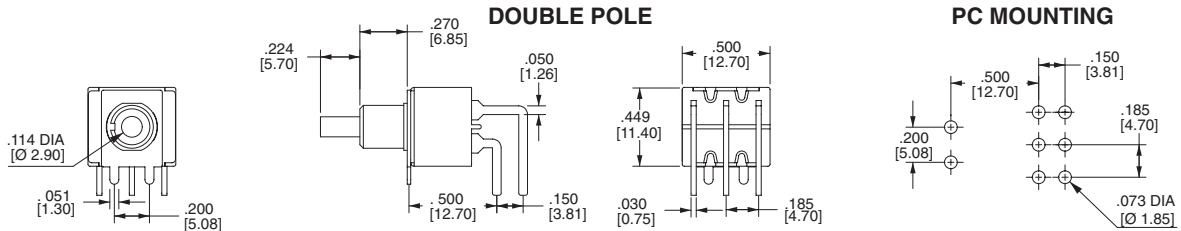

**M7**

### SINGLE POLE

### PC MOUNTING

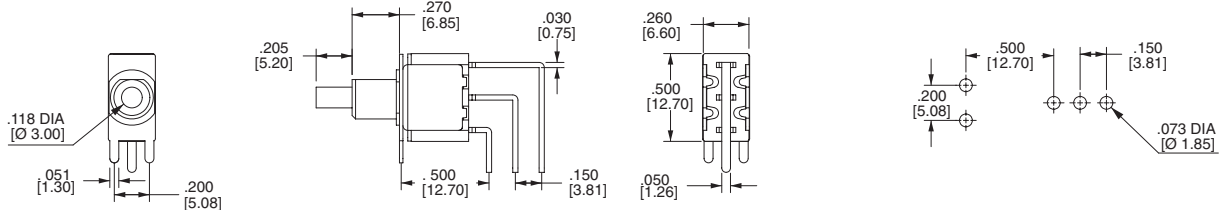

### DOUBLE POLE

### PC MOUNTING

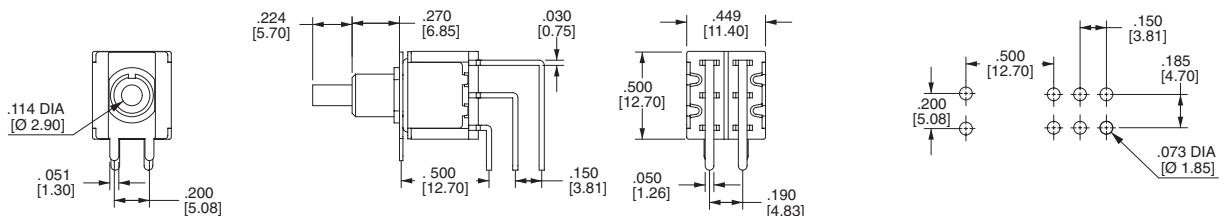

## 3MN-Series Dimensional Specifications: in. [mm]

### TERMINATION

#### SINGLE POLE

OPTION CODE	DIM. "A"
VS2	.460 [11.68]
VS3	.630 [16.00]
VS7	[16.00]

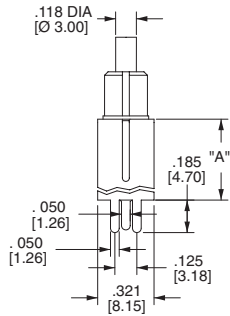

#### PC MOUNTING

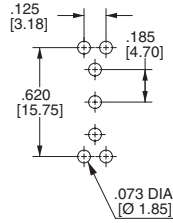

#### VS2-VS3

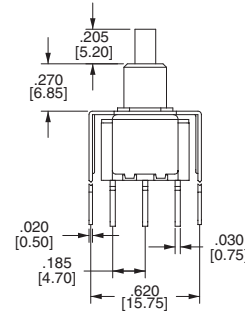

#### VS6-VS7 (For B6 Bushing Only)

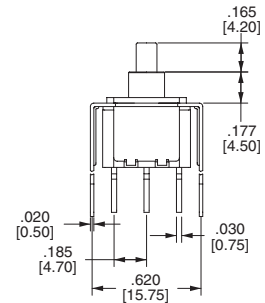

#### DOUBLE POLE

OPTION CODE	DIM. "A"
VS2	.460 [11.68]
VS3	.630 [16.00]
VS7	[16.00]

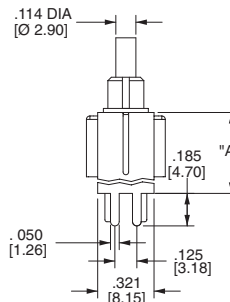

#### PC MOUNTING

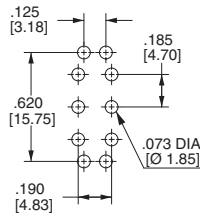

#### VS2-VS3

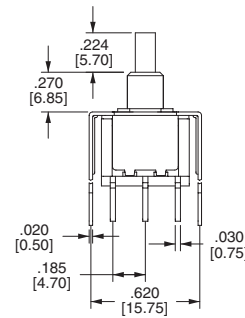

#### VS6-VS7 (For B6 Bushing Only)

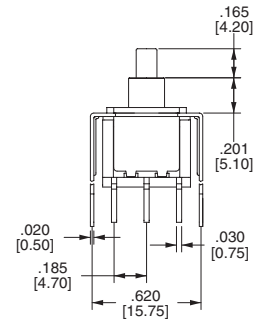

#### SINGLE POLE

OPTION CODE	DIM. "A"
VS4	.460 [11.68]
VS5	.630 [16.00]
VS9	[16.00]

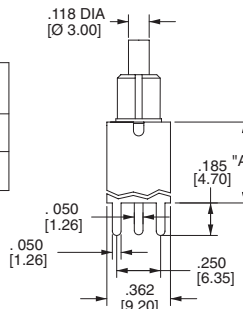

#### PC MOUNTING

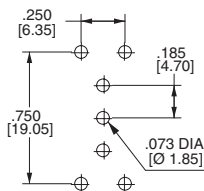

#### VS4-VS5

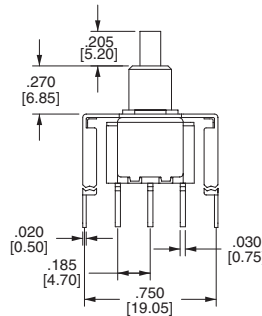

#### VS8-VS9 (For B6 Bushing Only)

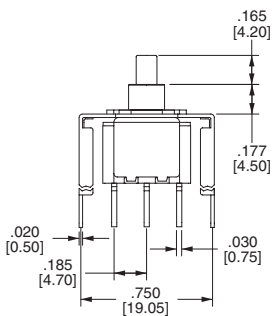

#### DOUBLE POLE

OPTION CODE	DIM. "A"
VS4	.460 [11.68]
VS5	.630 [16.00]
VS9	[16.00]

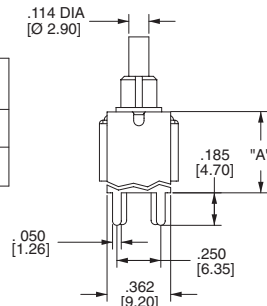

#### PC MOUNTING

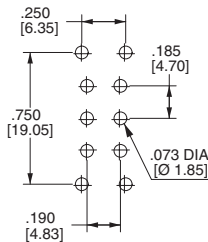

#### VS4-VS5

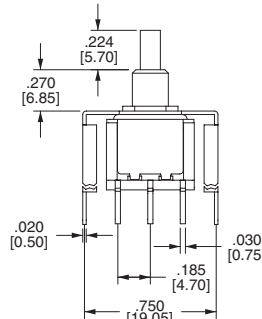

#### VS8-VS9 (For B6 Bushing Only)

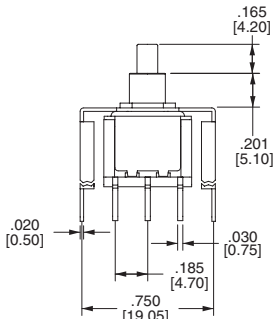

## 3MS-Series Dimensional Specifications: in. [mm]

### PLUNGER

	<table border="1"> <thead> <tr> <th>OPTION CODE</th> <th>DIM. "A"</th> </tr> </thead> <tbody> <tr> <td><b>P1</b></td> <td>.173 [4.40]</td> </tr> <tr> <td><b>P2</b></td> <td>.220 [5.60]</td> </tr> <tr> <td><b>P3</b></td> <td>.087 [2.20]</td> </tr> </tbody> </table>	OPTION CODE	DIM. "A"	<b>P1</b>	.173 [4.40]	<b>P2</b>	.220 [5.60]	<b>P3</b>	.087 [2.20]		<table border="1"> <thead> <tr> <th>OPTION CODE</th> <th>DIM. "A"</th> </tr> </thead> <tbody> <tr> <td><b>P1</b></td> <td>.276 [7.00]</td> </tr> <tr> <td><b>P2</b></td> <td>.327 [8.30]</td> </tr> <tr> <td><b>P3</b></td> <td>.193 [4.90]</td> </tr> </tbody> </table>	OPTION CODE	DIM. "A"	<b>P1</b>	.276 [7.00]	<b>P2</b>	.327 [8.30]	<b>P3</b>	.193 [4.90]
OPTION CODE	DIM. "A"																		
<b>P1</b>	.173 [4.40]																		
<b>P2</b>	.220 [5.60]																		
<b>P3</b>	.087 [2.20]																		
OPTION CODE	DIM. "A"																		
<b>P1</b>	.276 [7.00]																		
<b>P2</b>	.327 [8.30]																		
<b>P3</b>	.193 [4.90]																		
FOR B1 BUSHING		FOR B4 BUSHING																	

### BUSHING

<b>B1</b> 	<b>B4</b> 
---------------	---------------

### TERMINATION

<b>M1</b> 	<b>M2</b> 
THK .030 [0.75]	THK .030 [0.75]

<b>SINGLE POLE</b> 	<b>DOUBLE POLE</b> 
------------------------	------------------------

### M6

	<b>SINGLE POLE</b> 		<b>PC MOUNTING</b> 
	<b>DOUBLE POLE</b> 		<b>PC MOUNTING</b> 

## 3MS-Series Dimensional Specifications: in. [mm]

### TERMINATION

#### M7

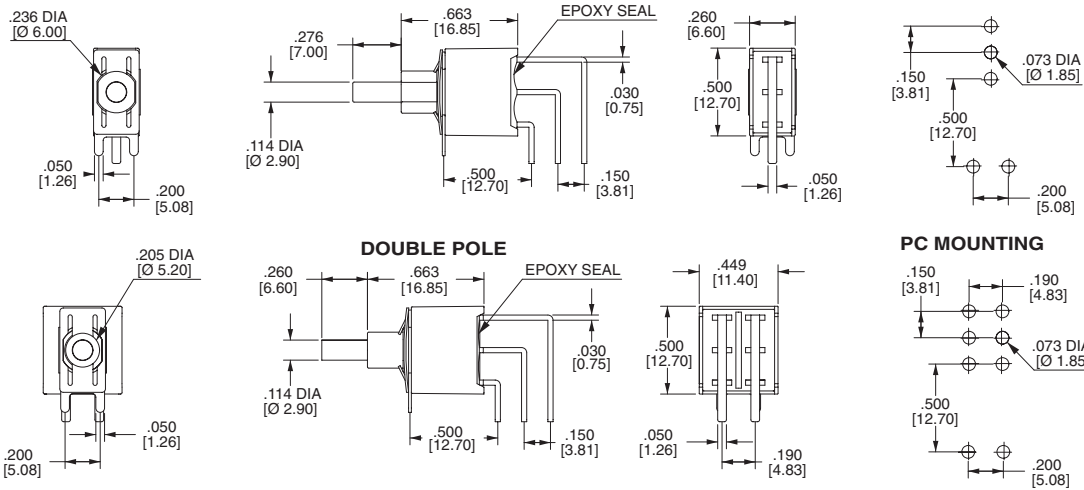

#### VS2-VS3

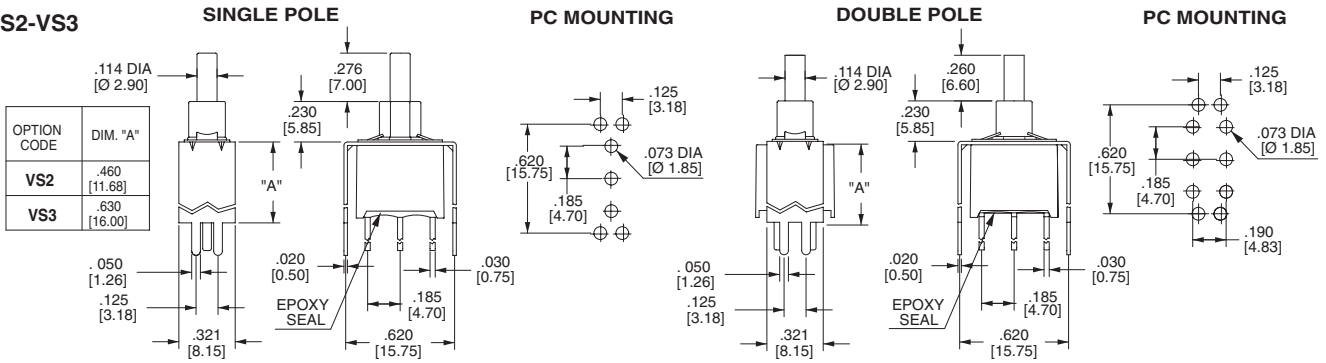

#### VS4-VS5

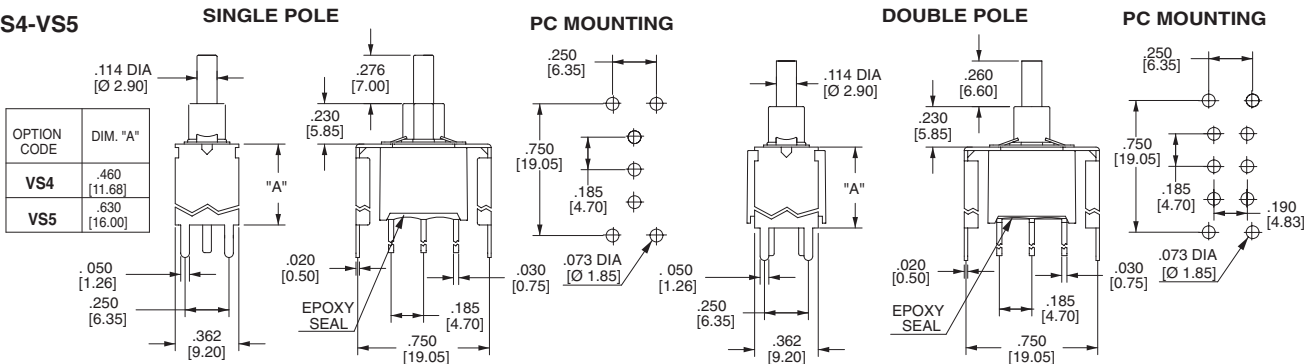

### SNAP-IN TERMINATION OPTIONS

#### M61



#### M71

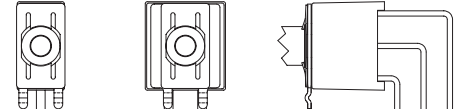

#### VS21,VS31

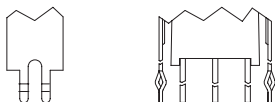

#### VS41,VS51

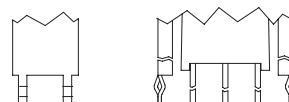

M61,M71,VS21,VS31,VS41,VS51 have the same P.C. mounting but with snap-in bracket.

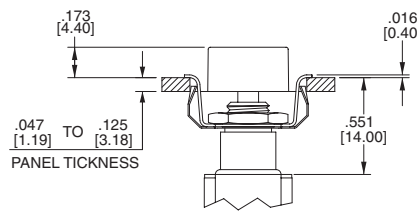
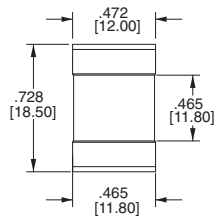
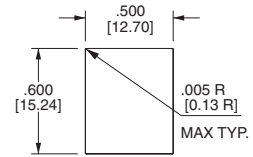
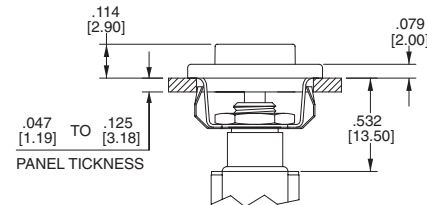
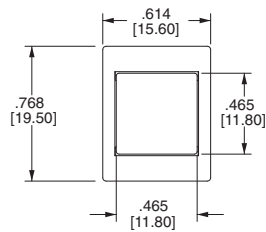
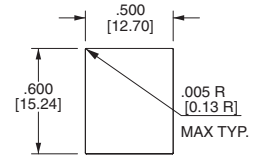
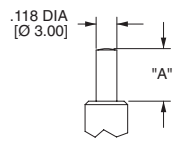

**3MA-Series Dimensional Specifications: in. [mm]**
**ACTUATOR**
**AP1**

**PANEL MOUNTING**

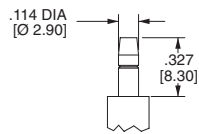
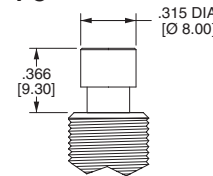
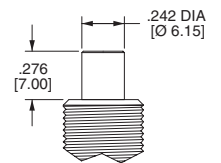
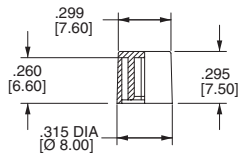
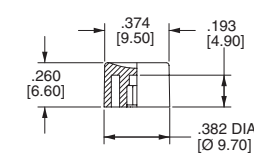
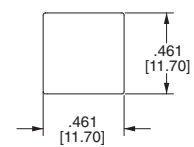
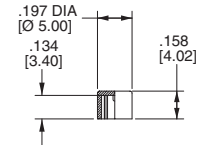
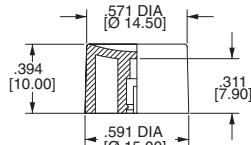
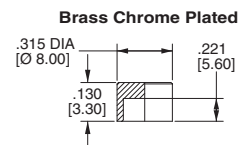
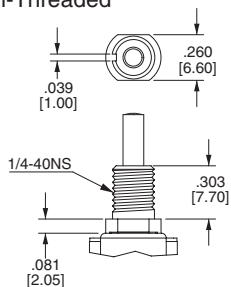
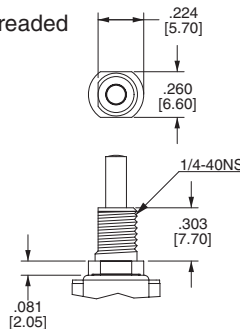
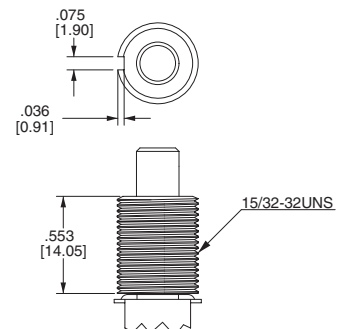
**AP2**

**PANEL MOUNTING**

**PLUNGER**
**PA,PI**

OPTION CODE	DIM. "A"
PA	.299 [7.60]
PI	.244 [6.20]

**PL**

**PC**

**Brass Chrome Plated**
**PD**

**PC, PD Plunger must fit with BD bushing**
**CAP**
**C1**

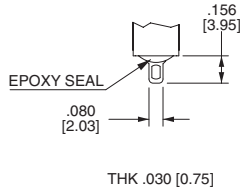
**C2**

**C3**

**C4**

**C5**

**For PL Bushing Only**
**C6**

**For PD Bushing Only**
**BUSHING**
**B10 Threaded  
B20 Non-Threaded**

**B21 Non-Threaded**

**BD**

**3MA-Series Dimensional Specifications: in. [mm]**

**TERMINATION**

**M1**



**M2**

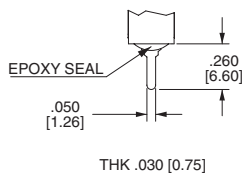

**M5**

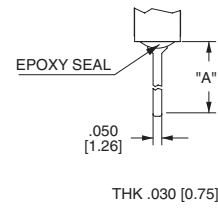

OPTION CODE	DIM. "A"
<b>M5-1</b>	.750 [19.05]
<b>M5-2</b>	.964 [24.48]
<b>M5-3</b>	.425 [10.80]
<b>M5-4</b>	1.062 [26.97]

**SINGLE POLE**

**DOUBLE POLE**

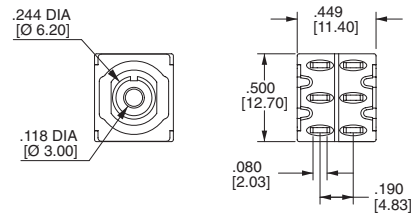
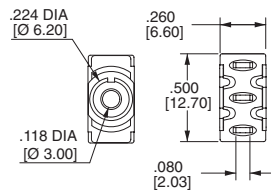
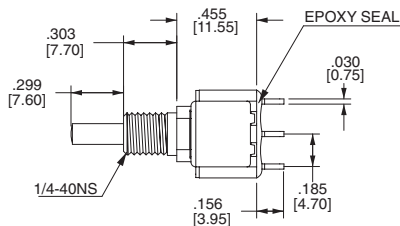

**3 POLE**

**4 POLE**

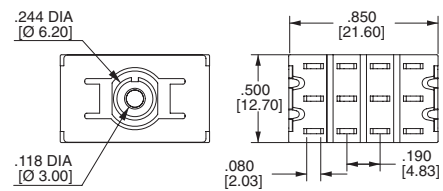
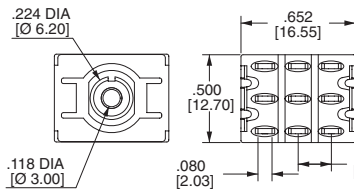
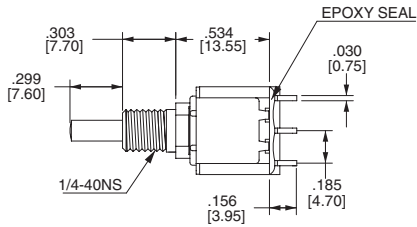

**M6**

**SINGLE POLE**

**PC MOUNTING**

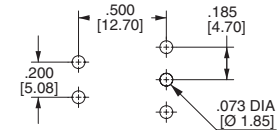
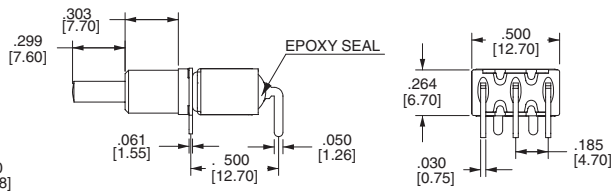
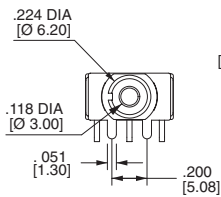

**DOUBLE POLE**

**PC MOUNTING**

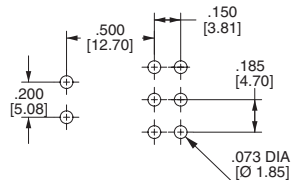
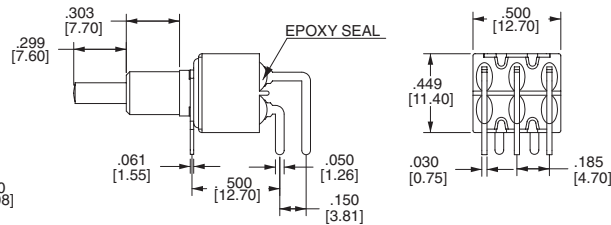
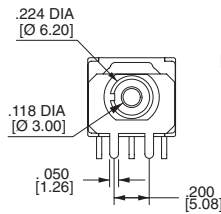

## 3MA-Series Dimensional Specifications: in. [mm]

### TERMINATION

M7

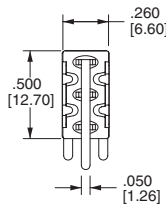
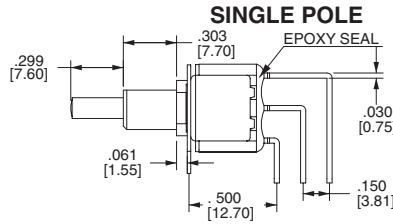
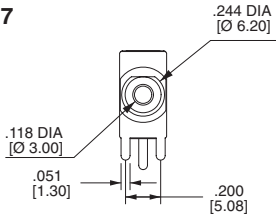

PC MOUNTING

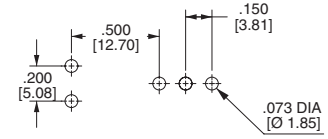

DOUBLE POLE

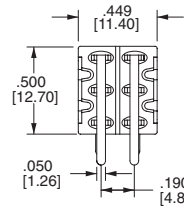
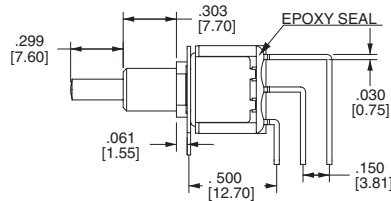
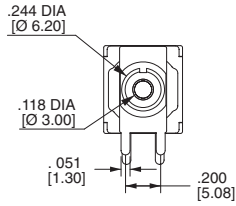

PC MOUNTING

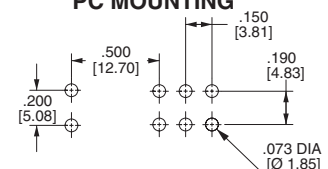

THREE POLE

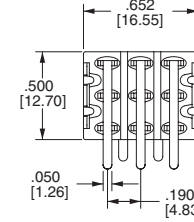
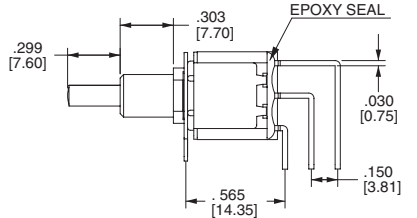
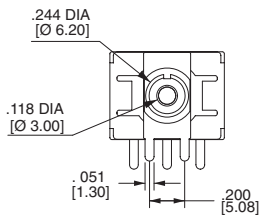

PC MOUNTING

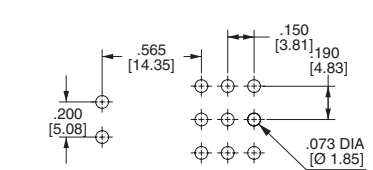

FOUR POLE

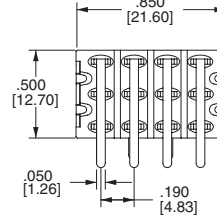
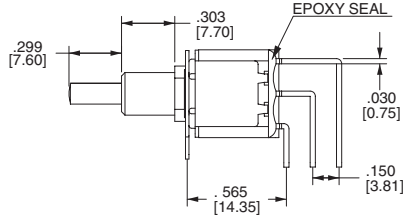
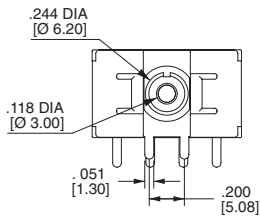

PC MOUNTING

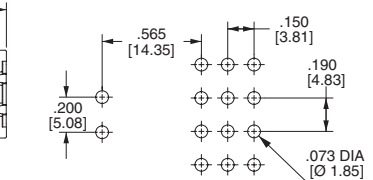

VS2-VS3

OPTION CODE	DIM. "A"
VS2	.460 [11.68]
VS3	.630 [16.00]

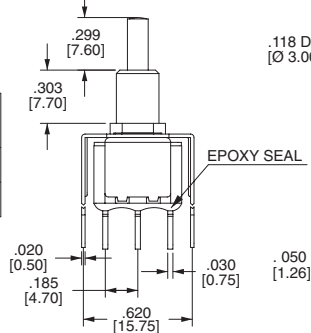

SINGLE POLE

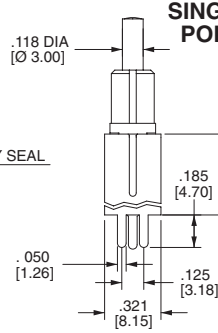

PC MOUNTING

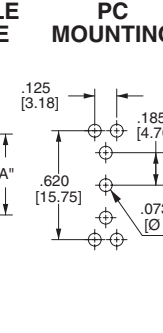

DOUBLE POLE

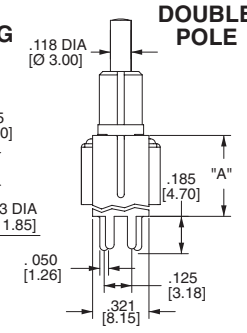

PC MOUNTING

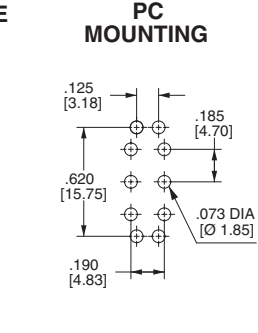

VS4-VS5

OPTION CODE	DIM. "A"
VS4	.460 [11.68]
VS5	.630 [16.00]

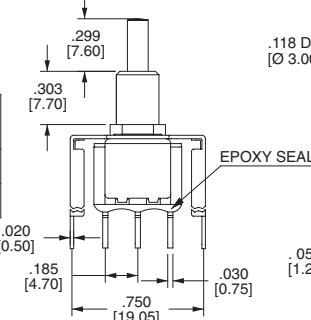

SINGLE POLE

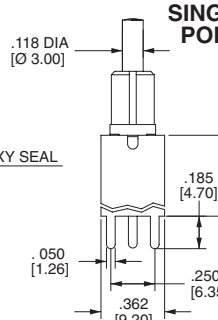

PC MOUNTING

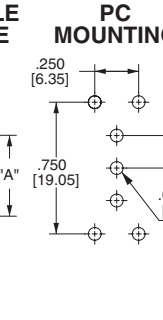

DOUBLE POLE

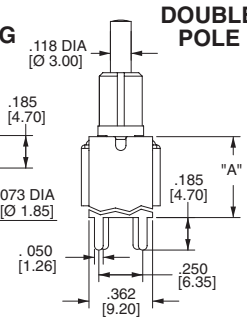

PC MOUNTING

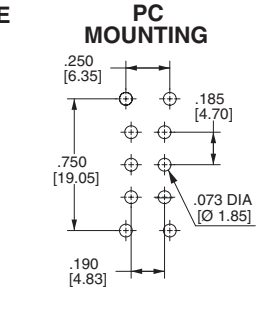

## Данный компонент на территории Российской Федерации

### Вы можете приобрести в компании MosChip.

Для оперативного оформления запроса Вам необходимо перейти по данной ссылке:

<http://moschip.ru/get-element>

Вы можете разместить у нас заказ для любого Вашего проекта, будь то серийное производство или разработка единичного прибора.

В нашем ассортименте представлены ведущие мировые производители активных и пассивных электронных компонентов.

Нашей специализацией является поставка электронной компонентной базы двойного назначения, продукции таких производителей как XILINX, Intel (ex.ALTERA), Vicor, Microchip, Texas Instruments, Analog Devices, Mini-Circuits, Amphenol, Glenair.

Сотрудничество с глобальными дистрибьюторами электронных компонентов, предоставляет возможность заказывать и получать с международных складов практически любой перечень компонентов в оптимальные для Вас сроки.

На всех этапах разработки и производства наши партнеры могут получить квалифицированную поддержку опытных инженеров.

Система менеджмента качества компании отвечает требованиям в соответствии с ГОСТ Р ИСО 9001, ГОСТ РВ 0015-002 и ЭС РД 009

### Офис по работе с юридическими лицами:

105318, г.Москва, ул.Щербаковская д.3, офис 1107, 1118, ДЦ «Щербаковский»

Телефон: +7 495 668-12-70 (многоканальный)

Факс: +7 495 668-12-70 (доб.304)

E-mail: [info@moschip.ru](mailto:info@moschip.ru)

Skype отдела продаж:

moschip.ru

moschip.ru\_4

moschip.ru\_6

moschip.ru\_9