

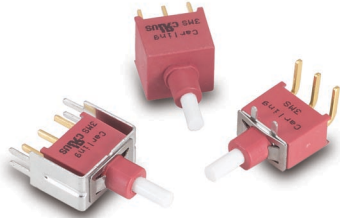

3MN-Series
Snap-Action Miniature Pushbutton Switch

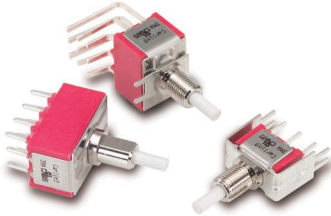

3MS-Series
Sealed Snap-Action Miniature Pushbutton Switch



3MA-Series
Alternate Action Miniature Pushbutton Switch

Specifications

Contact Rating	refer to ordering scheme
Electrical Life	50,000 make & break cycles @ full load
Contact Resistance.	<i>3MN & 3MA-Series:</i> 10 mΩ max. initial @ 2-4 VDC 100mA for both silver & gold plated contacts. <i>3MS-Series:</i> 50 mΩ max. initial @ 2-4 VDC 100mA for both silver & gold plated contacts.
Insulation Resistance . . .	1000 MΩ min.
Dielectric Strength	1500 Volts RMS @ sea level
Operating Temperature . . .	-30°C to +85°C
Index of Protection	<i>3MS -Series:</i> IP68
Cap Installation Support . .	<i>3MS-Series:</i> 10 lbs. max.
Solder Heat Resistance. . .	MIL-STD-202, Method 210
Actuator Travel25°

Materials

Case	<i>3MN & 3MA-Series:</i> Diallyl phthalate (DAP) (UL 94V-0) <i>3MS-Series:</i> Glass filled nylon 6/6, flame retardant, heat stabilized (UL 94V-0)
Plunger.	<i>3MN-Series:</i> Thermoplastic polyester, black <i>3MS & 3MA-Series:</i> Glass filled nylon or glass filled polyester (UL 94V-0)
Bushing	<i>3MN-Series:</i> Brass, nickel plated <i>3MA-Series:</i> Zinc, nickel plated
Housing.	<i>3MN & 3MA-Series:</i> Stainless Steel
Switch Support Retainer . .	<i>3MS-Series:</i> Stainless Steel
Terminal Seal	Epoxy

3M-Series Optional Cap

To order a cap assembled on a switch, specify the switch number followed by the cap part number and the word "assembled".

Ex: 3MN-SP-7-P2-B6-M6QE-C13ASSEMBLED

To order caps in bulk, specify the Series, followed by the cap. Ex.) 3MN-C13



1 SERIES OR SWITCH CATALOG NUMBER 3MN, 3MS or 3MA			
2 CAP SIZE			
C1	round 7.6mm dia.	C5	round 14.5mm dia.
C2	round 9.35 mm dia.	C6	brass chrome plated (for 3MA w/ PL bushing)
C3	square 11.7 x 11.7mm		
C4	round 5mm dia.		(for 3MA w/ PD bushing)

3 CAP COLOR			
1	white	5	yellow
2	black	6	green
3	red	7	blue
4	orange		
1 Black, white & red standard. Other colors available. Consult factory.			

3MN-Series Dimensional Specifications: in. [mm]

PLUNGER

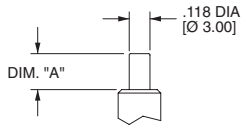

OPTION CODE	DIM. "A"
P0	.000 [0.00]
P1	.205 [5.20]
P2	.079 [2.00]

FOR B10,B11,B20,B21 ONLY

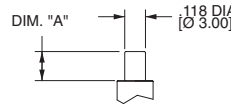

OPTION CODE	DIM. "A"
P0	.098 [2.50]
P1	.295 [7.50]
P2	.165 [4.20]

FOR B6 ONLY

ACTUATOR

AP1

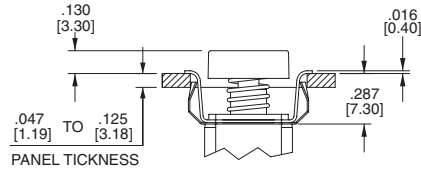
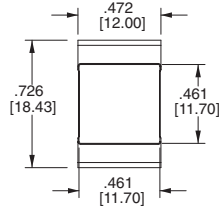

PANEL MOUNTING

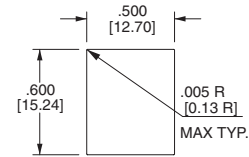

AP2

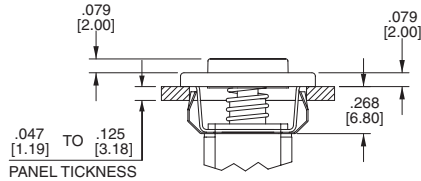
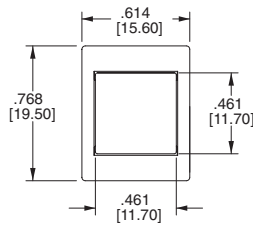

PANEL MOUNTING

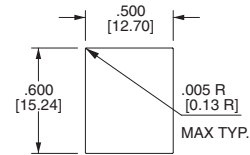

AP3

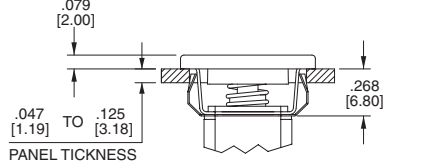
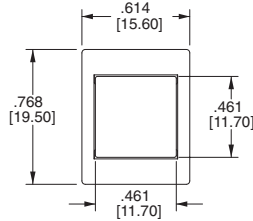

BUSHING

B10
STANDARD KEYWAY
THREADED SHOWN

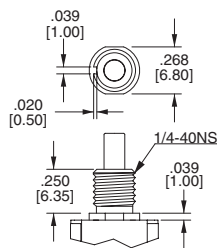

B20
STANDARD KEYWAY
NON-THREADED

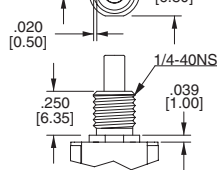

B11
THREADED SHOWN
WITH FLAT

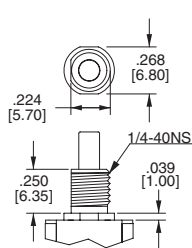

B21
NON-THREADED
WITH FLAT

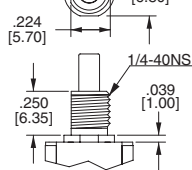

B6
NON-THREADED
(FOR TERMINATION
OPTIONS VS6-VS9 ONLY)

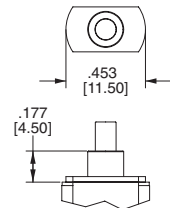

CAP

C1

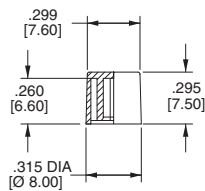

C2

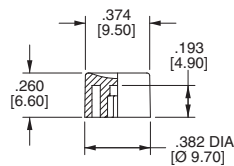

C3

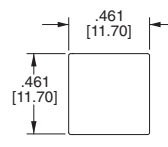

C4

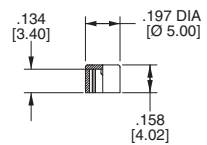

3MN-Series Dimensional Specifications: in. [mm]

TERMINATION

M1

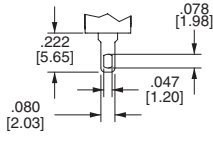

THK .030 [0.75]

M2

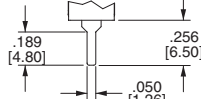

THK .030 [0.75]

M5

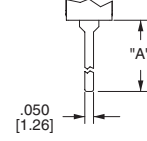

THK .030 [0.75]

OPTION CODE	DIM. "A"
M5-1	.750 [19.05]
M5-3	.425 [10.80]

SINGLE POLE

DOUBLE POLE

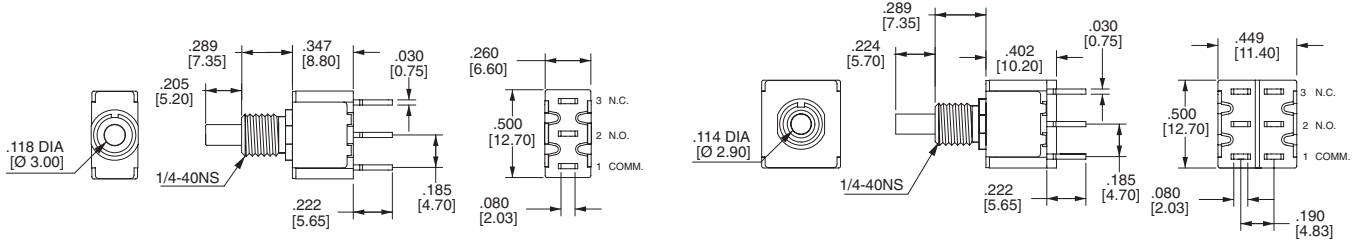

M6

SINGLE POLE

PC MOUNTING

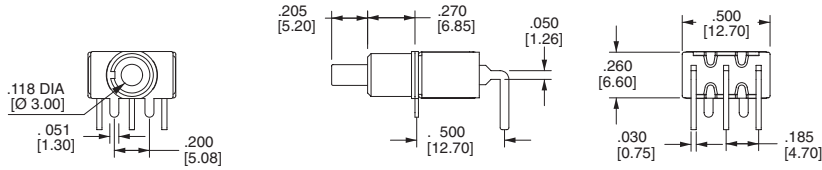

DOUBLE POLE

PC MOUNTING

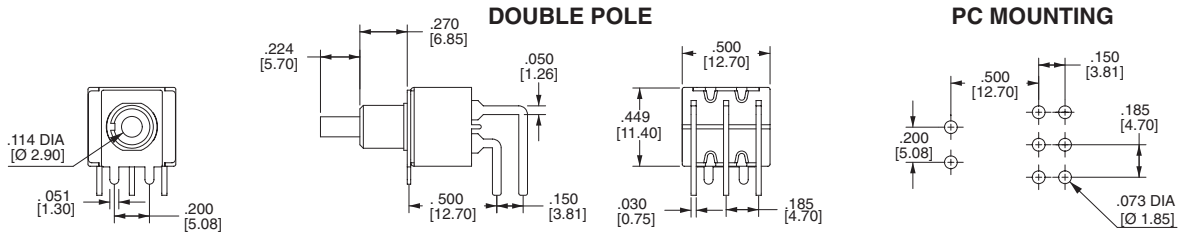

M7

SINGLE POLE

PC MOUNTING

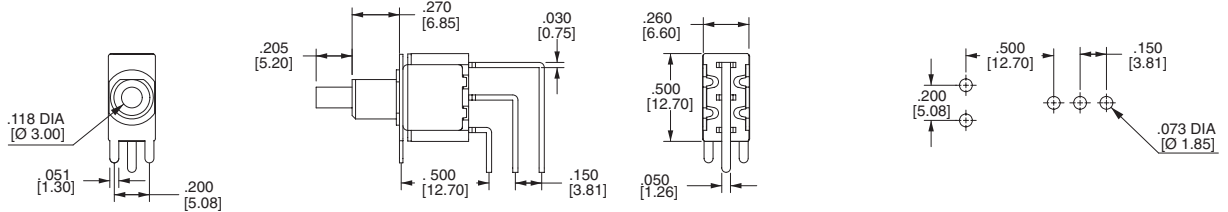

DOUBLE POLE

PC MOUNTING

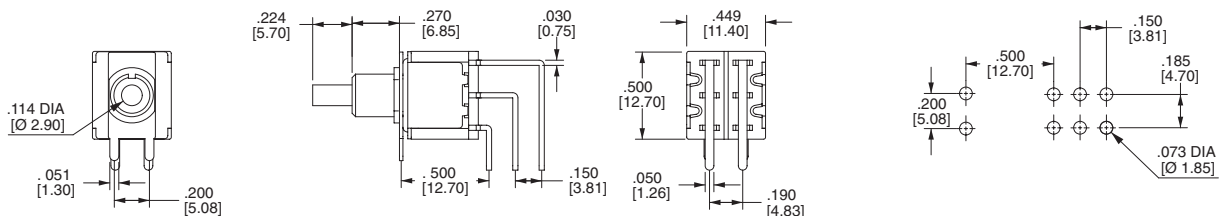

3MN-Series Dimensional Specifications: in. [mm]

TERMINATION

SINGLE POLE

OPTION CODE	DIM. "A"
VS2	.460 [11.68]
VS3	.630 [16.00]
VS7	[16.00]

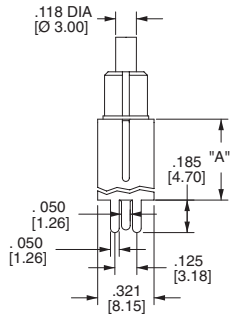

PC MOUNTING

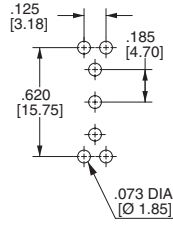

VS2-VS3

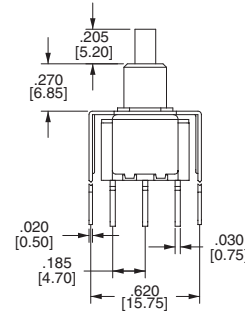

VS6-VS7 (For B6 Bushing Only)

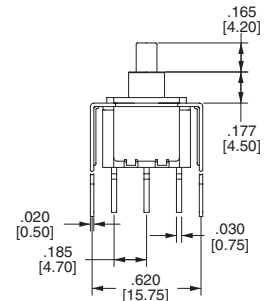

DOUBLE POLE

OPTION CODE	DIM. "A"
VS2	.460 [11.68]
VS3	.630 [16.00]
VS7	[16.00]

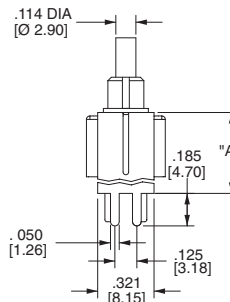

PC MOUNTING

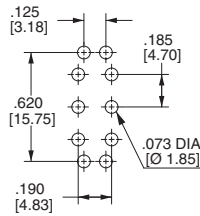

VS2-VS3

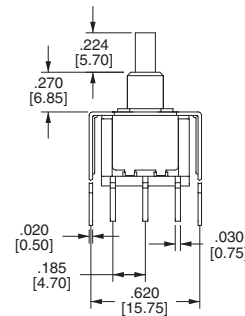

VS6-VS7 (For B6 Bushing Only)

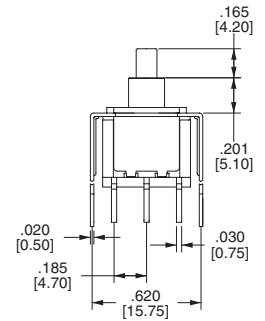

SINGLE POLE

OPTION CODE	DIM. "A"
VS4	.460 [11.68]
VS5	.630 [16.00]
VS9	[16.00]

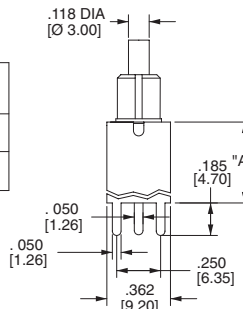

PC MOUNTING

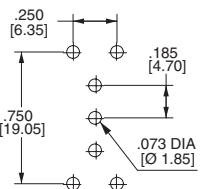

VS4-VS5

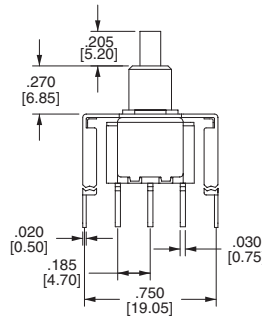

VS8-VS9 (For B6 Bushing Only)

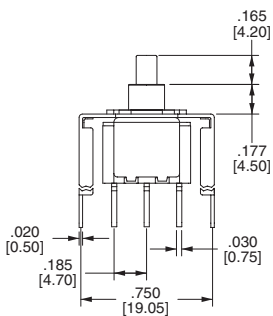

DOUBLE POLE

OPTION CODE	DIM. "A"
VS4	.460 [11.68]
VS5	.630 [16.00]
VS9	[16.00]

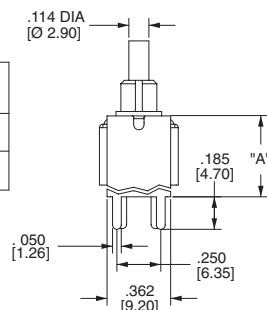

PC MOUNTING

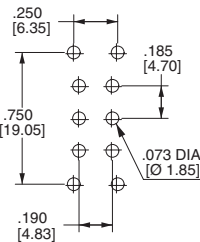

VS4-VS5

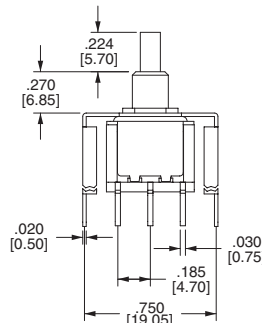

VS8-VS9 (For B6 Bushing Only)

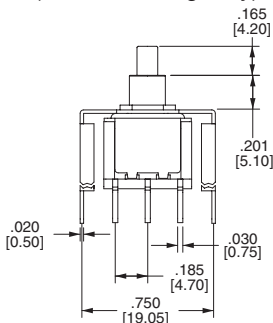

3MS-Series Dimensional Specifications: in. [mm]

PLUNGER

OPTION CODE	DIM. "A"
P1	.173 [4.40]
P2	.220 [5.60]
P3	.087 [2.20]

FOR B1 BUSHING

OPTION CODE	DIM. "A"
P1	.276 [7.00]
P2	.327 [8.30]
P3	.193 [4.90]

FOR B4 BUSHING

BUSHING

B1

1/4-40NS
.350 [8.90]

B4

.250 [6.35]

TERMINATION

M1

.078 [1.98]
.152 [3.85]
EPOXY SEAL
.080 [2.03]
.047 [1.20]
THK .030 [0.75]

M2

EPOXY SEAL
.185 [4.70]
.050 [1.26]
THK .030 [0.75]

SINGLE POLE

.236 DIA [Ø 6.00]
.276 [7.00]
.663 [16.85]
EPOXY SEAL
.260 [6.60]
.030 [0.75]
.500 [12.70]
.185 [4.70]
.050 [1.26]

DOUBLE POLE

.205 DIA [Ø 5.20]
.260 [6.60]
.663 [16.85]
EPOXY SEAL
.449 [11.40]
.030 [0.75]
.500 [12.70]
.185 [4.70]
.050 [1.26]
.190 [4.83]

M6

.236 DIA [Ø 6.00]
.200 [5.08]
.050 [1.26]

SINGLE POLE

.276 [7.00]
.663 [16.85]
EPOXY SEAL
.114 DIA [Ø 2.90]
.050 [1.26]
.500 [12.70]

PC MOUNTING

.185 [4.70]
.500 [12.70]
.073 DIA [Ø 1.85]
.200 [5.08]

.205 DIA [Ø 5.20]
.200 [5.08]
.050 [1.26]

DOUBLE POLE

.260 [6.60]
.663 [16.85]
EPOXY SEAL
.114 DIA [Ø 2.90]
.050 [1.26]
.500 [12.70]
.150 [3.81]

PC MOUNTING

.185 [4.70]
.150 [3.81]
.500 [12.70]
.073 DIA [Ø 1.85]
.200 [5.08]

3MS-Series Dimensional Specifications: in. [mm]

TERMINATION

M7

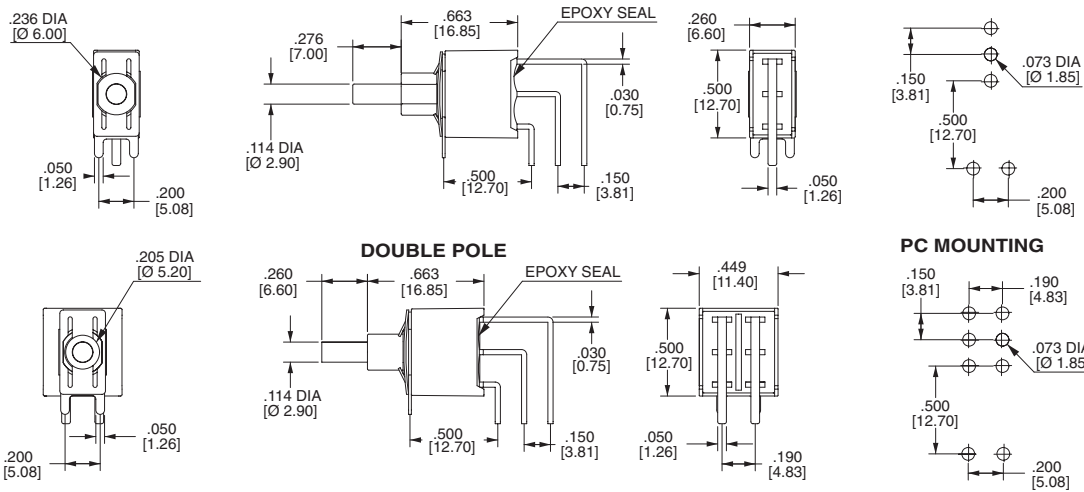

VS2-VS3

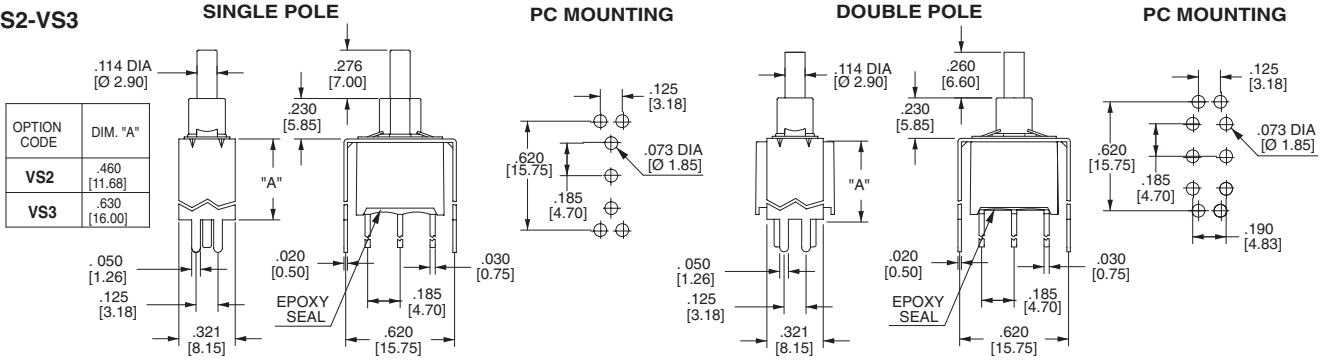

VS4-VS5

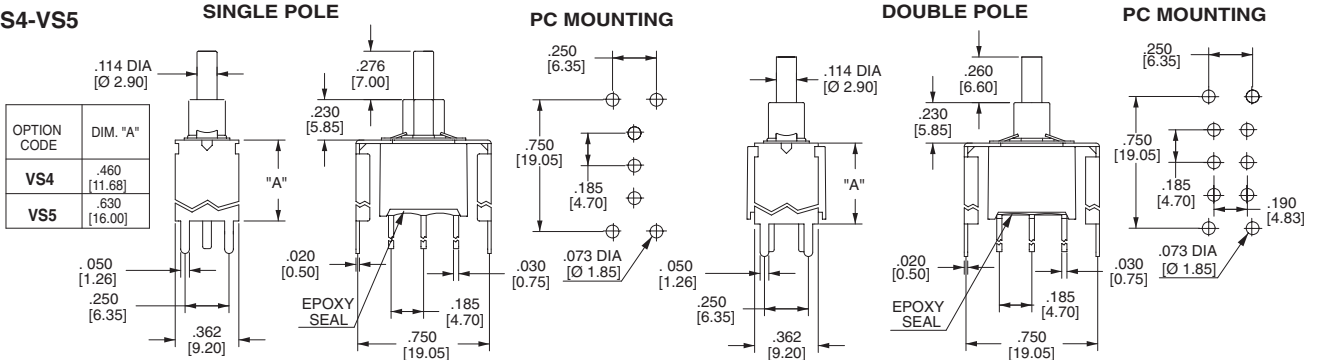

SNAP-IN TERMINATION OPTIONS

M61

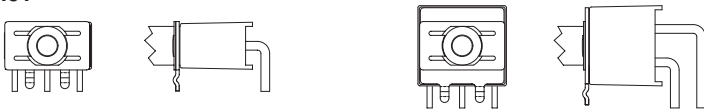

M71

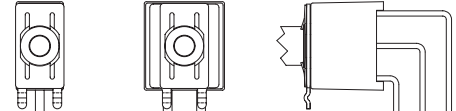

VS21, VS31

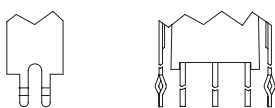

VS41, VS51

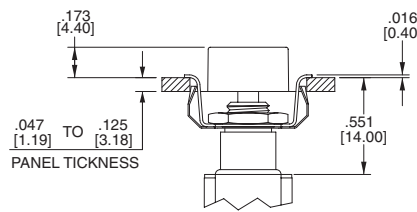
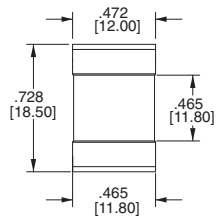
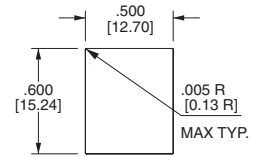
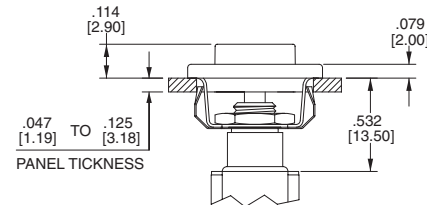
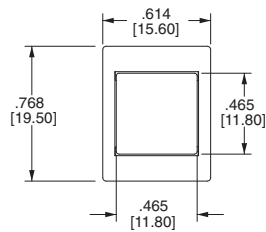
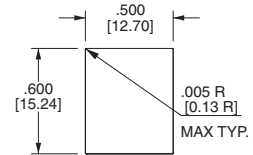
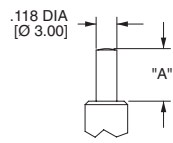

M61, M71, VS21, VS31, VS41, VS51 have the same P.C. mounting but with snap-in bracket.

3MA-Series Dimensional Specifications: in. [mm]
ACTUATOR
AP1

PANEL MOUNTING

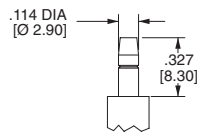
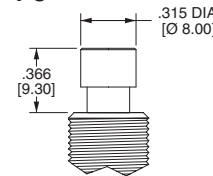
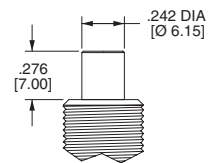
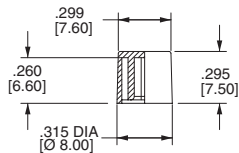
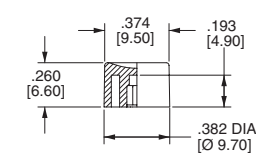
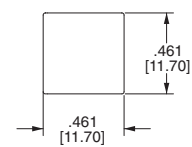
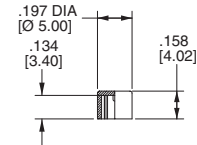
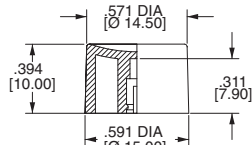
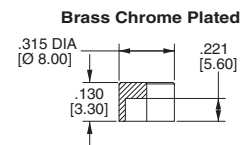
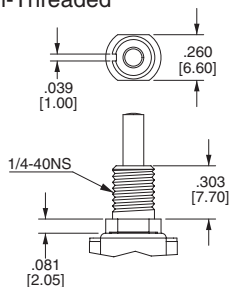
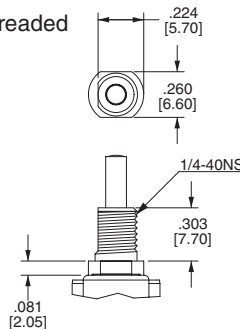
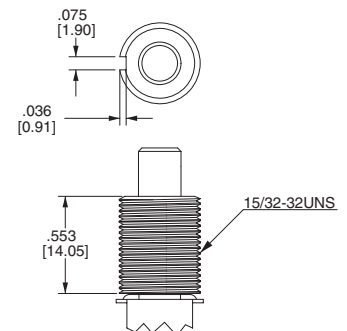
AP2

PANEL MOUNTING

PLUNGER
PA,PI

OPTION CODE	DIM. "A"
PA	.299 [7.60]
PI	.244 [6.20]

PL

PC

Brass Chrome Plated
PD

PC, PD Plunger must fit with BD bushing
CAP
C1

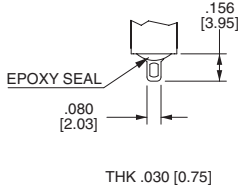
C2

C3

C4

C5

For PL Bushing Only
C6

For PD Bushing Only
BUSHING
**B10 Threaded
B20 Non-Threaded**

B21 Non-Threaded

BD

3MA-Series Dimensional Specifications: in. [mm]

TERMINATION

M1



M2

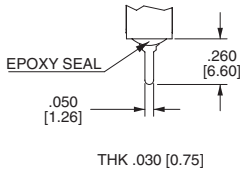

M5

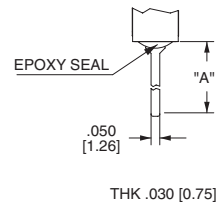

OPTION CODE	DIM. "A"
M5-1	.750 [19.05]
M5-2	.964 [24.48]
M5-3	.425 [10.80]
M5-4	1.062 [26.97]

SINGLE POLE

DOUBLE POLE

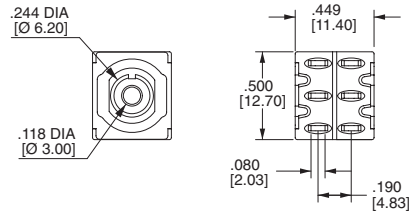
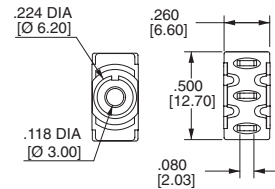
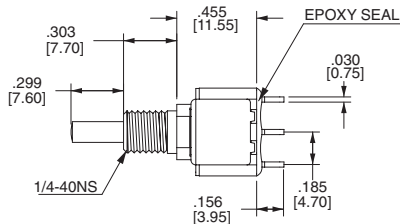

3 POLE

4 POLE

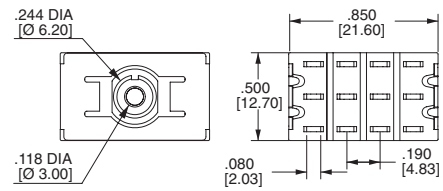
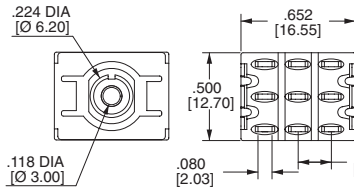
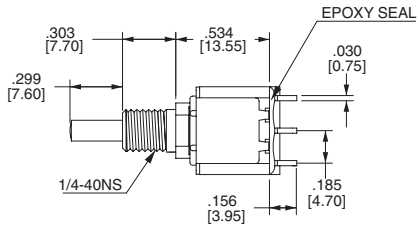

M6

SINGLE POLE

PC MOUNTING

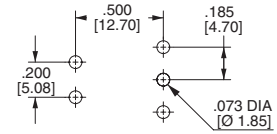
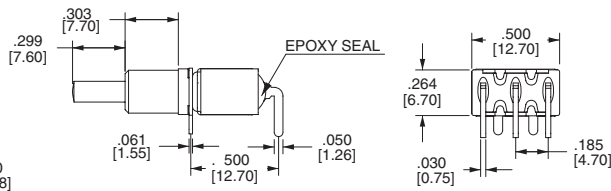
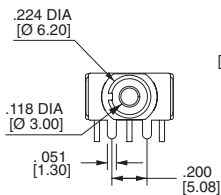

DOUBLE POLE

PC MOUNTING

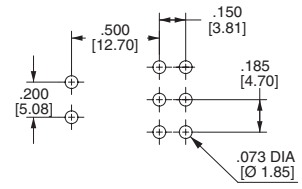
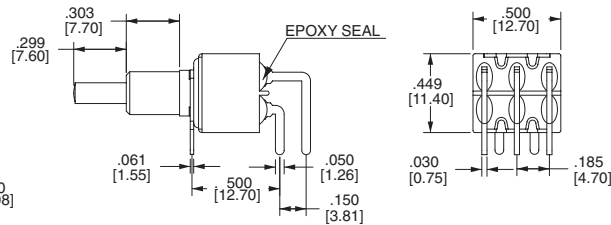
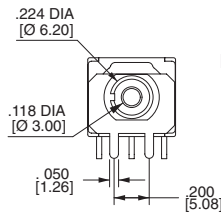

3MA-Series Dimensional Specifications: in. [mm]

TERMINATION

M7

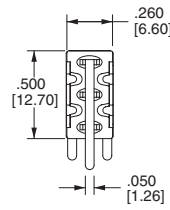
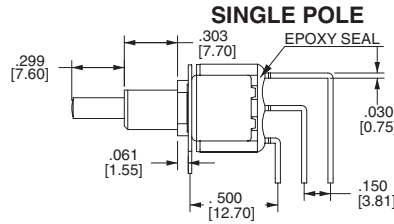
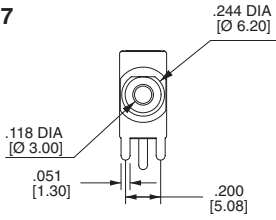

PC MOUNTING

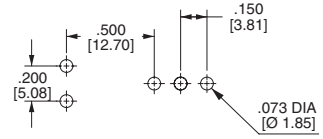

DOUBLE POLE

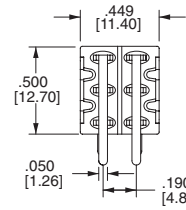
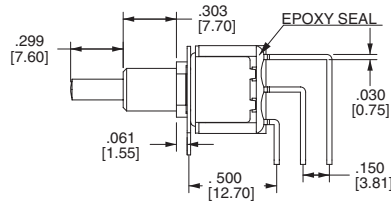
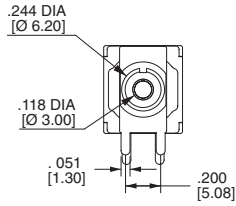

PC MOUNTING

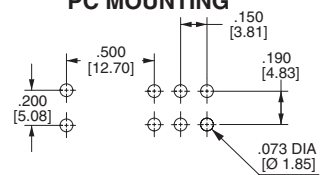

THREE POLE

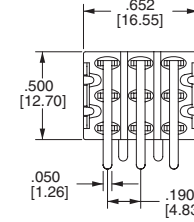
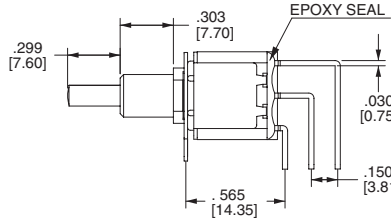
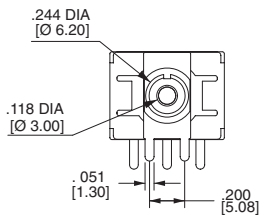

PC MOUNTING

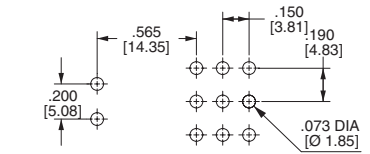

FOUR POLE

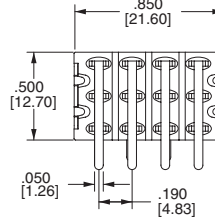
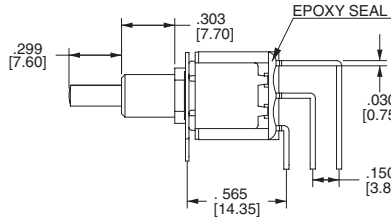
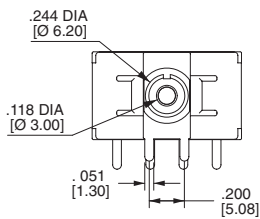

PC MOUNTING

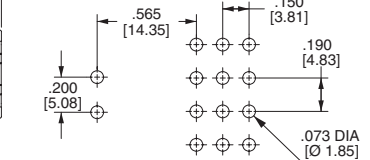

VS2-VS3

OPTION CODE	DIM. "A"
VS2	.460 [11.68]
VS3	.630 [16.00]

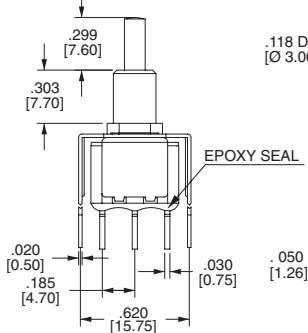

SINGLE POLE

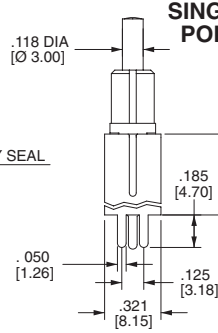

PC MOUNTING

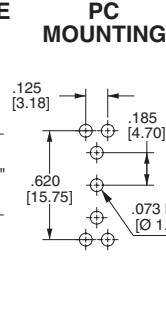

DOUBLE POLE

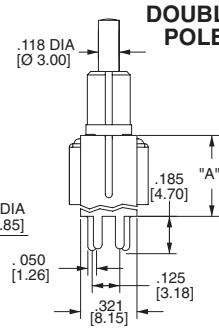

PC MOUNTING

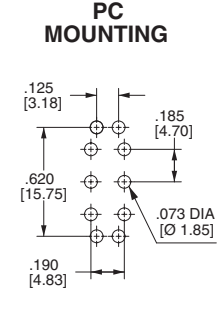

VS4-VS5

OPTION CODE	DIM. "A"
VS4	.460 [11.68]
VS5	.630 [16.00]

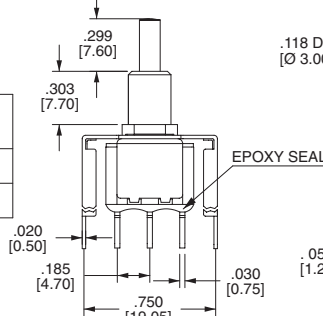

SINGLE POLE

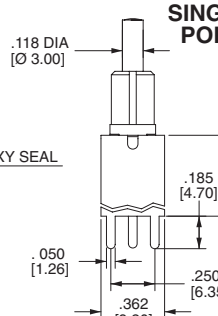

PC MOUNTING

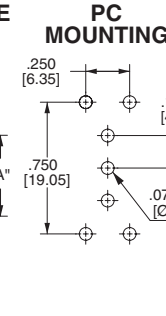

DOUBLE POLE

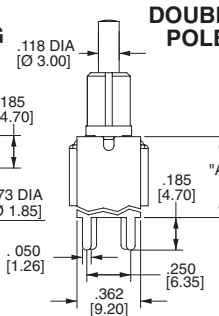

PC MOUNTING

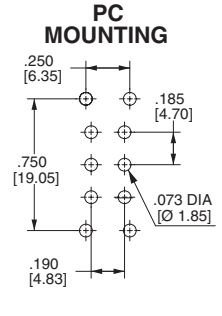

Данный компонент на территории Российской Федерации

Вы можете приобрести в компании MosChip.

Для оперативного оформления запроса Вам необходимо перейти по данной ссылке:

<http://moschip.ru/get-element>

Вы можете разместить у нас заказ для любого Вашего проекта, будь то серийное производство или разработка единичного прибора.

В нашем ассортименте представлены ведущие мировые производители активных и пассивных электронных компонентов.

Нашей специализацией является поставка электронной компонентной базы двойного назначения, продукции таких производителей как XILINX, Intel (ex.ALTERA), Vicor, Microchip, Texas Instruments, Analog Devices, Mini-Circuits, Amphenol, Glenair.

Сотрудничество с глобальными дистрибьюторами электронных компонентов, предоставляет возможность заказывать и получать с международных складов практически любой перечень компонентов в оптимальные для Вас сроки.

На всех этапах разработки и производства наши партнеры могут получить квалифицированную поддержку опытных инженеров.

Система менеджмента качества компании отвечает требованиям в соответствии с ГОСТ Р ИСО 9001, ГОСТ РВ 0015-002 и ЭС РД 009

Офис по работе с юридическими лицами:

105318, г.Москва, ул.Щербаковская д.3, офис 1107, 1118, ДЦ «Щербаковский»

Телефон: +7 495 668-12-70 (многоканальный)

Факс: +7 495 668-12-70 (доб.304)

E-mail: info@moschip.ru

Skype отдела продаж:

moschip.ru

moschip.ru_4

moschip.ru_6

moschip.ru_9