

# VARIOCON

## Modular Contact Inserts

### 1. Short Description

The modular contact inserts are based on the tried-and-tested COMBICON technology. They are available with the screw connection system and on the equipment side also as a solder in version.

The sleeve or mounting contact inserts are snapped into the correct frames and are then simple to assemble and mount. The modules are easy to unsnap with a screwdriver.

All contact inserts can be equipped with coding profiles. This rules out the possibility of mixing up several plug connectors.

The modules can be individually labeled using the corresponding marker cards SK...

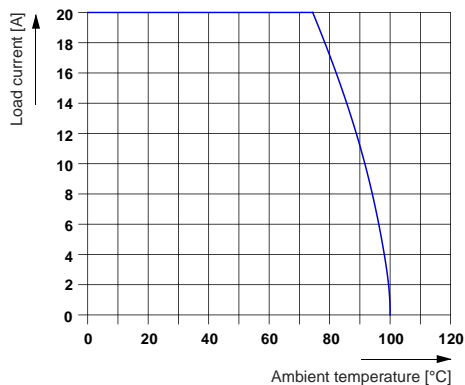

Derating curve VC-TFS 2 / VC-AML 2 / VC-AMS 2

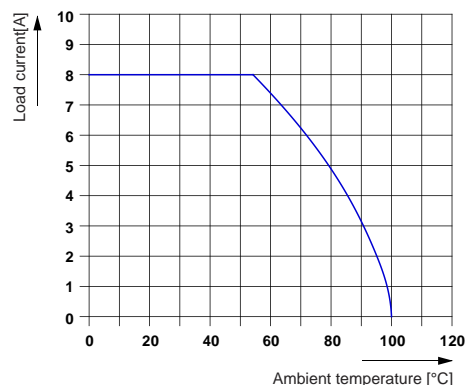

Derating curve VC-TFS HC 8 / VC-AML 8 / VC-AMS 8

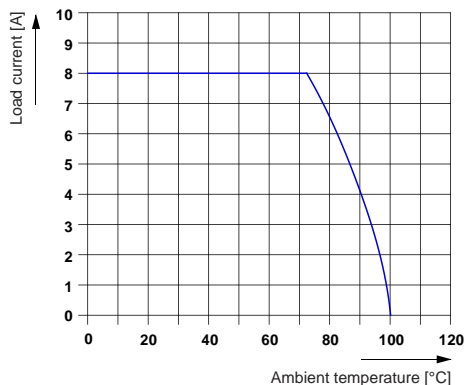

Derating curve VC-TFS HC 6 / VC-AML 6 / VC-AMS 6

# VARIOCON

## Sleeve Contact Insert with Screw Terminal Blocks



Description	Number of positions	Type	Order No.	Pcs./Pkt.
<b>Contact insert</b> , for sleeve frames	2	<b>VC-TFS 2</b>	<b>18 52 84 6</b>	10
	6	<b>VC-TFS 6</b>	<b>18 53 47 6</b>	
	8	<b>VC-TFS 8</b>	<b>18 52 82 0</b>	
<b>Accessories</b>				
<b>Coding section</b> , for VC-...2, is inserted into the groove on the connector and header, red insulating material		<b>CP-HCC 4</b>	<b>16 00 02 7</b>	100
<b>Coding section</b> , for VC-...6/8, is inserted into the groove on the header, red insulating material		<b>CP-MSTB</b>	<b>17 34 63 4</b>	100

### Technical data

#### Design

#### Technical data in accordance with IEC/ DIN VDE

		VC-TFS 2	VC-TFS 6	VC-TFS 8
Rated current	[A]	20	8	8
Rated voltage	[V]	400	250	160
Surge voltage category / contamination class		III / 3	III / 3	III / 3
Rated surge voltage / insulation material group	[kV] / -	6 / I	4 / I	2.5 / I
<b>Connection capacity</b>				
Solid / Stranded	[mm <sup>2</sup> ] / [mm <sup>2</sup> ]	0.2 - 4.0 / 0.2 - 1.5	0.14 - 1.5 / 0.14 - 1.5	0.14 - 1.5 / 0.14 - 1.5
	AWG / AWG	24 - 12 / 24 - 16	28 - 16 / 28 - 16	28 - 16 / 28 - 16
<b>Multiple connection (2 conductors with same cross section)</b>				
Solid / Stranded	[mm <sup>2</sup> ] / [mm <sup>2</sup> ]	0.2 - 2.5 / 0.2 - 1.5	0.14 - 0.5 / 0.14 - 0.75	0.14 - 0.5 / 0.14 - 0.75
	AWG / AWG	24 - 14 / 24 - 16	28 - 20 / 28 - 18	28 - 20 / 28 - 18
Stranded with ferrule without plastic sleeve	[mm <sup>2</sup> ] / [mm <sup>2</sup> ]	0.25 - 1.5	0.25 - 0.34	0.25 - 0.34
	AWG / AWG	24 - 16	24 - 20	24 - 20
Stranded with TWIN ferrule with plastic sleeve	[mm <sup>2</sup> ] / [mm <sup>2</sup> ]	0.5 - 2.5	0.5	0.5
	AWG / AWG	20 - 14	20	20
<b>Insulating material</b>				
Inflammability class in acc. with UL 94		PA	PA	PA
		V0	V0	V0
<b>Approval data (UL and CUL)</b>				
Nom. voltage / nom. current / conduc. cross sec.	UL: [V] / [A] / AWG	600 / 20 / 30-10	300 / 8 / 30-14	300 / 8 / 30-14
	CUL: [V] / [A] / AWG	600 / 20 / 30-10	300 / 8 / 30-14	300 / 8 / 30-14
<b>Torque</b>	[Nm]	0.5 - 0.6	0.22 - 0.25	0.22 - 0.25
<b>Approvals</b>				

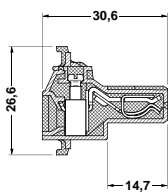

VC-TFS 2

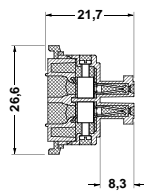
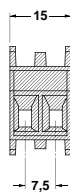

VC-TFS 6

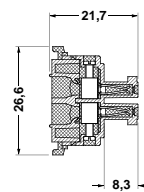

VC-TFS 8



# VARIOCON

## Mounting Contact Insert with Screw Terminal Blocks



Description	Number of positions	Type	Order No.	Pcs./Pkt.
<b>Contact insert</b> , for panel mounting frames	2	<b>VC-AMS 2</b>	<b>18 53 52 8</b>	10
	6	<b>VC-AMS 6</b>	<b>18 54 01 9</b>	
	8	<b>VC-AMS 8</b>	<b>18 54 02 2</b>	
<b>Accessories</b>				
<b>Coding section</b> , for VC-...2, is inserted into the groove on the connector and header, red insulating material		<b>CP-HCC 4</b>	<b>16 00 02 7</b>	100
<b>Coding section</b> , for VC-...6/8, is inserted into the groove on the header, red insulating material		<b>CP-MSTB</b>	<b>17 34 63 4</b>	100

### Technical data

#### Design

#### Technical data in accordance with IEC/ DIN VDE

		VC-AMS 2	VC-AMS 6	VC-AMS 8
Rated current	[A]	20	8	8
Rated voltage	[V]	400	250	160
Surge voltage category / contamination class		III / 3	III / 3	III / 3
Rated surge voltage / insulation material group	[kV] / -	6 / I	4 / I	2.5 / I
<b>Connection capacity</b>				
Solid / Stranded	[mm <sup>2</sup> ] / [mm <sup>2</sup> ]	0.2 - 4.0 / 0.2 - 1.5	0.14 - 1.5 / 0.14 - 1.5	0.14 - 1.5 / 0.14 - 1.5
	AWG / AWG	24 - 12 / 24 - 16	28 - 16 / 28 - 16	28 - 16 / 28 - 16
<b>Multiple connection (2 conductors with same cross section)</b>				
Solid / Stranded	[mm <sup>2</sup> ] / [mm <sup>2</sup> ]	0.2 - 2.5 / 0.2 - 1.5	0.14 - 0.5 / 0.14 - 0.75	0.14 - 0.5 / 0.14 - 0.75
	AWG / AWG	24 - 14 / 24 - 16	28 - 20 / 28 - 18	28 - 20 / 28 - 18
Stranded with ferrule without plastic sleeve	[mm <sup>2</sup> ] / [mm <sup>2</sup> ]	0.25 - 1.5	0.25 - 0.34	0.25 - 0.34
	AWG / AWG	24 - 16	24 - 20	24 - 20
Stranded with TWIN ferrule with plastic sleeve	[mm <sup>2</sup> ] / [mm <sup>2</sup> ]	0.5 - 2.5	0.5	0.5
	AWG / AWG	20 - 14	20	20
<b>Insulating material</b>				
Inflammability class in acc. with UL 94		PA	PA	PA
		V0	V0	V0
<b>Approval data (UL and CUL)</b>				
Nom. voltage / nom. current / conduc. cross sec.	UL: [V] / [A] / AWG	600 / 20 / 30-10	300 / 8 / 30-14	300 / 8 / 30-14
	CUL: [V] / [A] / AWG	600 / 20 / 30-10	300 / 8 / 30-14	300 / 8 / 30-14
<b>Torque</b>	[Nm]	0.5 - 0.6	0.22 - 0.25	0.22 - 0.25
<b>Approvals</b>				

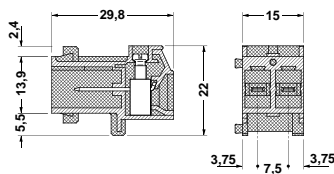

VC-AMS 2

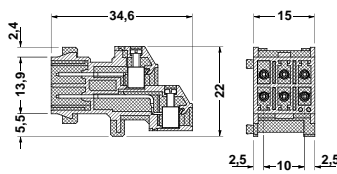

VC-AMS 6

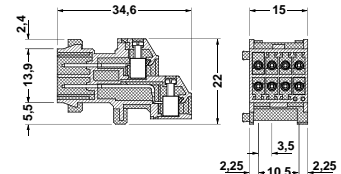

VC-AMS 8

# VARIOCON

## Mounting Contact Insert with 90° Angled Solder-In Pins



Description	Number of positions	Type	Order No.	Pcs./Pkt.
<b>Contact insert</b> , for mounting panel frames	2	VC-AML 2	18 52 85 9	10
	6	VC-AML 6	18 53 53 1	
	8	VC-AML 8	18 52 83 3	
<b>Accessories</b>				
<b>Coding section</b> , for VC-...2, is inserted into the groove on the connector and header, red insulating material		CP-HCC 4	16 00 02 7	100
<b>Coding section</b> , for VC-...6/8, is inserted into the groove on the header, red insulating material		CP-MSTB	17 34 63 4	100

### Technical data

Design		VC-AML 2	VC-AML 6	VC-AML 8
Dimensions solder-in pins	[mm] x [mm]	2 x 0.8	0.8 x 0.8	0.8 x 0.8
Hole diameter	[mm]	1.4	1.4	1.2
<b>Technical data in accordance with IEC/ DIN VDE</b>				
Rated current	[A]	20	8	8
Rated voltage	[V]	400	250	160
Surge voltage category / contamination class		III / 3	III / 3	III / 3
Rated surge voltage / insulation material group	[kV] / -	6 / I	4 / I	2.5 / I
<b>Insulating material</b>		PA	PA	PA
Inflammability class in acc. with UL 94		V0	V0	V0
<b>Approval data (UL and CUL)</b>				
Nom. voltage / nom. current / conduc. cross sec.	UL: [V] / [A] / AWG	600 / 20 / -	300 / 8 / -	300 / 8 / -
	CUL: [V] / [A] / AWG	600 / 20 / -	300 / 8 / -	300 / 8 / -
<b>Approvals</b>				

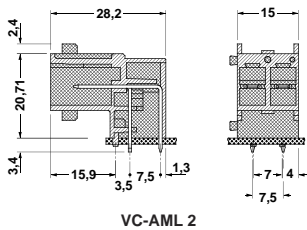

VC-AML 2

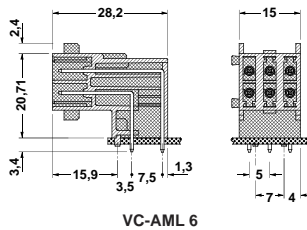

VC-AML 6

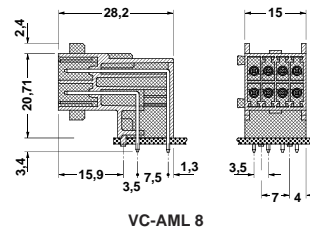

VC-AML 8

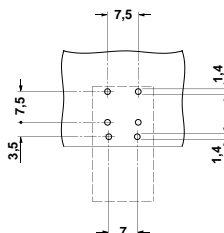

Drilling diagram VC-AML 2

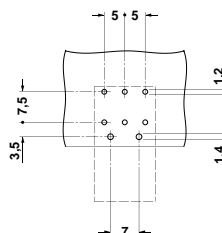

Drilling diagram VC-AML 6

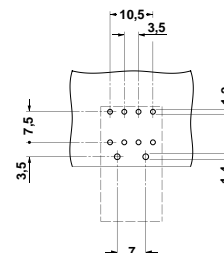

Drilling diagram VC-AML 8

# VARIOCON

## Mounting Contact Insert with Straight Solder-In Pins



Description	Number of positions	Type	Order No.	Pcs./Pkt.
<b>Contact insert</b> , for panel mounting frames	2	VC-AMLV 2	18 84 97 9	10
	6	VC-AMLV 6	18 84 87 2	
	8	VC-AMLV 8	18 84 88 5	
<b>Accessories</b>				
<b>Coding section</b> , for VC-...2, is inserted into the groove on the connector and header, red insulating material		CP-HCC 4	16 00 02 7	100
<b>Coding section</b> , for VC-...6/8, is inserted into the groove on the header, red insulating material		CP-MSTB	17 34 63 4	100

### Technical data

Design		VC-AMLV 2	VC-AMLV 6	VC-AMLV 8
Dimensions solder-in pins	[mm] x [mm]	2 x 0.8	0.8 x 0.8	0.8 x 0.8
Hole diameter	[mm]	1.4	1.4	1.2
<b>Technical data in accordance with IEC/ DIN VDE</b>				
Rated current	[A]	20	8	8
Rated voltage	[V]	400	250	160
Surge voltage category / contamination class <sup>1)</sup>		III / 3	III / 3	III / 3
Rated surge voltage / insulation material group	[kV] / -	6 / I	4 / I	2.5 / I
<b>Insulating material</b>		PA	PA	PA
Inflammability class in acc. with UL 94		V0	V0	V0
<b>Approval data (UL and CUL)</b>				
Nom. voltage / nom. current / conduc. cross sec.	UL: [V] / [A] / AWG	600 / 20 / -	300 / 8 / -	300 / 8 / -
	CUL: [V] / [A] / AWG	600 / 20 / -	300 / 8 / -	300 / 8 / -

### Approvals

<sup>1)</sup> In the 2 and 6-pos. constellation, as well as in the 2 and 8-pos. versions, there is a reduction in the air and creepage distances. The contamination class is thus reduced to 2 and the surge voltage category to II.

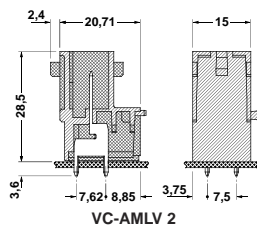

VC-AMLV 2

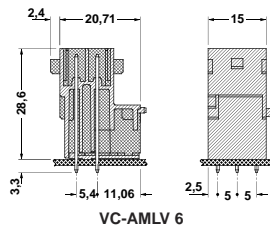

VC-AMLV 6

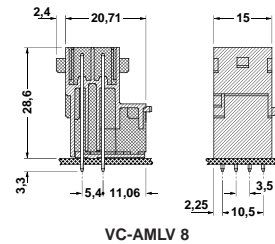

VC-AMLV 8

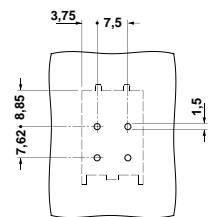

Drilling diagram VC-AMLV 2

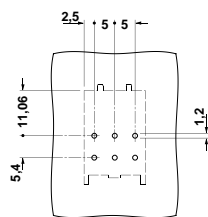

Drilling diagram VC-AMLV 6

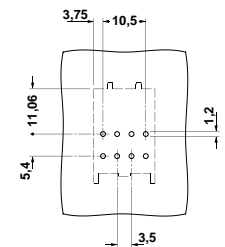

Drilling diagram VC-AMLV 8

## Данный компонент на территории Российской Федерации

### Вы можете приобрести в компании MosChip.

Для оперативного оформления запроса Вам необходимо перейти по данной ссылке:

<http://moschip.ru/get-element>

Вы можете разместить у нас заказ для любого Вашего проекта, будь то серийное производство или разработка единичного прибора.

В нашем ассортименте представлены ведущие мировые производители активных и пассивных электронных компонентов.

Нашей специализацией является поставка электронной компонентной базы двойного назначения, продукции таких производителей как XILINX, Intel (ex.ALTERA), Vicor, Microchip, Texas Instruments, Analog Devices, Mini-Circuits, Amphenol, Glenair.

Сотрудничество с глобальными дистрибьюторами электронных компонентов, предоставляет возможность заказывать и получать с международных складов практически любой перечень компонентов в оптимальные для Вас сроки.

На всех этапах разработки и производства наши партнеры могут получить квалифицированную поддержку опытных инженеров.

Система менеджмента качества компании отвечает требованиям в соответствии с ГОСТ Р ИСО 9001, ГОСТ РВ 0015-002 и ЭС РД 009

### Офис по работе с юридическими лицами:

105318, г.Москва, ул.Щербаковская д.3, офис 1107, 1118, ДЦ «Щербаковский»

Телефон: +7 495 668-12-70 (многоканальный)

Факс: +7 495 668-12-70 (доб.304)

E-mail: [info@moschip.ru](mailto:info@moschip.ru)

Skype отдела продаж:

moschip.ru

moschip.ru\_4

moschip.ru\_6

moschip.ru\_9