

AA SERIES PHOTOCONTROL

THERMAL, BUTTON STYLE, WIRE - IN DESIGN

KEY FEATURES

- 3/4in long threaded nipple
- 30 - 45 second time delay
- UL and CSA Listed
- Durable polycarbonate housing
- 1800 and 1200 watt load rating
- Fail mode is ON

TE Connectivity's (TE) AA Series offers a unique button style design for internal post fixtures or mounting applications. Common uses include decorative light fixtures, post lanterns, wall mount applications, and other commercial and residential uses. TE's innovative design with the wire leads exiting from the rear allow the control to be placed in tight locations while positioning the wiring for easy access.

The AA Series photocontrol is constructed of a high impact UV stabilized polycarbonate housing for superior quality. The 105W and 1068W controls include a brushed aluminum wall plate for installation in standard outlet boxes.

The 105M and 1068M are equipped with a 180 Joule Metal Oxide Varistor (MOV) and are designed to protect luminaries where transient voltage surges are a frequent and recurring problem.

The 105HA is a high ambient temperature photocontrol, designed specifically to last longer in today's hotter running HID luminaries. This unit incorporates insulation and heat sink to absorb the heat generated by the lamp and other components, significantly adding to the control's useful life.

Customers can count on consistent, high quality products, driven by TE's proven innovation and backed by our extraordinary customer support.



TE's photocontrols can be used to safely control luminaries with incandescent, HID, LED, or compact fluorescent lamps.

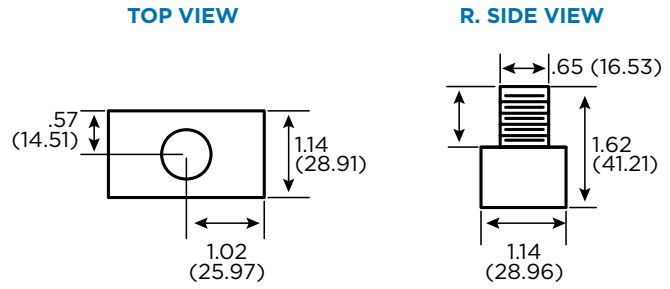

Dimensions shown in inches (mm)

PRODUCT SELECTION INFORMATION								
Description	Product Information	Rated Volts	Range (Volts)	Load Rating Tungsten (Watts)	Load Rating Ballast (VA)	Surge Protection (Joules)	Turn ON (Fc)	OFF/ON Ratio
AA-105		120	105 - 130	1800	1100		1.5	4 : 1
AA-105W	w/Wall Plate	120	105 - 130	1800	1100		1.5	4 : 1
AA-1068		208/240/277	185 - 305	1200	1100		1.5	4 : 1
AA-1068W	w/Wall Plate	208/240/277	185 - 305	1200	1100		1.5	4 : 1
AA-305		120	105 - 130	300	840		1.5	4 : 1
AA-105M	15" Leads	120	105 - 130	1800	1100	180	1.5	4 : 1
AA-1068M	15" Leads	208/240/277	185 - 305	1200	1100	180	1.5	4 : 1
AA-105HA	High Ambient	120	105 - 130	1800	1100		1.5	4 : 1

Note: 6" lead wires unless otherwise noted

SPECIFICATION	
Physical	Dimensions: approx. 2.05" [51.94mm] dia. x 1.62" [41.21mm] high (Not including wiring)
	Enclosure: designed to meet ANSI C136.24, UL 773A
	Power consumption: less than 0.9 watts at 120 VAC
Temperature	Minus 40°C to plus 65°C at 96% RH
Control	Thermal State Switch Type
Light Sensor	Cadmium Sulfide Cell

TECHNICAL INFORMATION	
Switch	SPST thermal bi-metallic, exceeds 7,500 ON/OFF operations
Fail Mode	ON (contacts normally closed)
Housing	Polycarbonate with UV stabilized window
Lead Wires	6", #18 AWG, rated 105°C (AA controls) 15", #18 AWG, rated 105°C (AA-M controls) 6", #18 AWG, rated 150°C (AA-HA controls)
Nipple	3/8" pipe
Nut	3/8" pipe, thermoplastic
Light Sensor	1/2" Cadmium sulfide (Cds) cell



te.com/energy

©2008, 2012, 2014 TE Connectivity Ltd. family of companies. All Rights Reserved. 7-1773453-6 E328 10/2014

TE Connectivity and TE connectivity (logo) are trademarks. Other logos, product and/or company names might be trademarks of their respective owners. While TE has made every reasonable effort to ensure the accuracy of the information in this brochure, TE does not guarantee that it is error-free, nor does TE make any other representation, warranty or guarantee that the information is accurate, correct, reliable or current. TE reserves the right to make any adjustments to the information contained herein at any time without notice. TE expressly disclaims all implied warranties regarding the information contained herein, including, but not limited to, any implied warranties of merchantability or fitness for a particular purpose. The dimensions in this catalog are for reference purposes only and are subject to change without notice. Specifications are subject to change without notice. Consult TE for the latest dimensions and design specifications.

FOR MORE INFORMATION: TE Technical Support Centers

USA: +1 800 327 6996
 France: +33 380 583 200
 UK: +44 0870 870 7500
 Germany: +49 896 089 903
 Spain: +34 916 630 400
 Benelux: +32 16 351 731
 Canada: +1 (905) 475-6222
 Mexico: +52 (0) 55-1106-0800
 Latin/S. America: +54 (0) 11-4733-2200
 China: +86 (0) 400-820-6015

Данный компонент на территории Российской Федерации

Вы можете приобрести в компании MosChip.

Для оперативного оформления запроса Вам необходимо перейти по данной ссылке:

<http://moschip.ru/get-element>

Вы можете разместить у нас заказ для любого Вашего проекта, будь то серийное производство или разработка единичного прибора.

В нашем ассортименте представлены ведущие мировые производители активных и пассивных электронных компонентов.

Нашей специализацией является поставка электронной компонентной базы двойного назначения, продукции таких производителей как XILINX, Intel (ex.ALTERA), Vicor, Microchip, Texas Instruments, Analog Devices, Mini-Circuits, Amphenol, Glenair.

Сотрудничество с глобальными дистрибьюторами электронных компонентов, предоставляет возможность заказывать и получать с международных складов практически любой перечень компонентов в оптимальные для Вас сроки.

На всех этапах разработки и производства наши партнеры могут получить квалифицированную поддержку опытных инженеров.

Система менеджмента качества компании отвечает требованиям в соответствии с ГОСТ Р ИСО 9001, ГОСТ РВ 0015-002 и ЭС РД 009

Офис по работе с юридическими лицами:

105318, г.Москва, ул.Щербаковская д.3, офис 1107, 1118, ДЦ «Щербаковский»

Телефон: +7 495 668-12-70 (многоканальный)

Факс: +7 495 668-12-70 (доб.304)

E-mail: info@moschip.ru

Skype отдела продаж:

moschip.ru

moschip.ru_4

moschip.ru_6

moschip.ru_9