



Main

| | |
|------------------------------------|--|
| Range of product | OsiSense XT |
| Sensor type | Capacitive proximity sensor |
| Product specific application | Detection of insulated or conductive materials |
| Sensor name | XT2 |
| Sensor design | Cylindrical Ø 32 mm plain |
| Size | 80 mm |
| Body type | Fixed |
| Detector flush mounting acceptance | Non flush mountable |
| Material | Plastic |
| Enclosure material | Plastic |
| Type of output signal | Discrete |
| Wiring technique | 2-wire |
| [Sn] nominal sensing distance | 0.79 in (20 mm) |
| Discrete output function | 1 NO |
| Output circuit type | AC |
| Electrical connection | Cable |
| Cable length | 6.56 ft (2 m) |
| [Us] rated supply voltage | 24 V DC 24...240 V AC 50...60 Hz |
| Delay response | < 30 ms |
| IP degree of protection | IP67 double insulation conforming to IEC 60529 |

Complementary

| | |
|---------------------------------|--|
| Detection face | Frontal |
| [Sa] assured operating distance | 0...0.59 in (0...15 mm) |
| Adjustment zone | 0...0.87 in (0...22 mm) |
| Differential travel | < 1...20 % Sr |
| Repeat accuracy | < 5 % Sr |
| Wire insulation material | PVC |
| Status LED | 1 LED (yellow) output state indication |
| Supply voltage limits | 20...265 V AC |
| Switching frequency | <= 15 Hz |
| Voltage drop | < 10 V (closed) |
| Current consumption | < 4 mA |
| Delay first up | < 200 ms |
| Delay recovery | < 30 ms |
| Maximum switching current | 300 mA |
| Marking | CE |
| Setting-up | Sensitivity by potentiometer |
| Length | 3.15 in (80 mm) |
| Product weight | 0.88 lb(US) (0.4 kg) |

Environment

| | |
|---------------------------------------|---|
| standards | EN/IEC 60947-5-2 |
| product certifications | CULus |
| ambient air temperature for operation | 14...140 °F (-10...60 °C) |
| vibration resistance | 10 gn amplitude = 1 mm (10...55 Hz) conforming to IEC 60068-2-6 |

The information provided in this documentation contains general descriptions and/or technical characteristics of the products contained herein. This documentation is not intended as a substitute for and is not to be used for determining suitability or reliability of these products for specific user applications. It is the duty of any such user or integrator to perform the appropriate and complete risk analysis, evaluation and testing of the products with respect to the relevant specific application or use thereof. Neither Schneider Electric Industries SAS nor any of its affiliates or subsidiaries shall be responsible or liable for misuse of the information contained herein.

| | |
|---------------------------------------|--|
| shock resistance | 30 gn (duration = 11 ms) conforming to IEC 60068-2-27 |
| resistance to electrostatic discharge | 4 kV (contact) conforming to IEC 61000-4-2 8 kV (air) conforming to IEC 61000-4-2 |
| resistance to electromagnetic fields | 2.74 V/yd (3 V/m) conforming to IEC 61000-4-3 |
| resistance to fast transients | 2 kV conforming to IEC 61000-4-4 |

Offer Sustainability

| | |
|--|--|
| Not Green Premium product | Not Green Premium product |
| Compliant - since 0918 - Schneider Electric declaration of conformity | Compliant - since 0918 - Schneider Electric declaration of conformity |
| WARNING: This product can expose you to chemicals including: | WARNING: This product can expose you to chemicals including: |
| Diisononyl phthalate (DINP), which is known to the State of California to cause cancer, and | Diisononyl phthalate (DINP), which is known to the State of California to cause cancer, and |
| Di-isodecyl phthalate (DIDP), which is known to the State of California to cause birth defects or other reproductive harm. | Di-isodecyl phthalate (DIDP), which is known to the State of California to cause birth defects or other reproductive harm. |
| For more information go to www.p65warnings.ca.gov | For more information go to www.p65warnings.ca.gov |

Contractual warranty

| | |
|-----------------|-----------|
| Warranty period | 18 months |
|-----------------|-----------|

Dimensions

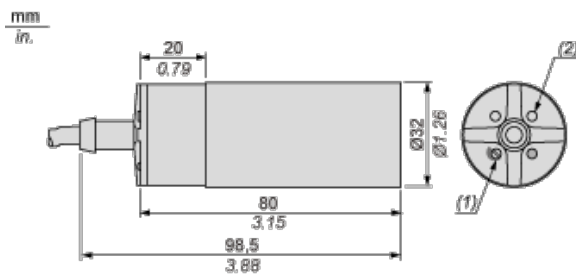

- (1) Adjustment potentiometer
- (2) LED

Mounting Accessory Included

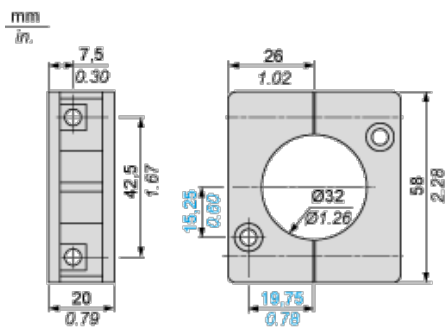

Setting-up

Minimum Mounting Distances (mm)

Side by side

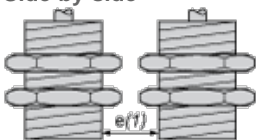

e(1) 65

≥

Face to face

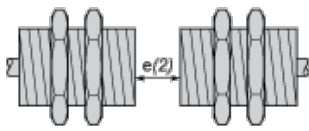

e(2) 120
 \geq

Facing a metal object

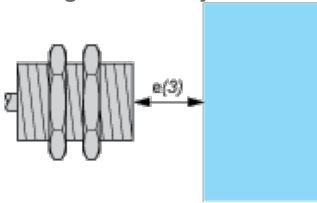

e(3) 60
 \geq

Mounted in support

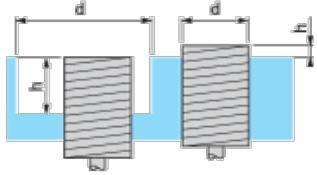

d \geq 100
h \geq 30

Adjustment

Sensitivity Adjustment

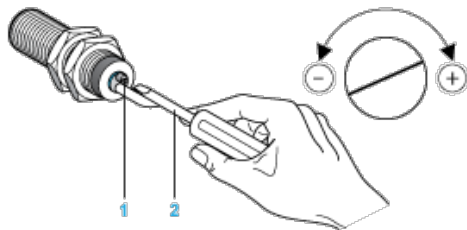

- (1) Adjustment potentiometer
- (2) Screwdriver (included with sensor)

Wiring Diagram

Pre-cabled

2-wire AC NO Output

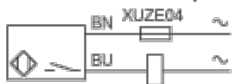

- (BU) Blue
(BN) Brown

Данный компонент на территории Российской Федерации

Вы можете приобрести в компании MosChip.

Для оперативного оформления запроса Вам необходимо перейти по данной ссылке:

<http://moschip.ru/get-element>

Вы можете разместить у нас заказ для любого Вашего проекта, будь то серийное производство или разработка единичного прибора.

В нашем ассортименте представлены ведущие мировые производители активных и пассивных электронных компонентов.

Нашей специализацией является поставка электронной компонентной базы двойного назначения, продукции таких производителей как XILINX, Intel (ex.ALTERA), Vicor, Microchip, Texas Instruments, Analog Devices, Mini-Circuits, Amphenol, Glenair.

Сотрудничество с глобальными дистрибьюторами электронных компонентов, предоставляет возможность заказывать и получать с международных складов практически любой перечень компонентов в оптимальные для Вас сроки.

На всех этапах разработки и производства наши партнеры могут получить квалифицированную поддержку опытных инженеров.

Система менеджмента качества компании отвечает требованиям в соответствии с ГОСТ Р ИСО 9001, ГОСТ РВ 0015-002 и ЭС РД 009

Офис по работе с юридическими лицами:

105318, г.Москва, ул.Щербаковская д.3, офис 1107, 1118, ДЦ «Щербаковский»

Телефон: +7 495 668-12-70 (многоканальный)

Факс: +7 495 668-12-70 (доб.304)

E-mail: info@moschip.ru

Skype отдела продаж:

moschip.ru

moschip.ru_4

moschip.ru_6

moschip.ru_9