

REVISONS		DATE	DNW	APVD
REV	DESCRIPTION			
C	RELEASE PER ECR-10-024107	8/31/2010	FL	SY
C1	RELEASE PER ECR-11-016951	7/20/2011	JJ	SY
D	RELEASED PER ECR-12-000920	11/08/2011	JJ	SY

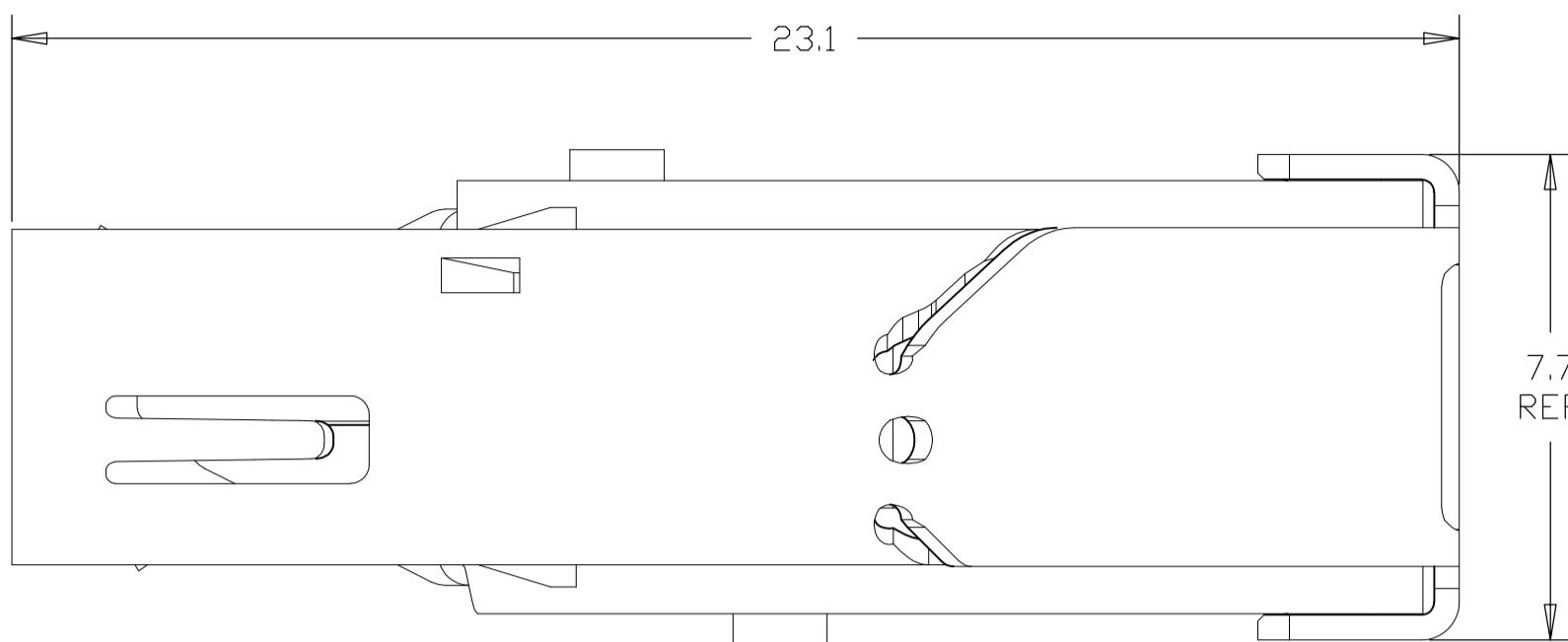

- 1 MATERIALS:  
HOUSING: HIGH TEMP THERMOPLASTIC, UL94V-0, BLACK, PBT.  
CONTACTS: COPPER ALLOY.  
SHIELD: STAINLESS STEEL.
- 2 FINISH:  
CONTACTS:  
MATING AREA: CONFORMS TO HDMI SPECIFICATION VERSION 1.3a TABLE 4-6 AND 4-7 (ELECTRICAL AND ENVIRONMENTAL PERFORMANCE), BASED ON EIA/ECA - 364-1000.01A (CONTROLLED ENVIRONMENT APPLICATIONS).  
SOLDER TAILS: TIN OVER NICKEL.
- 3 INTERFACE DIMENSIONS PER HDMI SPECIFICATION VERSION 1.3a.
- 4 WAVE SOLDER COMPATIBLE PER 109-202. CONDITION B. NO CLEAN FLUX IS RECOMMENDED.
- 5 THIS DIMENSION HAS AN ADDITIONAL 1.0 CLEARANCE OVER HDMI V1.3a SPECIFICATION MAXIMUM CABLE TYPE A PLUG HEIGHT.
- 6 REMOVE CAP IS RECOMMENDED AFTER WAVE SOLDER.
- 7 MATERIALS:  
HOUSING: HIGH TEMP THERMOPLASTIC, UL94V-0, BLACK, LCP.  
CONTACTS: COPPER ALLOY.  
SHIELD: STAINLESS STEEL.
- 8 STAND-OFF AREA.

2007435-1(-4)  
SCALE 6:1

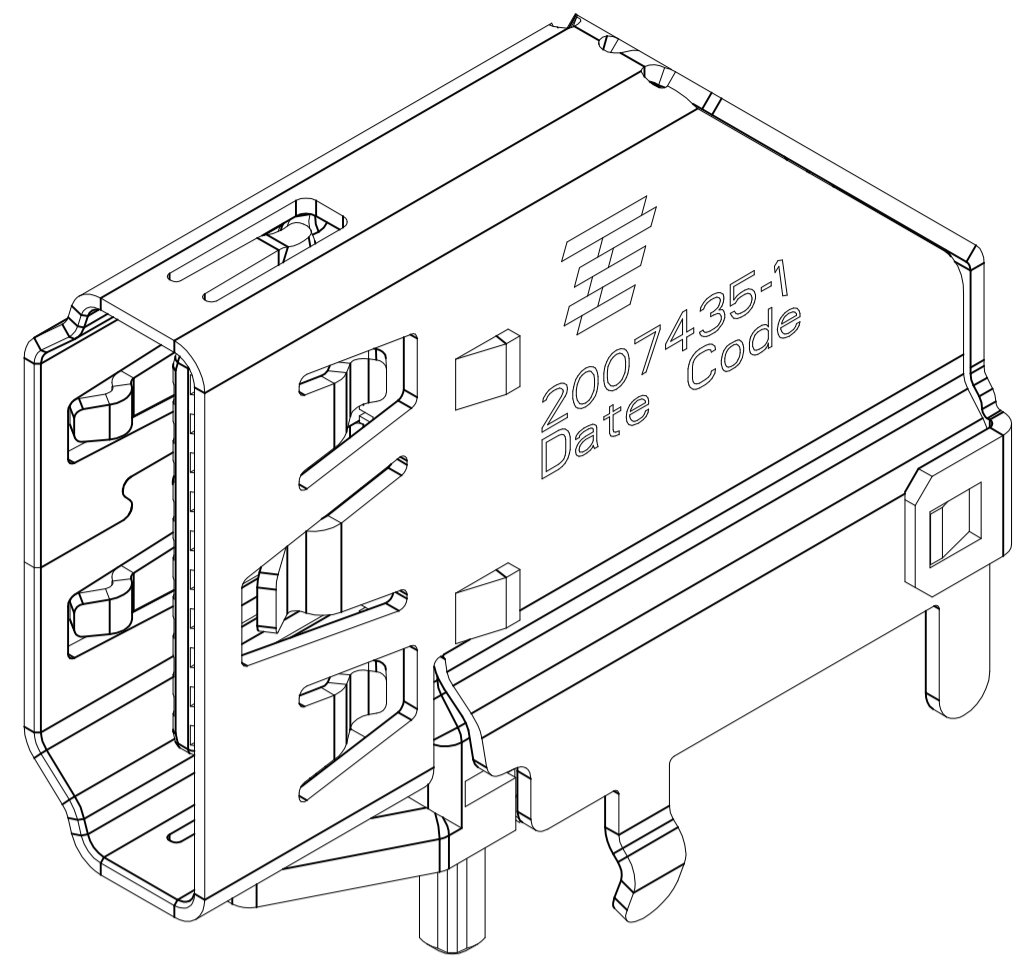
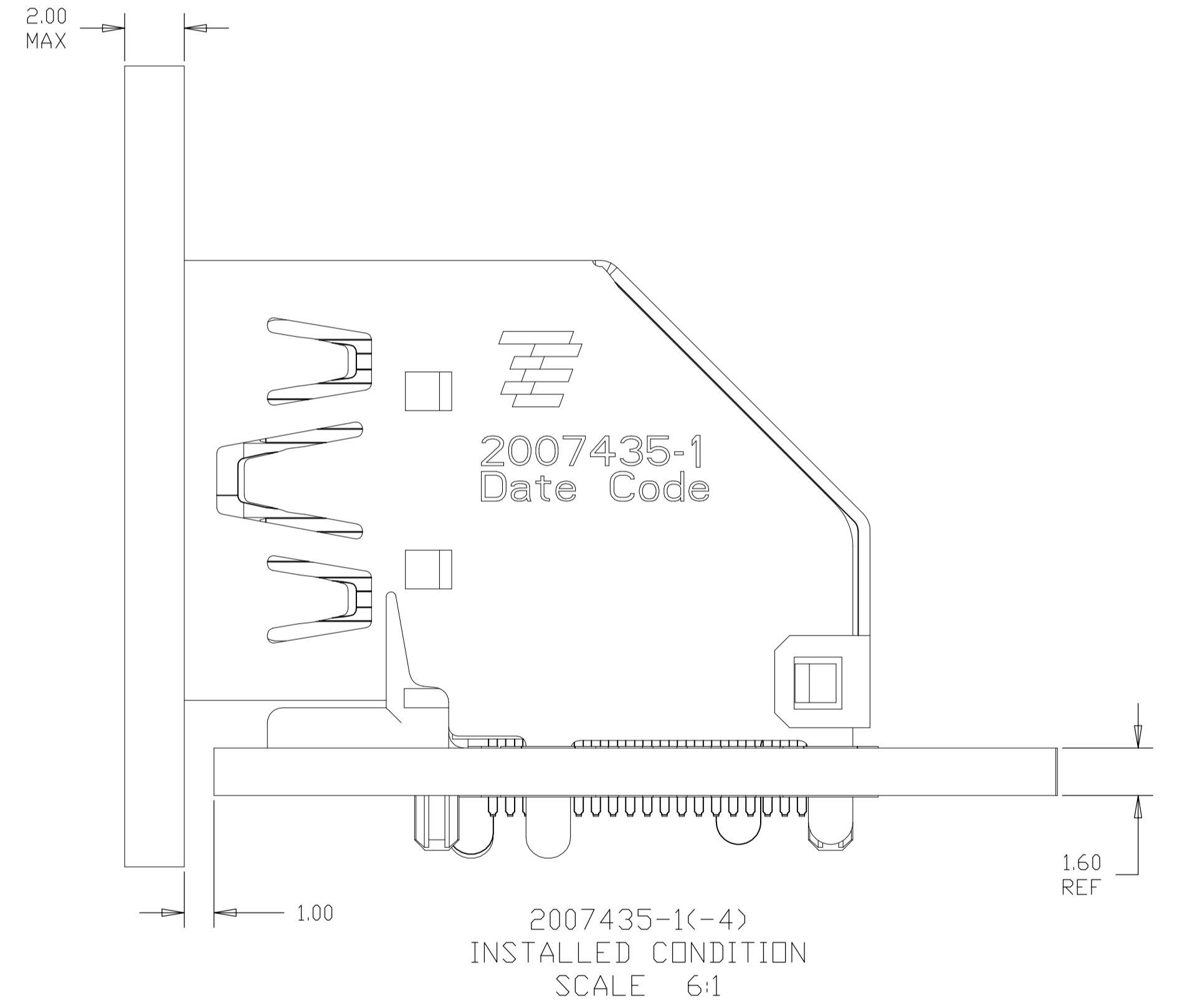
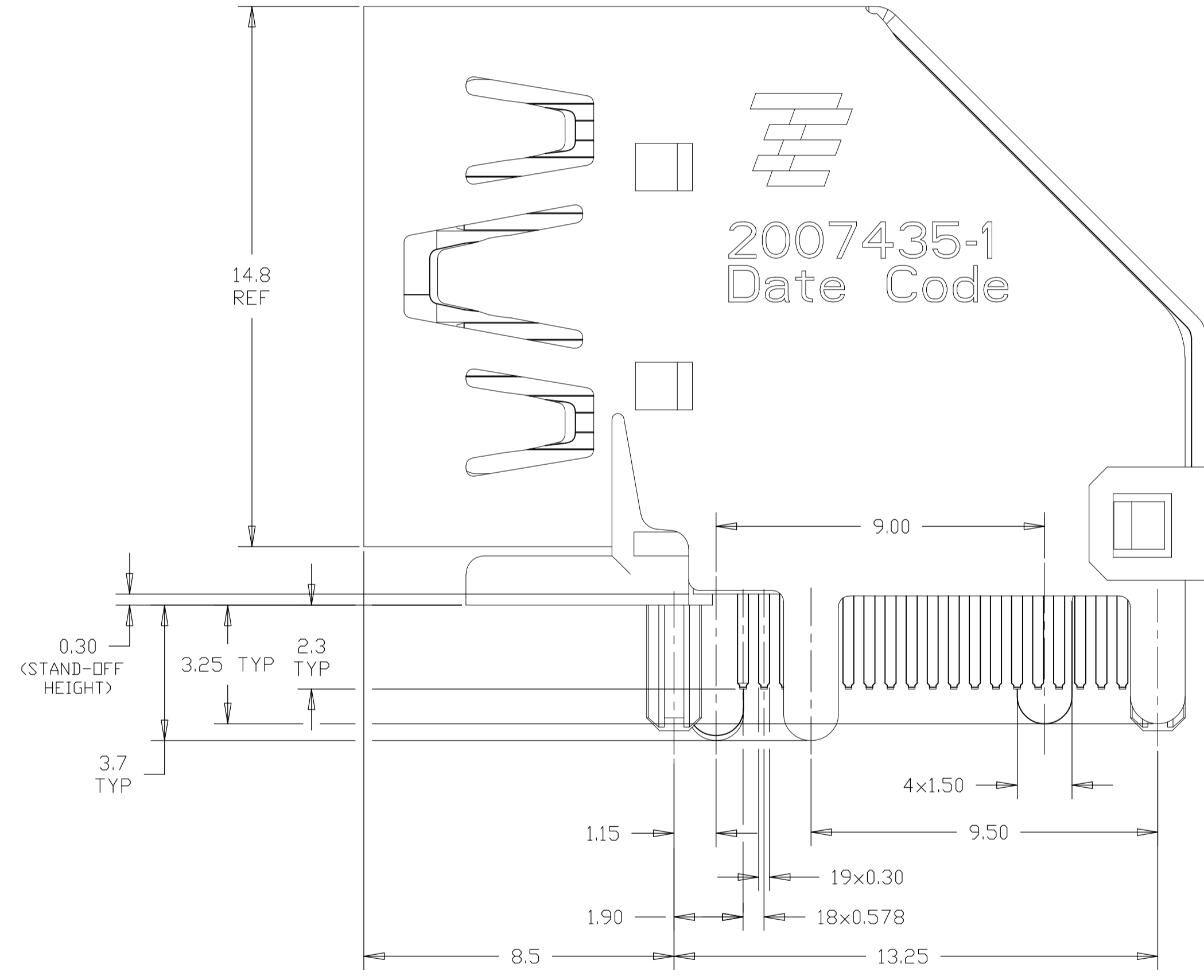
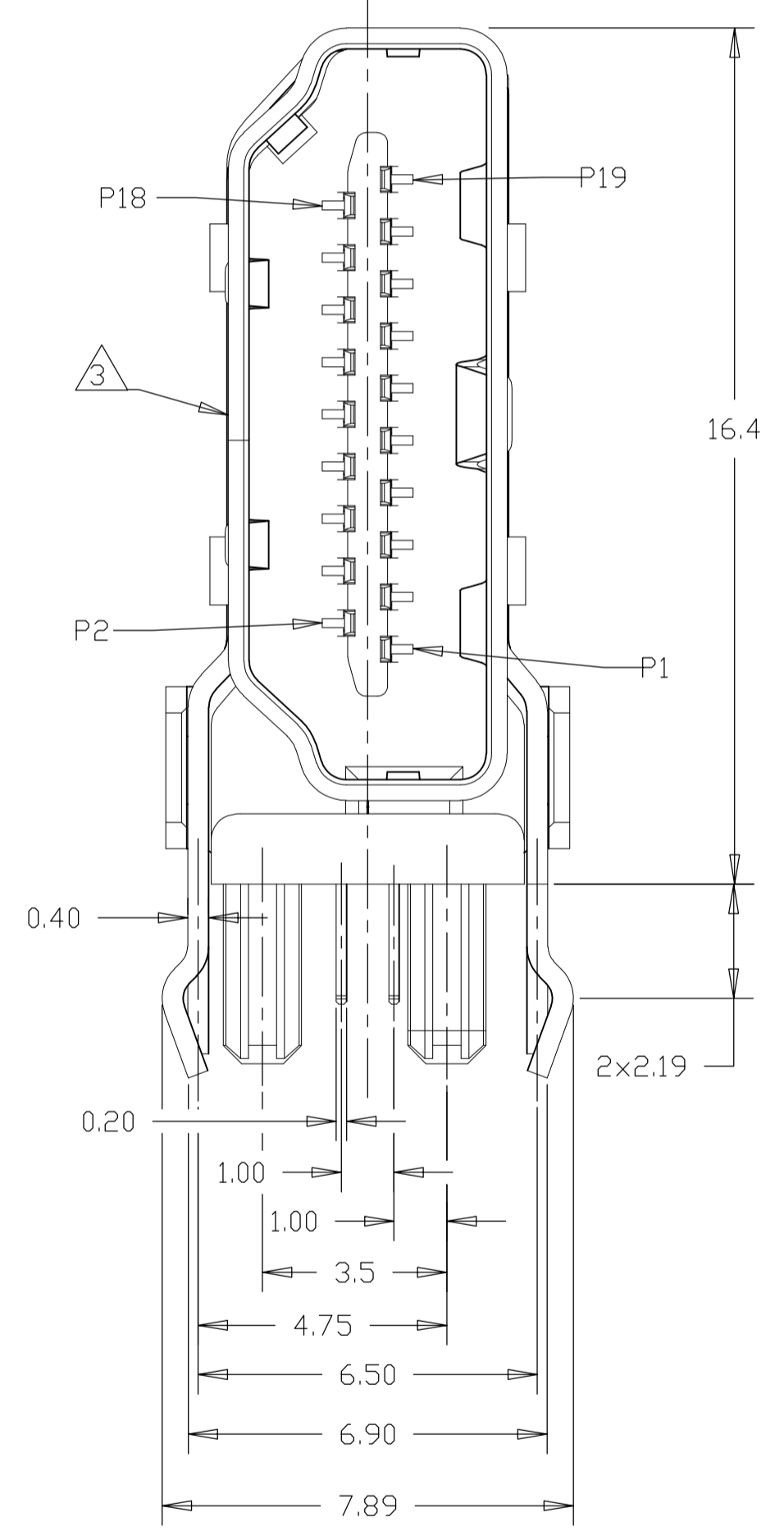

2007435-1(-4)  
INSTALLED CONDITION  
SCALE 6:1

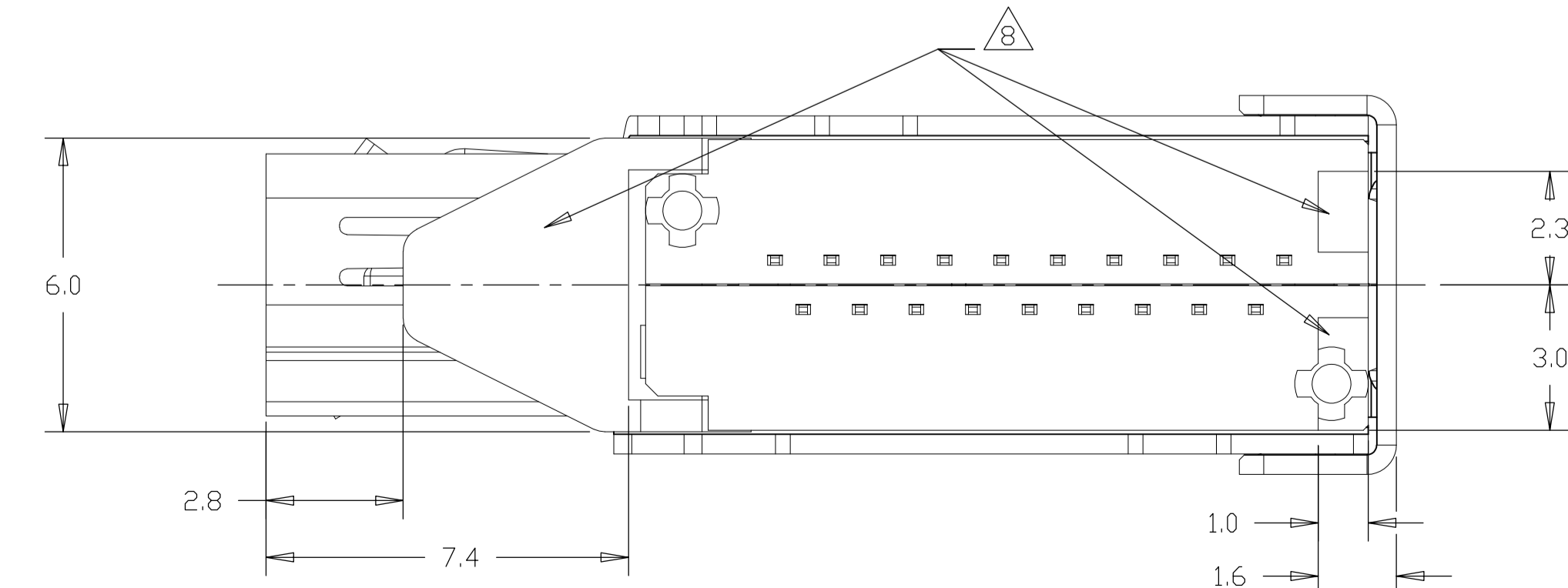

EMBOSS TAPE	WITHOUT POLYIMIDE TAPE	WITHOUT KINK AND WITH CAP	0.38 μm	△	2.00	2007435-7
EMBOSS TAPE	WITH POLYIMIDE TAPE	WITHOUT KINK AND WITHOUT CAP	0.38 μm	△	2.00	2007435-6
TRAY	WITHOUT POLYIMIDE TAPE	WITH KINK AND WITH CAP	0.38 μm	△	1.60	2007435-5
		WITH KINK AND WITHOUT CAP	0.76 μm	△	1.60	2007435-4
		WITHOUT KINK AND WITH CAP	0.38 μm	△	1.60	2007435-3
		WITHOUT KINK AND WITHOUT CAP	0.38 μm	△	2.40	2007435-2
PACKAGE		WITH KINK AND WITHOUT CAP	0.38 μm	△	1.60	2007435-1
REMARK		GOLD PLATING ON CONTACT AREA	MATERIAL	PCB THICKNESS	PART NO.	

THIS DRAWING IS A CONTROLLED DOCUMENT.

Francis Lee 31AUG2010  
Martin Li 31AUG2010  
Steven Yao 31AUG2010

STE TE Connectivity

HDMI FLAG CONNECTOR ASSEMBLY

108-60079

SIZE: A1 CAGE CODE: 00779 DRAWING NO: 2007435

SCALE: 8:1 SHEET: 1 OF 9 REV: D

LOC		DIST		REVISIONS			
P	LTR	DESCRIPTION	DATE	DN	APVD		
-	-	SEE SHEET 1	-	-	-	-	-

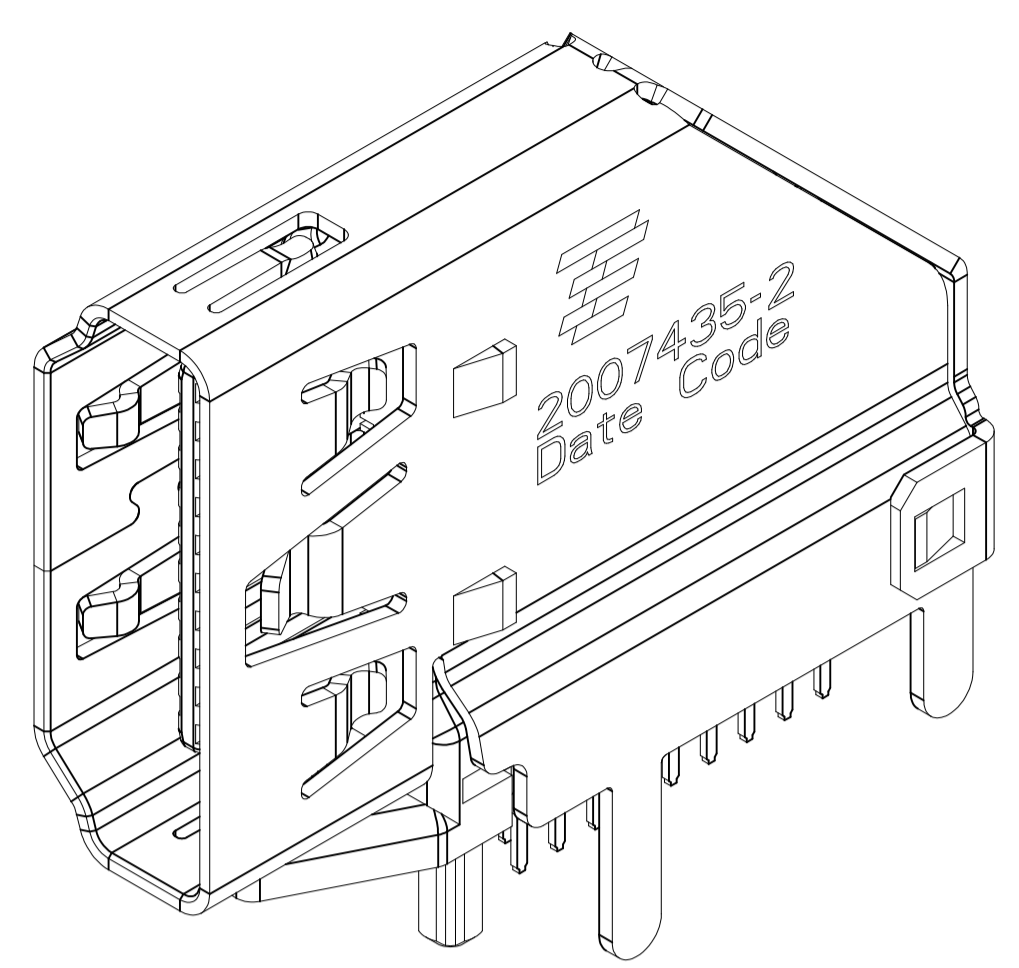

2007435-2 WITHOUT BOARD LOCK,  
 UNMARKED DIMENSIONS SAME AS 2007435-1  
 SCALE 6:1

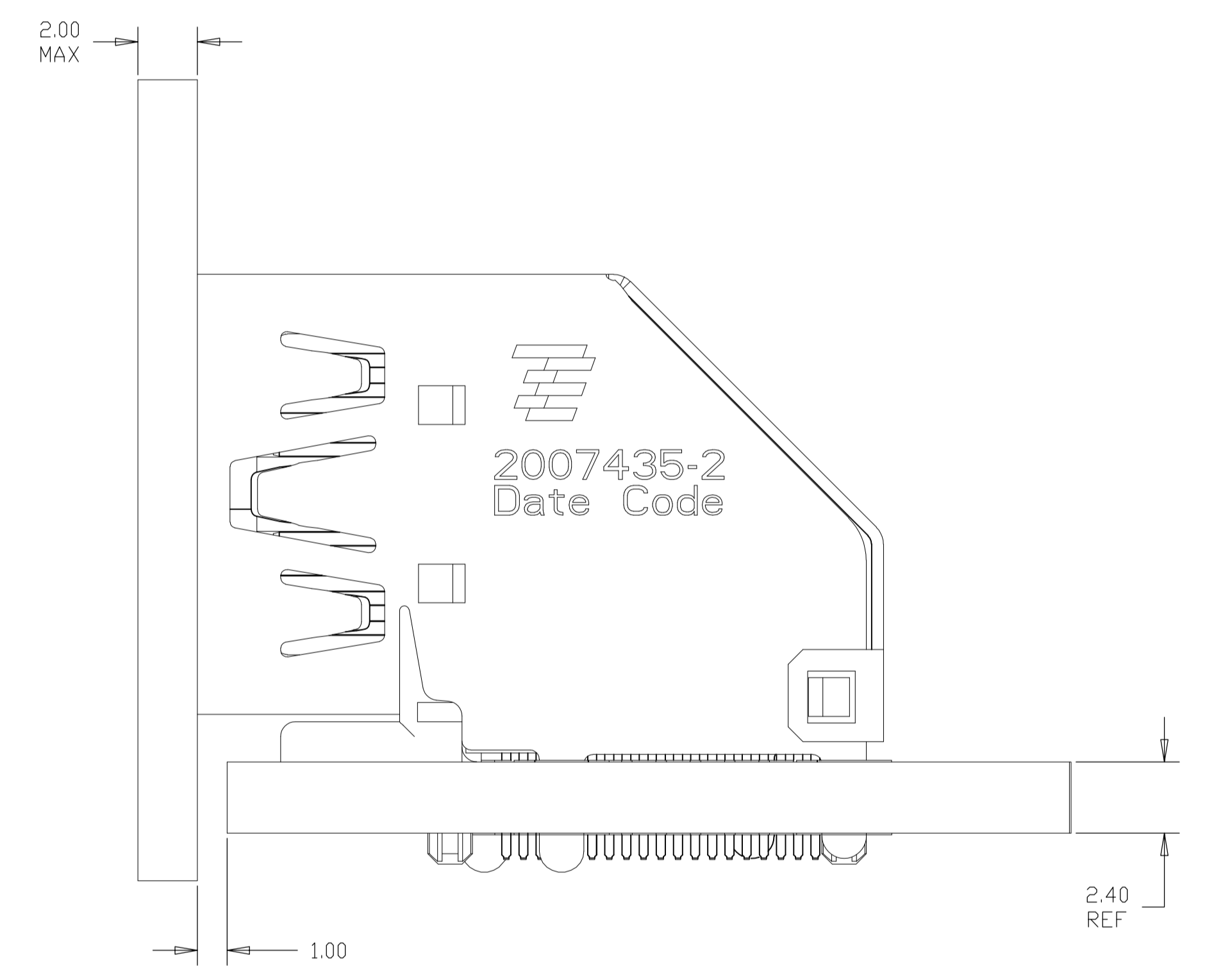
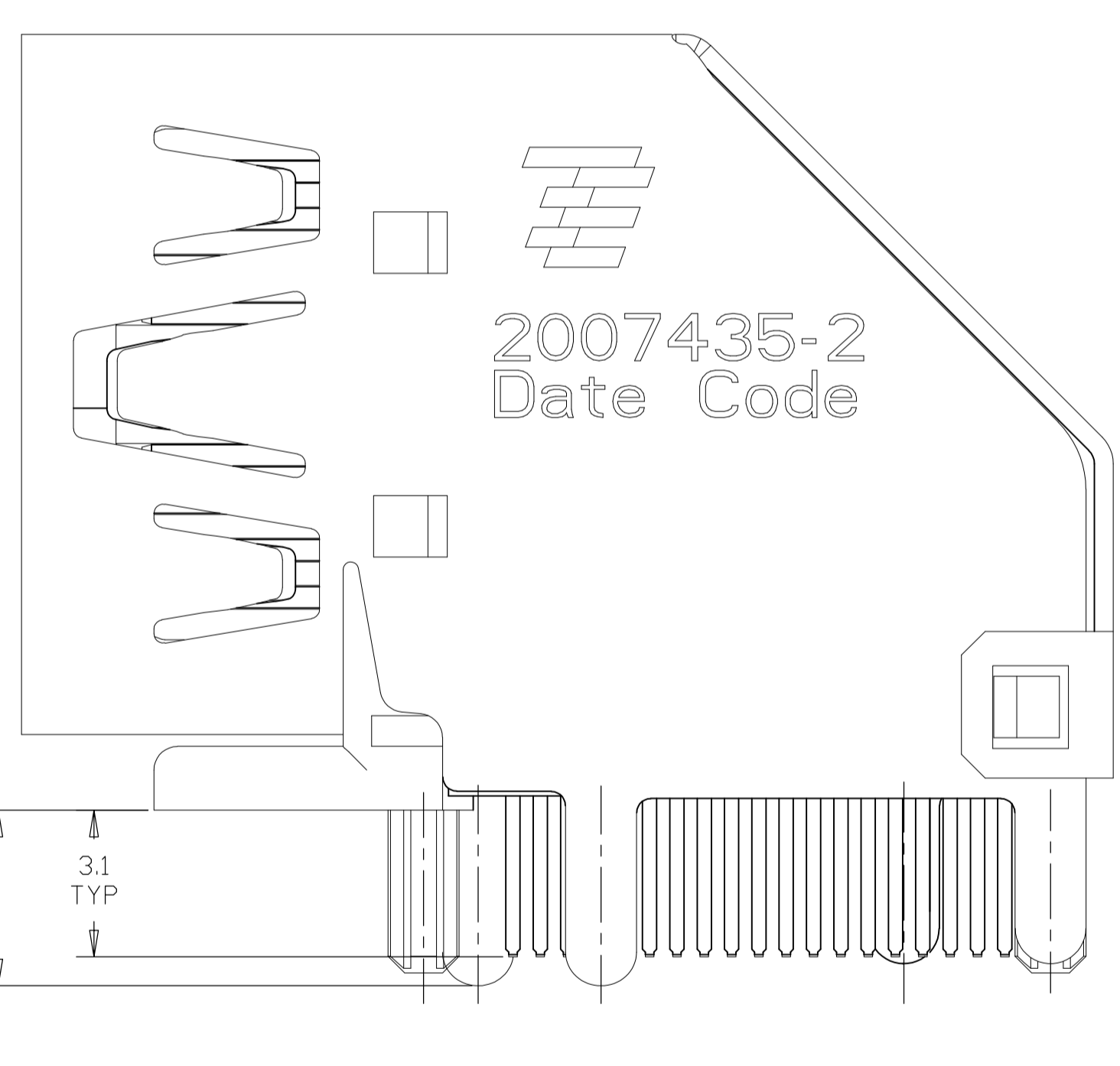
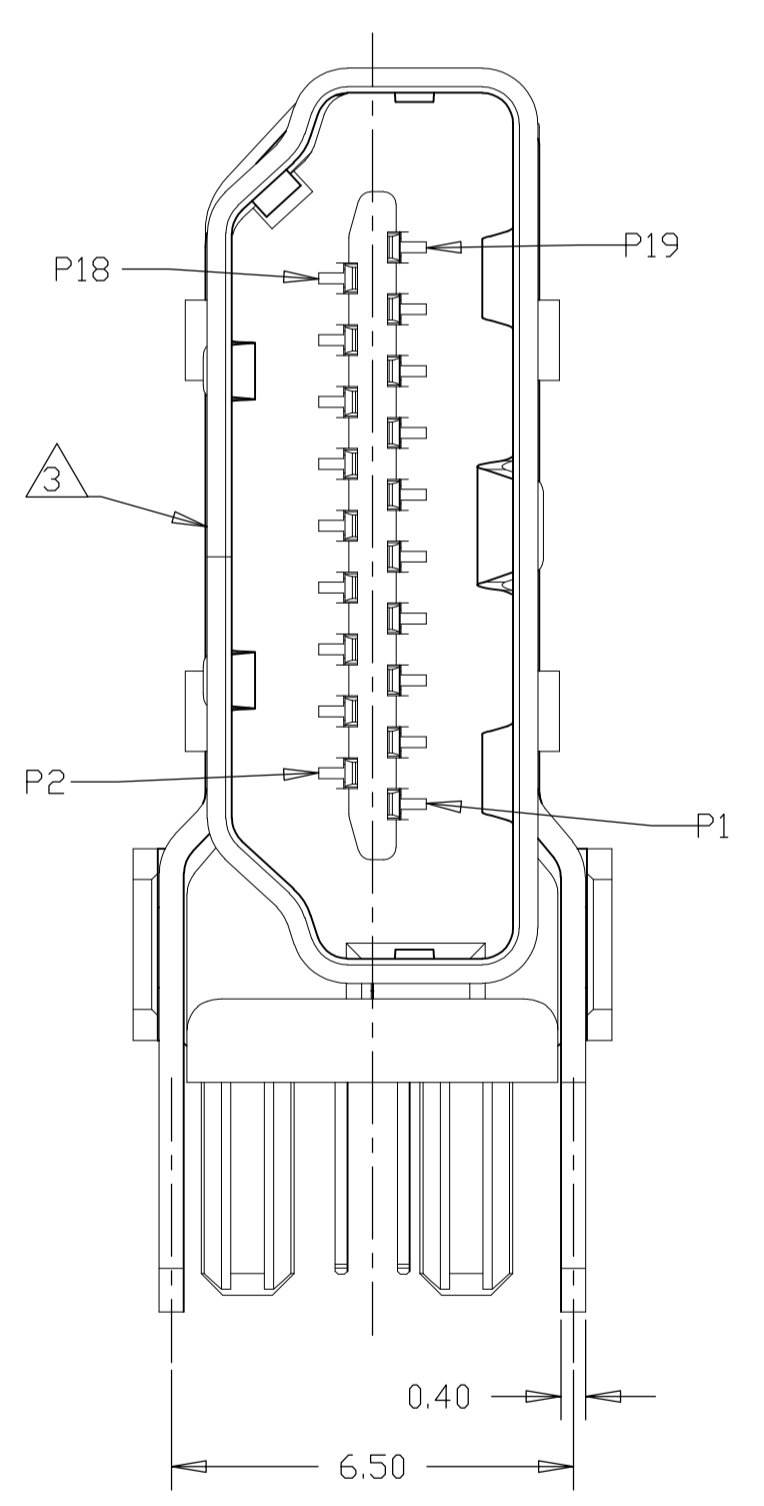
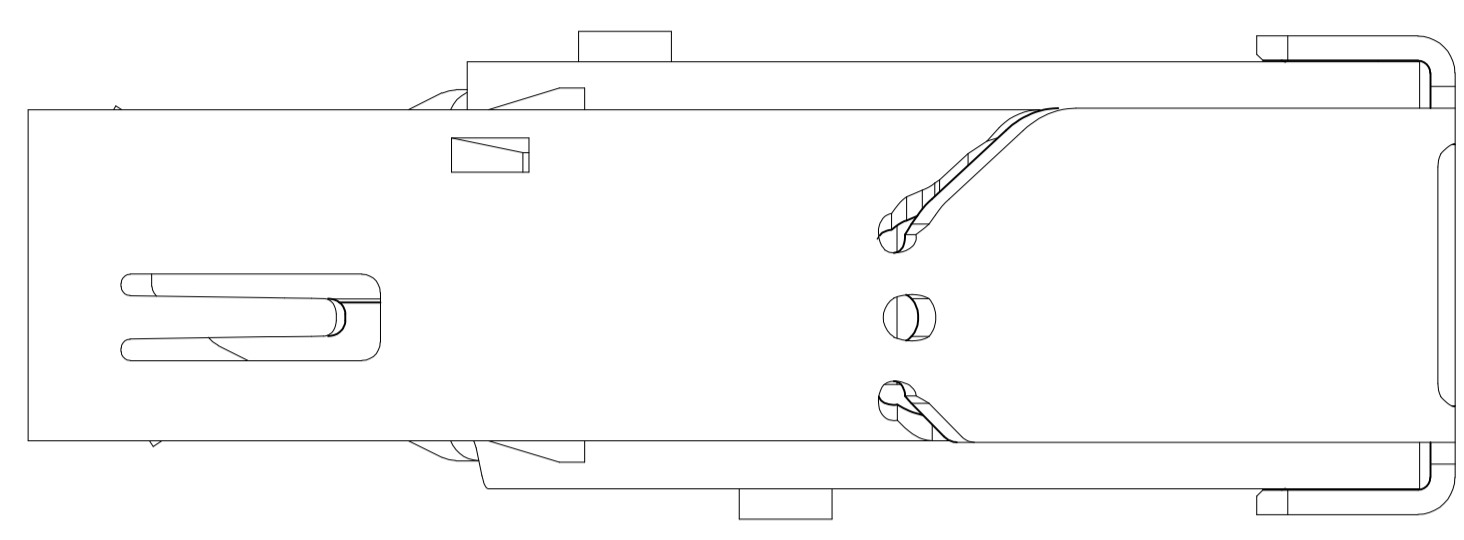

2007435-2  
 INSTALLED CONDITION  
 SCALE 6:1

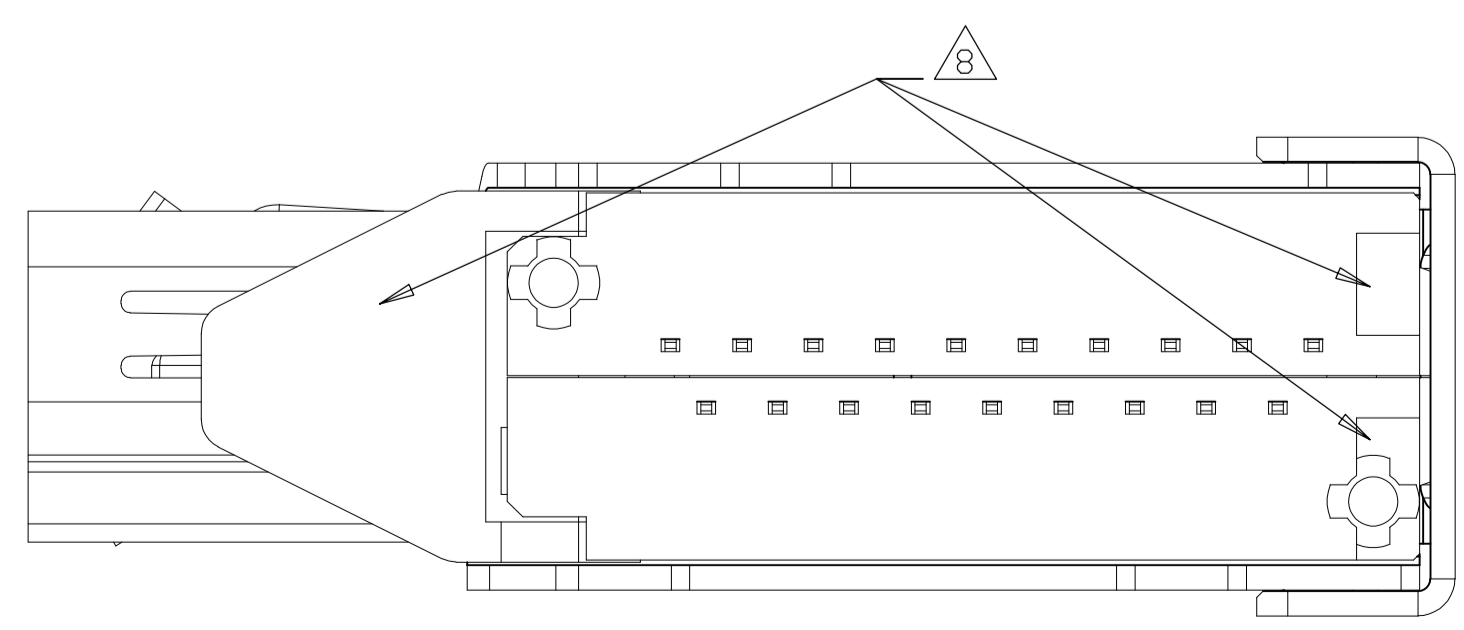

THIS DRAWING IS A CONTROLLED DOCUMENT.		DIN	STE TE Connectivity	
DIMENSIONS:	TOLERANCES UNLESS OTHERWISE SPECIFIED:	CHK	NAME	
mm	0. PLC ± -	APVD	HDMI FLAG CONNECTOR ASSEMBLY	
	1. PLC ± 0.3	PRODUCT SPEC	-	
	2. PLC ± 0.25	APPLICATION SPEC	-	
	3. PLC ± 0.100	WEIGHT	-	
	4. PLC ± 0.1000	CUSTOMER DRAWING	-	
MATERIAL	FINISH	SIZE	CAGE CODE	DRAWING NO
SEE TABLE		A1	00779	C=2007435
		SCALE	SHEET	REV
		8:1	2 OF 9	D

LOC		DIST		REVISIONS			
P	LTR	DESCRIPTION	DATE	DN	APVD		
-	-	SEE SHEET 1	-	-	-	-	-

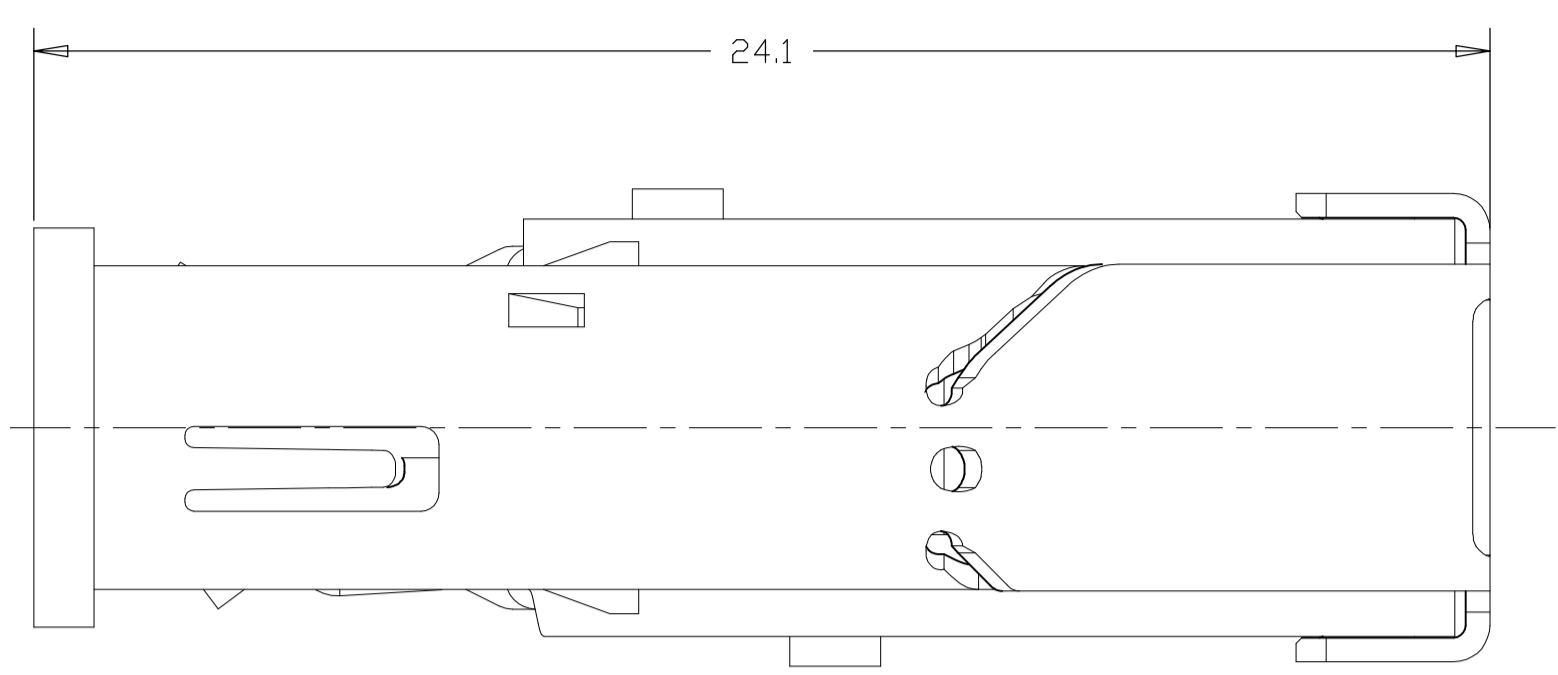
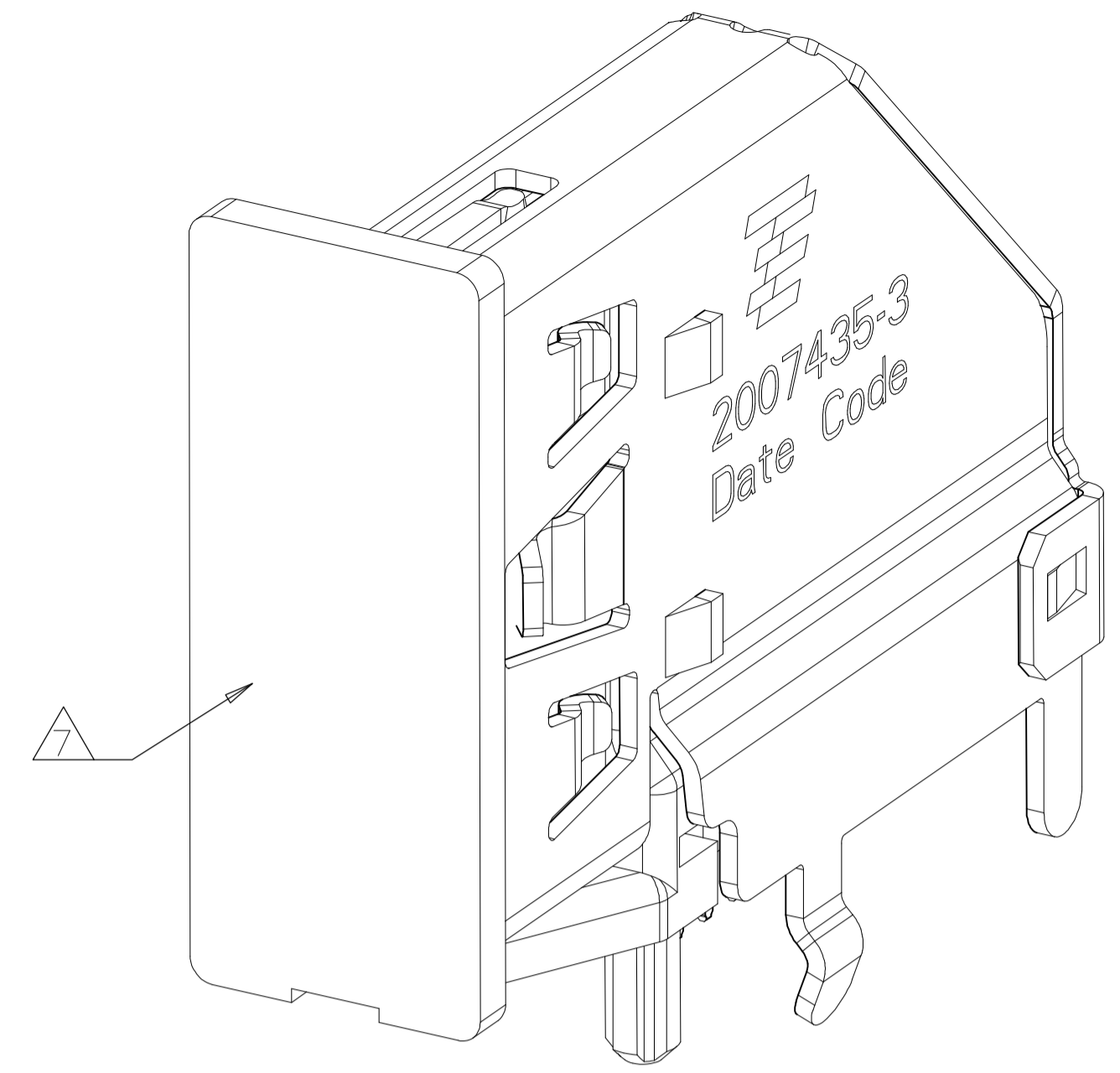

2007435-3(-5) WITH CAP, UNMARKED  
 DIMENSIONS SAME AS 2007435-1  
 SCALE 6:1

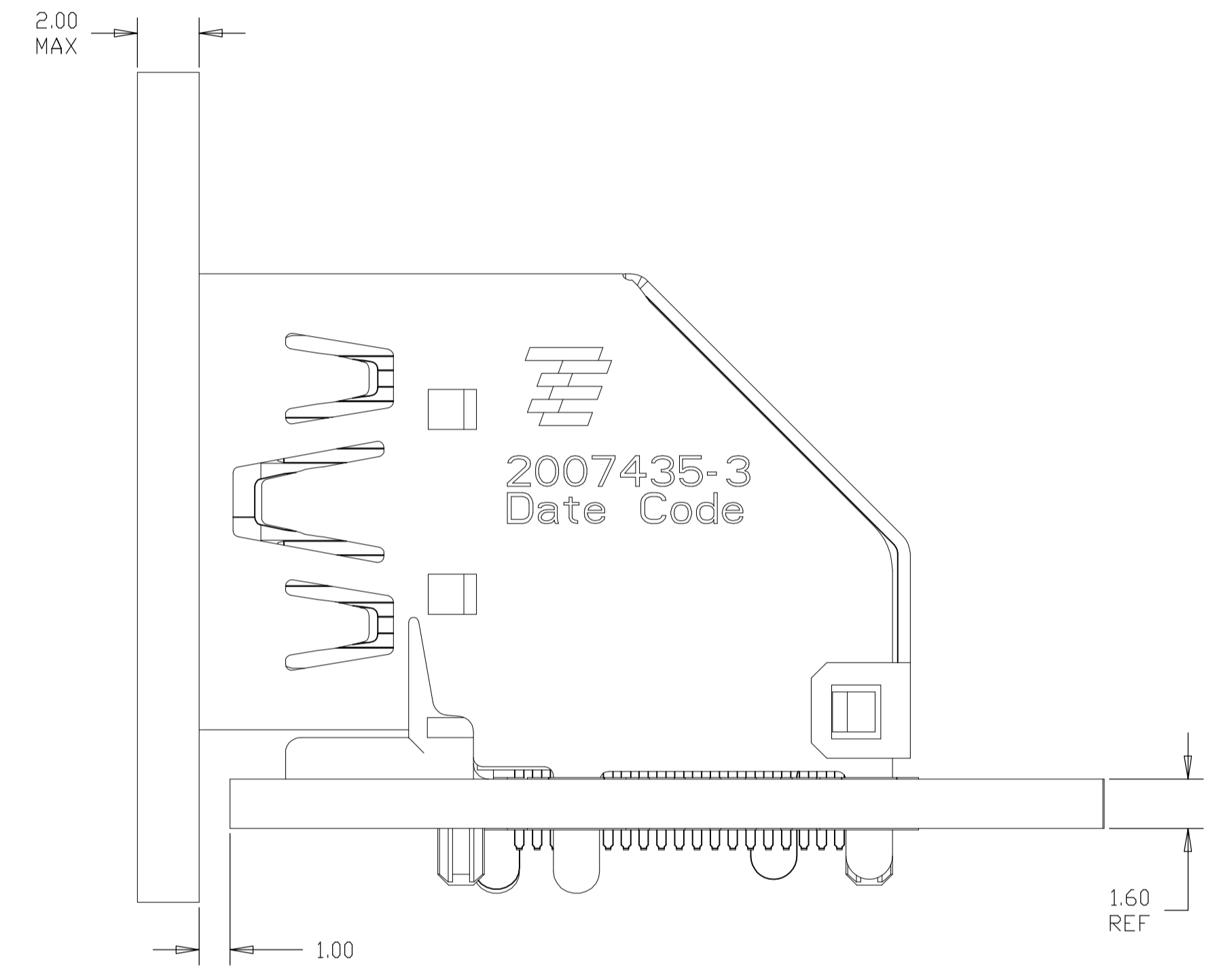
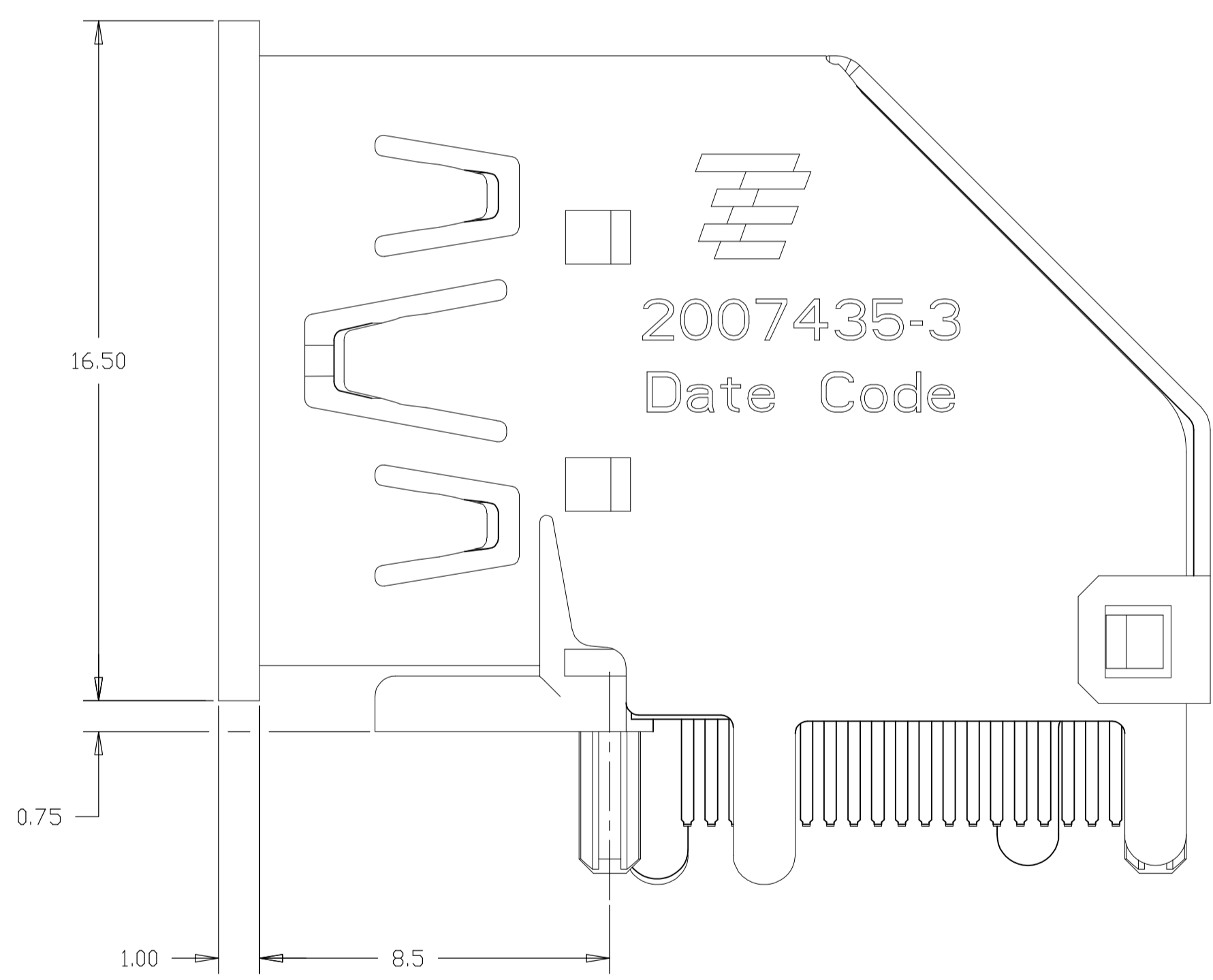
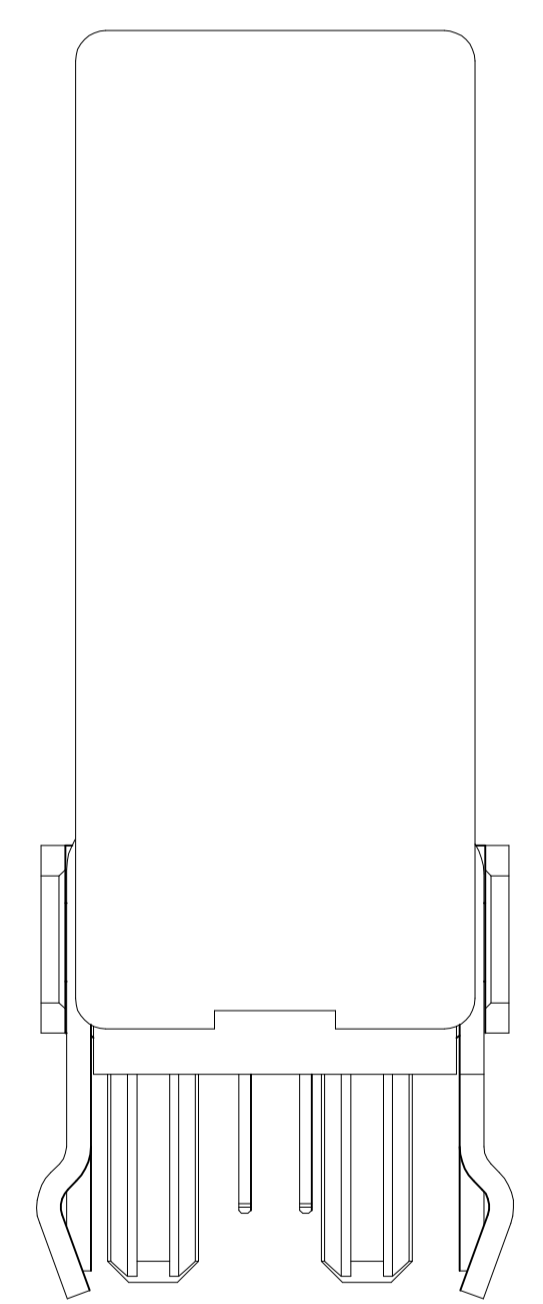

2007435-3(-5)  
 INSTALLED CONDITION  
 (ONLY FOR AFTER REMOVE CAP)  
 SCALE 6:1

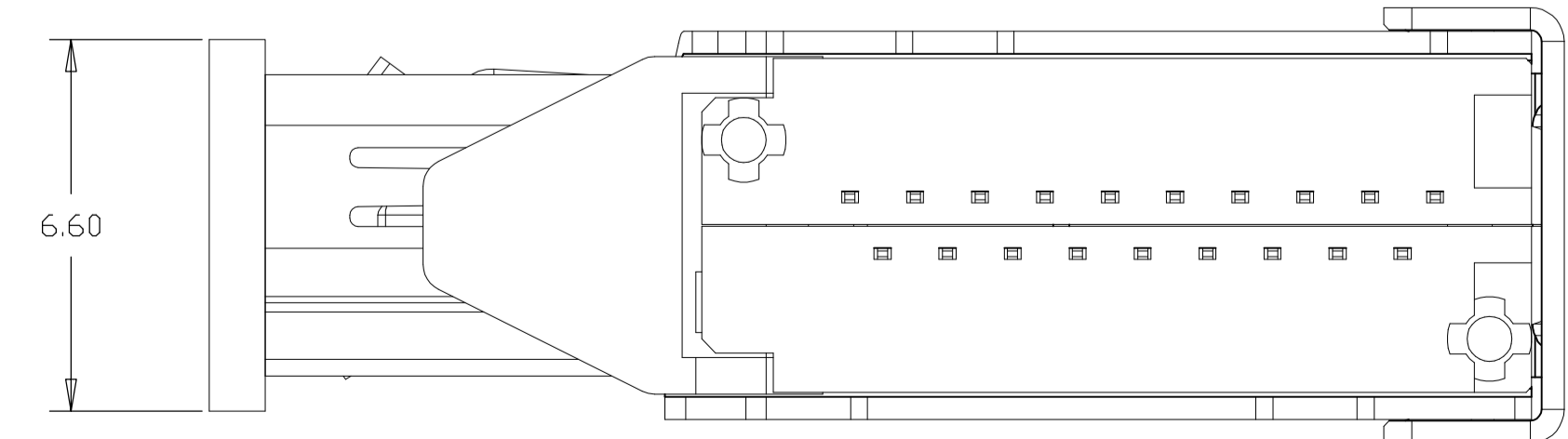

THIS DRAWING IS A CONTROLLED DOCUMENT.		DIN		TE Connectivity	
DIMENSIONS: mm		TOLERANCES UNLESS OTHERWISE SPECIFIED:			
		0. PLC ± 0.3	1. PLC ± 0.25	NAME	
MATERIAL SEE TABLE		2. PLC ± 0.10	3. PLC ± 0.10	PRODUCT SPEC	
FINISH		4. PLC ± 0.10	ANGLES ± -	APPLICATION SPEC	
				SIZE	CAGE CODE
				A1	00779
				DRAWING NO	RESTRICTED TO
				C=2007435	-
				WEIGHT	-
				CUSTOMER DRAWING	SCALE 8:1 SHEET 3 OF 9 REV D

LOC		DIST		REVISIONS			
P	LTR	DESCRIPTION	DATE	DWN	APVD		
-	-	SEE SHEET 1	-	-	-	-	-

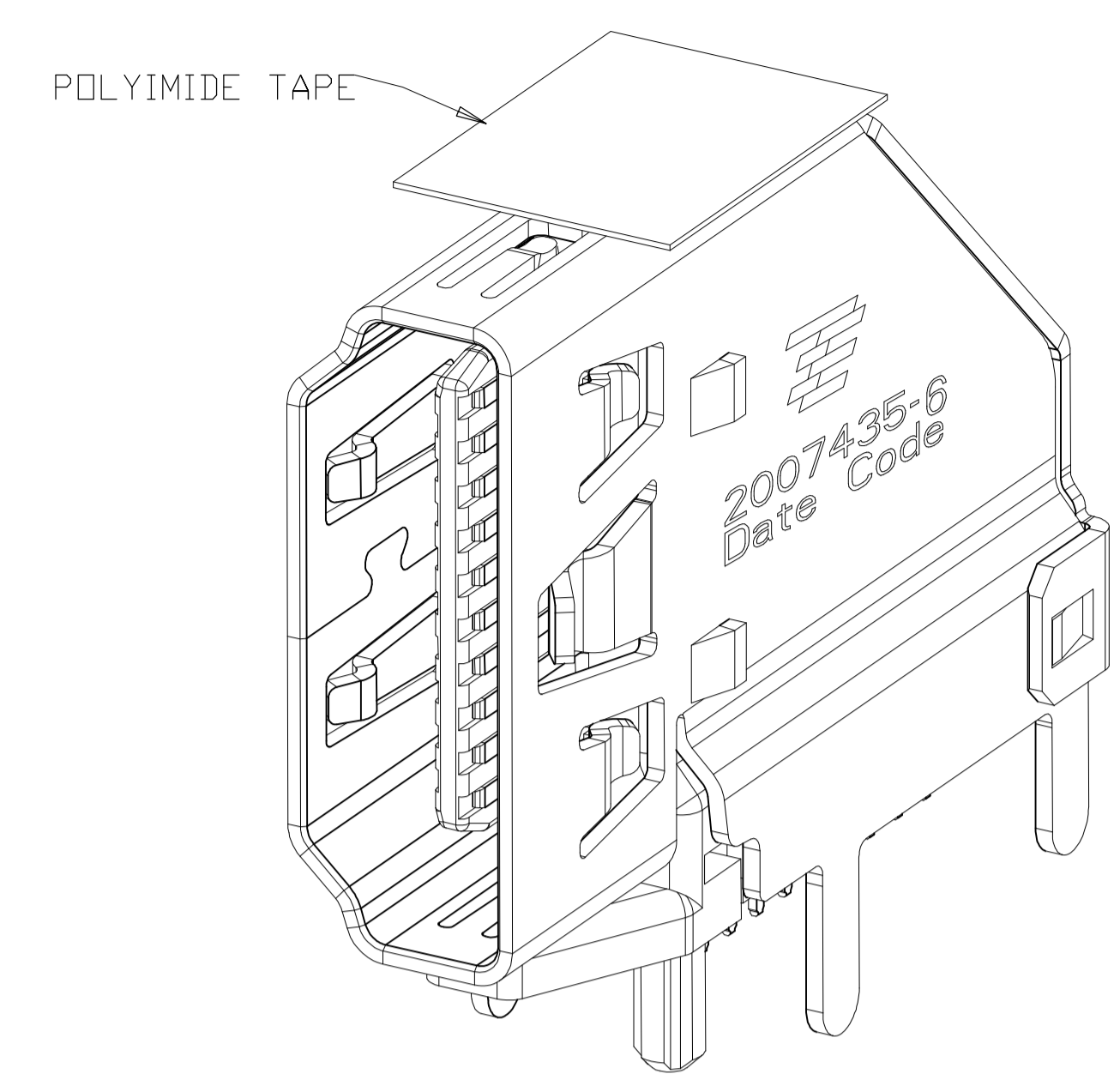
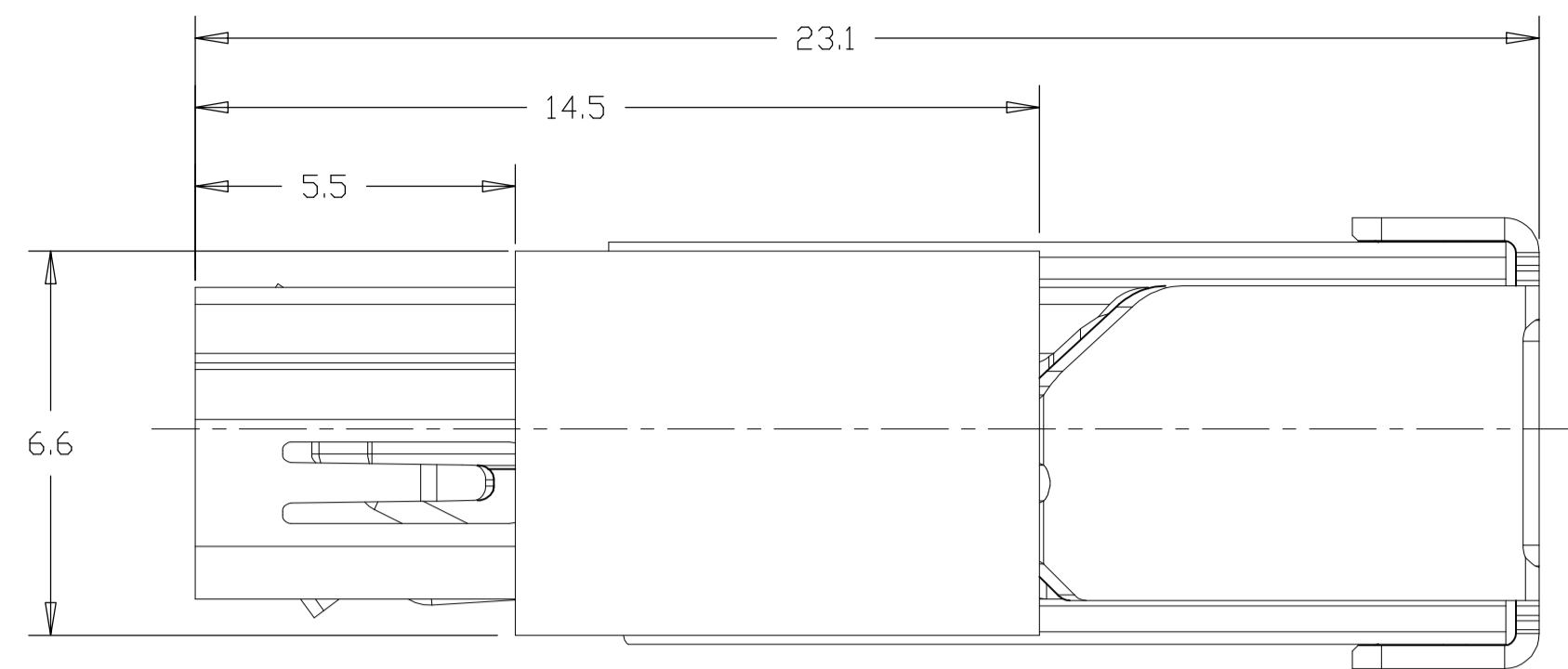

2007435-6 WITH POLYIMIDE TAPE,  
UNMARKED DIMENSIONS SAME AS 2007435-1  
SCALE 6:1

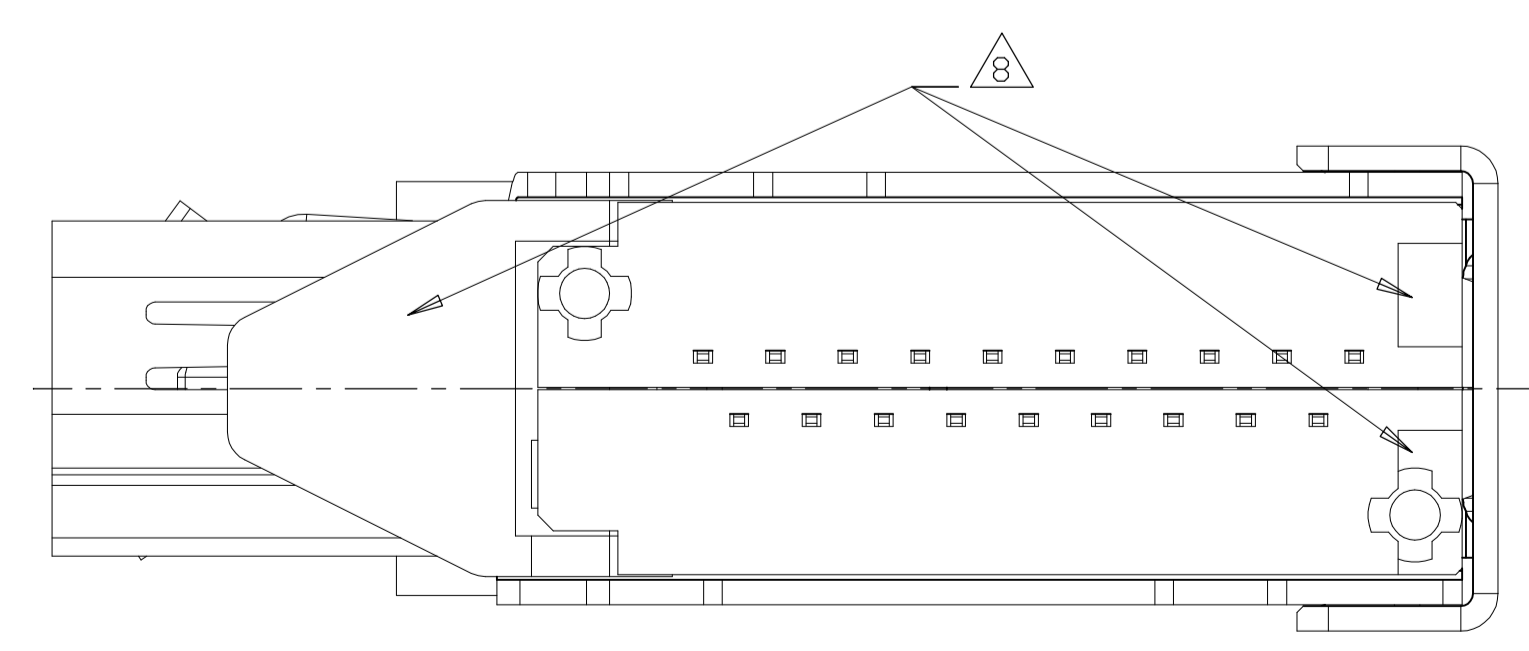
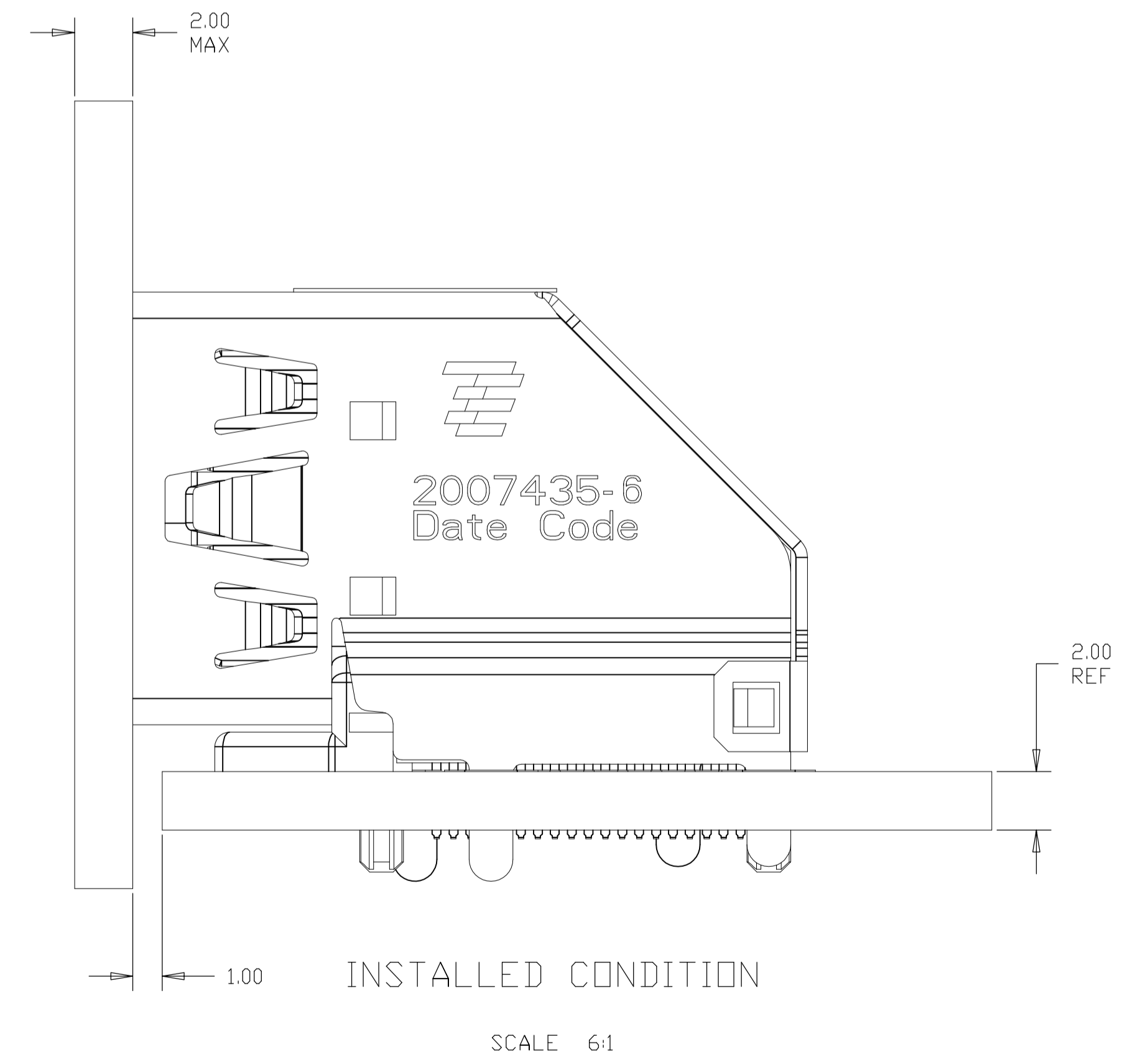
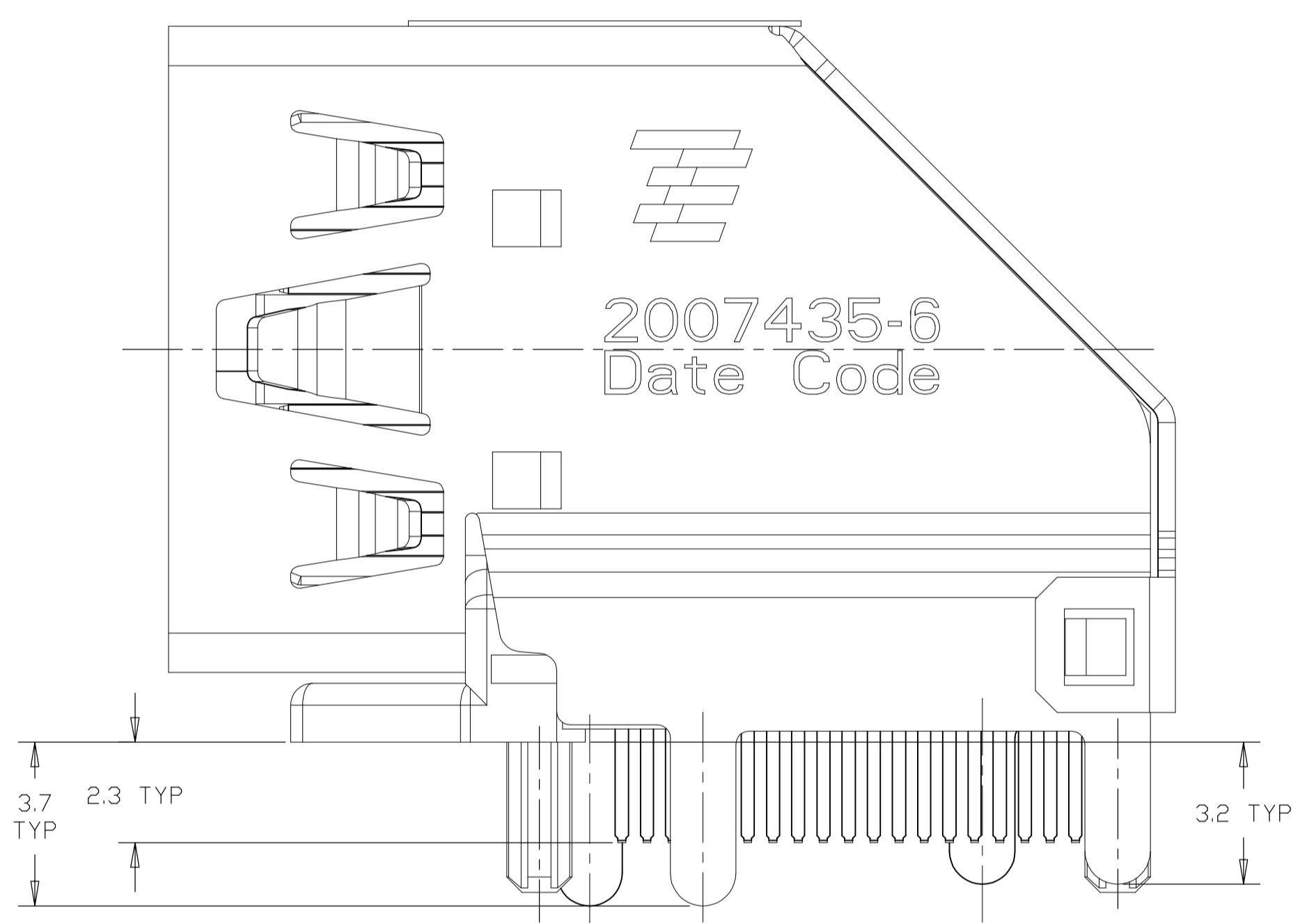
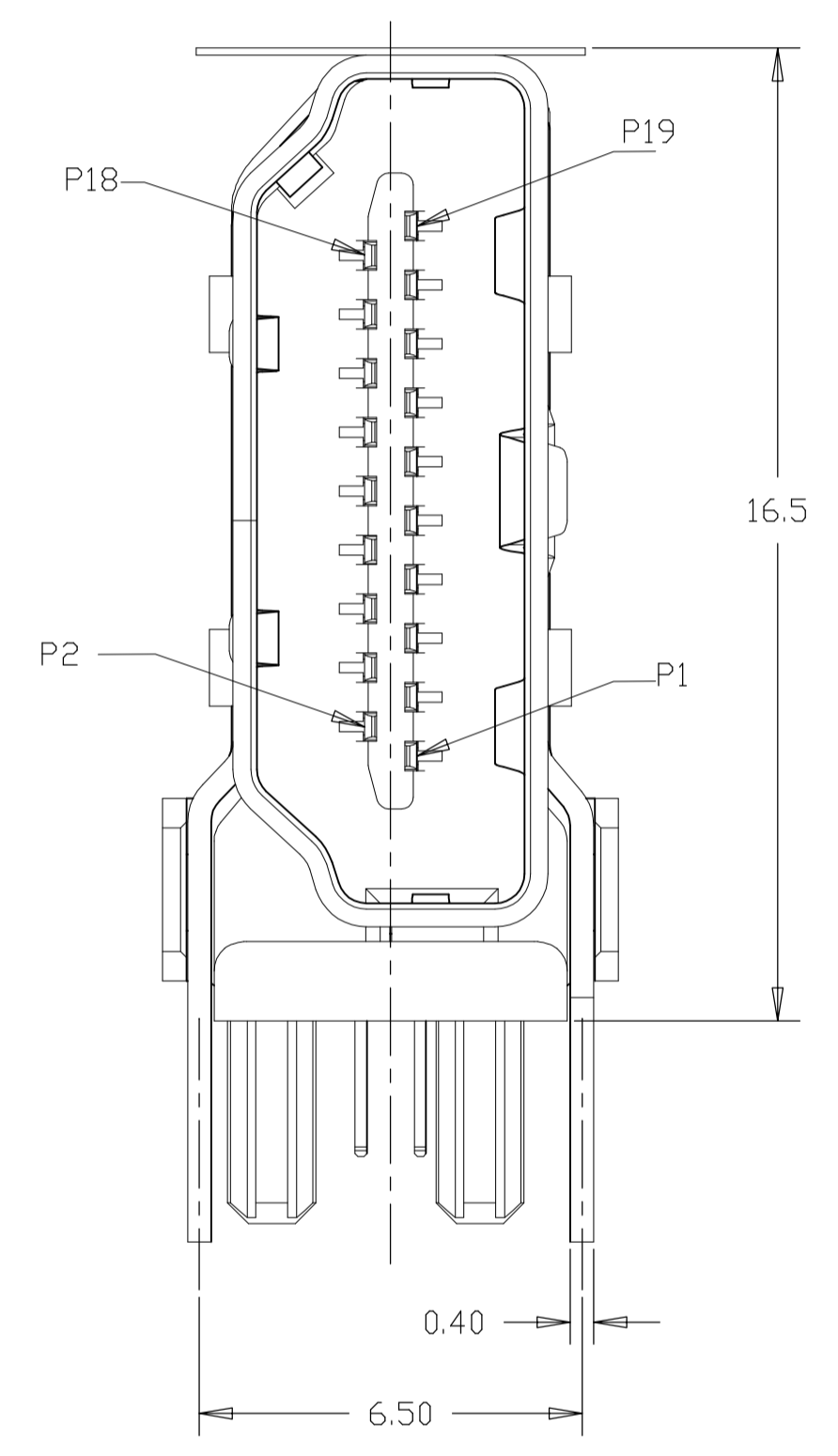

THIS DRAWING IS A CONTROLLED DOCUMENT.		DWN	TE Connectivity	
DIMENSIONS: mm		CHK	NAME	
TOLERANCES UNLESS OTHERWISE SPECIFIED:		APVD	HDMI FLAG CONNECTOR ASSEMBLY	
0. PLC	± 0.3	PRODUCT SPEC	-	
1. PLC	± 0.25	APPLICATION SPEC	-	
2. PLC	± 0.10	SIZE	A1	RESTRICTED TO
3. PLC	± 0.10	CAGE CODE	00779	4 OF 9
4. PLC	± 0.10	DRAWING NO	2007435	REV D
ANGLES	± -	WEIGHT	-	-
FINISH	2	CUSTOMER DRAWING	SCALE 8:1	SHEET 4 OF 9

LOC		DIST		REVISIONS			
P	LTR	DESCRIPTION	DATE	DNW	APVD		
-	-	SEE SHEET 1	-	-	-	-	-

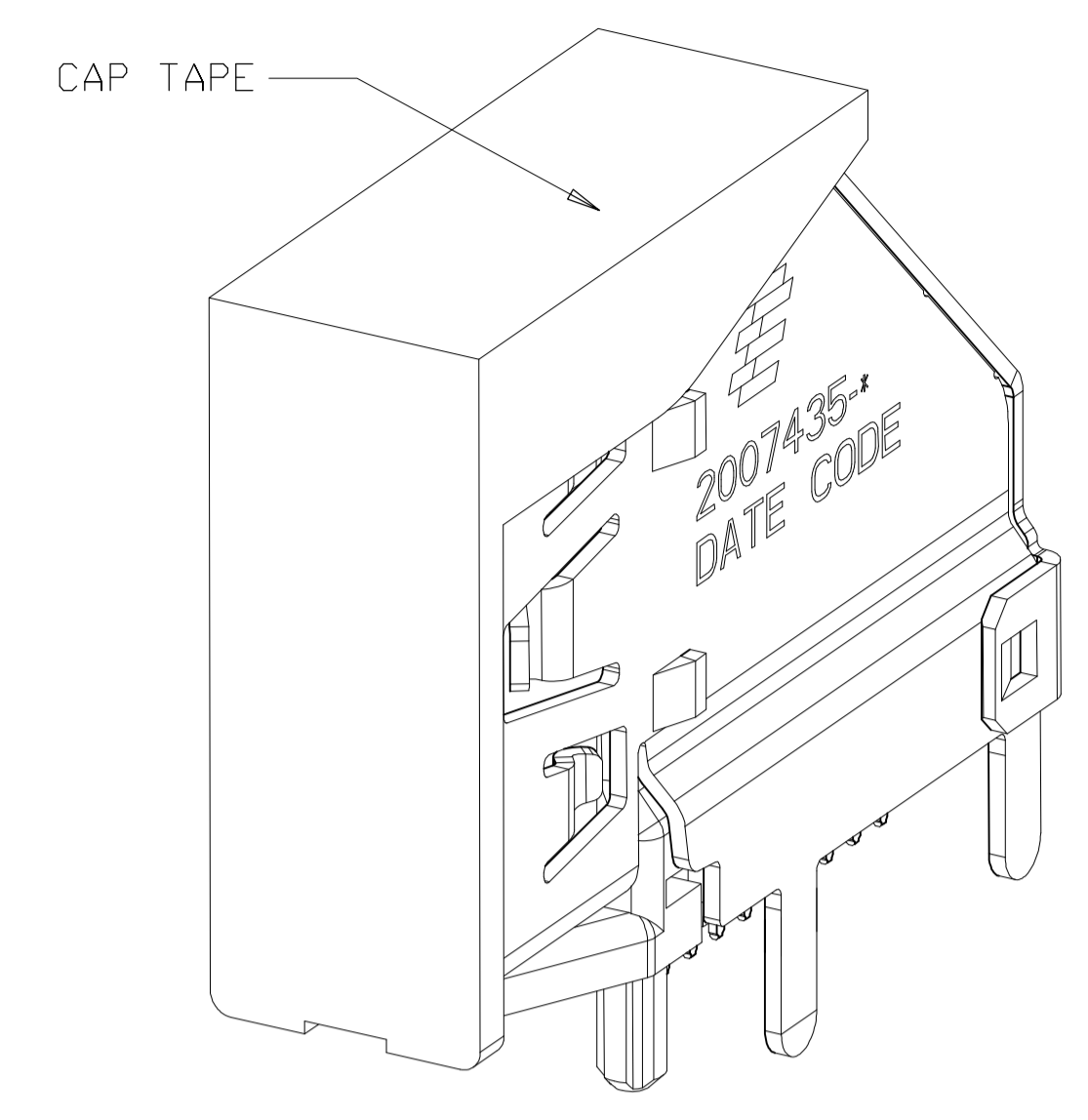
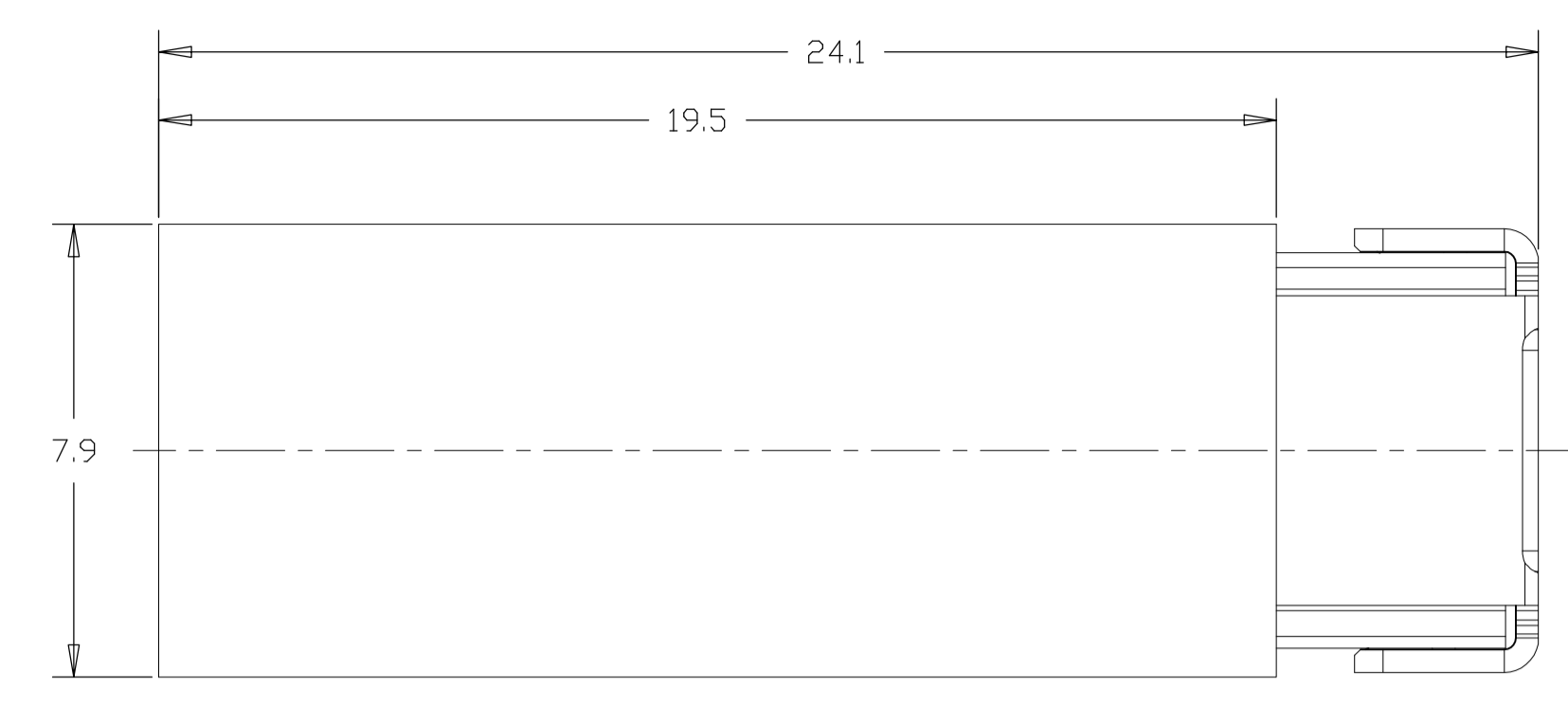

2007435-7 WITH CAP,  
UNMARKED DIMENSIONS SAME AS 2007435-1

SCALE 6:1

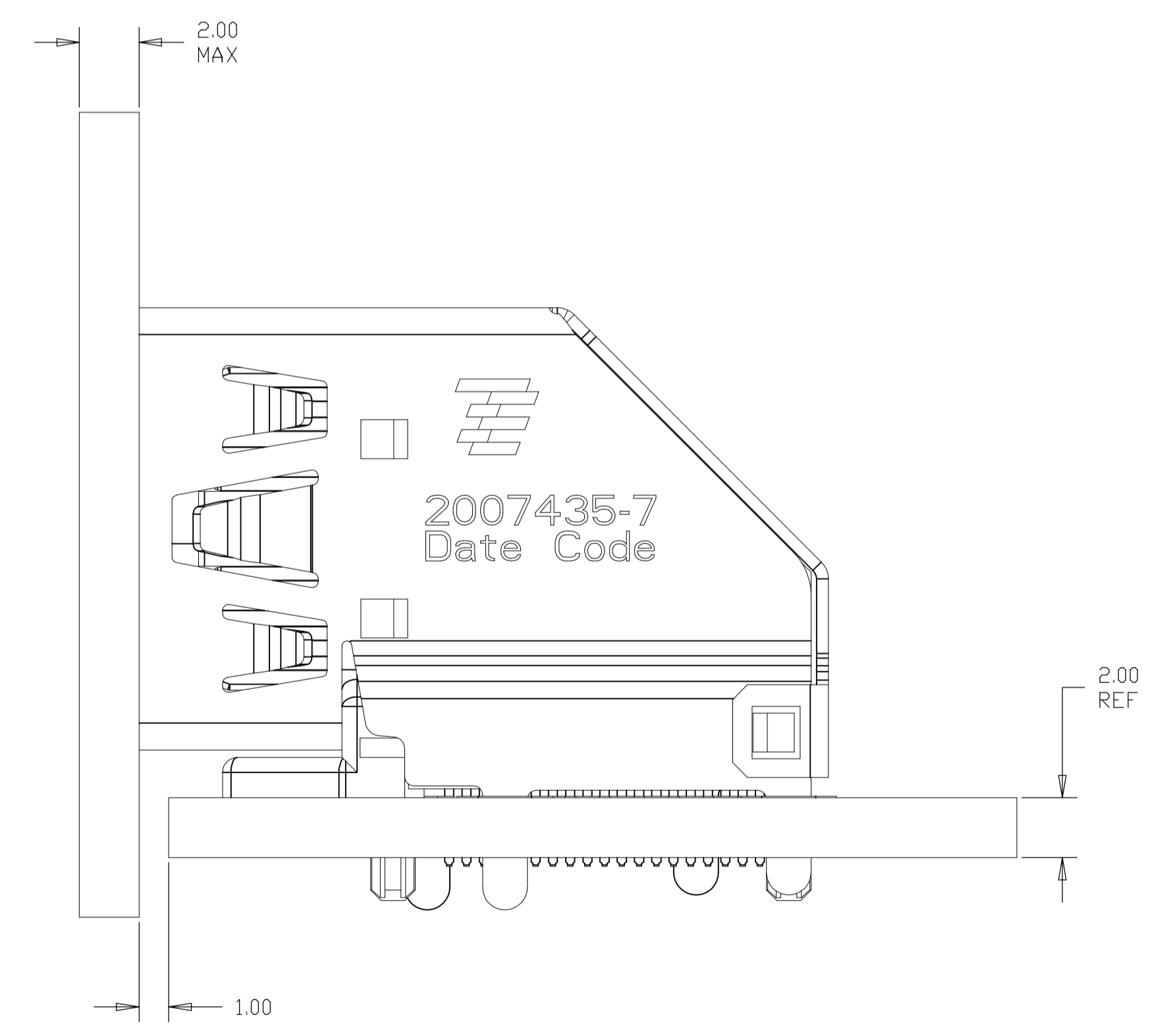
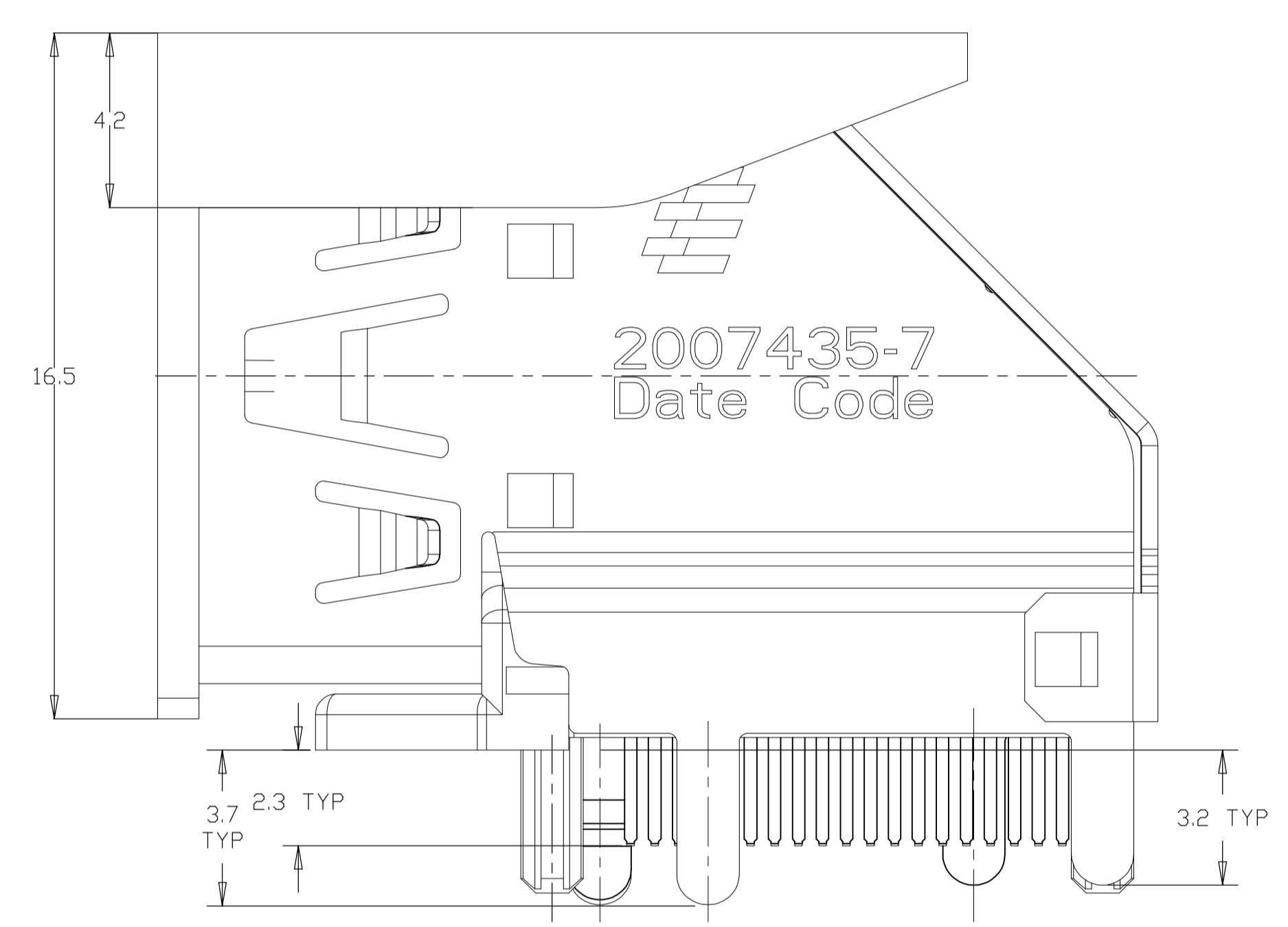
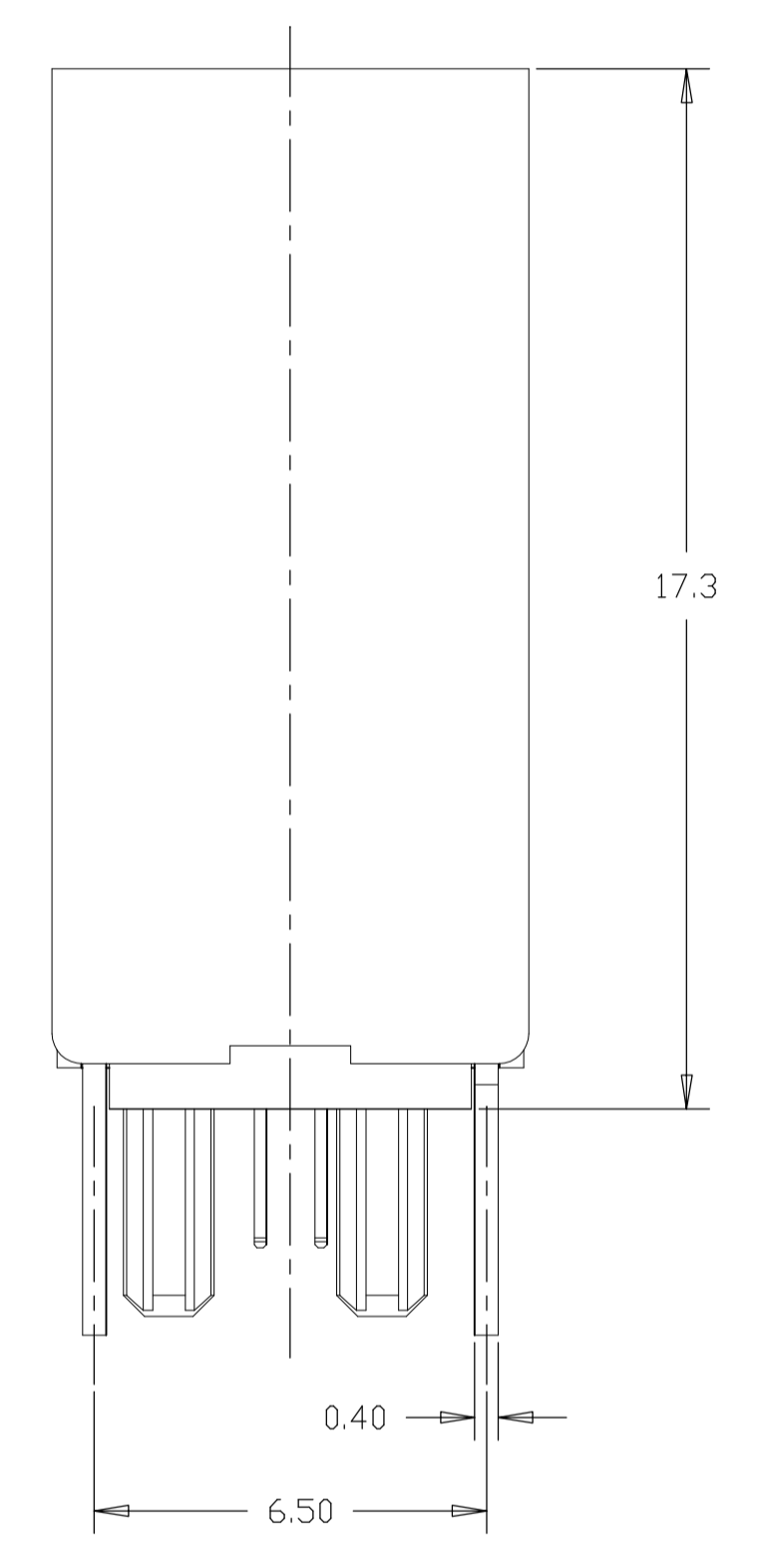

INSTALLED CONDITION  
(ONLY FOR AFTER REMOVE CAP)  
SCALE 6:1

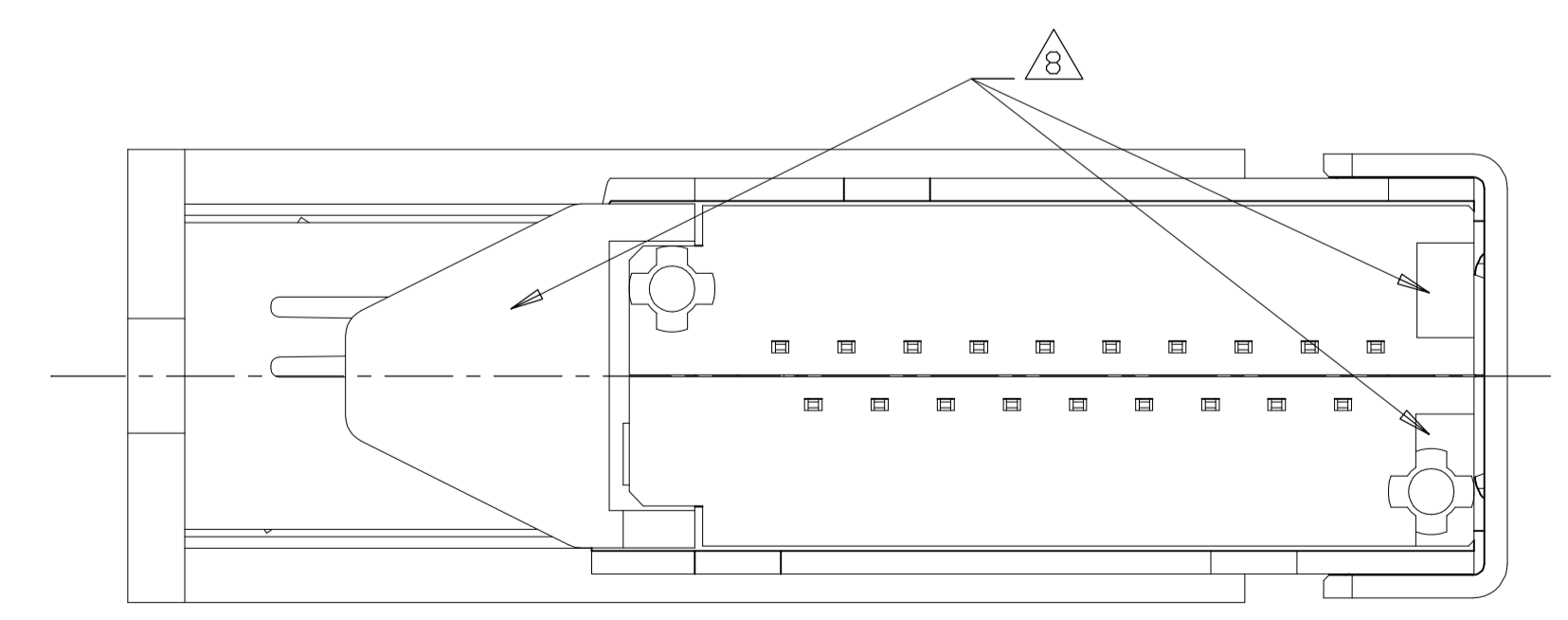

THIS DRAWING IS A CONTROLLED DOCUMENT.		DIN		STE		TE Connectivity	
DIMENSIONS: mm		TOLERANCES UNLESS OTHERWISE SPECIFIED:		NAME		HDMI FLAG CONNECTOR ASSEMBLY	
<ul style="list-style-type: none"> <li>0. PLC ± 0.3</li> <li>1. PLC ± 0.25</li> <li>2. PLC ± 0.10</li> <li>3. PLC ± 0.10</li> <li>4. PLC ± 0.10</li> <li>ANGLES ± -</li> </ul>		<ul style="list-style-type: none"> <li>APVD</li> <li>PRODUCT SPEC</li> <li>APPLICATION SPEC</li> </ul>		SIZE		RESTRICTED TO	
MATERIAL SEE TABLE		FINISH		WEIGHT		A1 00779 C=2007435	
				CUSTOMER DRAWING		SCALE 8:1 SHEET 5 OF 9 REV D	

LOC		DIST		REVISIONS			
#	LTR	DESCRIPTION	DATE	DWN	APVD		
SEE SHEET 1							

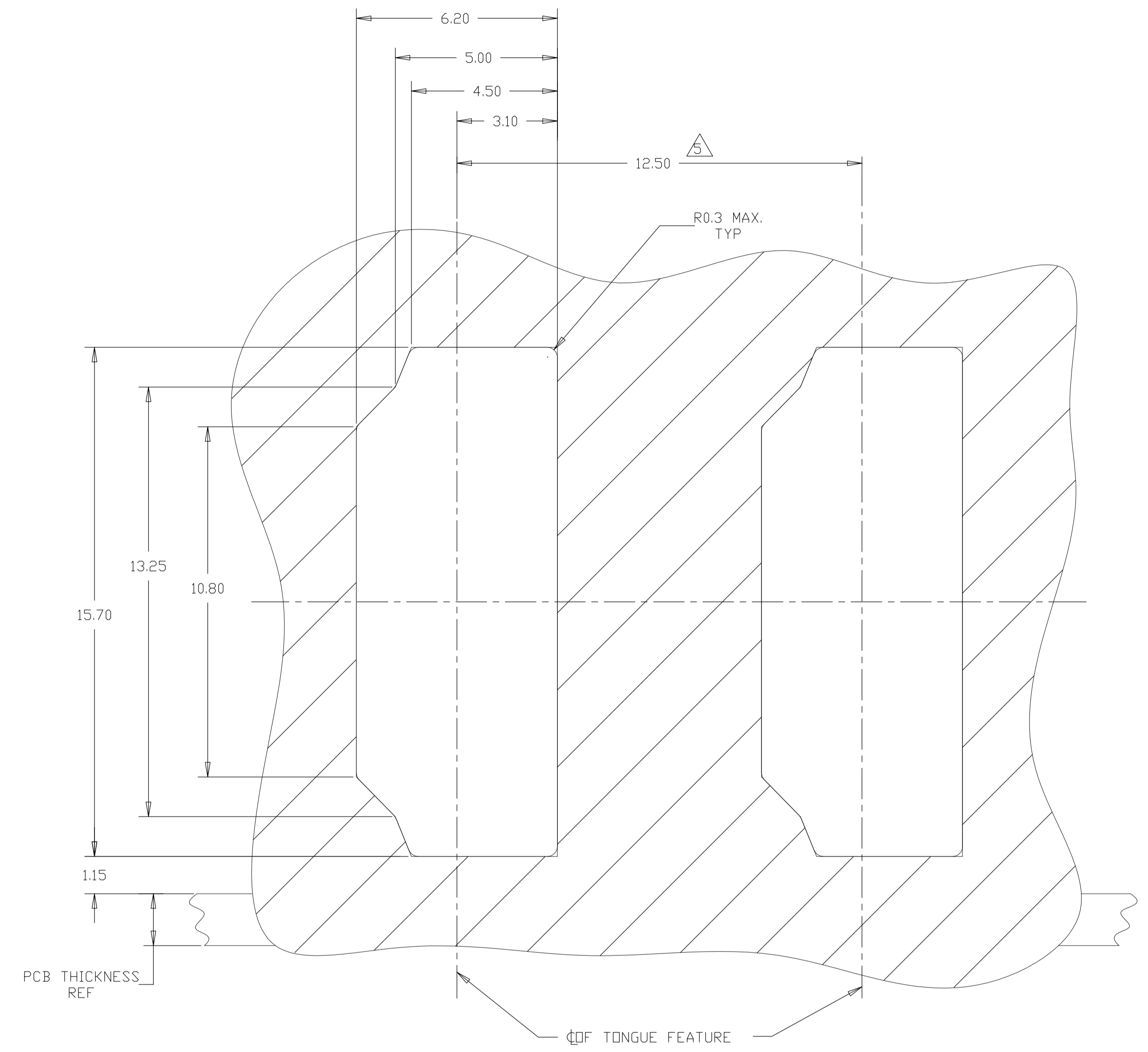
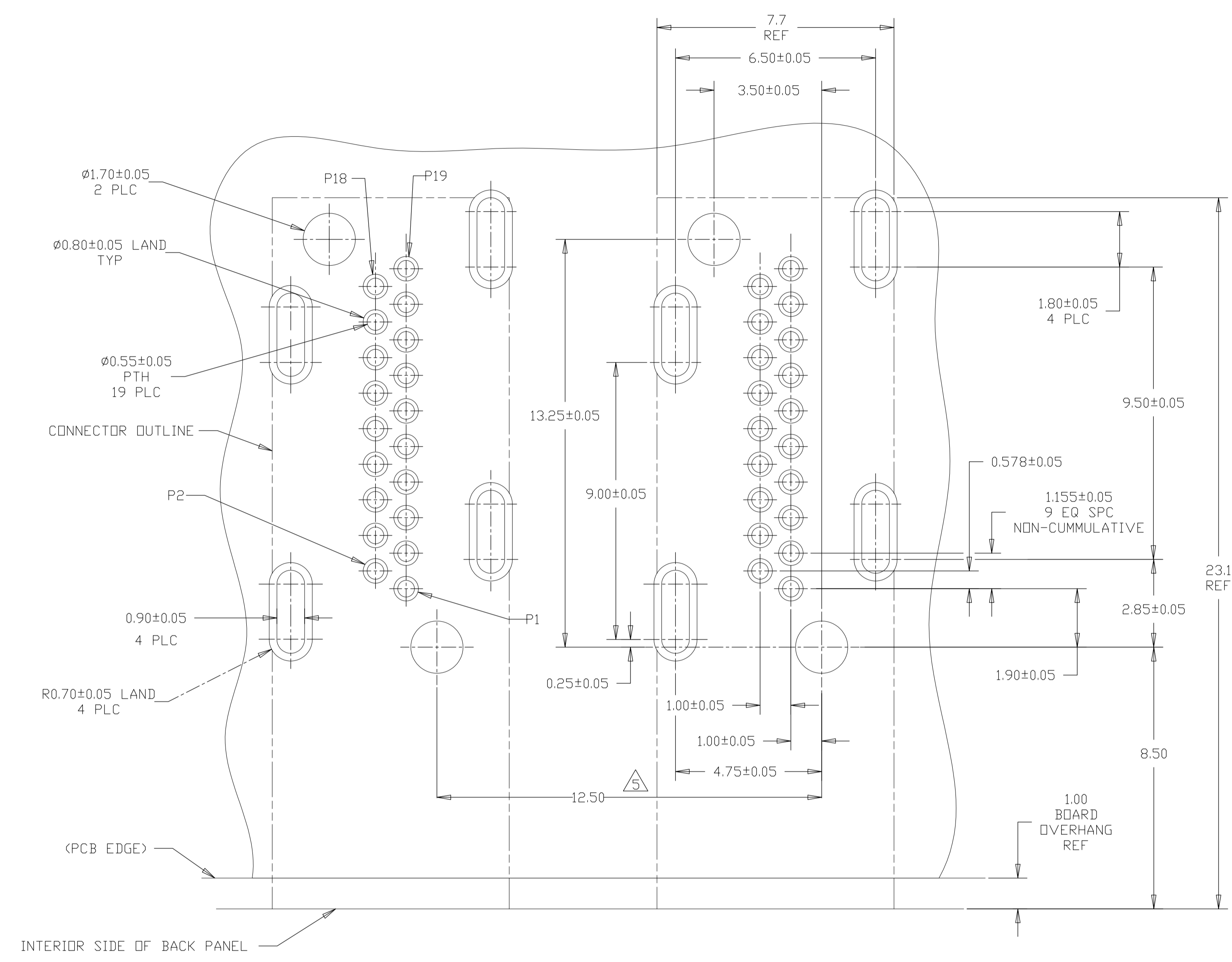

THIS DRAWING IS A CONTROLLED DOCUMENT.		DWN	TE Connectivity	
DIMENSIONS:	TOLERANCES UNLESS OTHERWISE SPECIFIED:	CHK	NAME	HDMI FLAG CONNECTOR ASSEMBLY
mm	0 PLC ± - 1 PLC ± 0.1 2 PLC ± 0.10 3 PLC ± 0.100 4 PLC ± 0.1000 ANGLES ± -	APVD	PRODUCT SPEC	
			APPLICATION SPEC	
MATERIAL	FINISH	WEIGHT	SIZE	CAGE CODE
			A1	00779
			2007435	RESTRICTED TO
			CUSTOMER DRAWING	SCALE 8:1 SHEET 6 OF 9 REV D

LOC		DIST		REVISIONS			
#	LTR	DESCRIPTION	DATE	DWN	APVD		
-	-	SEE SHEET 1	-	-	-		

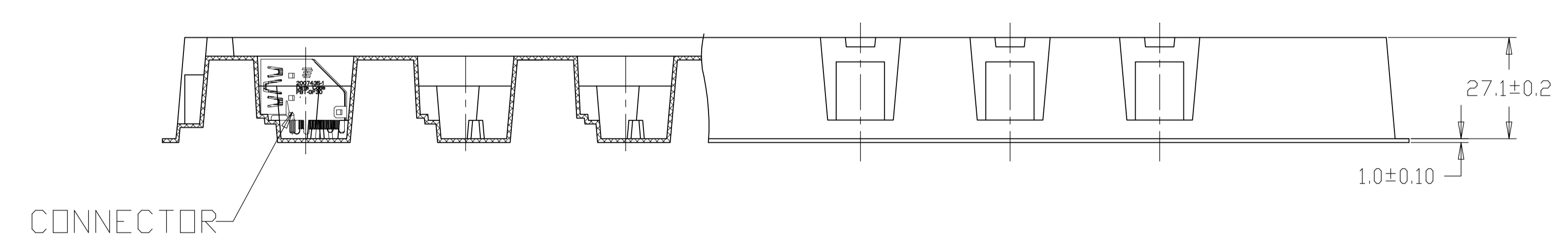
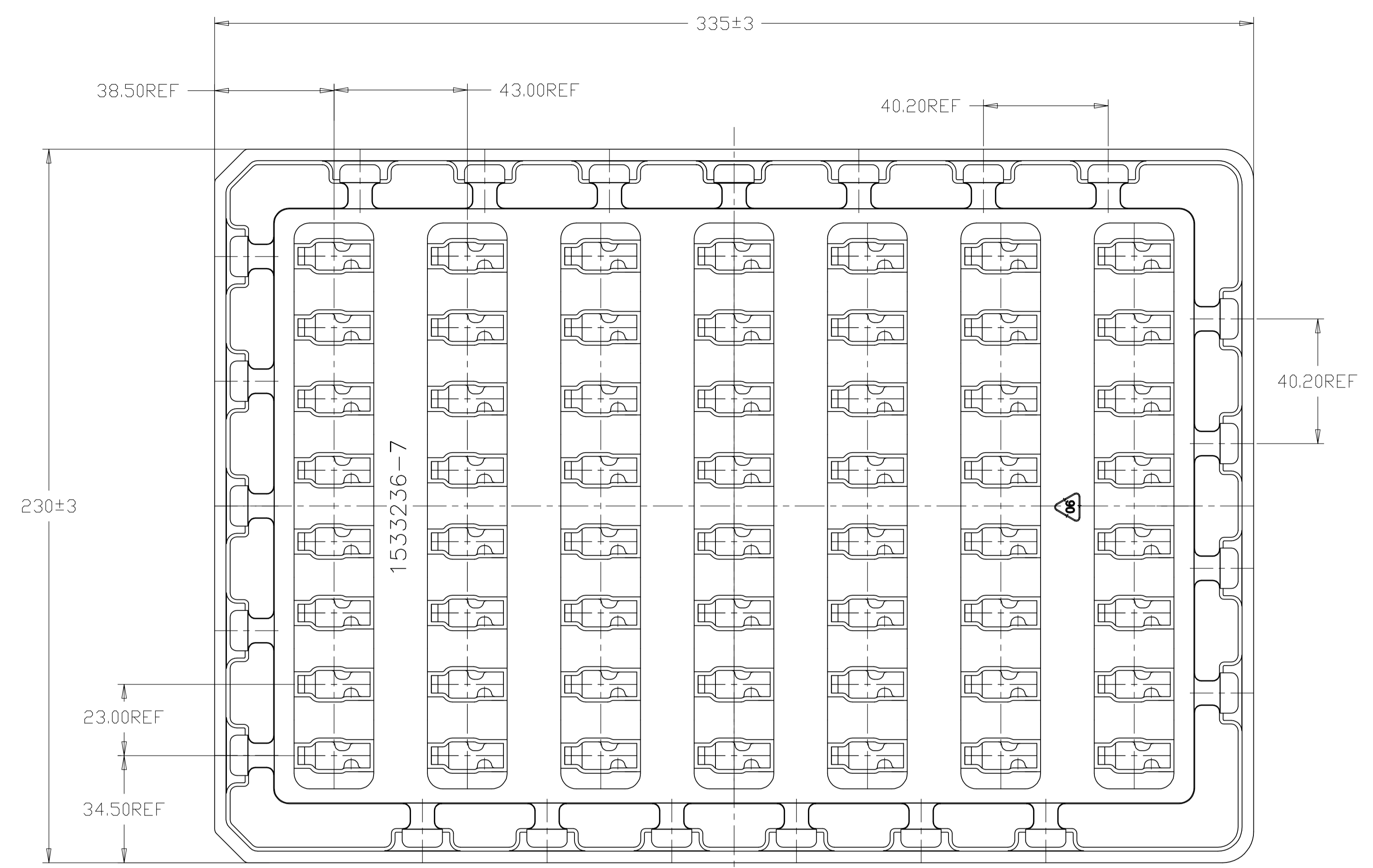

PACKAGE TRAY  
 FOR PART NUMBER  
 2007435-1,-2,-3,-4,-5

THIS DRAWING IS A CONTROLLED DOCUMENT.		DWN	TE Connectivity	
DIMENSIONS: mm	TOLERANCES UNLESS OTHERWISE SPECIFIED: 0 PLC ± - 1 PLC ± - 2 PLC ± - 3 PLC ± - 4 PLC ± - ANGLES ± ±	CHK	NAME	
		APVD	HDMI FLAG CONNECTOR ASSEMBLY	
	APPLICATION SPEC	PRODUCT SPEC	SIZE	CAGE CODE
		APPLICATION SPEC	A1	00779
MATERIAL	FINISH	WEIGHT	DRAWING NO	RESTRICTED TO
CUSTOMER DRAWING			©=2007435	
		SCALE	N/A	SHEET 7 OF 9
		REV	D	

LOC		DIST		REVISIONS			
P	LTR	DESCRIPTION	DATE	DWN	APVD		
-	-	SEE SHEET 1	-	-	-	-	-

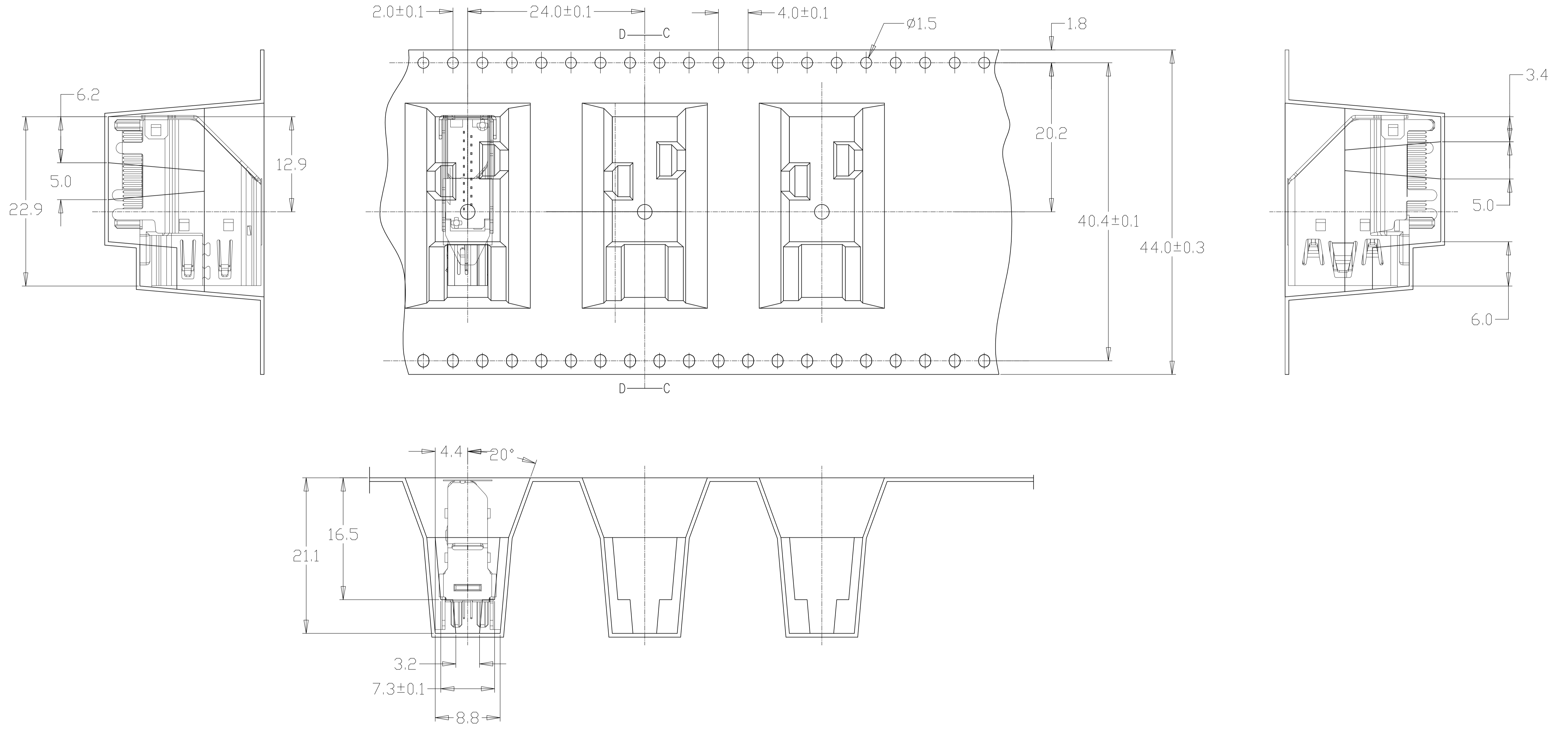

EMBOSS TAPE  
FOR PART NUMBER 2007435-6

THIS DRAWING IS A CONTROLLED DOCUMENT.		DWN	TE Connectivity	
DIMENSIONS: mm		CHK	NAME	
TOLERANCES UNLESS OTHERWISE SPECIFIED:		APVD	HDMI FLAG CONNECTOR ASSEMBLY	
0. PLC ± 0.3		PRODUCT SPEC	-	
1. PLC ± 0.15		APPLICATION SPEC	-	
2. PLC ± 0.10		WEIGHT	-	
3. PLC ± 0.10		SCALE	N/A	
4. PLC ± 0.10		SHEET	8 of 9	
ANGLES ± -		REV	D	
FINISH ± -		CUSTOMER DRAWING	-	
MATERIAL		SIZE	A1 00779 ©=2007435	



LOC		DIST		REVISIONS			
P	LTR	DESCRIPTION	DATE	DNW	APVD		
-	-	SEE SHEET 1	-	-	-	-	-

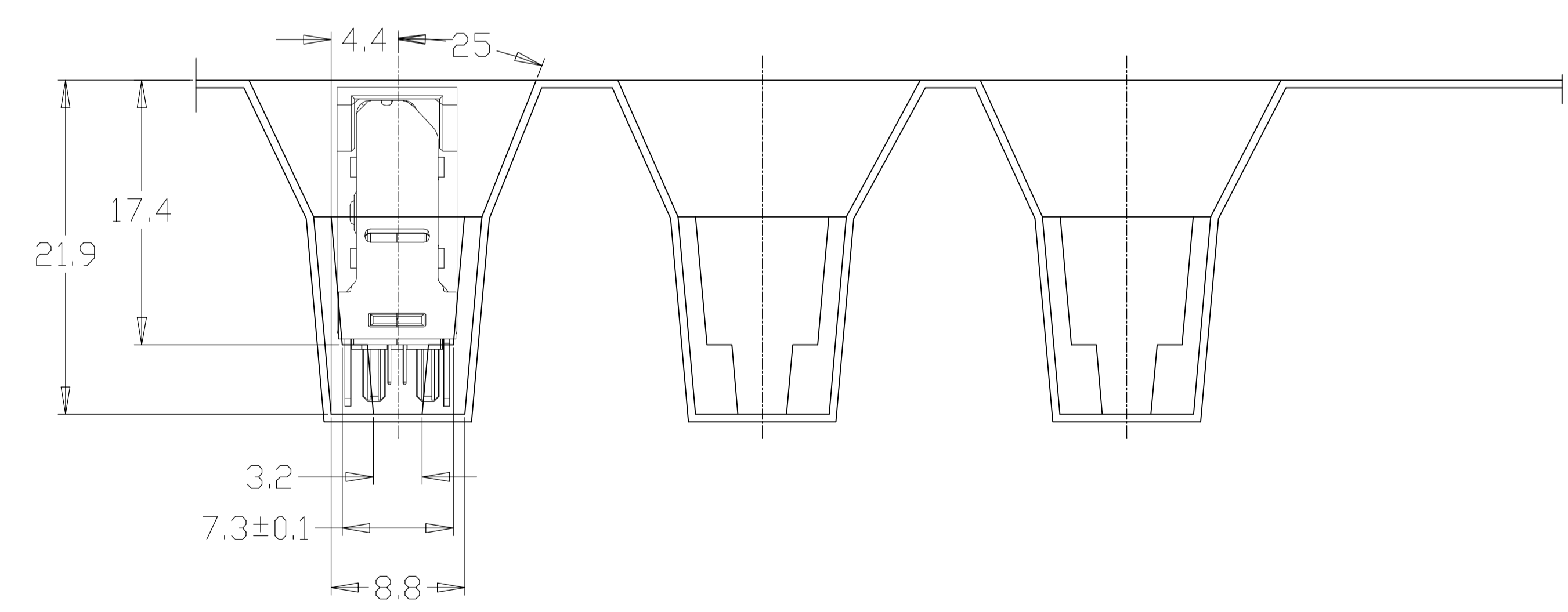
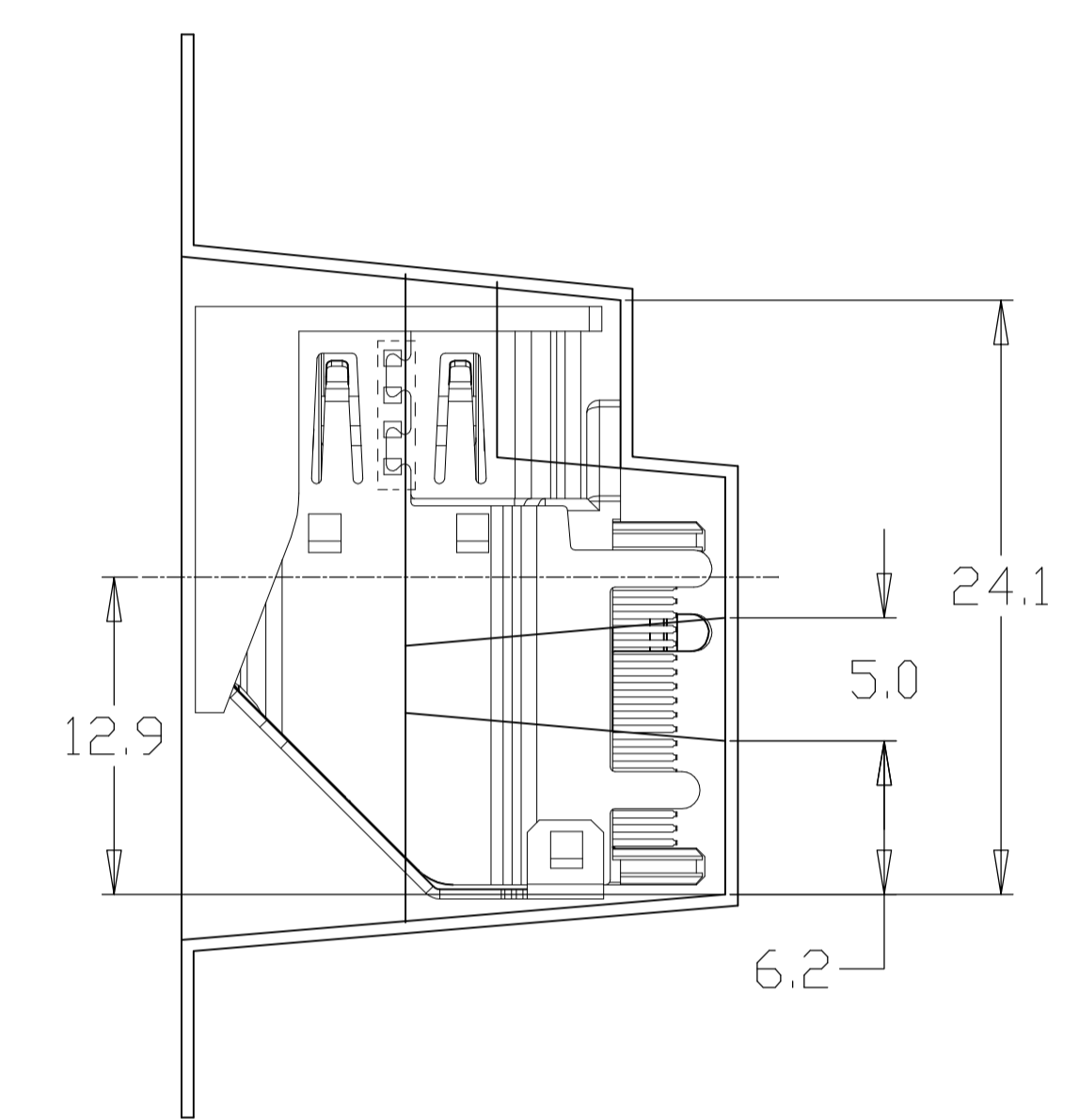
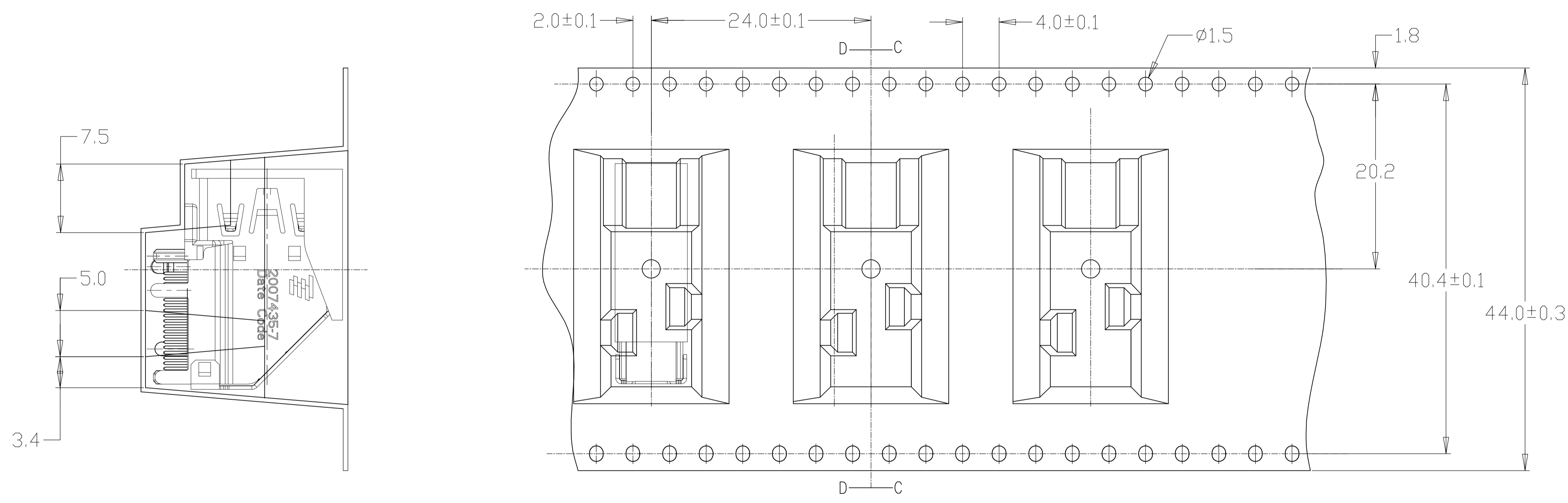

EMBOSS TAPE  
FOR PART NUMBER 2007435-7

THIS DRAWING IS A CONTROLLED DOCUMENT.		DIN		STE TE Connectivity	
DIMENSIONS: mm		CHK		NAME	
TOLERANCES UNLESS OTHERWISE SPECIFIED:		APVD		HDMI FLAG CONNECTOR ASSEMBLY	
0. PLC ± 0.3		PRODUCT SPEC		-	
1. PLC ± 0.15		APPLICATION SPEC		-	
2. PLC ± 0.10		MATERIAL		SIZE: A1	
3. PLC ± 0.10		FINISH		CAGE CODE: 00779	
4. PLC ± 0.10		MATERIAL		DRAWING NO: 2007435	
ANGLES ± 0.10		WEIGHT		RESTRICTED TO: -	
-		CUSTOMER DRAWING		SCALE: N/A	
-		SHEET 9 OF 9		REV D	

## Данный компонент на территории Российской Федерации

### Вы можете приобрести в компании MosChip.

Для оперативного оформления запроса Вам необходимо перейти по данной ссылке:

<http://moschip.ru/get-element>

Вы можете разместить у нас заказ для любого Вашего проекта, будь то серийное производство или разработка единичного прибора.

В нашем ассортименте представлены ведущие мировые производители активных и пассивных электронных компонентов.

Нашей специализацией является поставка электронной компонентной базы двойного назначения, продукции таких производителей как XILINX, Intel (ex.ALTERA), Vicor, Microchip, Texas Instruments, Analog Devices, Mini-Circuits, Amphenol, Glenair.

Сотрудничество с глобальными дистрибьюторами электронных компонентов, предоставляет возможность заказывать и получать с международных складов практически любой перечень компонентов в оптимальные для Вас сроки.

На всех этапах разработки и производства наши партнеры могут получить квалифицированную поддержку опытных инженеров.

Система менеджмента качества компании отвечает требованиям в соответствии с ГОСТ Р ИСО 9001, ГОСТ РВ 0015-002 и ЭС РД 009

### Офис по работе с юридическими лицами:

105318, г.Москва, ул.Щербаковская д.3, офис 1107, 1118, ДЦ «Щербаковский»

Телефон: +7 495 668-12-70 (многоканальный)

Факс: +7 495 668-12-70 (доб.304)

E-mail: [info@moschip.ru](mailto:info@moschip.ru)

Skype отдела продаж:

moschip.ru

moschip.ru\_4

moschip.ru\_6

moschip.ru\_9