

# General Specifications

## Electrical Capacity (Resistive Load)

**Low/Logic Level:** 50mA @ 24V DC

## Other Ratings

**Contact Resistance:** 50 milliohms maximum

**Insulation Resistance:** 500 megohms minimum @ 250V DC

**Dielectric Strength:** 250V AC minimum for 1 minute minimum

**Mechanical Life:** 500,000 operations minimum

**Electrical Life:** 500,000 operations minimum

**Nominal Operating Force:** 1.96N for sculptured actuator

2.0N for piano actuator

3.0N for square & round flush actuators

**Total Travel:** Flush Actuators .016" (0.4mm)

Sculptured & Piano Actuators .031" (0.8mm)

## Materials & Finishes

**Actuator:** Polyamide

**Case:** Glass fiber reinforced polyamide

**Seal:** Nitrile butadiene rubber

**Base:** Glass fiber reinforced polyester

**Movable Contact:** Phosphor bronze with silver plating

**Stationary Contacts:** Brass with silver plating

**Terminals:** Brass with silver plating

## Environmental Data

**Operating Temperature Range:** -25°C through +85°C (-13°F through +185°F)

**Humidity:** 90 ~ 95% humidity for 96 hours @ 40°C (104°F)

**Vibration:** 10 ~ 55Hz with peak-to-peak amplitude of 1.5mm traversing the frequency range & returning in 1 minute; 3 right angled directions for 2 hours

**Shock:** 50G (490m/s<sup>2</sup>) acceleration (tested in 6 right angled directions, with 5 shocks in each direction)

## PCB Processing

**Soldering:** Wave Soldering Recommended. See Profile A in Supplement section.

Manual Soldering: See Profile A in Supplement section.

**Cleaning:** Automated cleaning. See Cleaning specifications in Supplement section.

## Standards & Certifications

The JF Series tactiles have not been tested for UL recognition or CSA certification.

These switches are designed for use in a low-voltage, low-current, logic-level circuit.

When used as intended in a logic-level circuit, the results do not produce hazardous energy.

# Distinctive Characteristics

Extremely low profile of 5mm from PCB to top of switch.

Rubber seal construction prevents contact contamination and allows automated soldering and cleaning.

Minimal operating force and short stroke permit light touch operation.

Dome contact gives crisp tactile and audible feedback to positively indicate circuit transfer and assures high reliability and long life.

Wide choice of body shapes and colors.

Crimped terminals provide a spring type action to ensure secure mounting and prevent dislodging during wave soldering.

Space saving body dimensions provide for compact, side-by-side mounting on a standard grid.

Terminal spacing conforms to standard .100" (2.54mm) PCB grid.

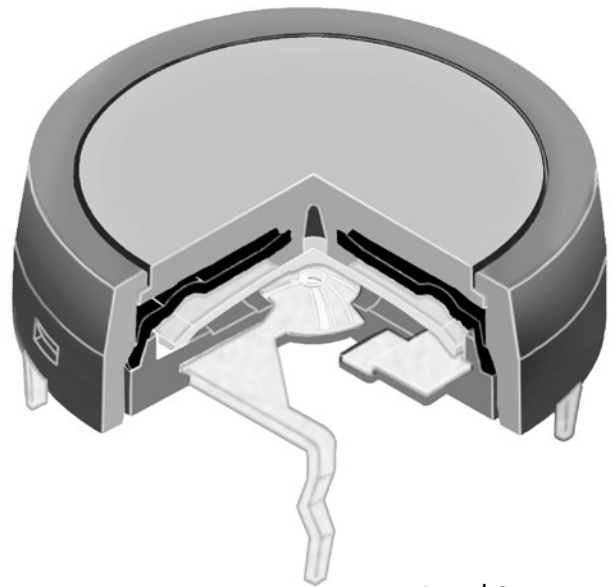

Actual Size



## Common Bus Matrix

These single pole, single throw switches can be used in a keyboard matrix and, using strapped terminals, achieve a common bus electrical configuration on a single-sided PC board.

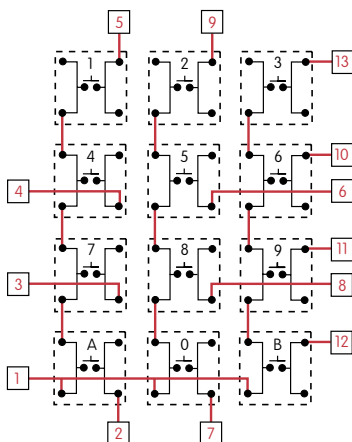

|                 |   | PC Terminations |   |   |   |   |   |   |   |   |    |    |    |    |
|-----------------|---|-----------------|---|---|---|---|---|---|---|---|----|----|----|----|
|                 |   | 1               | 2 | 3 | 4 | 5 | 6 | 7 | 8 | 9 | 10 | 11 | 12 | 13 |
| Keys (Switches) | 1 |                 |   |   |   |   |   |   |   |   |    |    |    |    |
|                 | 2 |                 |   |   |   |   |   |   |   |   |    |    |    |    |
|                 | 3 |                 |   |   |   |   |   |   |   |   |    |    |    |    |
|                 | 4 |                 |   |   |   |   |   |   |   |   |    |    |    |    |
|                 | 5 |                 |   |   |   |   |   |   |   |   |    |    |    |    |
|                 | 6 |                 |   |   |   |   |   |   |   |   |    |    |    |    |
|                 | 7 |                 |   |   |   |   |   |   |   |   |    |    |    |    |
|                 | 8 |                 |   |   |   |   |   |   |   |   |    |    |    |    |
|                 | 9 |                 |   |   |   |   |   |   |   |   |    |    |    |    |
|                 | 0 |                 |   |   |   |   |   |   |   |   |    |    |    |    |
|                 | A |                 |   |   |   |   |   |   |   |   |    |    |    |    |
|                 | B |                 |   |   |   |   |   |   |   |   |    |    |    |    |

● = ON

## X-Y Matrix

These single pole, single throw switches can be arranged on a single-sided PC board matrix with strapped terminals to achieve an X-Y type electrical interconnection.

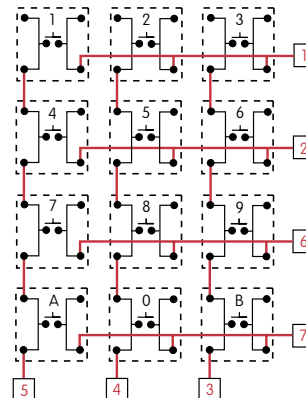

|                 |   | PC Terminations |   |   |   |   |   |   |
|-----------------|---|-----------------|---|---|---|---|---|---|
|                 |   | 1               | 2 | 3 | 4 | 5 | 6 | 7 |
| Keys (Switches) | 1 |                 |   |   |   |   |   |   |
|                 | 2 |                 |   |   |   |   |   |   |
|                 | 3 |                 |   |   |   |   |   |   |
|                 | 4 |                 |   |   |   |   |   |   |
|                 | 5 |                 |   |   |   |   |   |   |
|                 | 6 |                 |   |   |   |   |   |   |
|                 | 7 |                 |   |   |   |   |   |   |
|                 | 8 |                 |   |   |   |   |   |   |
|                 | 9 |                 |   |   |   |   |   |   |
|                 | 0 |                 |   |   |   |   |   |   |
|                 | A |                 |   |   |   |   |   |   |
|                 | B |                 |   |   |   |   |   |   |

● = ON

Red = PCB Trace    Black = Switch Circuit

### TYPICAL SWITCH ORDERING EXAMPLE

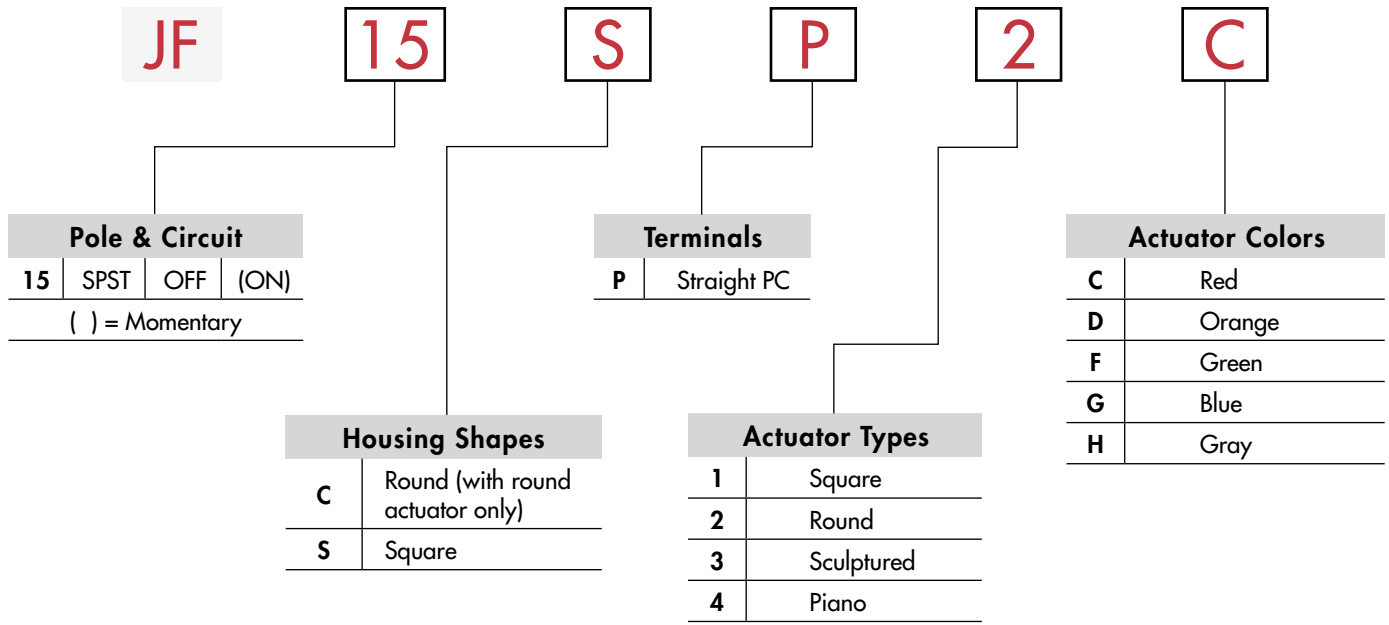

### DESCRIPTION FOR TYPICAL ORDERING EXAMPLE

**JF15SP2C**

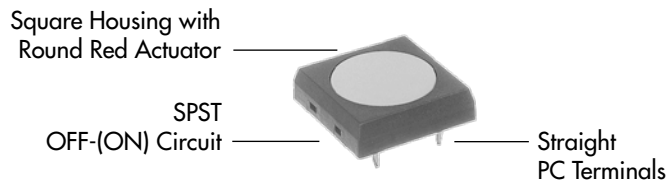

### POLE & CIRCUIT

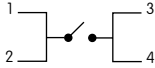
| Pole | Model | Actuator Position<br>( ) = Momentary |      | Switch Throw & Schematic  | Note: Terminal numbers are shown on the switch. |
|------|-------|--------------------------------------|------|---|---|
|      |       | Normal                               | Down |   |   |
| SP   | JF15  | OFF                                  | (ON) | SPST  |   |

HOUSING SHAPES & ACTUATOR TYPES

**C** Round Housing

**S** Square Housing

**2** Round Actuator

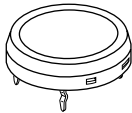

**1** Square Actuator

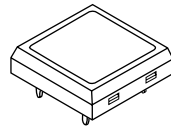

**2** Round Actuator

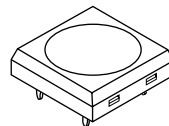

**3** Sculptured Actuator

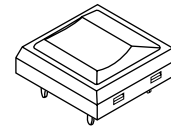

**4** Piano Actuator

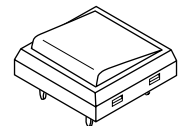

Actuator Colors Available:

**C** Red

**D** Orange

**F** Green

**G** Blue

**H** Gray

Housing is Black

TERMINALS & PANEL DESIGN

**P** Straight PC

Additional details in Typical Switch Dimensions

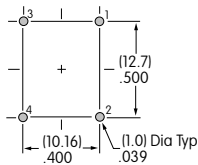
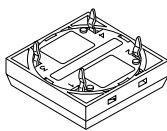

Versatile panel arrangements can be made to fit individual design needs.

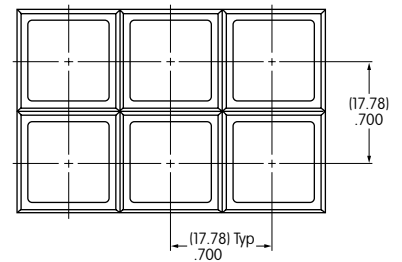
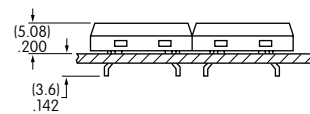

TYPICAL SWITCH DIMENSIONS

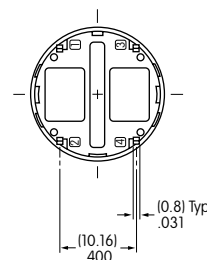
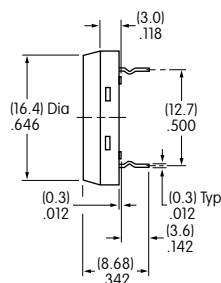
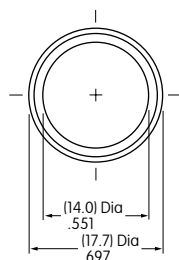

Round Actuator



JF15CP2C

Toggles  
Rocker  
Pushbuttons  
Illuminated PB  
Programmable  
Keylocks  
Rotaries  
Slides  
Tactiles  
Tilt  
Touch  
Indicators  
Accessories  
Supplement

## TYPICAL SWITCH DIMENSIONS

### Square Actuator

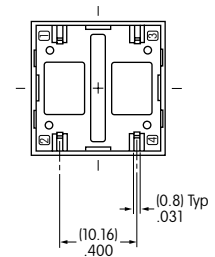
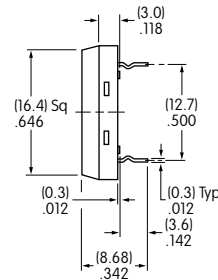
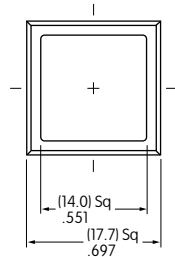

JF15SP1C

### Round Actuator

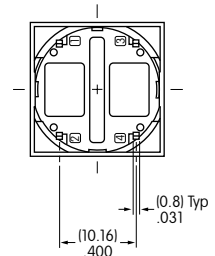
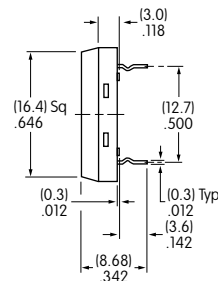
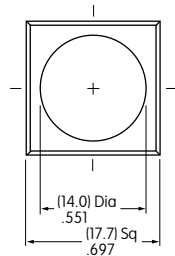

JF15SP2C

### Sculptured Actuator

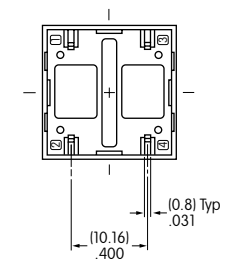
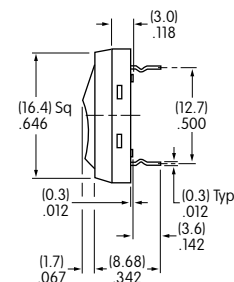
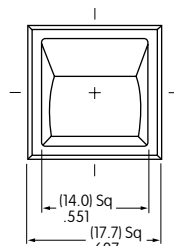
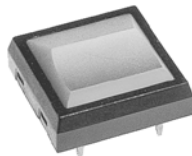

JF15SP3C

### Piano Actuator

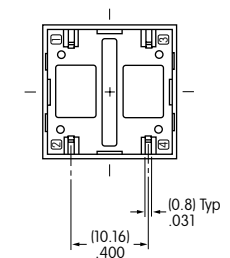
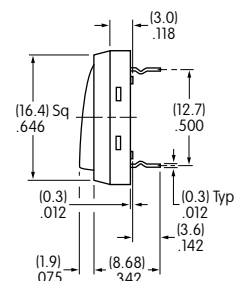
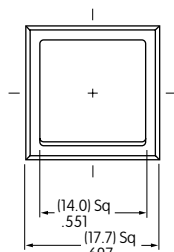
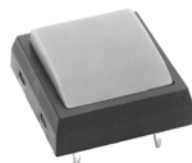

JF15SP4C

Toggles

Rockers

Pushbuttons

Illuminated PB

Programmable

Keylocks

Rotaries

Slides

Tactiles

Tilt

Touch

Indicators

Accessories

Supplement

LEGENDS

NKK Switches can provide custom legends for caps. Contact factory for more information.

Shaded Areas are Printable Areas

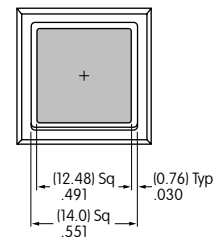
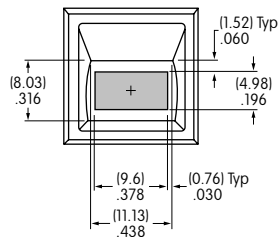
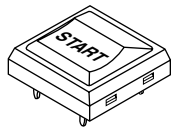
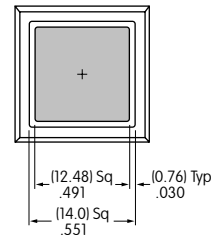
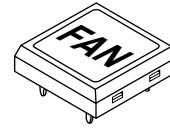
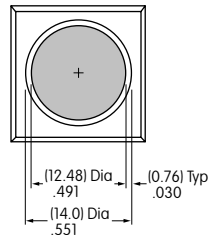
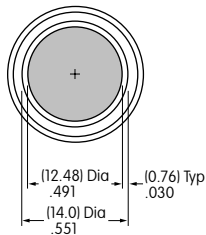

Recommended Print Methods: Screen Print or Pad Print. Epoxy based ink is recommended.

## Данный компонент на территории Российской Федерации

### Вы можете приобрести в компании MosChip.

Для оперативного оформления запроса Вам необходимо перейти по данной ссылке:

<http://moschip.ru/get-element>

Вы можете разместить у нас заказ для любого Вашего проекта, будь то серийное производство или разработка единичного прибора.

В нашем ассортименте представлены ведущие мировые производители активных и пассивных электронных компонентов.

Нашей специализацией является поставка электронной компонентной базы двойного назначения, продукции таких производителей как XILINX, Intel (ex.ALTERA), Vicor, Microchip, Texas Instruments, Analog Devices, Mini-Circuits, Amphenol, Glenair.

Сотрудничество с глобальными дистрибьюторами электронных компонентов, предоставляет возможность заказывать и получать с международных складов практически любой перечень компонентов в оптимальные для Вас сроки.

На всех этапах разработки и производства наши партнеры могут получить квалифицированную поддержку опытных инженеров.

Система менеджмента качества компании отвечает требованиям в соответствии с ГОСТ Р ИСО 9001, ГОСТ РВ 0015-002 и ЭС РД 009

### Офис по работе с юридическими лицами:

105318, г.Москва, ул.Щербаковская д.3, офис 1107, 1118, ДЦ «Щербаковский»

Телефон: +7 495 668-12-70 (многоканальный)

Факс: +7 495 668-12-70 (доб.304)

E-mail: [info@moschip.ru](mailto:info@moschip.ru)

Skype отдела продаж:

moschip.ru

moschip.ru\_4

moschip.ru\_6

moschip.ru\_9