

**PLEASE CHECK WWW.MOLEX.COM FOR LATEST PART INFORMATION**

**Part Number:** **0673450000**  
**Status:** **Active**  
**Description:** 0.80mm (.031") Pitch SODIMM Socket, Right Angle, SMT, Reverse Mount, 5.20mm (.205") Mounted Height, 144 Circuits, 3.3V Power Supply, Soft Tray Packaging

**Documents:**

[3D Model](#) [RoHS Certificate of Compliance \(PDF\)](#)  
[Drawing \(PDF\)](#)

**General**

Product Family	Memory Module Sockets
Series	<a href="#">67345</a>
Comments	3.3V Power Supply
Component Type	Socket
JEDEC Outline	N/A
Product Name	S.O. DIMM

**Physical**

Circuits (Loaded)	144
Durability (mating cycles max)	30
Entry Angle	90° Angle (Side Entry)
Keying to Mating Part	Yes
Material - Plating Mating	Gold
PCB Retention	Yes
PCB Thickness Recommended (in)	0.045 In
PCB Thickness Recommended (mm)	1.20 mm
Packaging Type	Tray
Pitch - Mating Interface (in)	0.031 In
Pitch - Mating Interface (mm)	0.80 mm
Temperature Range - Operating	-55°C to +85°C
Termination Interface: Style	Surface Mount

**Electrical**

Current - Maximum per Contact	0.3A
Voltage - Maximum	100V
Voltage Key	3.3V

**Material Info**

**Reference - Drawing Numbers**

Product Specification	RPS-54698-004
Sales Drawing	SD-67345-001

**EU RoHS** **China RoHS**

**Compliance Status**

**Not Reviewed**

**REACH SVHC**

**Not Reviewed**

**Halogen-Free**

**Status**

**Not Reviewed**

**Need more information on product environmental compliance?**

Email [productcompliance@molex.com](mailto:productcompliance@molex.com)  
 For a multiple part number RoHS Certificate of Compliance, [click here](#)

Please visit the [Contact Us](#) section for any non-product compliance questions.

**Search Parts in this Series**

[67345Series](#)

**Mates With**

JEDEC Standard DRAM and SDRAM modules

10 9 8 7 6 5 4 3 2 1

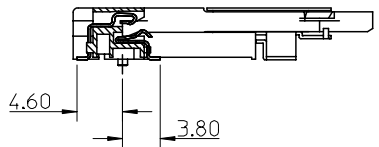
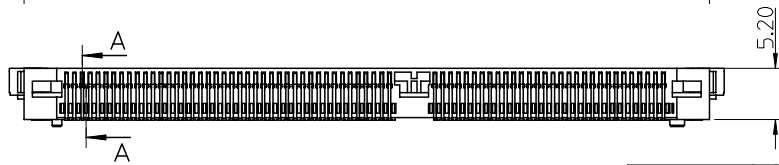
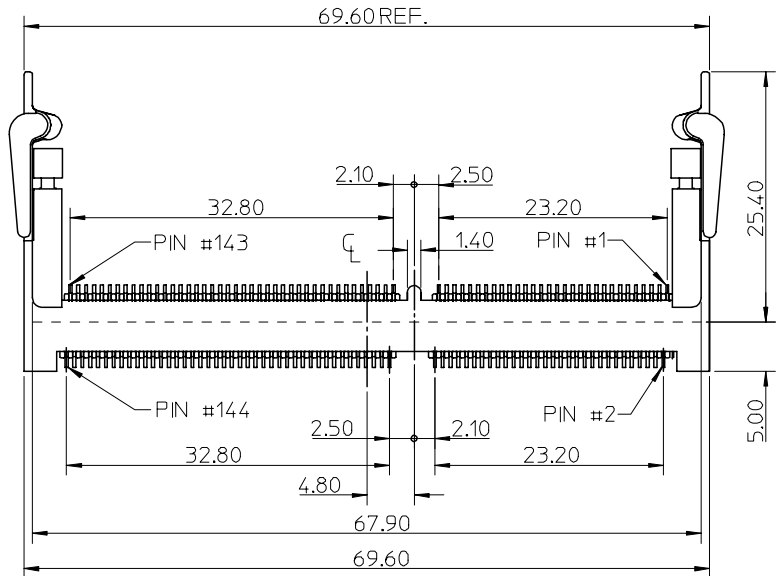
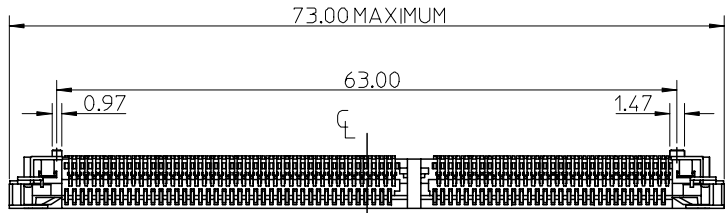

Section A-A

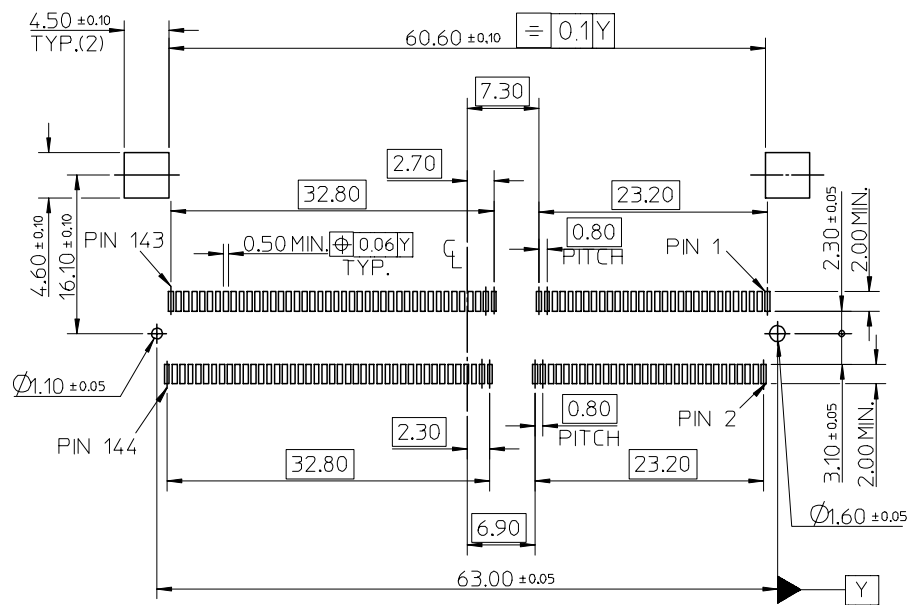
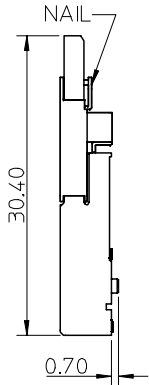

RECOMMENDED PCB PATTERN LAYOUT

NOTES:

- MATERIAL  
HOUSING - HIGH TEMPERATURE PLASTIC, GLASS FILL, UL 94V-0  
TERMINAL - COPPER ALLOY  
NAIL - COPPER ALLOY
- FINISH  
TERMINAL - 0.25 MICROMETER GOLD IN CONTACT AREA  
1.0 MICROMETER TIN-LEAD IN SOLDER TAIL  
NAIL - 2.0 MICROMETER TIN-LEAD
- COPLANARITY : 0.1 mm MAXIMUM
- PRODUCT SPECIFICATION: RPS-54698-004

EC NO: SH200500073 DRWN: WFDENG 2004/11/02 CHKD: 2004/11/04 APPR: YTYAP 2004/11/05	QUALITY SYMBOLS	GENERAL TOLERANCES (UNLESS SPECIFIED)		SCALE 2:1	DESIGN UNITS METRIC	THIRD ANGLE PROJECTION	REVISE ON CAD ONLY
	▴ - 0 ▽ - 0	mm INCH 4 PLACES ± --- ± --- 3 PLACES ± --- ± --- 2 PLACES ± 0.25 ± --- 1 PLACE ± 0.25 ± --- ANGULAR ± 2 °	DIMENSION STYLE MM ONLY DRAWN BY WILSON DATE 00/03/09 CHECKED BY MEGA LIN DATE APPROVED BY MEGA LIN DATE		TITLE 0.8 MM PITCH SODIMM 5.2H REVERSE MOLEX MOLEX INCORPORATED		MATERIAL NO. SEE TABLE DOCUMENT NO. SD-67345-001 SHEET NO. 1 OF 3
REV	DESCRIPTION	DRAFT WHERE APPLICABLE MUST REMAIN WITHIN DIMENSIONS		THIS DRAWING CONTAINS INFORMATION THAT IS PROPRIETARY TO MOLEX INCORPORATED AND SHOULD NOT BE USED WITHOUT WRITTEN PERMISSION		A3	

9 8 7 6 5 4 3 2 1

10 9 8 7 6 5 4 3 2 1

PART NO. 67345-0000	COLOR BLACK	PACKAGING PK-67345-001 (SOFT TRAY)
67345-0100	BLACK	PK-67345-002 (SEMI-HARD TRAY)

△

F  
E  
D  
C  
B  
A

F  
E  
D  
C  
B  
A

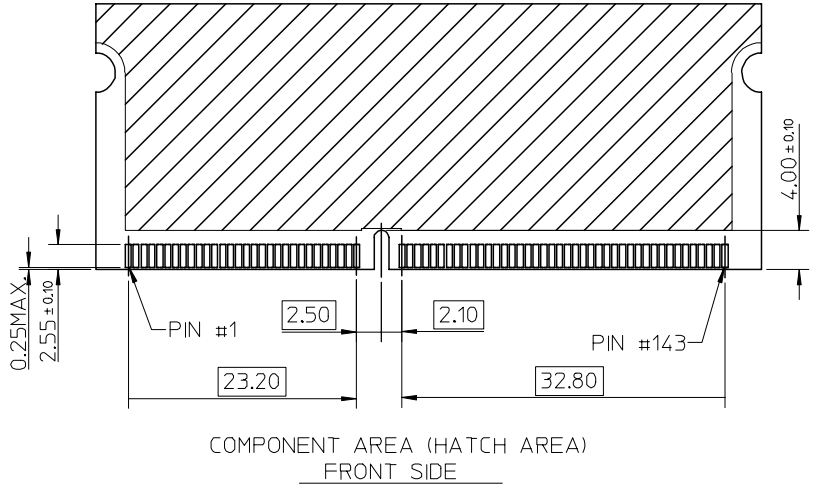
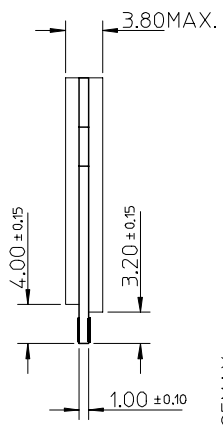
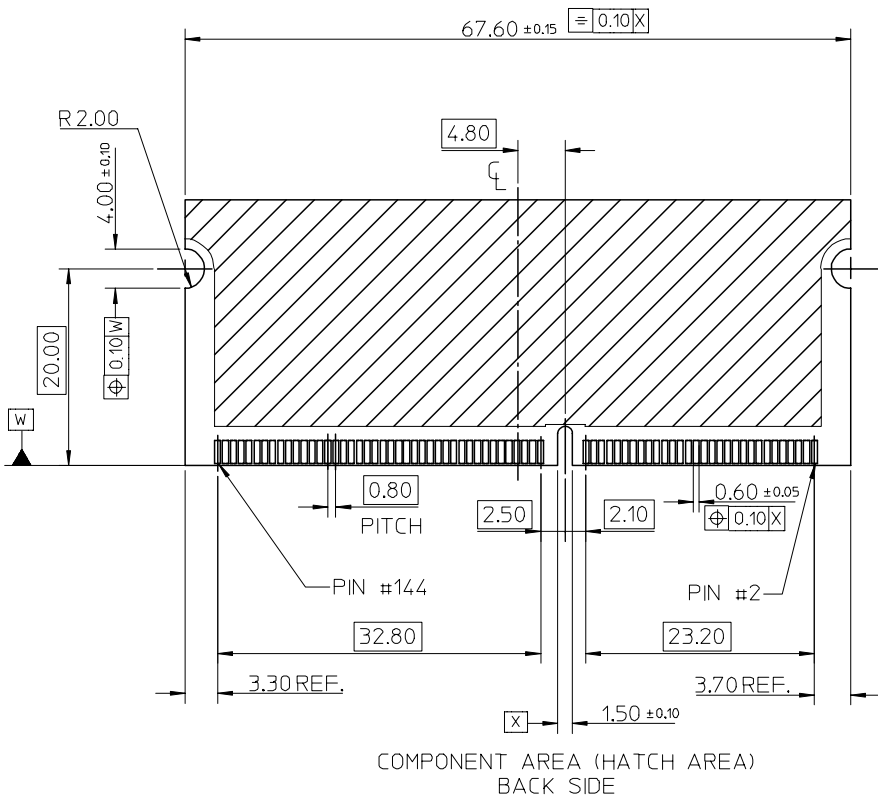

COMPONENT AREA (HATCH AREA)  
BACK SIDE

COMPONENT AREA (HATCH AREA)  
FRONT SIDE

EC NO: SH200500073 DRWN: WFDENG 2004/11/02 CHKD: 2004/11/04 APPR: YTYAP 2004/11/05	QUALITY SYMBOLS	GENERAL TOLERANCES (UNLESS SPECIFIED)	SCALE 2:1	DESIGN UNITS METRIC	THIRD ANGLE PROJECTION	REVISE ON CAD ONLY
	▼ - 0	mm INCH	DIMENSION STYLE MM ONLY		TITLE	
	▽ - 0	4 PLACES ± --- ± ---	DRAWN BY WILSON DATE 00/03/09		0.8 MM PITCH SODIMM 5.2H REVERSE	
		3 PLACES ± --- ± ---	CHECKED BY MEGA LIN DATE		MOLEX INCORPORATED	
	2 PLACES ± 0.25 ± ---	APPROVED BY MEGA LIN DATE		MATERIAL NO. SEE TABLE	DOCUMENT NO. SD-67345-001	SHEET NO. 2 OF 3
	1 PLACE ± 0.25 ± ---	DRAFT WHERE APPLICABLE MUST REMAIN WITHIN DIMENSIONS		THIS DRAWING CONTAINS INFORMATION THAT IS PROPRIETARY TO MOLEX INCORPORATED AND SHOULD NOT BE USED WITHOUT WRITTEN PERMISSION		
	ANGULAR ± 2 °					

9 8 7 6 5 4 3 2 1

A3

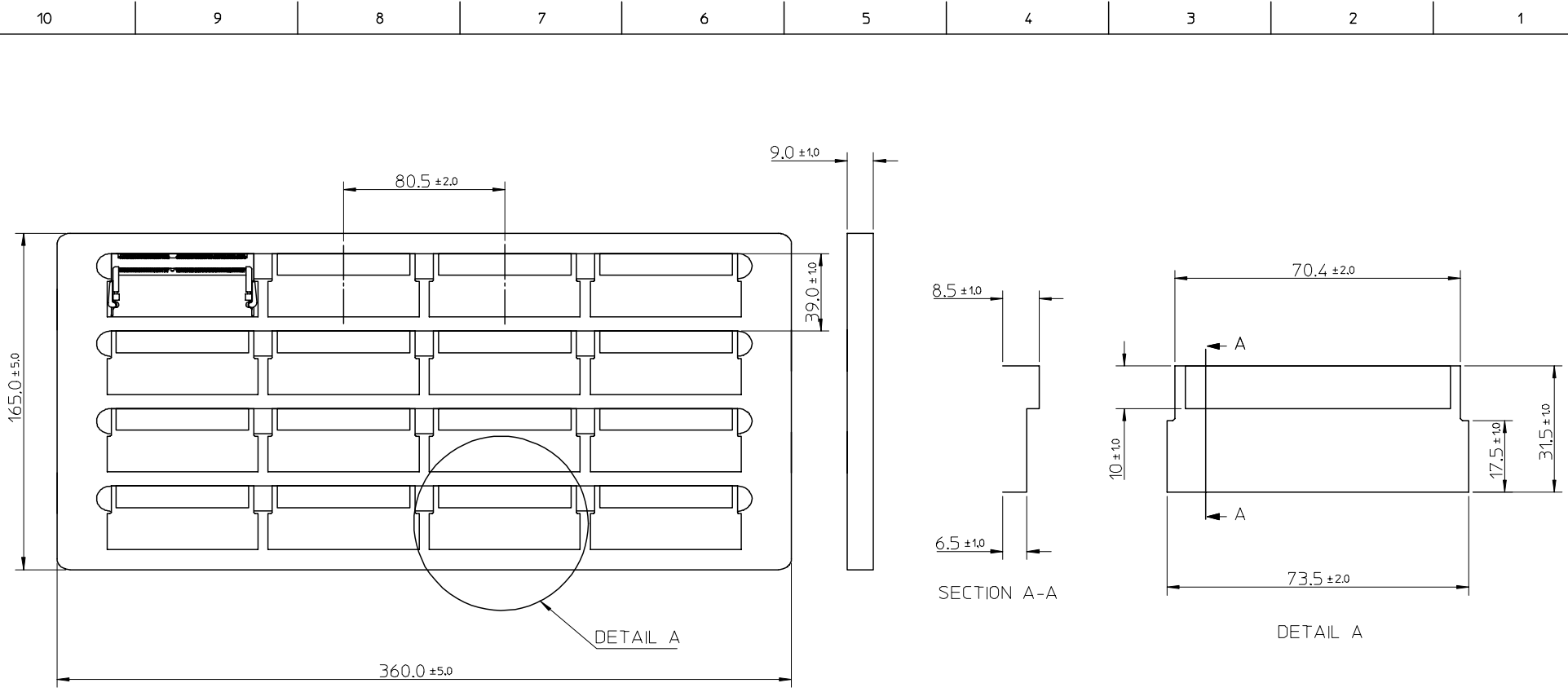

DRAWING OF TRAY PACKAGING

EC NO: <b>S14200540873</b> DRWN: WFDENG 2004/11/02 CHKD: 2004/11/04 APPR: YTYAP 2004/11/05	QUALITY SYMBOLS	GENERAL TOLERANCES (UNLESS SPECIFIED)		SCALE N/A	DESIGN UNITS METRIC	THIRD ANGLE PROJECTION	REVISE ON CAD ONLY
	 		mm	INCH	DIMENSION STYLE MM ONLY		TITLE
		4 PLACES	± ---	± ---	DRAWN BY	DATE	<b>0.8 MM PITCH SODIMM 5.2H REVERSE</b>
		3 PLACES	± ---	± ---	WILSON	00/03/09	
2 PLACES	± 0.25	± ---	CHECKED BY	DATE	<b>MOLEX INCORPORATED</b>		
1 PLACE	± 0.25	± ---	MEGA LIN				
		ANGULAR ± 2 °		APPROVED BY	DATE	MATERIAL NO.	DOCUMENT NO.
		DRAFT WHERE APPLICABLE		MEGA LIN		SEE TABLE	SD-67345-001
		MUST REMAIN WITHIN DIMENSIONS		THIS DRAWING CONTAINS INFORMATION THAT IS PROPRIETARY TO MOLEX INCORPORATED AND SHOULD NOT BE USED WITHOUT WRITTEN PERMISSION		SHEET NO.	3 OF 3

## Данный компонент на территории Российской Федерации

### Вы можете приобрести в компании MosChip.

Для оперативного оформления запроса Вам необходимо перейти по данной ссылке:

<http://moschip.ru/get-element>

Вы можете разместить у нас заказ для любого Вашего проекта, будь то серийное производство или разработка единичного прибора.

В нашем ассортименте представлены ведущие мировые производители активных и пассивных электронных компонентов.

Нашей специализацией является поставка электронной компонентной базы двойного назначения, продукции таких производителей как XILINX, Intel (ex.ALTERA), Vicor, Microchip, Texas Instruments, Analog Devices, Mini-Circuits, Amphenol, Glenair.

Сотрудничество с глобальными дистрибьюторами электронных компонентов, предоставляет возможность заказывать и получать с международных складов практически любой перечень компонентов в оптимальные для Вас сроки.

На всех этапах разработки и производства наши партнеры могут получить квалифицированную поддержку опытных инженеров.

Система менеджмента качества компании отвечает требованиям в соответствии с ГОСТ Р ИСО 9001, ГОСТ РВ 0015-002 и ЭС РД 009

### Офис по работе с юридическими лицами:

105318, г.Москва, ул.Щербаковская д.3, офис 1107, 1118, ДЦ «Щербаковский»

Телефон: +7 495 668-12-70 (многоканальный)

Факс: +7 495 668-12-70 (доб.304)

E-mail: [info@moschip.ru](mailto:info@moschip.ru)

Skype отдела продаж:

moschip.ru

moschip.ru\_4

moschip.ru\_6

moschip.ru\_9