



Circular Connectors

Content

Page

| | |
|------------------------------|-----|
| powerCON Series | 112 |
| Ordering Information | 113 |
| Accessories | 113 |
| powerCON 32 Amp Series | 114 |
| Ordering Information | 114 |
| nanoCON Series | 115 |
| Ordering Information | 116 |
| miniCON Series | 117 |
| Ordering Information | 118 |
| neutriCON Series | 119 |
| Ordering Information | 120 |
| Technical Data | 121 |
| Assembly Tools | 122 |



Introduction

The Neutrik® circular connector program is a range of metal, multi-pole connectors specifically designed for industrial applications. These series provide a variety of male and female cable connectors and receptacles that can be terminated by soldering and crimping or to printed circuit boards. An easy to use and reliable quick-lock system ensures a perfect connection and cannot be released accidentally. The circular connectors offer Neutrik® unique chuck type strain relief and reinforced housing for robust dependability.

The Neutrik® industrial connector range also features a unique power connector for single phase applications up to 32 Amps.

Further features are:

- Number of contacts is 1 to 12
- Self-locking system
- Robust all-metal housing
- Front or rear mounting
- Chuck and crimp type strain relief
- Gold plated contacts
- Solder or crimp termination
- Printed circuit board mounting
- Excellent shielding (crimp type strain relief)

The main areas of applications are in the measurement, test and control, automotive and machine tool industry as well as medical technique.



New quick lock



Neutrik hologram



3/16" flat tabs



Coupler for linking cables

powerCON - Locking 3 Pole Power Connectors



NAC3FCA



NAC3MPA-1



NAC3FCB



NAC3MPB-1



NAC3MM-1

- Lockable 3 pole equipment (AC) connector with contacts for line, neutral and pre-mating safety ground
- High current capacity, rated at 20A / 250V ac
- Colour coded for easy identification, powerCON offers power-in (blue) and power-out (grey) versions with different keying to avoid the possibility of intermating
- Fast and easy locking system
- Extremely robust and reliable
- Excellent cable retention
- UL, cUL recognized components (file no. E 135070)
VDE certified (Reg. No. 6360),
SEV approved (No. 96.1 10096)
- New latch design for easier handling and secure locking
- Branded with unique hologram - guarantees genuine and authentic Neutrik product
- Coupler for linking cables (couples NAC3FCA to NAC3FCB)

NAC3FCA(B)

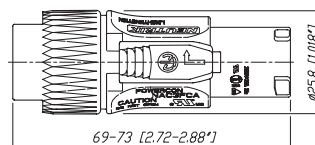

NAC3MPA(B)

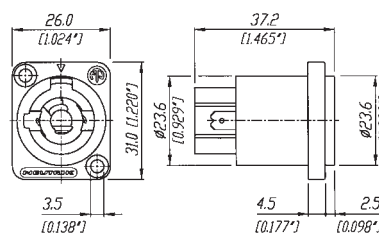

NAC3MM

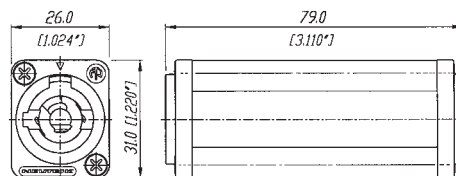

Ordering Information

| | |
|-----------|-------------------------------------------------------------------------------------------|
| NAC3FCA | Cable connector, quick lock with securing lever, A-type for power inlet, screw terminals |
| NAC3MPA-1 | Air tight chassis connector, A-type for power inlet, flat tab terminals |
| NAC3FCB | Cable connector, quick lock with securing lever, B-type for power outlet, screw terminals |
| NAC3MPB-1 | Air tight chassis connector, B-type for power outlet, flat tab terminals |
| NAC3MM-1 | Coupler for linking cables (couples NAC3FCA to NAC3FCB) |

Accessories

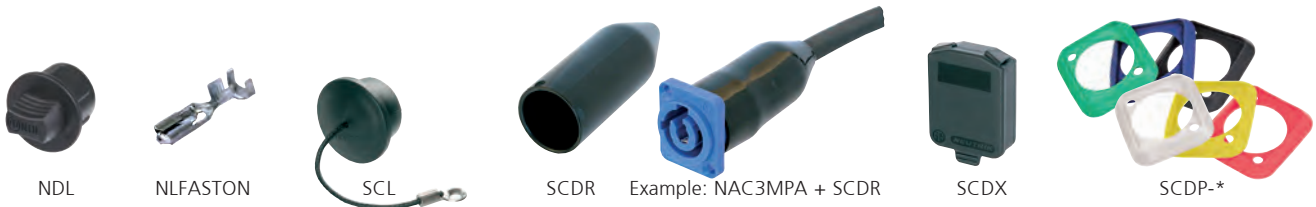

| | |
|----------|-------------------------------------------------------------------------------------------------------|
| NDL | dummyPLUG for powerCON 20 A chassis connector |
| NLFASTON | FASTON® receptacle for tabs with "positive lock" for use with NL4MP, NL4MPR, NL8MPR, Pack of 100 pcs. |
| SCL | Plastic sealing cover to protect the connectors against dust and moisture |
| SCDR | Rear end protection cover for D-size chassis connectors |
| SCDP-* | D-Size sealing gaskets, colour coding (*: 0- black, 2- red, 4- yellow, 5- green, 6- blue, 9- white) |
| SCDX | Hinged cover seals D-size chassis connectors, IP42 rated |

KEYWAYS

With the two non-interchangeable types of connectors (A type and B type) it is impossible to produce a short circuit. Mating connectors (combination) are identified by mechanical keyways and by color.

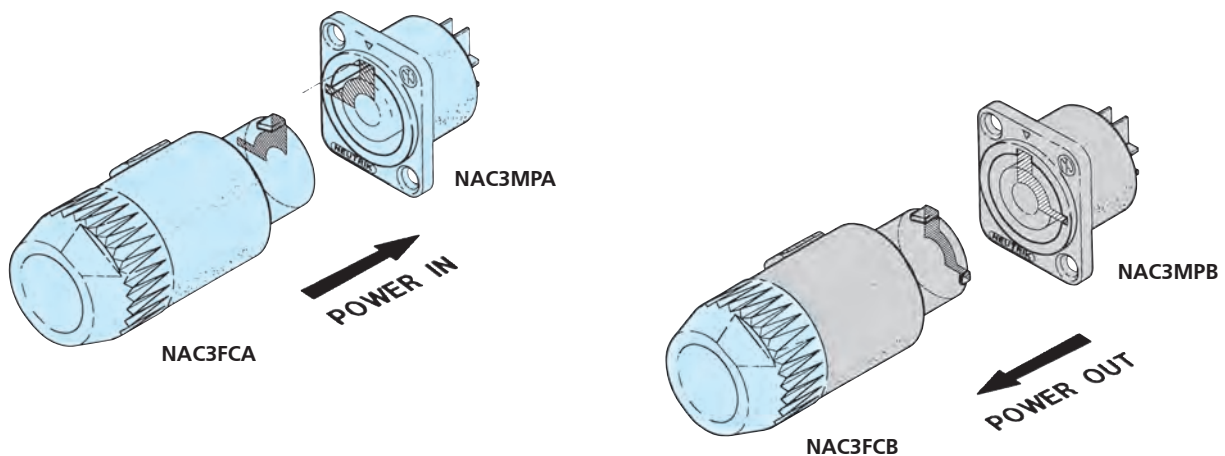

ATTENTION

The technical data of the powerCON connectors refer to connectors without breaking capacity, meaning connecting devices not to be engaged and disengaged in normal use when live or under load.



Robust metal housing



Screw-type terminals

powerCON 32 Amp Connectors



NAC3FC-HC



NAC3MP-HC

- Locking single phase AC appliance coupler
- High current capacity (32 A rated)
- Fast and easy locking system
- Excellent cable handling and protection
- Extremely robust and reliable
- 250 V ac, 32 Amp single-phase (for ambient temperatures up to 35°C)
- Premating contact for protective earth
- Locking system to prevent unintentional disengagement
- Cable O.D. Range: 8 - 20 mm
- Wiring with screw-type terminals for wires 2.5 to 6.0 mm² (AWG 14 - 10)

NAC3FC-HC

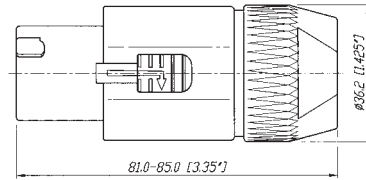

NAC3MP-HC

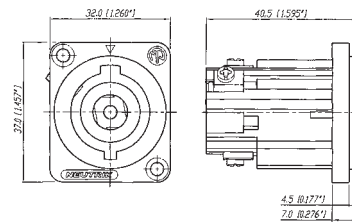

Ordering Information

| | |
|-----------|------------------------------------------------------------------|
| NAC3FC-HC | Cable connector, quick lock with securing lever, screw terminals |
| NAC3MP-HC | Fast and easy locking system, screw-type terminals |



Connector locking



PCB receptacle

nanoCON - 3 Pole Subminiature Connectors



NP3F-H



NSC3F



NR3M-S

- World's smallest circular lockable multipole connector
- Robust metal housing with gold plated contacts
- Male and female receptacles for vertical or horizontal PCB mount or solder termination
- Cable connector and receptacle with interchangeable male and female inserts
- Reliable and versatile in applications like medical equipment, control systems, sensors or audio applications such as miniature and wireless microphones and portable mixers
- Pre-mating contact 1

NSC3F(M)

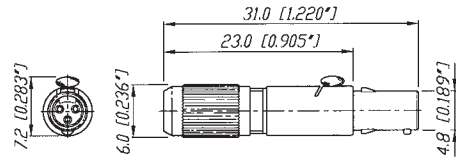

NR3F(M)-S

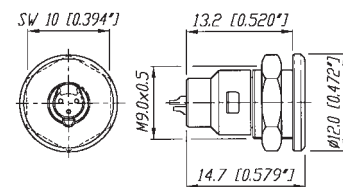

NP3F(M)-H

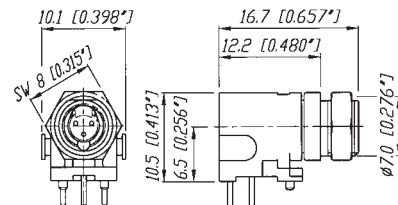

M 1:1



Ordering Information

| Female | | Male | |
|--------|---------------------------------------------------|--------|---------------------------------------------------|
| NSC3F | Cable connector, chuck principle, solder contacts | NSC3M | Cable connector, chuck principle, solder contacts |
| NR3F-S | Receptacle panel mount, solder contacts | NR3M-S | Receptacle panel mount, solder contacts |
| NP3F-H | Receptacle horizontal PCB mount | NP3M-H | Receptacle horizontal PCB mount |
| NP3F-V | Receptacle vertical PCB mount | NP3M-V | Receptacle vertical PCB mount |

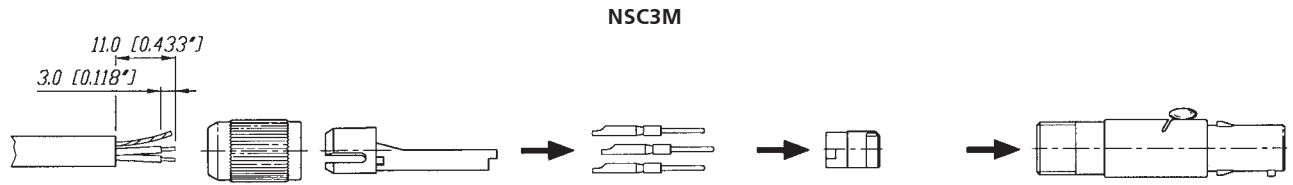
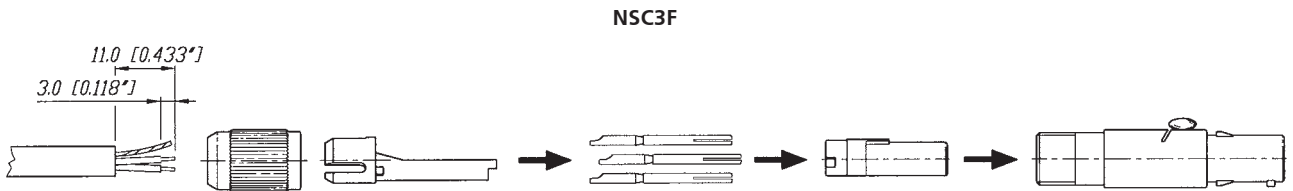

NP3F-H
NP3M-H

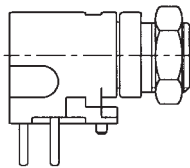

NR3F-S

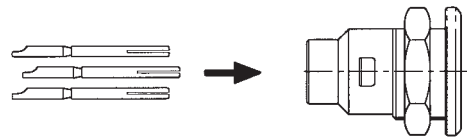

NP3F-V
NP3M-V

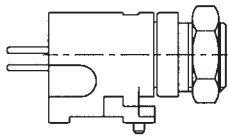

NR3M-S

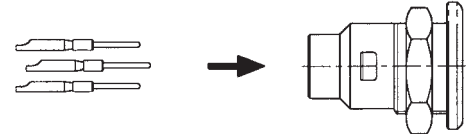

Contact Arrangement

Stecker



Buchse



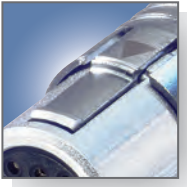

Push Pull locking



Gold solder contacts

miniCON - 12 Pole Miniature Connectors



MSCM12



MRF12



MMC* (modular system)

- Up to 12 pole miniature connector
- Complete set or modular system
- Push-pull self-locking system
- Precisely machined, rugged all metal design
- Fully loaded male and female receptacles for horizontal or vertical PCB mount
- Gold plated contacts, crimp or solder, velour chromium housing
- Special crimp type strain relief establishes an ideal coaxial connection of the cable shield to the connector shell for best EMC shielding
- Easy assembly: contact soldering in disassembled condition avoids awkward wiring of wight density contacts
- Interchangeable insert (male-female)

MSCF(M)12 (+MSRC)

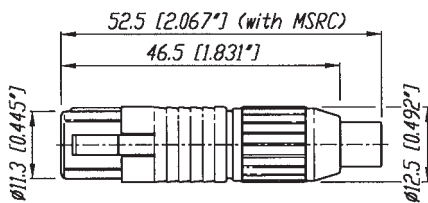

MPF(M)12-V

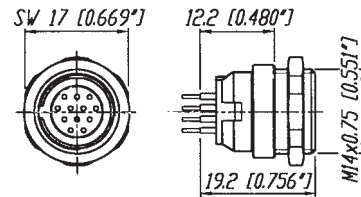

MRF(M)12

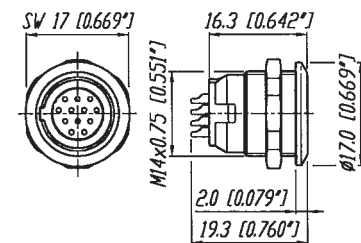

MPF(M)12-H

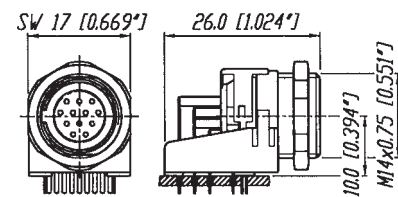

Ordering Information for complete miniCON set

Complete set (consisting of housing, insert, 12 contacts and chuck for cable connector)

| Female | | Male | |
|---------|---------------------------------------------------|---------|---------------------------------------------------|
| MSCF12 | Cable connector, chuck principle, solder contacts | MSCM12 | Cable connector, chuck principle, solder contacts |
| MRF12 | Receptacle panel mount, solder contacts | MRM12 | Receptacle panel mount, solder contacts |
| MPF12-H | Receptacle horizontal PCB mount | MPM12-H | Receptacle horizontal PCB mount |
| MPF12-V | Receptacle vertical PCB mount | MPM12-V | Receptacle vertical PCB mount |

MSCF(M)12



MPF(M)12-V

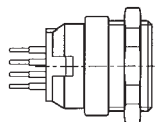

MPF(M)12-H

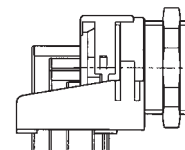

Ordering Information for modular miniCON system

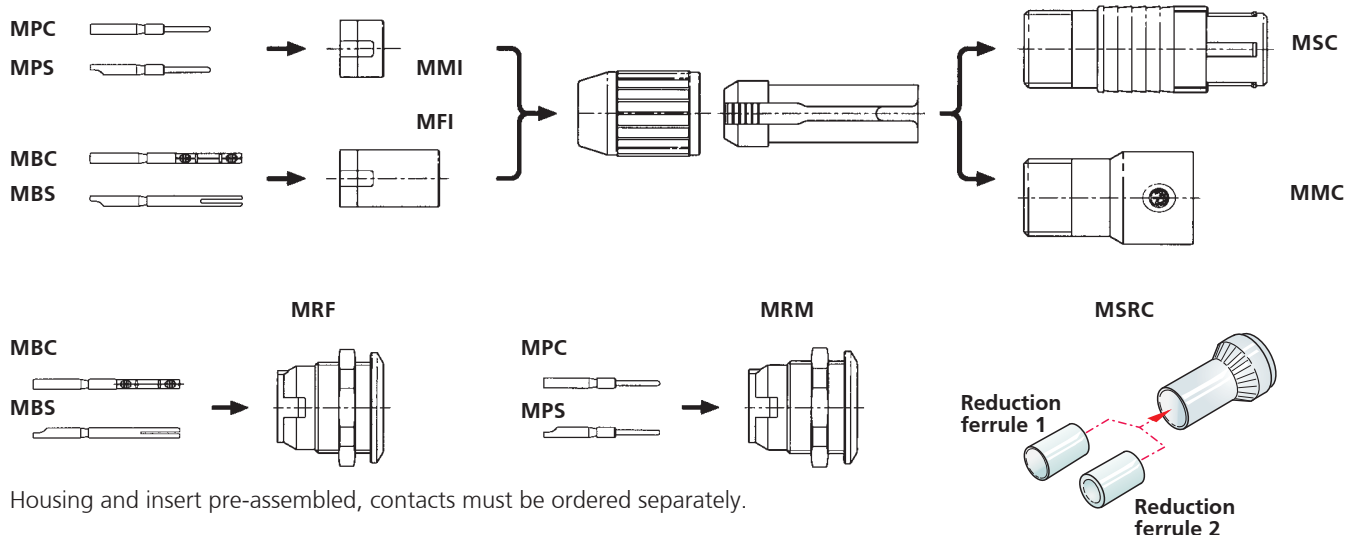

Modular system

| Female | | Male | |
|--------|----------------------------------------------------------------------------------------------------------------|------|----------------------------------------------------|
| MFI | Insert for cable connector | MMI | Insert for cable connector |
| MBC | Crimp contacts for cable connector and receptacle | MPC | Crimp contacts for cable connector and receptacle |
| MBS | Solder contacts for cable connector and receptacle | MPS | Solder contacts for cable connector and receptacle |
| MRF | Receptacle housing and insert pre-assembled | MRM | Receptacle housing and insert pre-assembled |
| MMC | Cable connector extension, incl. chuck (for male and female) | | |
| MSC | Cable connector housing, incl. chuck (for male and female) | | |
| MSRC | Set of strain relief crimp version (consisting of crimp ferrule & reduction ferrule 1 + 2, tools see page 122) | | |



Push Pull locking



All metal housing

neutriCON - Versatile Circular Connectors



ORP8F-Ni



OSC8F



ORP8M

- Complete set or modular system for any desirable configuration
- Contact configuration can be selected from 1 to 8 contacts
- Special crimp type strain relief establishes an ideal circumferential connection of the cable shield to the connector shell as required by best EMC working practice
- Precise and robust all metal housing absorbs vibration forces and protects contact inserts
- Easy, fast and screwless assembly
- Push-pull self-locking system

OSC8F / OSC8M

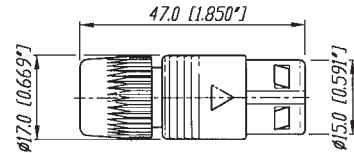

MODULAR SYSTEM

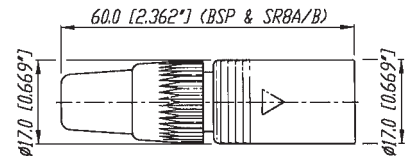

MC8 + SR8A/B + insert

Polarization

Housing: Two variants of metal polarizing guides (90° and 180°).

Coding 90°

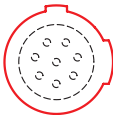

Coding 180°

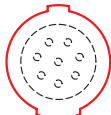

Insert: The male and female insert can be assembled in all three housings.

ORP8F / ORP8M

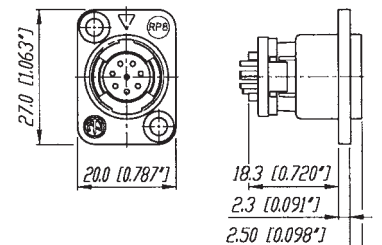

Ordering Information for complete neutriCON set

Complete set (consisting of housing, insert, 8 contacts and chuck for cable connector)

| | |
|----------|--------------------------------------------------------------------------|
| OSC8F | Female cable connector, chuck principle, black housing, solder contacts |
| OSC8F-Ni | Female cable connector, chuck principle, nickel housing, solder contacts |
| OSC8M | Male cable connector, chuck principle, black housing, solder contacts |
| OSC8M-Ni | Male cable connector, chuck principle, nickel housing, solder contacts |
| ORP8F | Female panel mount receptacle, black housing, solder contacts |
| ORP8F-Ni | Female panel mount receptacle, nickel housing, solder contacts |
| ORP8M | Male panel mount receptacle, black housing, solder contacts |
| ORP8M-Ni | Male panel mount receptacle, nickel housing, solder contacts |

Ordering Information for modular neutriCON system

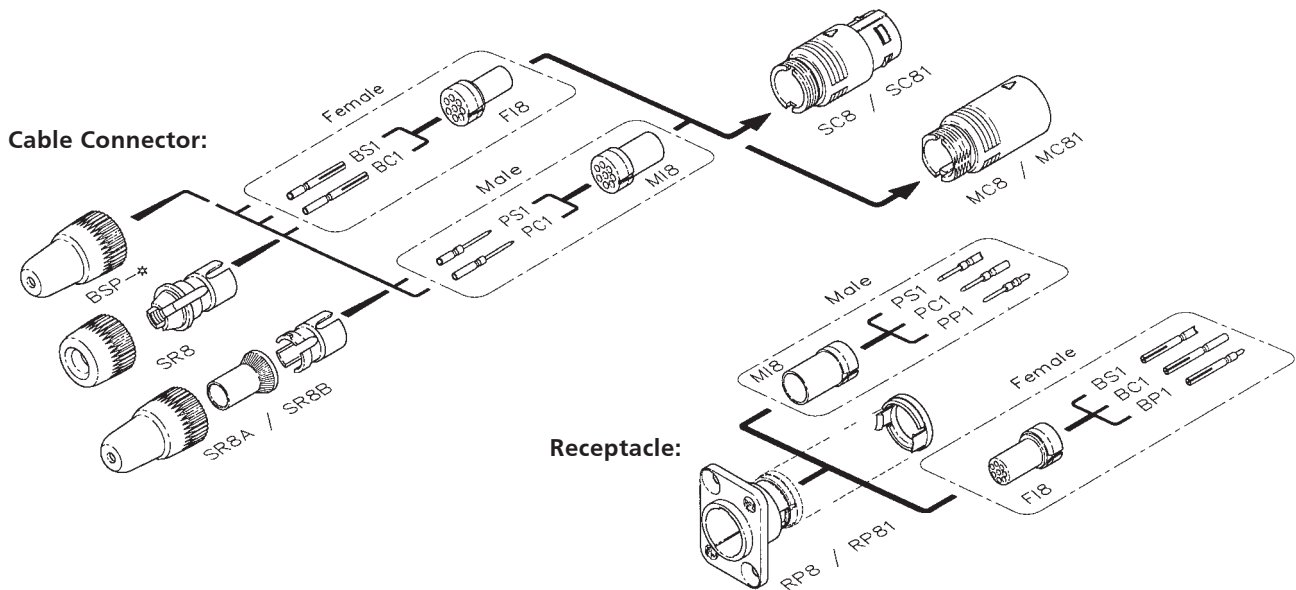

Modular system

| Female | | Male | |
|---------|--------------------------------------------------------------------------------------------------------|---------|--------------------------------------------------|
| FI8 | Insert for cable connector and receptacle | MI8 | Insert for cable connector and receptacle |
| BS1 | Solder contact | PS1 | Solder contact |
| BC1 | Crimp contact | PC1 | Crimp contact |
| BP1 | PCB contact | PP1 | PCB contact |
| SC8 | Cable housing, black coated, 180° coding | MC8 | Mating cable housing, black coated, 180° coding |
| SC8-Ni | Cable housing, nickel coated, 180° coding | MC8-Ni | Mating cable housing, nickel coated, 180° coding |
| SC81 | Cable housing, black coated, 90° coding | MC81 | Mating cable housing, black coated, 90° coding |
| SC81-Ni | Cable housing, nickel coated, 90° coding | MC81-Ni | Mating cable housing, nickel coated, 90° coding |
| SC8W | Cable housing, black coated, 180° coding, waterproof multipin connector according IP54 | | |
| RP8 | Receptacle, black coated, 180° coding | | |
| RP8-Ni | Receptacle, nickel coated, 180° coding | | |
| RP81 | Receptacle, black coated, 90° coding | | |
| RP81-Ni | Receptacle, nickel coated, 90° coding | | |
| SR8 | Bushing and chuck type strain relief (standard) | | |
| SR8A | Crimp type strain relief for cable O.D. 3 - 3.8 mm (Hex crimp 5.41 mm acc. IEC 803, see also page 122) | | |
| SR8B | Crimp type strain relief for cable O.D. 6 - 7 mm (Hex crimp 7.01 mm acc. IEC 803, see also page 122) | | |
| SR8W | Bushing and chuck type strain relief for waterproof solution IP54 | | |
| BSP-* | Coloured boot, available in 10 resistor colours | | |

* color coding: 0 - Black, 1 - Brown, 2 - Red, 3 - Orange, 4 - Yellow, 5 - Green, 6 - Blue, 7 - Violet, 8 - Grey, 9 - White

| Specification | powerCON Series | 32 A powerCON Series | nanoCON Series | miniCON Series | neutriCON Series |
|---------------|-----------------|----------------------|----------------|----------------|------------------|
|---------------|-----------------|----------------------|----------------|----------------|------------------|

Electrical

| | | | | | |
|-----------------------------------------------------------|-----------|-----------|-----------|--------------------------|-----------------------------|
| Number of contacts: | 2 + PE | 2 + PE | 3 | 12 (1-12 modular system) | 8 (1-8 modular system) |
| Rated current per contact: | 20 A rms | 32 A rms | 2 A | 3 A | 7.5 A (solder), 5 A (crimp) |
| Rated voltage: | 250 V ac | 250 V ac | 50 V ac | 50 V ac | 50 V ac |
| Dielectric strength: | 4000 V dc | 4000 V dc | 1000 V dc | 1000 V dc | 1500 Vdc |
| Contact resistance: | ≤ 3 mΩ | ≤ 3 mΩ | ≤ 12 mΩ | ≤ 8 mΩ | ≤ 5 mΩ |
| Insulation resistance after damp heat test (IEC 68-2-30): | > 100 MΩ | > 100 MΩ | > 1 GΩ | > 500 MΩ | > 500 MΩ |

Mechanical

| | | | | | |
|------------------------------------------|--------------------------------------------------------------------------|--------------------------------------------------------|-----------------------------------------------------|---------------------------------------------------------------------------------------|---------------------------------------------------------|
| Retention method: | Quick lock | Quick lock | latch | Push-pull | Push-pull |
| Cable O.D. range: | 5 - 15 mm | 8 - 20 mm | 3.4 mm max. | 3 - 5 mm (grey chuck) 5 - 7 mm (white chuck) 2.5 - 6 mm (crimp version MSRC) | 3 - 7 mm 3 - 3.8 mm (SR8A) 6 - 7 mm (SR8B) |
| Wiring: | Cable: screw type terminals or soldering 2.5 mm ² / 14 AWG | screw type terminals 2.5-6mm ² /14-10AWG | 0.2 mm ² / 24 AWG for solid wire | 0.5 mm ² / 20 AWG for solder | 1.0 mm ² / 18 AWG for solder |
| | Chassis: flat tabs for FASTON® 4.8 x 0.5 mm or soldering | | 0.14 mm ² 26 AWG for stranded wire | 0.22 mm ² 24 AWG for crimp | 0.14 - 0.34 mm ² 22 - 26 AWG for crimp |
| Solderability complies with IEC 68-2-20: | • | • | • | • | • |

Material

| | | | | | |
|--------------------------|---------------------------|------------------------|-------------|--------------------------------------------------|-----------------------------------------|
| Housing cable connector: | PA 6 30% GR | PA 6 30% GR | CuSn4Pb4Zn4 | ZnAl4Cu1 / CuZn39Pb3 | ZnAl4Cu1 gal Ni or black chrome |
| Housing receptacle: | PA 6.6 30% GR | PA 6.6 25% GR | CuZn39Pb2 | ZnAl4Cu1 | ZnAl4Cu1, gal Ni or black chrome |
| Insert: | PA 6 30% GR | PA 6.6 25% GR | PETP | PA 6.6 | PBTP 15% GR |
| Contacts: | CuZn39Pb3 / CuNi1Si0.2 | CuZn39Pb3 / CuSn0.2 | CuZn35Pb2 | CuZn35Pb2 (solder) CuZn39Pb3 (crimp) CuSn6 | CuZn35Pb2 (solder) CuZn39Pb3 (crimp) |
| Contact surface: | 4 μm / 2 μm Ag plated | 4 μm Ag | 0.5 μm Au | 0.2 μm AuCo | 0.3 μm Au hard alloy over 2 μm Ni |
| Chuck POM: | • | • | • | • | • |

Environmental

| | | | | | |
|-----------------------------------|-------|--------------------------------|-----------|-----------|-------|
| Flammability UL 94 HB: | - | • plug housing | UL 94 V-0 | UL 94 V-0 | • |
| Flammability UL 94 V-0: | • | • socket housing + plug insert | - | - | - |
| Temperature range: -30°C to +80°C | • | • | • | • | • |
| Protection class (mated): | IP 20 | IP 2X unmated | IP 40 | IP 5X | IP 5X |
| Safety Requirements EN/IC61984: | • | • | - | - | - |

FASTON® is a trademark of AMP Inc.

Crimptool



Crimptool HX-CONTACT DMC crimping tool AFM8
acc. M22520/2-01



MPOS-* Modified DMC positioner (K155) Contact
positioner holds contact in position when
crimping.

Contact and connector assembly



Crimptool HX-R-BNC Neutrik® HEX crimping tool



DIE-R-BNC-* Neutrik® DIE's for various HEX sizes.

neutriCON - Ordering Information Assembly Tools

| | | Cable O.D. / Wire | Crimptool | Die/Positioner | HEX-Size/Standard |
|------|----------------------|-------------------|------------|----------------|---------------------|
| SR8A | Strain relief | 3 - 3.8 mm | HX-R-BNC | DIE-R-BNC-PJ | 5.41 mm / IEC 803 |
| SR8B | Strain relief | 6 - 7 mm | HX-R-BNC | DIE-R-BNC-PS | 7.01 mm / IEC 803 |
| BC1 | Female crimp contact | AWG 22 -26 | HX-CONTACT | MPOS-BC1 | No. 5 / M22520/2-01 |
| PC1 | Male crimp contact | AWG 22 -26 | HX-CONTACT | MPOS-PC1 | No. 5 / M22520/2-01 |

miniCON - Ordering Information Assembly Tools

| | | Cable O.D. / Wire | Crimptool | Die/Positioner | HEX-Size/Standard |
|------|-------------------------------------|-----------------------------|------------|----------------|---------------------|
| MSRC | Crimp ferrule only | 4.5 - 6 mm | HX-R-BNC | DIE-R-BNC-PDC* | 6.47 mm / IEC 803 |
| MSRC | Crimp ferrule & reduction ferrule 1 | 3.3 - 4.4 mm | HX-R-BNC | DIE-R-BNC-PDC* | 6.47 mm / IEC 803 |
| MSRC | Crimp ferrule & reduction ferrule 2 | 2.5 - 3.2 mm | HX-R-BNC | DIE-R-BNC-PDC* | 6.47 mm / IEC 803 |
| MBC | Female crimp contact | 24 AWG/0.22 mm ² | HX-CONTACT | MPOS-MBC | No. 5 / M22520/2-01 |
| MPC | Male crimp contact | 24 AWG/0.22 mm ² | HX-CONTACT | MPOS-MPC | No. 5 / M22520/2-01 |

* DIE-R-BNC-PJ or PS also possible

Данный компонент на территории Российской Федерации

Вы можете приобрести в компании MosChip.

Для оперативного оформления запроса Вам необходимо перейти по данной ссылке:

<http://moschip.ru/get-element>

Вы можете разместить у нас заказ для любого Вашего проекта, будь то серийное производство или разработка единичного прибора.

В нашем ассортименте представлены ведущие мировые производители активных и пассивных электронных компонентов.

Нашей специализацией является поставка электронной компонентной базы двойного назначения, продукции таких производителей как XILINX, Intel (ex.ALTERA), Vicor, Microchip, Texas Instruments, Analog Devices, Mini-Circuits, Amphenol, Glenair.

Сотрудничество с глобальными дистрибьюторами электронных компонентов, предоставляет возможность заказывать и получать с международных складов практически любой перечень компонентов в оптимальные для Вас сроки.

На всех этапах разработки и производства наши партнеры могут получить квалифицированную поддержку опытных инженеров.

Система менеджмента качества компании отвечает требованиям в соответствии с ГОСТ Р ИСО 9001, ГОСТ РВ 0015-002 и ЭС РД 009

Офис по работе с юридическими лицами:

105318, г.Москва, ул.Щербаковская д.3, офис 1107, 1118, ДЦ «Щербаковский»

Телефон: +7 495 668-12-70 (многоканальный)

Факс: +7 495 668-12-70 (доб.304)

E-mail: info@moschip.ru

Skype отдела продаж:

moschip.ru

moschip.ru_4

moschip.ru_6

moschip.ru_9