

1M1-Series
Miniature Rocker &
Paddle Switch



1MS-Series
Sealed Miniature
Rocker & Paddle
Switch

Specifications

Contact Rating	refer to ordering scheme.
Electrical Life	1M1-Series: 50,000 make & break cycles @ full load 1MS-Series: 30,000 make & break cycles @ full load
Contact Resistance.	10 mΩ max. initial @ 2-4 VDC 100mA for both silver & gold plated contacts.
Insulation Resistance	1000 MΩ min.
Dielectric Strength	1500 Volts RMS @ sea level
Operating Temperature . . .	-30°C to +85°C
Index of Protection	1MS-Series: IP67
Solder Heat Resistance. . .	MIL-STD-202, Method 210
Actuator Travel	25°

Materials

Case	1M1-Series: Dially phthalate (DAP) (UL 94V-0) 1MS-Series: Glass filled nylon 6/6, flame retardant, heat stabilized (UL 94V-0)
Rocker/Paddle.	1M1-Series: Nylon (UL 94V-0) 1MS-Series: Nylon, black standard, internal o-ring sealed
Bushing	1M1-Series: Brass, nickel plated 1MS-Series: Glass filled nylon 6/6, flame retardant, heat stabilized (UL 94V-0)
Housing.	1M1-Series: Stainless Steel 1MS-Series: Spring Steel
Actuator Pivot & Mounting Bracket	1M1-Series: Stainless Steel 1MS-Series: Nylon (UL 94V-0)
Actuator Pivot Retainer . . .	1MS-Series: Stainless Steel
Switch Support	Brass, tin plated
Terminal Seal	Epoxy

1M1-Series Ordering Scheme



1 SERIES			
1M1 Miniature Rocker Switch			
2 POLES			
SP single pole - uses terminals 1, 2 & 3.			
DP double pole uses terminals 1,2, 3, 4, 5 & 6.			
3P double pole uses terminals 1,2, 3, 4, 5, 6, 7, 8 & 9.			
4P double pole uses terminals 1,2, 3, 4, 5, 6, 7, 8, 9, 10, 11, 12.			
3 CIRCUIT			
() - momentary			
Switching Position:			
2-3, 5-6, 8-9, 11-12 OPEN 2-1, 5-4, 8-7, 11-10			
1	ON	NONE	ON
2	ON	NONE	(ON)
3	ON	OFF	ON
4	(ON)	OFF	(ON)
5	ON	OFF	(ON)
4 ACTUATOR STYLE			
R1	Small rocker	R5	Large rocker
R2	Small paddle	R6	Rocker & frame
R3	Medium rocker	R7	Paddle & frame
R4	Large paddle	R8	Rocker w/out frame
		R9	Paddle w/out frame
5 ACTUATOR COLOR & 6 FRAME COLOR^{1,2}			
1	white	4	orange
2	black	5	yellow
3	red	6	green
		7	blue
		8	brown
		9	gray
1 Black is standard. Other colors available, consult factory for details.			
2 Selection 6 is blank if actuator style R8 or R9 (no frame)			

7 TERMINATION				
M1	Solder Lug		VS4	PC Mount, U bracket, .460 high
M2	PCB		VS5	PC Mount, U bracket, .630 high
M3	Quick Connect		M61	Snap-In, U bracket, 90° horizontal
M5-1	Wire Wrap .750 [19.05]		M71	Snap-In, U bracket, 90° vertical
M5-2	Wire Wrap .964 [24.48]		VS21	Snap-In, U bracket, .620 mounting x .460 high
M5-3	Wire Wrap .425 [10.80]		VS31	Snap-In, U bracket, .620 mounting x .630 high
M5-4	Wire Wrap 1.062 [26.97]		VS41	Snap-In, U bracket .620 mounting x .630 high
M6	PC Mount, 90° horizontal		VS51	Snap-In, U bracket
M7	PC Mount, 90° vertical			
VS2	PC Mount, U bracket, .620 mounting x .460 high			
VS3	PC Mount, U bracket, .620 mounting x .630 high			
8 CONTACT				
G	Material: silver ¹	Terminal Plating: gold over silver ²	Rating: 5A@125VAC or 28VDC, 2A @ 250VAC	Approvals: UL CSA
K	Material: gold ²	Terminal Plating: tin-lead ⁴	Rating: 0.4VA max. @20V max (AC/DC)	Approvals: -
P	Material: silver ¹	Terminal Plating: tin-lead ⁴	Rating: 5A@125VAC or 28VDC, 2A @ 250VAC	Approvals: UL CSA
Q	Material: silver ¹	Terminal Plating: silver ¹	Rating: 5A@125VAC or 28VDC, 2A @ 250VAC	Approvals: UL CSA
R	Material: gold ²	Terminal Plating: gold ²	Rating: 0.4VA max. @20V max (AC/DC)	Approvals: -
NOTE:				
Tin-lead option available with PC type terminations only.				
1 Moveable contact & terminals: copper alloy, silver plate				
2 Moveable contact & terminals: copper alloy with gold plate over nickel plate				
3 Terminals: silver plate with outer layer in gold plating				
4 Outer terminals: copper alloy with tin-lead over nickel plate				
9 EPOXY SEAL				
E epoxy seal				

1MS-Series Ordering Scheme



1 SERIES			
1MS Sealed Miniature Rocker Switch			
2 POLES			
SP single pole - uses terminals 1, 2 & 3.			
DP double pole uses terminals 1,2, 3, 4, 5 & 6.			
3P double pole uses terminals 1,2, 3, 4, 5, 6, 7, 8 & 9.			
3 CIRCUIT			
() - momentary			
Switching Position:			
2-3, 5-6, 8-9 OPEN 2-1, 5-4, 8-7			
1	ON	NONE	ON
2	ON	NONE	(ON)
3	ON	OFF	ON
4	(ON)	OFF	(ON)
5	ON	OFF	(ON)
4 ACTUATOR STYLE			
R1	Small rocker	R5	Large rocker
R2	Small paddle	R6	Rocker & frame
R3	Medium rocker	R7	Paddle & frame
R4	Large paddle	R8	Rocker w/out frame
		R9	Paddle w/out frame

5 TERMINATION				
M1	Solder Lug		VS3	PC Mount, U bracket, .620 mounting x .630 high
M2	PCB		VS4	PC Mount, U bracket, .460 high
M3	Quick Connect		VS5	PC Mount, U bracket, .630 high
M5-1	Wire Wrap .750 [19.05]		VS21	Snap-In, U bracket, .620 mounting x .460 high
M5-2	Wire Wrap .964 [24.48]		VS31	Snap-In, U bracket, .620 mounting x .630 high
M5-3	Wire Wrap .425 [10.80]		VS41	Snap-In, U bracket .620 mounting x .630 high
M5-4	Wire Wrap 1.062 [26.97]		VS51	Snap-In, U bracket
M6	PC Mount, 90° horizontal			
M7	PC Mount, 90° vertical			
VS2	PC Mount, U bracket, .620 mounting x .460 high			
6 CONTACT				
G	Material: silver ¹	Terminal Plating: gold over silver ²	Rating: 5A@125VAC or 28VDC, 2A @ 250VAC	Approvals: UL CUL
K	Material: gold ²	Terminal Plating: tin-lead ⁴	Rating: 0.4VA max. @20V max (AC/DC)	Approvals: -
P	Material: silver ¹	Terminal Plating: tin-lead ⁴	Rating: 5A@125VAC or 28VDC, 2A @ 250VAC	Approvals: UL CUL
R	Material: gold ²	Terminal Plating: gold ²	Rating: 0.4VA max. @20V max (AC/DC)	Approvals: -
NOTE:				
Tin-lead option available with PC type terminations only.				
1 Moveable contact & terminals: copper alloy, silver plate				
2 Moveable contact & terminals: copper alloy with gold plate over nickel plate				
3 Terminals: silver plate with outer layer in gold plating				
4 Outer terminals: copper alloy with tin-lead over nickel plate				
7 EPOXY SEAL				
E epoxy seal				

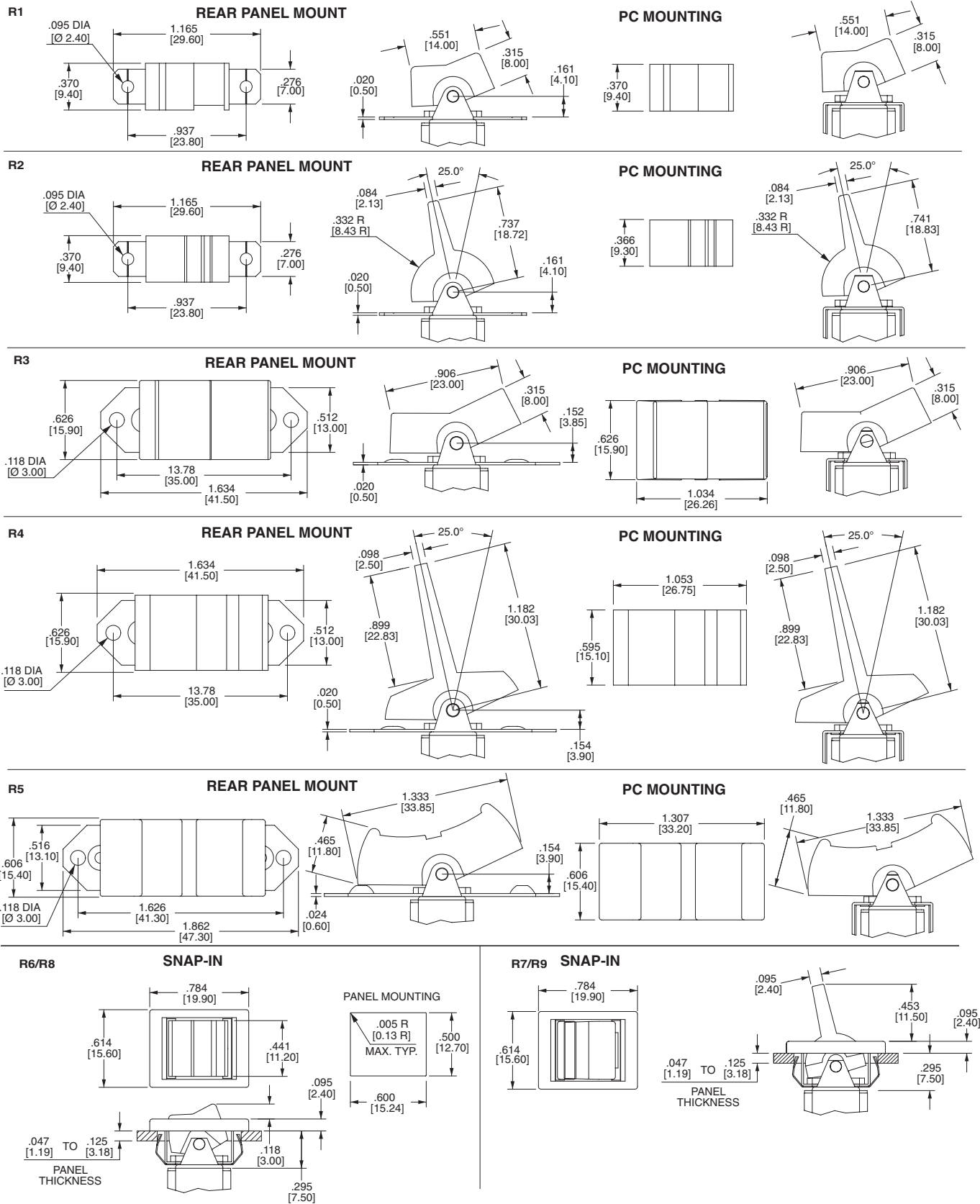
1M1-Series Dimensional Specifications: in.[mm]
ACTUATOR

R8 and R9 are without frame. Actuators are as shown.

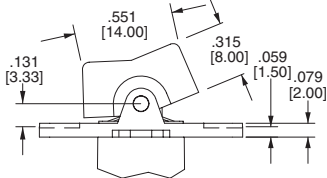
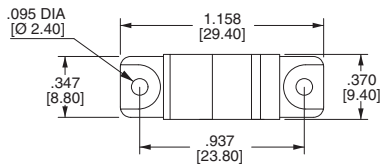
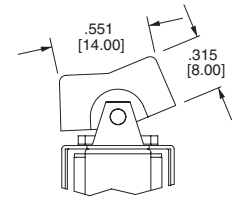
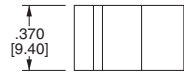
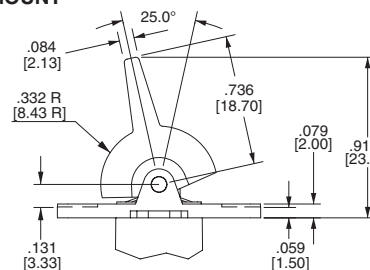
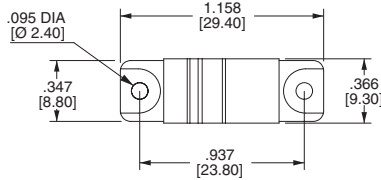
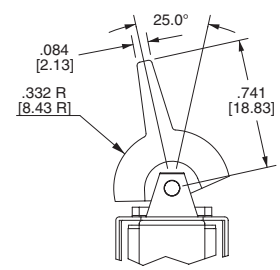
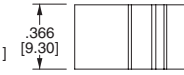
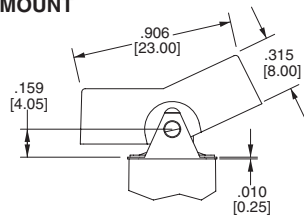
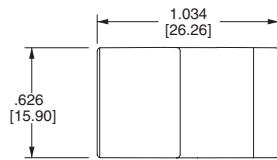
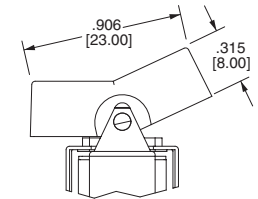
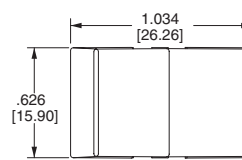
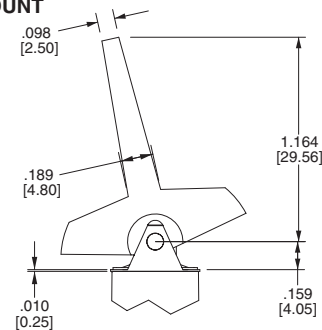
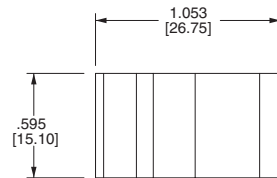
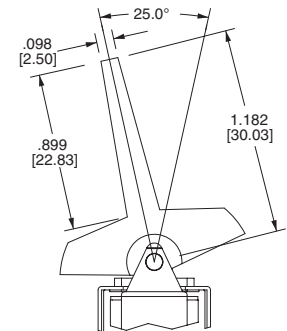
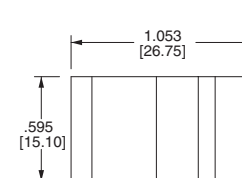
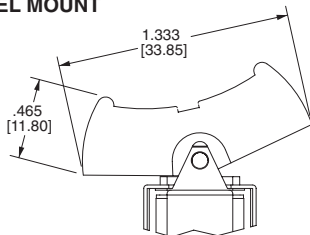
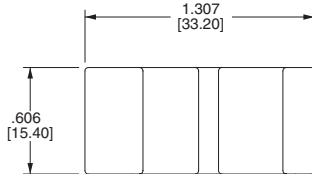
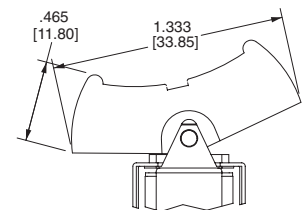
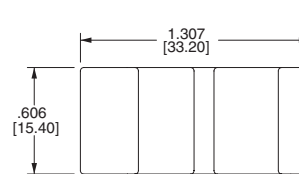
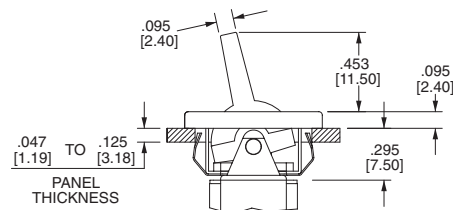
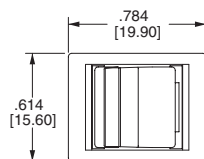
1MS-Series Dimensional Specifications: in.[mm]
ACTUATOR
R1 REAR PANEL MOUNT

PC MOUNTING

R2 REAR PANEL MOUNT

PC MOUNTING

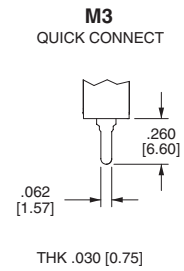
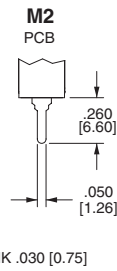
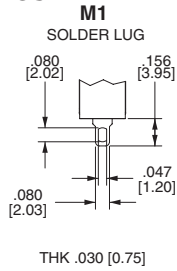
R3 REAR PANEL MOUNT

PC MOUNTING

R4 REAR PANEL MOUNT

PC MOUNTING

R5 REAR PANEL MOUNT

PC MOUNTING

R7 SNAP-IN

1M-Series Dimensional Specifications: in.[mm]

TERMINATION

1M1-Series



1MS-Series

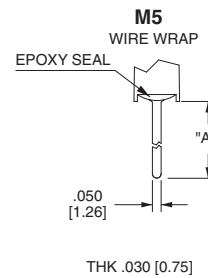
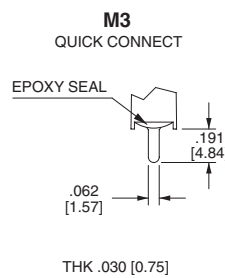
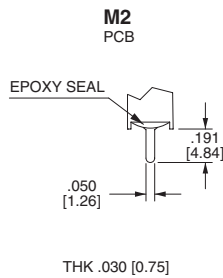
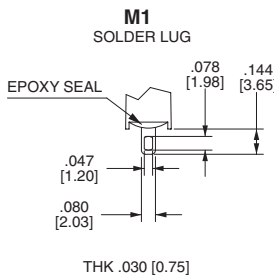

OPTION CODE	DIM. "A"
M5-1	.750 [19.05]
M5-2	.964 [24.48]
M5-3	.425 [10.80]
M5-4	1.062 [26.97]

1M-Series

M6

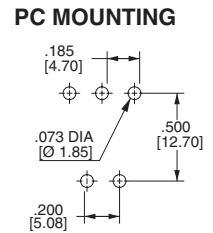
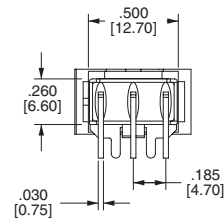
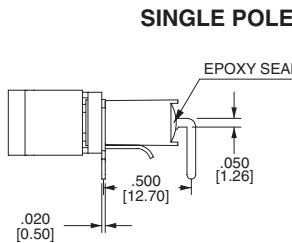
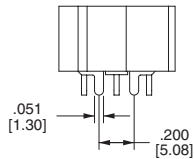

DOUBLE POLE

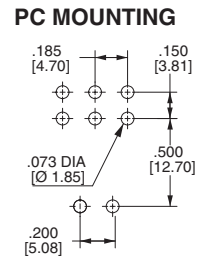
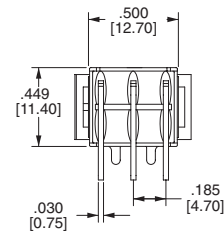
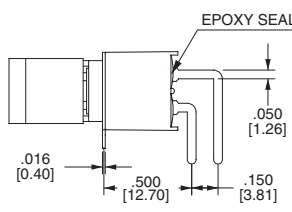
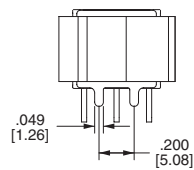

THREE POLE

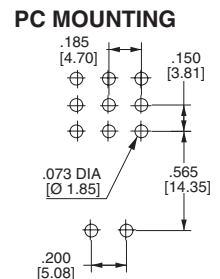
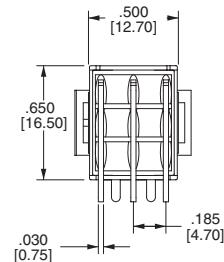
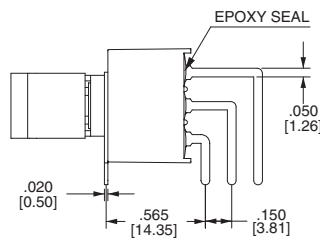
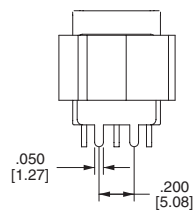

1M-Series Dimensional Specifications: in.[mm]

TERMINATION

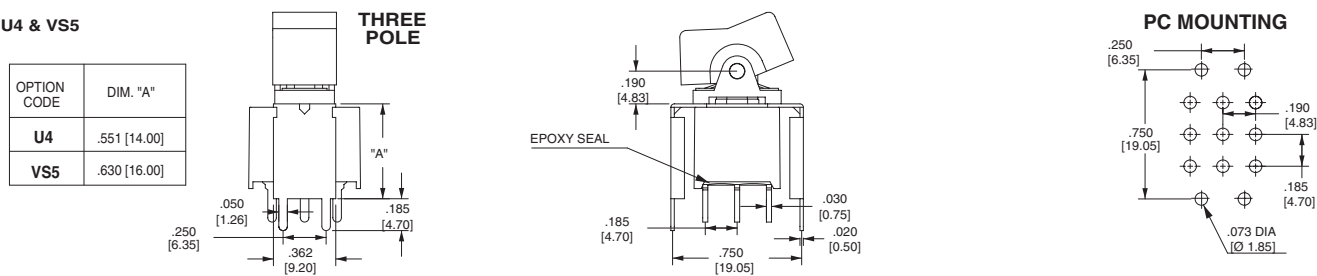
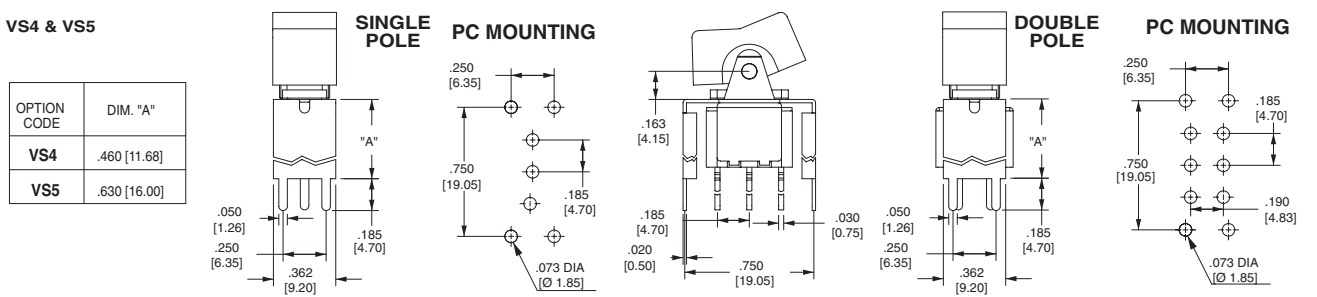
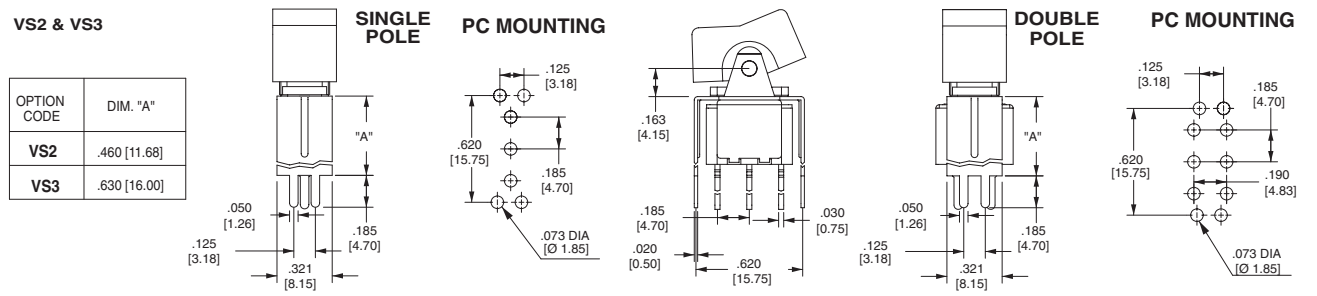
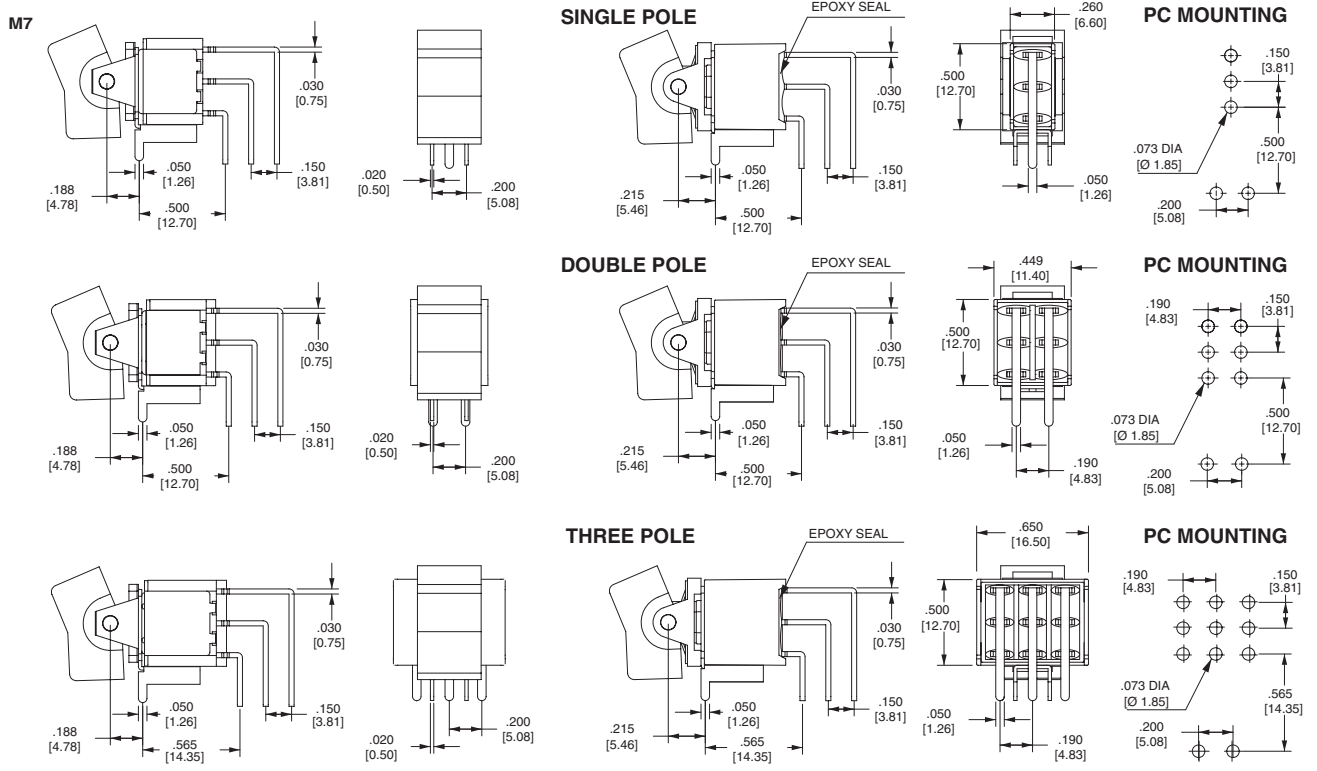

Данный компонент на территории Российской Федерации

Вы можете приобрести в компании MosChip.

Для оперативного оформления запроса Вам необходимо перейти по данной ссылке:

<http://moschip.ru/get-element>

Вы можете разместить у нас заказ для любого Вашего проекта, будь то серийное производство или разработка единичного прибора.

В нашем ассортименте представлены ведущие мировые производители активных и пассивных электронных компонентов.

Нашей специализацией является поставка электронной компонентной базы двойного назначения, продукции таких производителей как XILINX, Intel (ex.ALTERA), Vicor, Microchip, Texas Instruments, Analog Devices, Mini-Circuits, Amphenol, Glenair.

Сотрудничество с глобальными дистрибьюторами электронных компонентов, предоставляет возможность заказывать и получать с международных складов практически любой перечень компонентов в оптимальные для Вас сроки.

На всех этапах разработки и производства наши партнеры могут получить квалифицированную поддержку опытных инженеров.

Система менеджмента качества компании отвечает требованиям в соответствии с ГОСТ Р ИСО 9001, ГОСТ РВ 0015-002 и ЭС РД 009

Офис по работе с юридическими лицами:

105318, г.Москва, ул.Щербаковская д.3, офис 1107, 1118, ДЦ «Щербаковский»

Телефон: +7 495 668-12-70 (многоканальный)

Факс: +7 495 668-12-70 (доб.304)

E-mail: info@moschip.ru

Skype отдела продаж:

moschip.ru

moschip.ru_4

moschip.ru_6

moschip.ru_9