

VUA Series

Features

- 6.3 ϕ ~ 18 ϕ , 125°C, 1,000 ~ 2,000 hours assured
- Chip type high temperature range, for +125°C use
- For automobile modules and other high temperature applications
- RoHS Compliance



Marking color: Black

Specifications

Items	Performance																				
Category Temperature Range	-40°C ~ +125°C																				
Capacitance Tolerance	±20% (at 120Hz, 20°C)																				
Leakage Current (at 20°C)	I = 0.03CV or 4 (μA) whichever is greater (after 1 minutes) Where, C = rated capacitance in μF V = rated DC working voltage in V																				
Tanδ (at 120Hz, 20°C)	<table border="1"> <tr> <td>Rated Voltage</td> <td>10</td> <td>16</td> <td>25</td> <td>35</td> <td>50</td> </tr> <tr> <td>Tanδ (max)</td> <td>0.32</td> <td>0.24</td> <td>0.21</td> <td>0.18</td> <td>0.15</td> </tr> </table> <p>When the capacitance exceeds 1,000μF, 0.02 shall be added every 1,000μF increase.</p>	Rated Voltage	10	16	25	35	50	Tanδ (max)	0.32	0.24	0.21	0.18	0.15								
Rated Voltage	10	16	25	35	50																
Tanδ (max)	0.32	0.24	0.21	0.18	0.15																
Low Temperature Characteristics (at 120Hz)	<p>Impedance ratio shall not exceed the values given in the table below.</p> <table border="1"> <tr> <td>Rated Voltage</td> <td>10</td> <td>16</td> <td>25</td> <td>35</td> <td>50</td> </tr> <tr> <td>Impedance</td> <td>Z(-25°C)/Z(+20°C)</td> <td>6</td> <td>5</td> <td>4</td> <td>3</td> <td>3</td> </tr> <tr> <td>Ratio</td> <td>Z(-40°C)/Z(+20°C)</td> <td>12</td> <td>8</td> <td>6</td> <td>4</td> <td>4</td> </tr> </table>	Rated Voltage	10	16	25	35	50	Impedance	Z(-25°C)/Z(+20°C)	6	5	4	3	3	Ratio	Z(-40°C)/Z(+20°C)	12	8	6	4	4
Rated Voltage	10	16	25	35	50																
Impedance	Z(-25°C)/Z(+20°C)	6	5	4	3	3															
Ratio	Z(-40°C)/Z(+20°C)	12	8	6	4	4															
Endurance	<table border="1"> <tr> <td>Test Time</td> <td>1,000 Hrs for $\phi D \leq 8 \times 6.5\text{mm}$ 2,000 Hrs for $\phi D \geq 8 \times 10\text{mm}$</td> </tr> <tr> <td>Capacitance Change</td> <td>Within ±30% of initial value</td> </tr> <tr> <td>Tanδ</td> <td>Less than 300% of specified value</td> </tr> <tr> <td>Leakage Current</td> <td>Within specified value</td> </tr> </table> <p>* The above Specifications shall be satisfied when the capacitors are restored to 20°C after the rated voltage applied for 1,000 / 2,000 hours at 125°C.</p>	Test Time	1,000 Hrs for $\phi D \leq 8 \times 6.5\text{mm}$ 2,000 Hrs for $\phi D \geq 8 \times 10\text{mm}$	Capacitance Change	Within ±30% of initial value	Tanδ	Less than 300% of specified value	Leakage Current	Within specified value												
Test Time	1,000 Hrs for $\phi D \leq 8 \times 6.5\text{mm}$ 2,000 Hrs for $\phi D \geq 8 \times 10\text{mm}$																				
Capacitance Change	Within ±30% of initial value																				
Tanδ	Less than 300% of specified value																				
Leakage Current	Within specified value																				
Shelf Life Test	<table border="1"> <tr> <td>Test Time</td> <td>1,000 Hrs</td> </tr> <tr> <td>Capacitance Change</td> <td>Within ±30% of initial value</td> </tr> <tr> <td>Tanδ</td> <td>Less than 300% of specified value</td> </tr> <tr> <td>Leakage Current</td> <td>Within specified value</td> </tr> </table> <p>* The above Specifications shall be satisfied when the capacitors are restored to 20°C after exposing them for 1,000 hours at 125°C without voltage applied.</p>	Test Time	1,000 Hrs	Capacitance Change	Within ±30% of initial value	Tanδ	Less than 300% of specified value	Leakage Current	Within specified value												
Test Time	1,000 Hrs																				
Capacitance Change	Within ±30% of initial value																				
Tanδ	Less than 300% of specified value																				
Leakage Current	Within specified value																				
Ripple Current & Frequency Multipliers	<table border="1"> <tr> <td></td> <td>Freq.(Hz)</td> <td>50</td> <td>120</td> <td>1k</td> <td>10k up</td> </tr> <tr> <td rowspan="2">Cap.(μF)</td> <td>Under 330</td> <td>0.80</td> <td>1.0</td> <td>1.25</td> <td>1.40</td> </tr> <tr> <td>330 < C ≤ 4,700</td> <td>0.85</td> <td>1.0</td> <td>1.20</td> <td>1.30</td> </tr> </table>		Freq.(Hz)	50	120	1k	10k up	Cap.(μF)	Under 330	0.80	1.0	1.25	1.40	330 < C ≤ 4,700	0.85	1.0	1.20	1.30			
	Freq.(Hz)	50	120	1k	10k up																
Cap.(μF)	Under 330	0.80	1.0	1.25	1.40																
	330 < C ≤ 4,700	0.85	1.0	1.20	1.30																

Diagram of Dimensions

Fig. 1

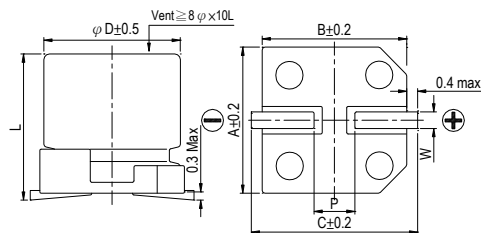
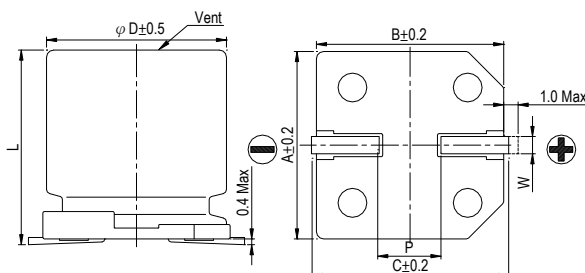

Fig. 2



Lead Spacing and Diameter

Unit: mm

ϕD	L	A	B	C	W	P ± 0.2	Fig. No.
6.3	5.7 ± 0.3	6.6	6.6	7.2	0.5 ~ 0.8	2.0	1
6.3	7.7 ± 0.3	6.6	6.6	7.2	0.5 ~ 0.8	2.0	1
8	6.5 ± 0.3	8.4	8.4	9.0	0.5 ~ 0.8	2.3	1
8	10 ± 0.5	8.4	8.4	9.0	0.7 ~ 1.1	3.1	1
10	10 ± 0.5	10.4	10.4	11.0	0.7 ~ 1.3	4.7	1
12.5	13.5 ± 0.5	13.0	13.0	13.7	1.1 ~ 1.4	4.4	2
12.5	16 ± 0.5	13.0	13.0	13.7	1.1 ~ 1.4	4.4	2
16	16.5 ± 0.5	17.0	17.0	18.0	1.1 ~ 1.4	6.4	2
18	16.5 ± 0.5	19.0	19.0	20.0	1.1 ~ 1.4	6.4	2

Marking

$\phi D = 6.3 \text{ mm}$

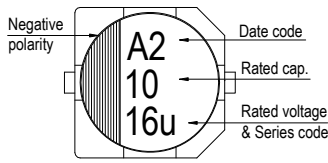

$\phi D = 8 \sim 10 \text{ mm}$

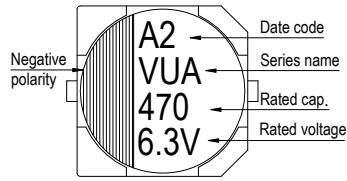

$\phi D \geq 12.5 \text{ mm}$

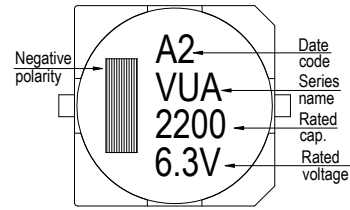

Dimension & Permissible Ripple Current

Dimension: $\phi D \times L(\text{mm})$

Ripple Current: mA/rms at 120 Hz, 125°C

μF	V. DC Contents	10V (1A)		16V (1C)		25V (1E)		35V (1V)		50V (1H)	
		$\phi D \times L$	mA	$\phi D \times L$	mA	$\phi D \times L$	mA	$\phi D \times L$	mA	$\phi D \times L$	mA
22	220							6.3×5.7	50	8×6.5	75
33	330			6.3×5.7	50	6.3×5.7	50	6.3×7.7	70	8×10	130
47	470			6.3×7.7	70	6.3×7.7	70	8×6.5	75	8×10	130
68	680	6.3×5.7	50	8×6.5	75	8×6.5	75	8×10	130	10×10	180
100	101	8×6.5	75	8×6.5	75	8×10	130	10×10	180	12.5×13.5	357
220	221	8×10	130	10×10	180	10×10	180	12.5×13.5	357	12.5×16	400
330	331	8×10	130	12.5×13.5	480	12.5×13.5	480	16×16.5	650	16×16.5	650
470	471	12.5×13.5	480	12.5×13.5	480	12.5×13.5	480	16×16.5	650	16×16.5	650
680	681	12.5×13.5	480	12.5×13.5	480	12.5×16	585	16×16.5	650	18×16.5	855
1,000	102	12.5×16	585	12.5×16	585	16×16.5	650	18×16.5	855		
1,500	152	12.5×16	585	16×16.5	650	18×16.5	855				
2,200	222	16×16.5	650	18×16.5	855						
3,300	332	18×16.5	855								
4,700	472	18×16.5	855								

Part Numbering System

VUA series	33 μF	$\pm 20\%$	16V	Carrier Tape	6.3 ϕ × 5.7L	Pb-free and PET coating case
VUA	330	M	1C	TR	-	0606
Series name	Capacitance	Capacitance Tolerance	Rated Voltage	Package Type	Terminal Type	Case size
						Lead Wire and Coating Type

Note: For more details, please refer to "Part Numbering System (SMD Type)" on page 12.

Данный компонент на территории Российской Федерации

Вы можете приобрести в компании MosChip.

Для оперативного оформления запроса Вам необходимо перейти по данной ссылке:

<http://moschip.ru/get-element>

Вы можете разместить у нас заказ для любого Вашего проекта, будь то серийное производство или разработка единичного прибора.

В нашем ассортименте представлены ведущие мировые производители активных и пассивных электронных компонентов.

Нашей специализацией является поставка электронной компонентной базы двойного назначения, продукции таких производителей как XILINX, Intel (ex.ALTERA), Vicor, Microchip, Texas Instruments, Analog Devices, Mini-Circuits, Amphenol, Glenair.

Сотрудничество с глобальными дистрибьюторами электронных компонентов, предоставляет возможность заказывать и получать с международных складов практически любой перечень компонентов в оптимальные для Вас сроки.

На всех этапах разработки и производства наши партнеры могут получить квалифицированную поддержку опытных инженеров.

Система менеджмента качества компании отвечает требованиям в соответствии с ГОСТ Р ИСО 9001, ГОСТ РВ 0015-002 и ЭС РД 009

Офис по работе с юридическими лицами:

105318, г.Москва, ул.Щербаковская д.3, офис 1107, 1118, ДЦ «Щербаковский»

Телефон: +7 495 668-12-70 (многоканальный)

Факс: +7 495 668-12-70 (доб.304)

E-mail: info@moschip.ru

Skype отдела продаж:

moschip.ru

moschip.ru_4

moschip.ru_6

moschip.ru_9