

DESIGN UNITS: METRIC (mm)
UNLESS OTHERWISE SPECIFIED
[INCHES]



Class J Fuseblocks(600V) Catalog Data

Catalog Number	Covers		Voltage	Current	Number of Poles	Label
	Class J	w/o Indication				
JM60100-1CR	CVR-J-60100	CVRI-J-60100	600	100	1	JM60100-1CR
JM60100-2CR					2	JM60100-2CR
JM60100-3CR					3	JM60100-3CR
JM60200-1CR	CVR-J-60200	CVRI-J-60200		200	1	JM60200-1CR
JM60200-2CR					2	JM60200-2CR
JM60200-3CR					3	JM60200-3CR
JM60400-1CR	CVR-J-60400	CVRI-J-60400		400	1	JM60400-1CR
JM60400-2CR					2	JM60400-2CR
JM60400-3CR					3	JM60400-3CR
JM60600-1CR	CVR-J-60600	CVRI-J-60600		600	1	JM60600-1CR
JM60600-2CR					2	JM60600-2CR
JM60600-3CR					3	JM60600-3CR

COOPER Bussmann
St. Louis MO 63178

TITLE:

Class J fuse holder-CUST

SCALE:
1:5

SIZE:
A3

SHEET:
1 OF 14

A
B
C
D
E
F

1 2 3 4 5 6 7 8

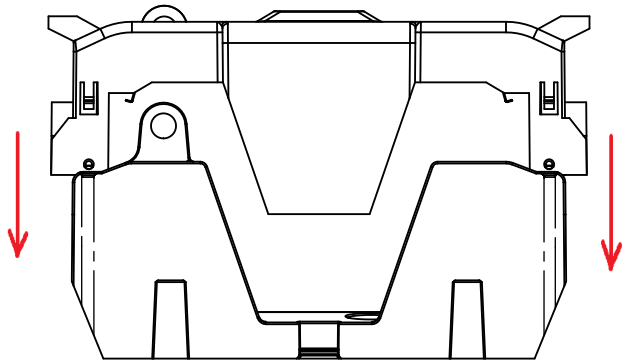

PUSH DOWN

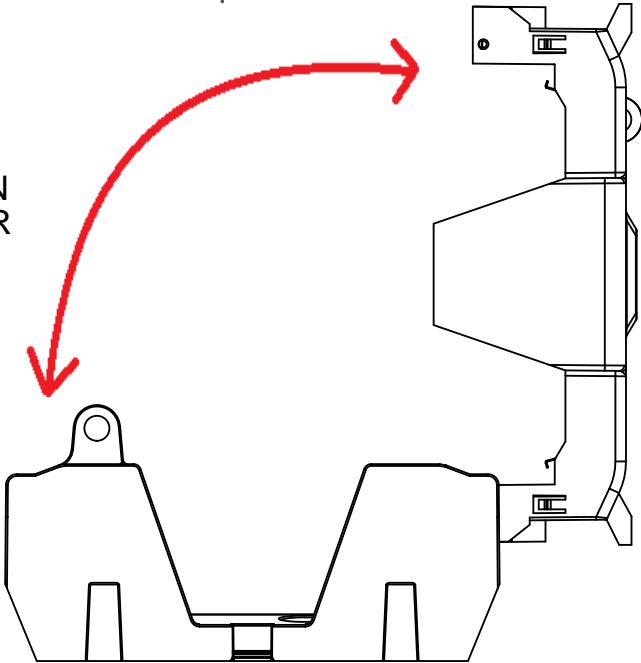

LIFT UP, THEN ROTATE OVER

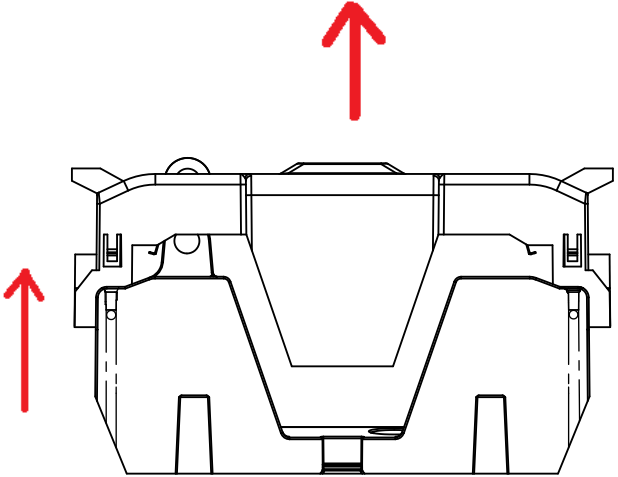
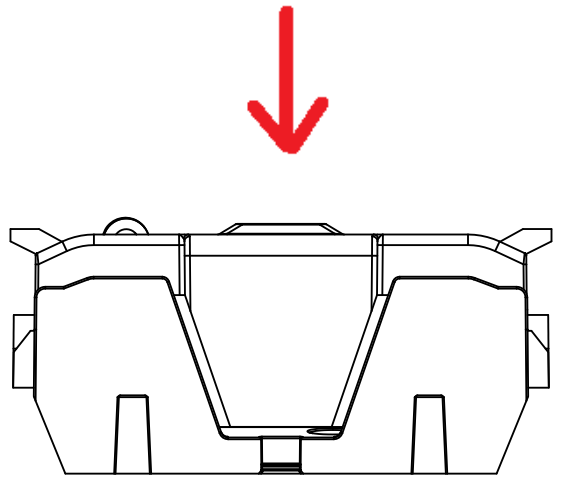

LIFT UP

COOPER Bussmann
St. Louis MO 63178

TITLE:
Class J fuse holder-CUST

SCALE: 1:2 SIZE: A3 SHEET: 2 OF 14

1 2 3 4 5 6 7 8

JM60100-1CR

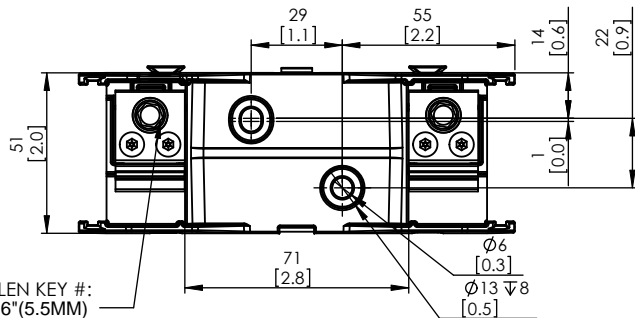

ALLEN KEY #: 3/16" (5.5MM)

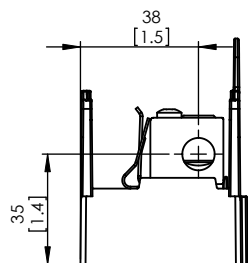
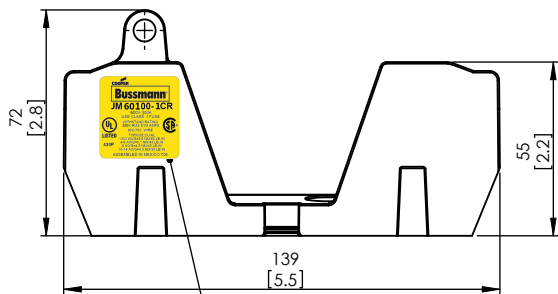

JM60100-1CR WITH CVR-J-60100 INSTALLED

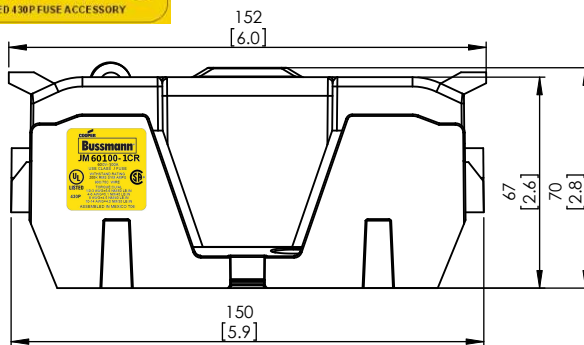
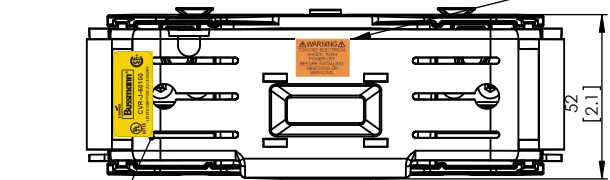

CVR-J-60100

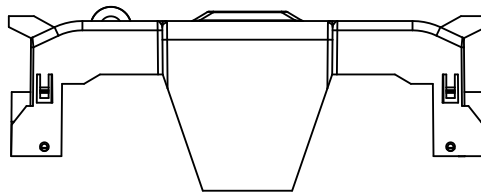

JM60100-1CR WITH CVRI-J-60100 INSTALLED

WARNING
TO AVOID ELECTRICAL SHOCK, TURN POWER OFF BEFORE INSTALLING, REMOVING OR SERVICING.

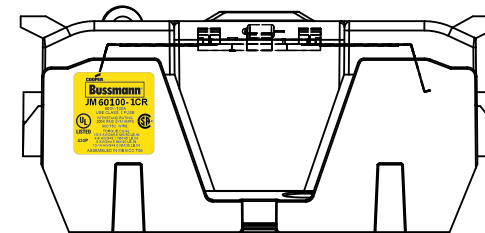
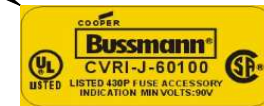
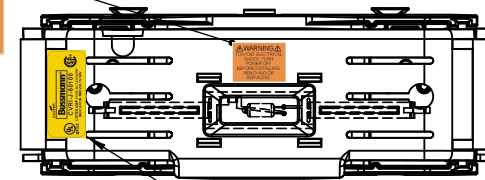

CVRI-J-60100

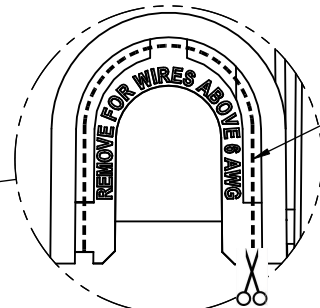
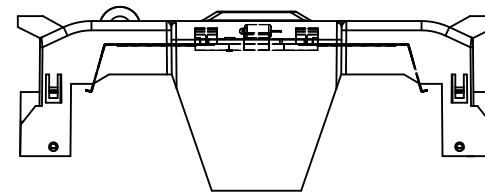

COOPER Bussmann
St. Louis MO 63178

Class J fuse holder-CUST

SCALE: 1:1 SIZE: A3 SHEET: 3 OF 14

JM60100-2CR

**JM60100-2CR
WITH CVR-J-60100 INSTALLED**

**JM60100-2CR
WITH CVRI-J-60100 INSTALLED**

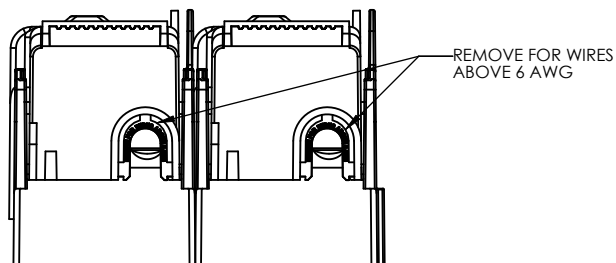
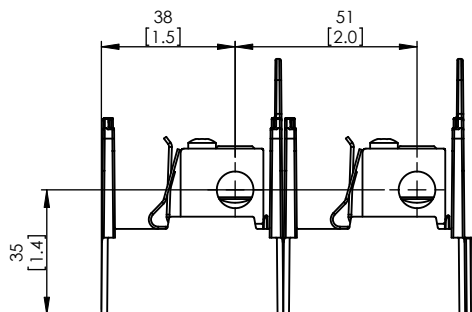
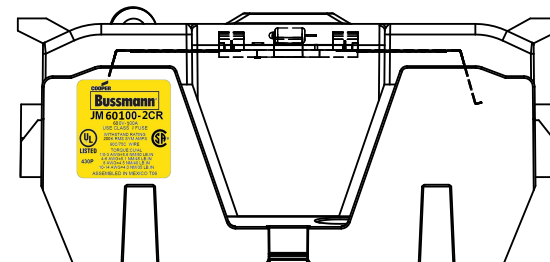
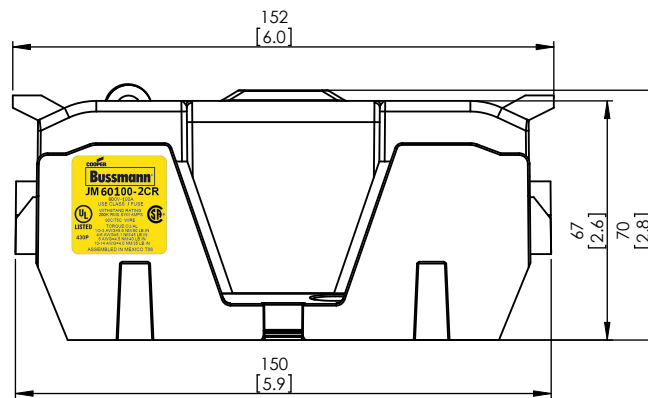
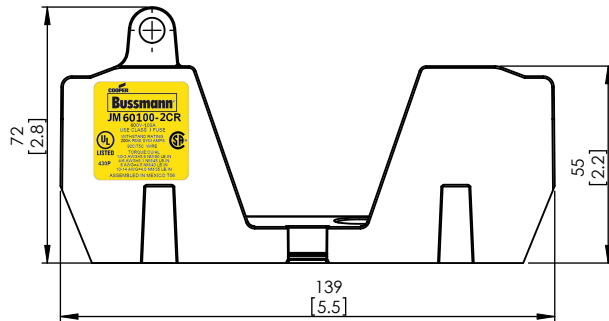
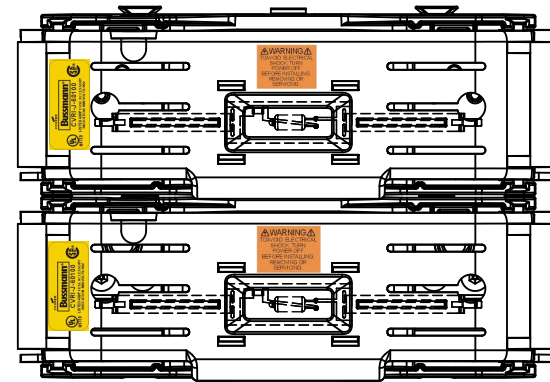
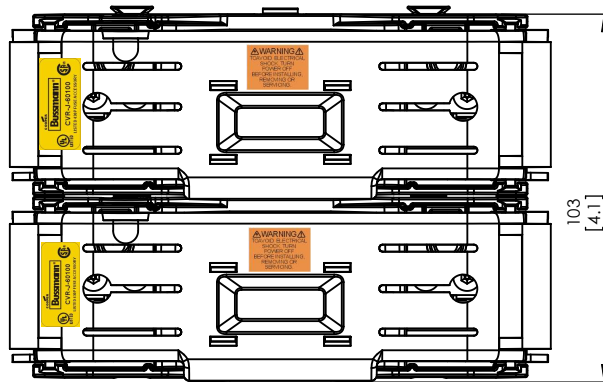
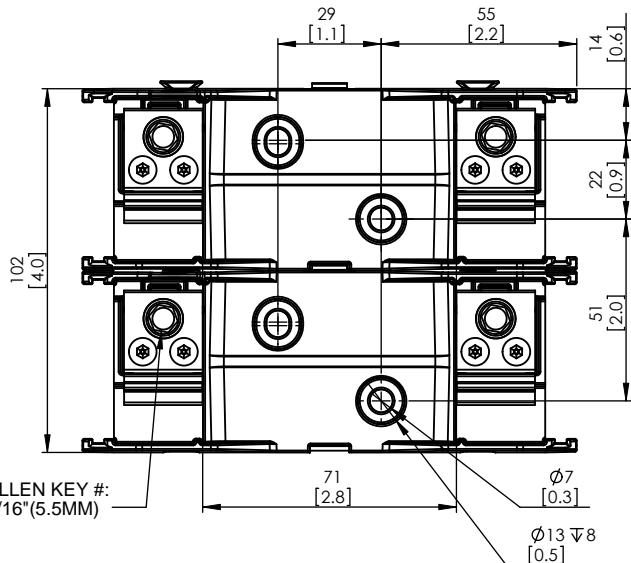

DESIGN UNITS: METRIC (mm)
UNLESS OTHERWISE SPECIFIED [INCHES]



JM60100-3CR

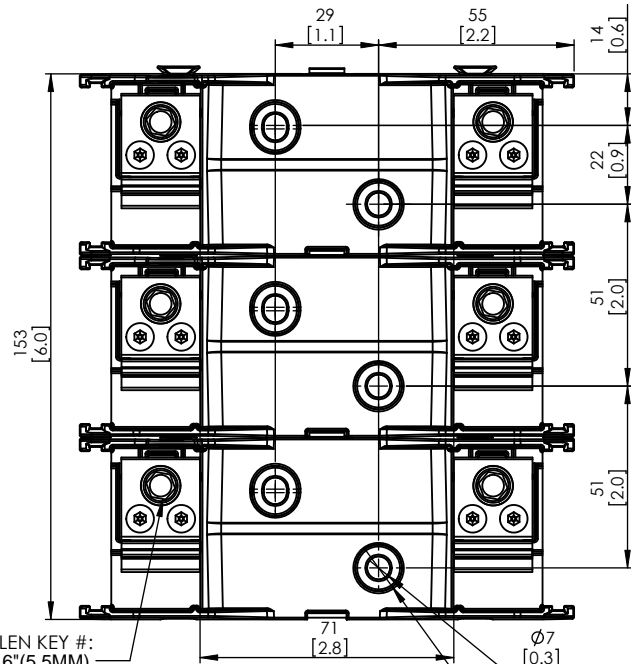

ALLEN KEY #:
3/16" (5.5MM)

Ø7 [0.3]
Ø13 ∇8 [0.5]

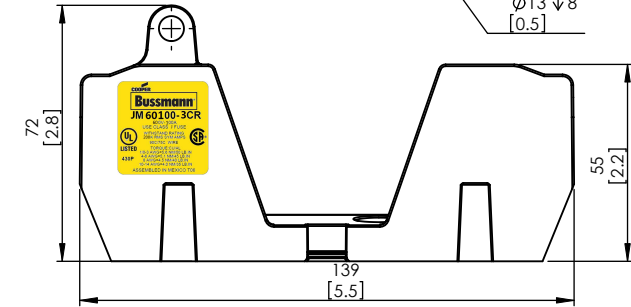

**JM60100-3CR
WITH CVR-J-60100 INSTALLED**

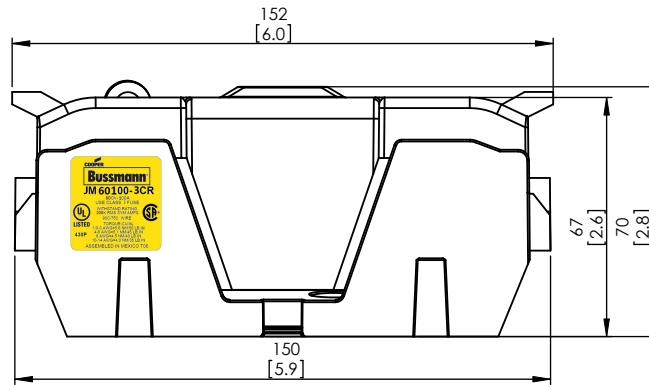
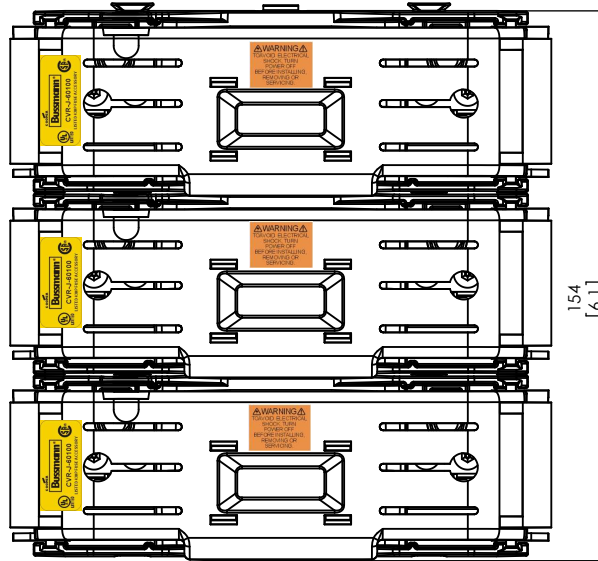

**JM60100-3CR
WITH CVRI-J-60100 INSTALLED**

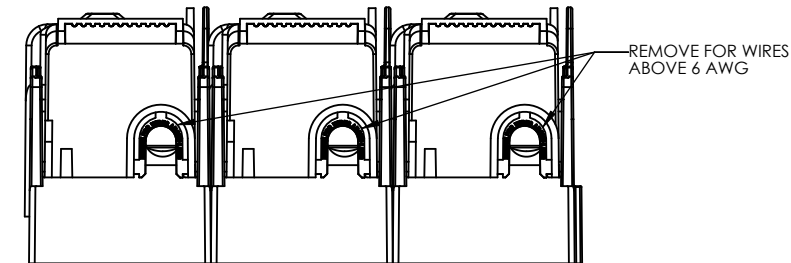
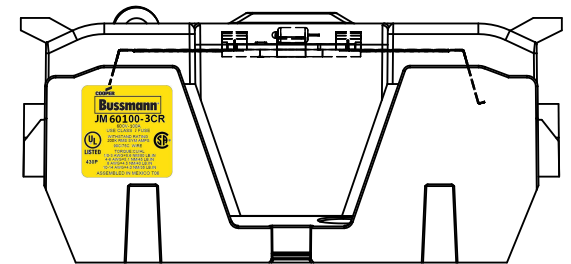
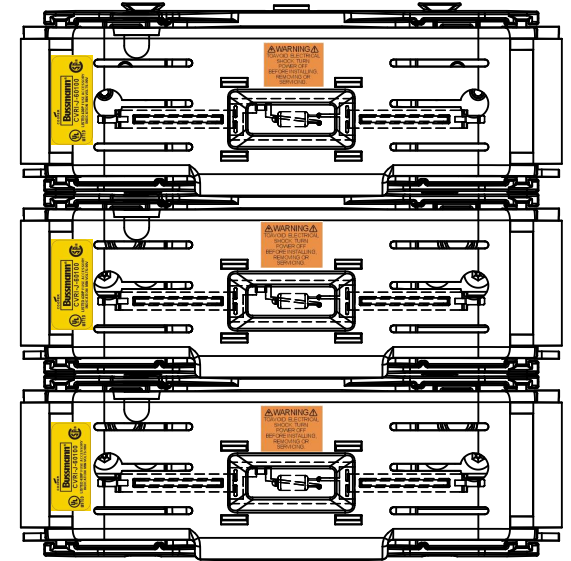

COOPER Bussmann
St. Louis MO 63178

Class J fuse holder-CUST

SCALE: 1:1 SIZE: A3 SHEET: 5 OF 14

JM60200-1CR

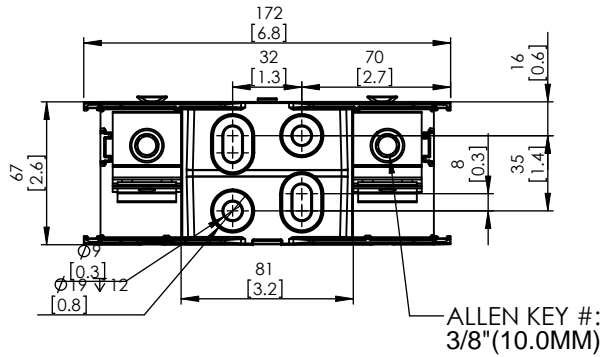

JM60200-1CR WITH CVR-J-60200 INSTALLED

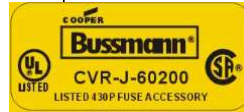
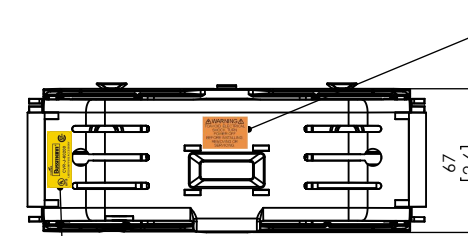

JM60200-1CR WITH CVRI-J-60200 INSTALLED

WARNING
TO AVOID ELECTRICAL SHOCK, TURN POWER OFF BEFORE INSTALLING, REMOVING OR SERVICING.

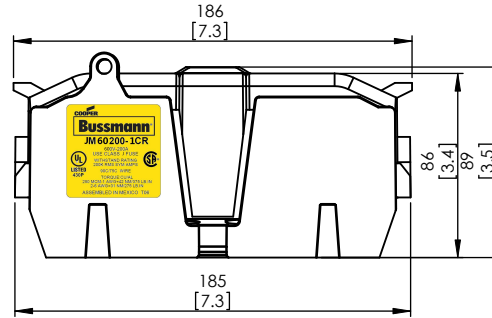
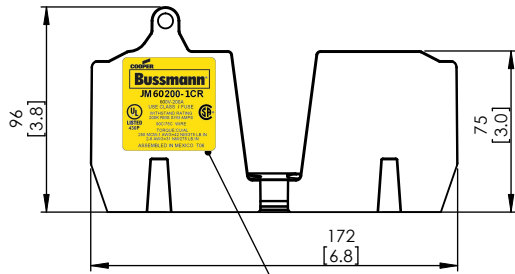
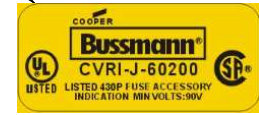
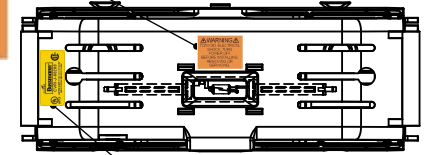

CVR-J-60200

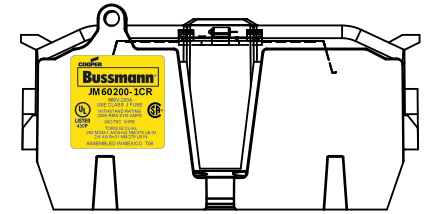
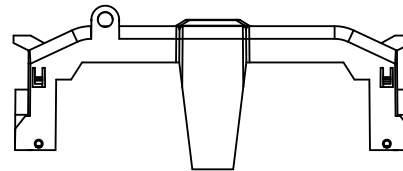

CVRI-J-60200

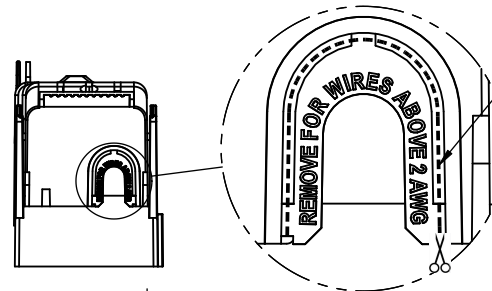
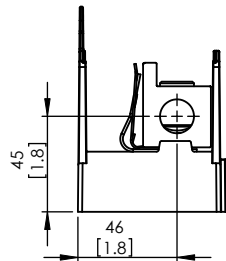
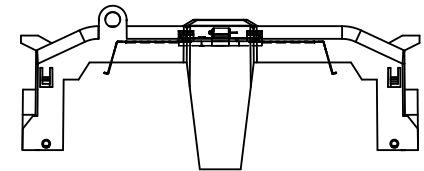

COOPER Bussmann St. Louis MO 63178

Class J fuse holder-CUST

SCALE: 1:2 SIZE: A3 SHEET: 6 OF 14

JM60200-2CR

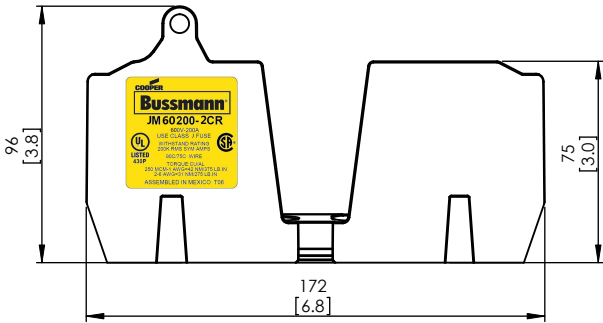
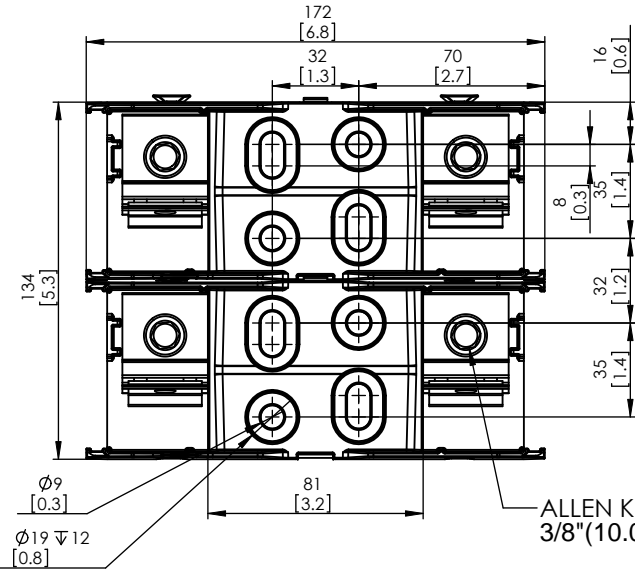

**JM60200-2CR
WITH CVR-J-60200 INSTALLED**

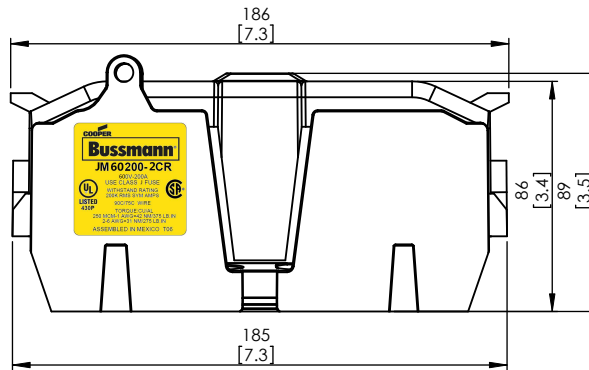
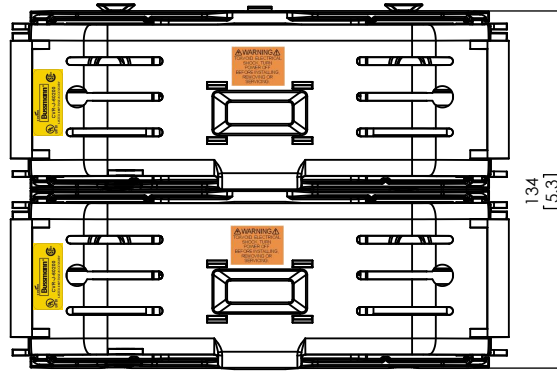

**JM60200-2CR
WITH CVRI-J-60200 INSTALLED**

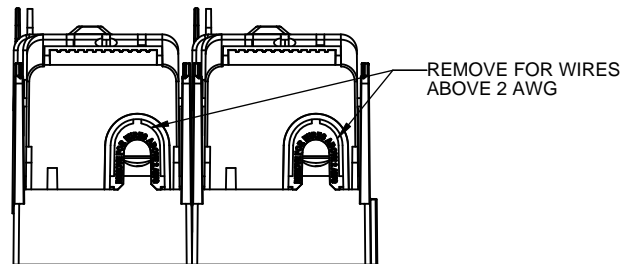
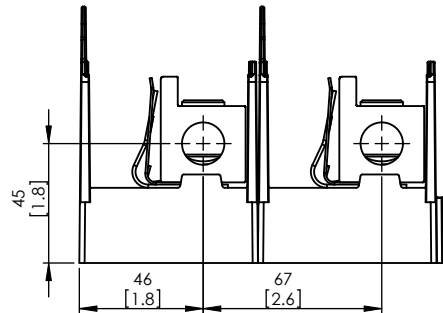
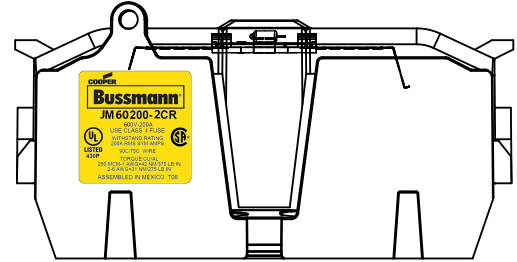
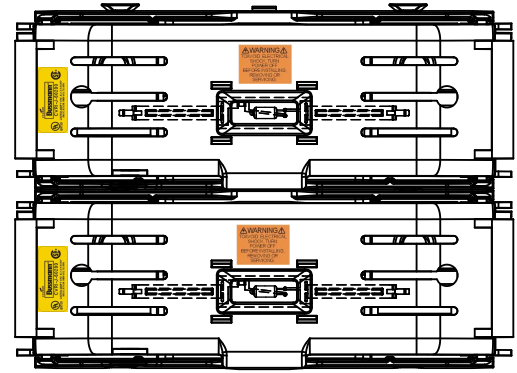

DESIGN UNITS: METRIC (mm)
UNLESS OTHERWISE SPECIFIED [INCHES]



JM60200-3CR

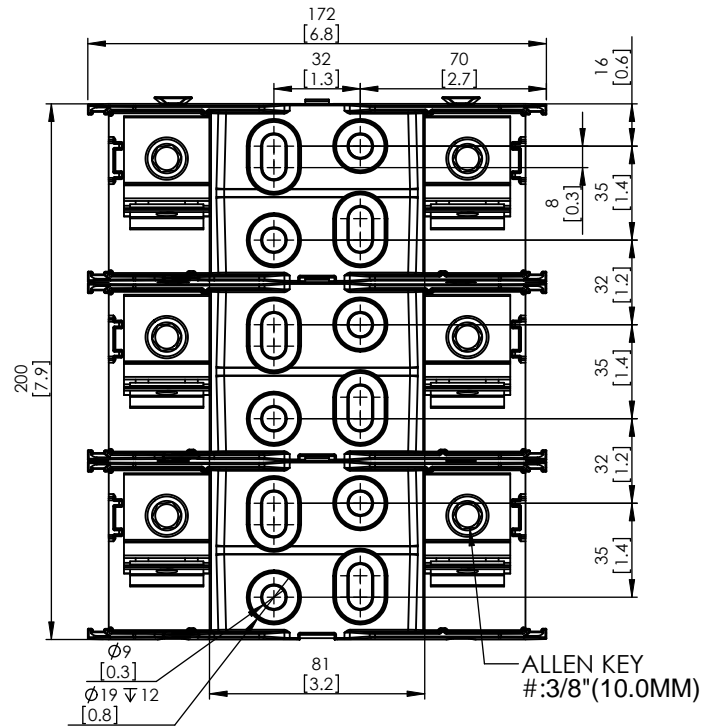

**JM60200-3CR
WITH CVR-J-60200 INSTALLED**

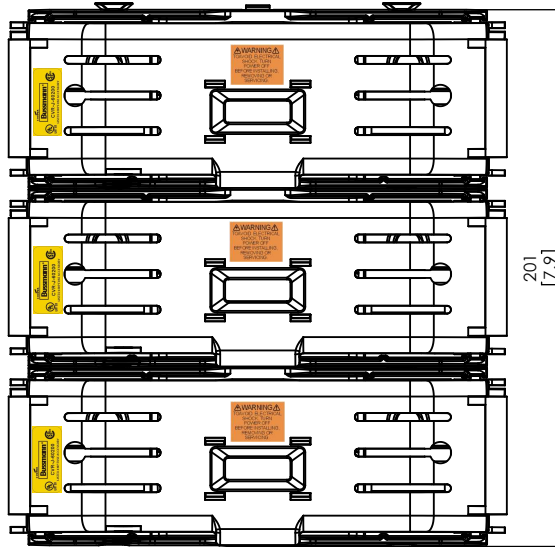

**JM60200-3CR
WITH CVRI-J-60200 INSTALLED**

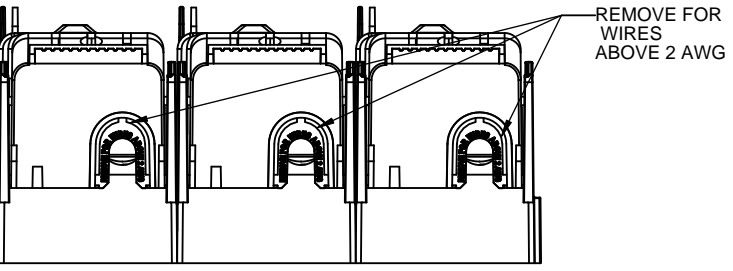
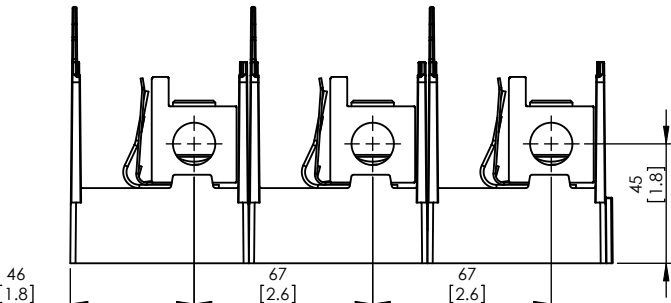
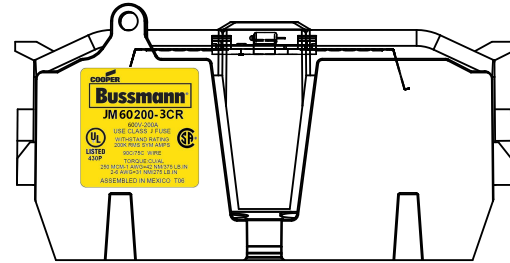
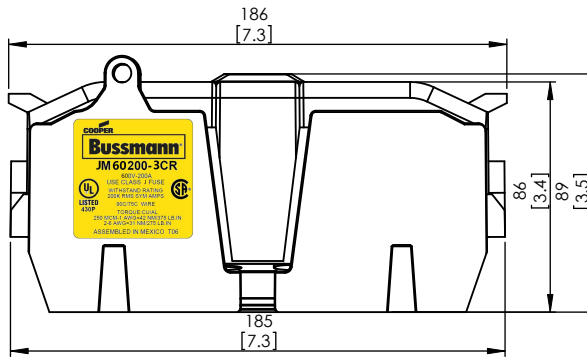
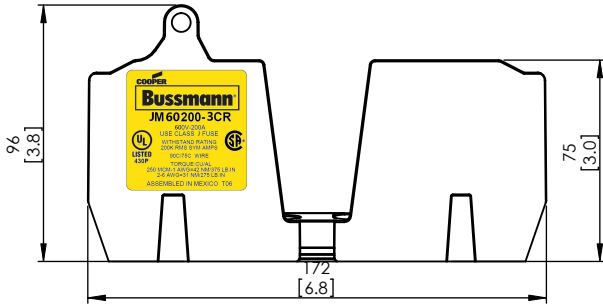
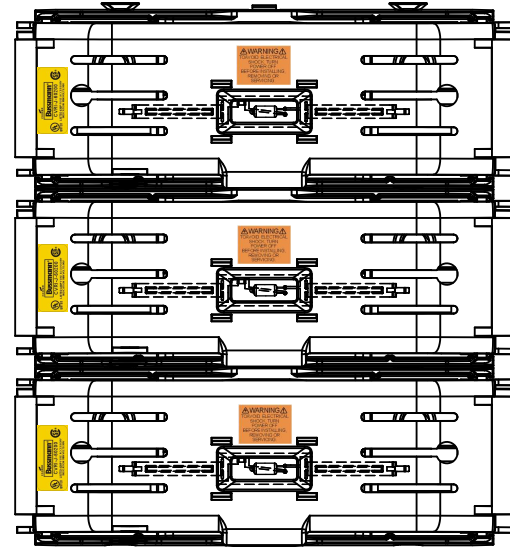

COOPER Bussmann
St. Louis MO 63178

TITLE:
Class J fuse holder-CUST

SCALE: 1:2 SIZE: A3 SHEET: 8 OF 14

JM60400-1CR

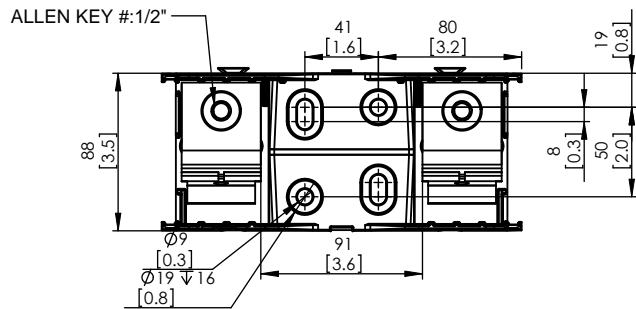

JM60400-1CR WITH CVR-J-60400 INSTALLED

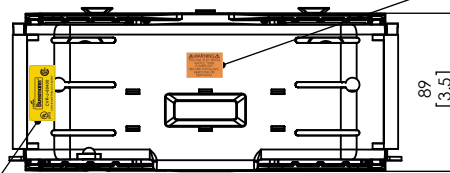

JM60400-1CR WITH CVRI-J-60400 INSTALLED

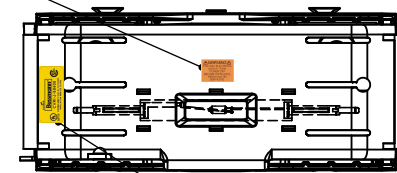

WARNING
TO AVOID ELECTRICAL SHOCK, TURN POWER OFF BEFORE INSTALLING, REMOVING OR SERVICING.

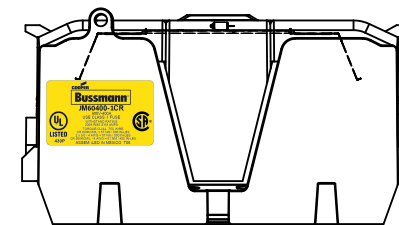
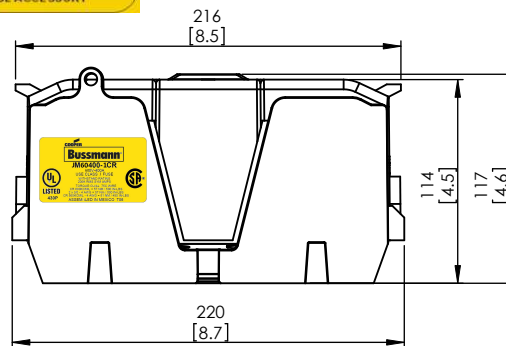
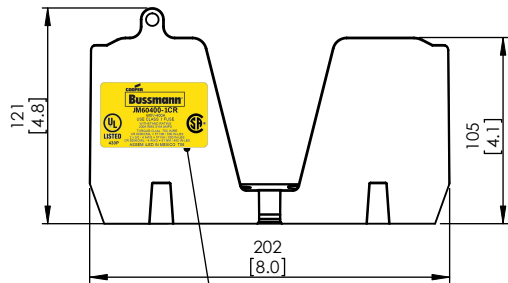
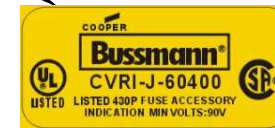
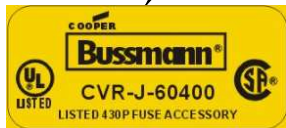

CVR-J-60400

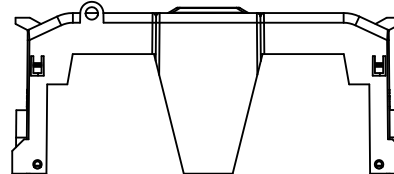

CVRI-J-60400

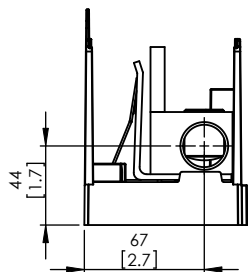
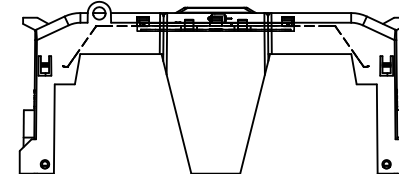

CUT OPEN ALONG THIS DOTTED LINE FOR WIRES ABOVE 250 KCMIL

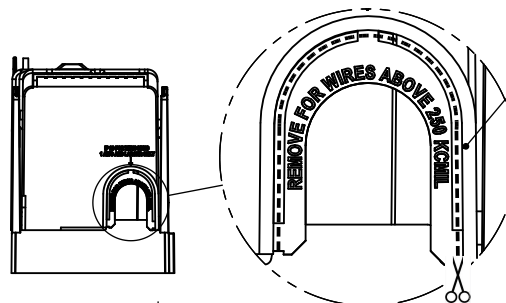

COOPER Bussmann St. Louis MO 63178

Class J fuse holder-CUST

SCALE: 1:5 SIZE: A3 SHEET: 9 OF 14

JM60400-2CR

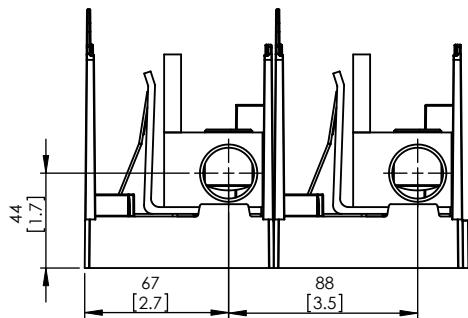
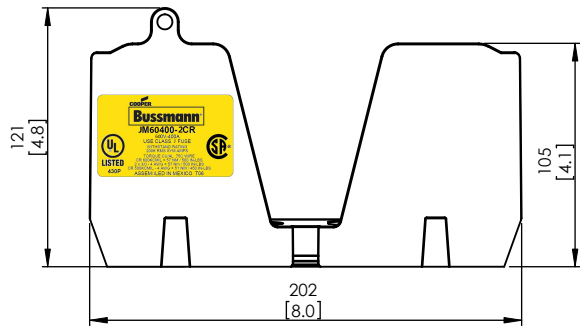
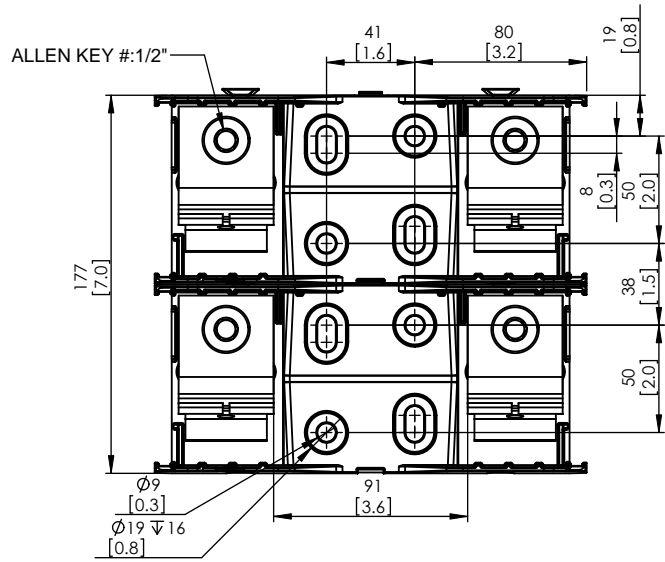

**JM60400-2CR
WITH CVR-J-60400 INSTALLED**

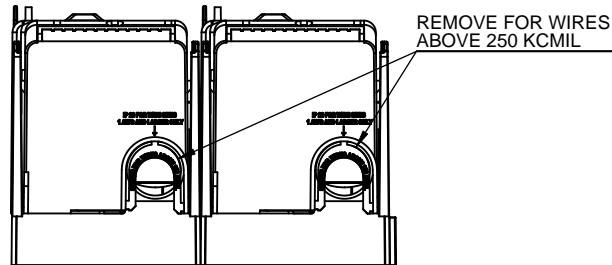
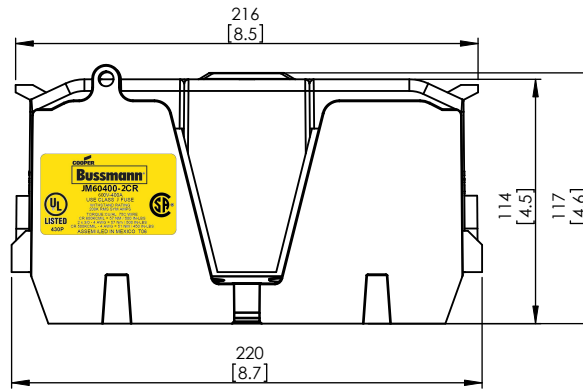
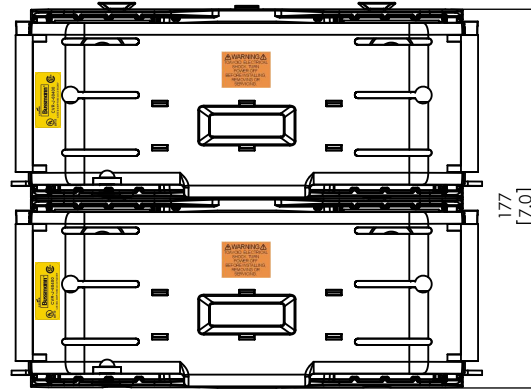

**JM60400-2CR
WITH CVRI-J-60400 INSTALLED**

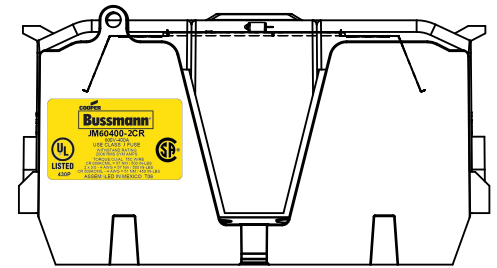
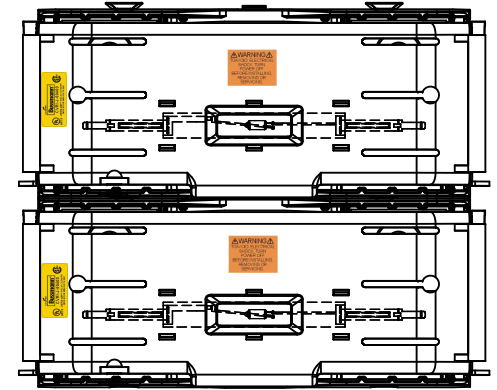

DESIGN UNITS: METRIC (mm)
UNLESS OTHERWISE SPECIFIED
[INCHES]



JM60400-3CR

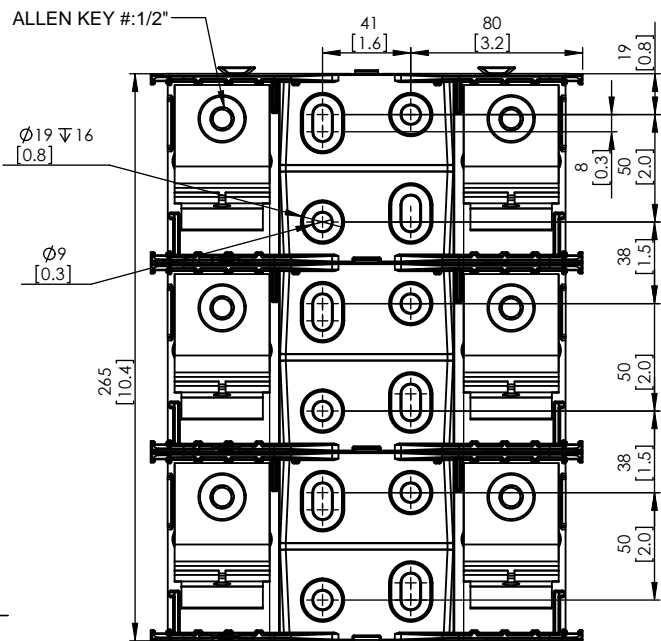

**JM60400-3CR
WITH CVR-J-60400 INSTALLED**

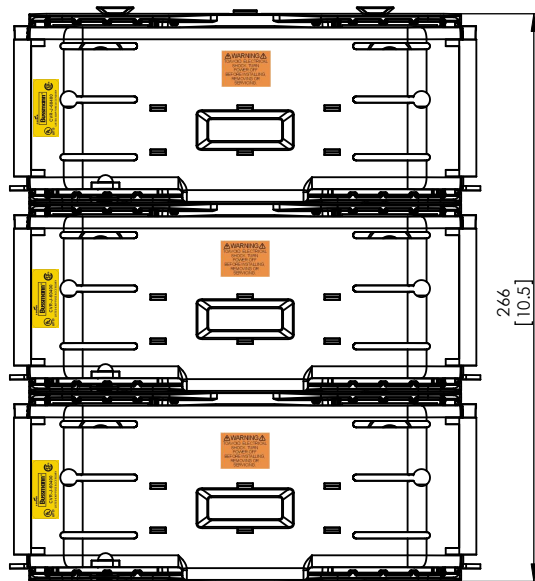

**JM60400-3CR
WITH CVRI-J-60400 INSTALLED**

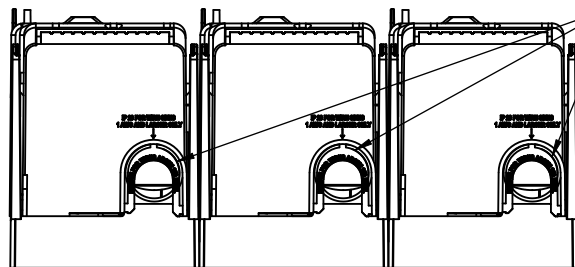
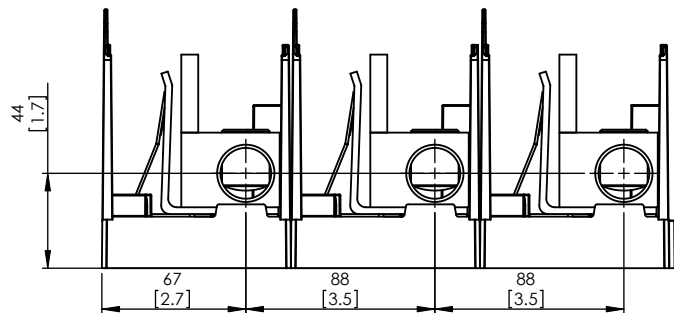
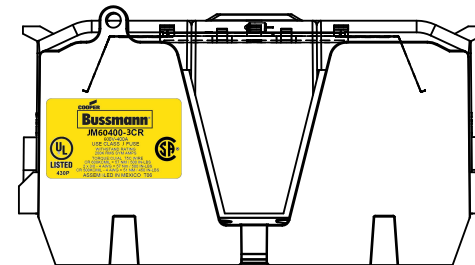
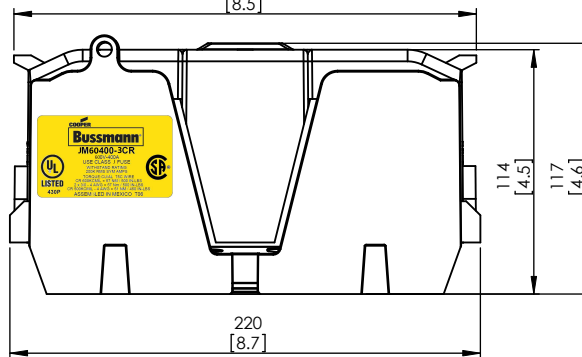
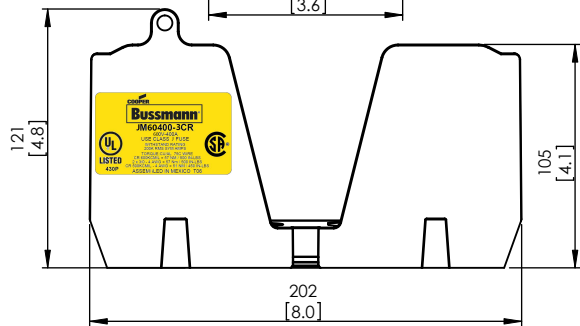
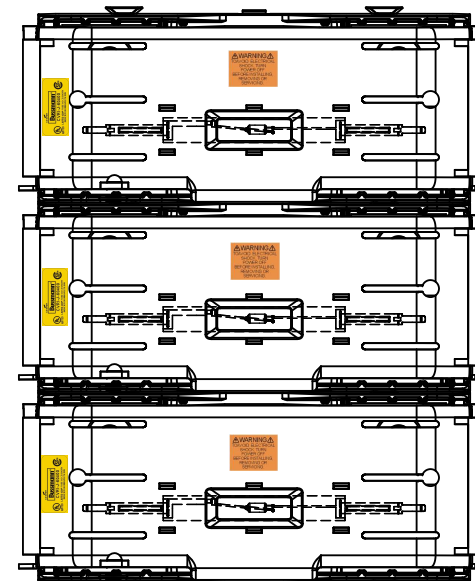

COOPER Bussmann
St. Louis MO 63178

TITLE:
Class J fuse holder-CUST

SCALE: 1:5 SIZE: A3 SHEET: 11 OF 14

JM60600-1CR

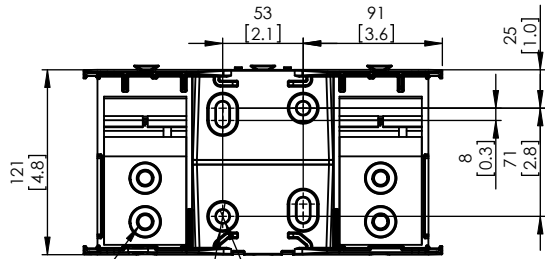

ALLEN KEY #: 3/8" (10.0MM)



JM60600-1CR WITH CVR-J-60600 INSTALLED

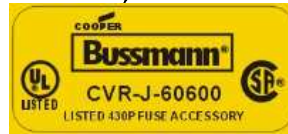
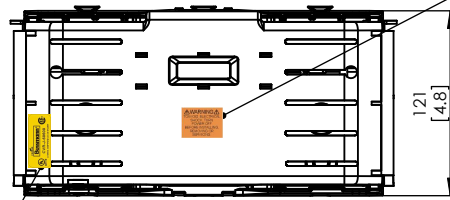

JM60600-1CR WITH CVRI-J-60600 INSTALLED

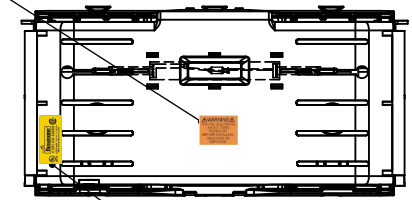

WARNING
 TO AVOID ELECTRICAL SHOCK, TURN POWER OFF BEFORE INSTALLING, REMOVING OR SERVICING.

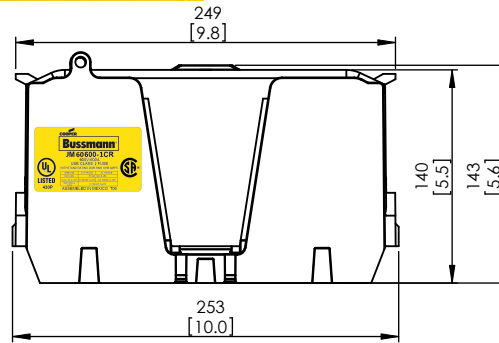
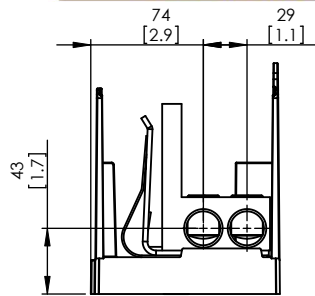
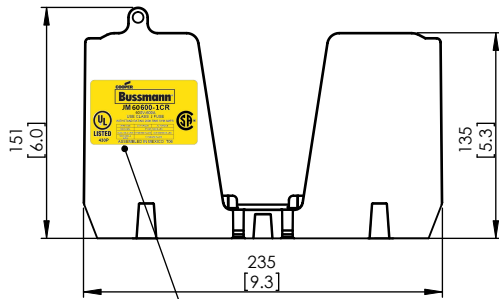

CVR-J-60600

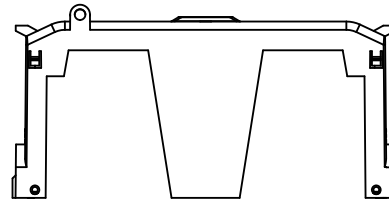

CVRI-J-60600

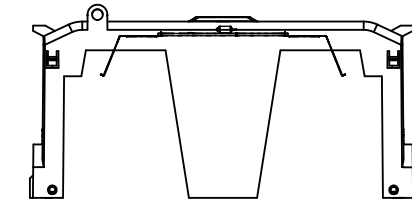

CUT OPEN ALONG THIS DOTTED LINE FOR WIRES ABOVE 250 KCMIL

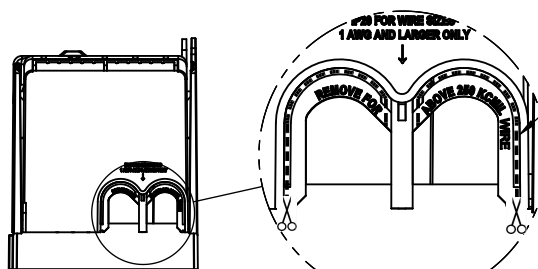

COOPER Bussmann
 St. Louis MO 63178

Class J fuse holder-CUST

SCALE: 1:5 SIZE: A3 SHEET: 12 OF 14

JM60600-2CR

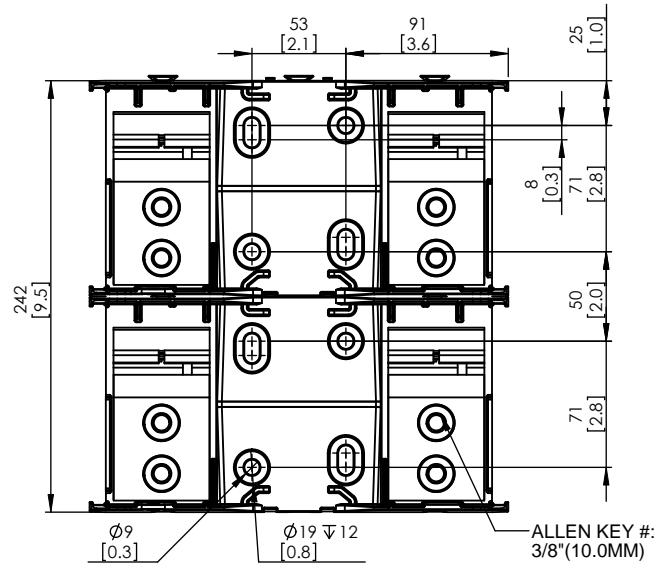

**JM60600-2CR
WITH CVR-J-60600 INSTALLED**

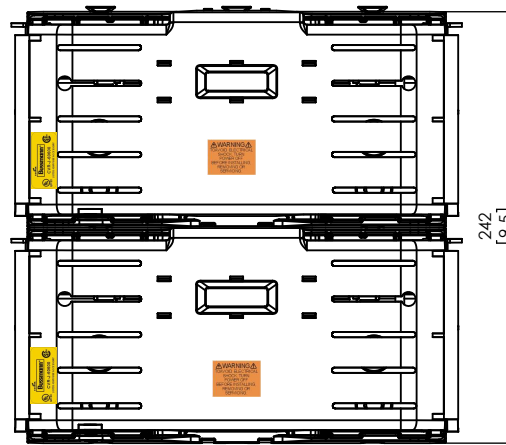

**JM60600-2CR
WITH CVRI-J-60600 INSTALLED**

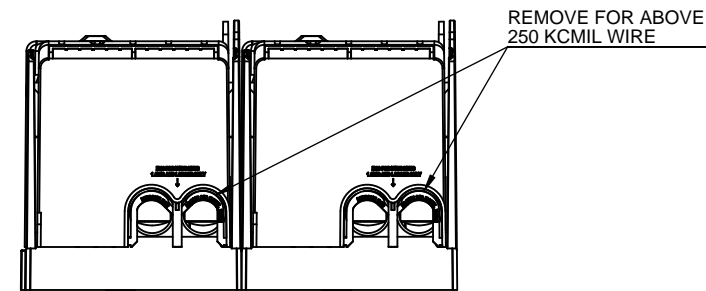
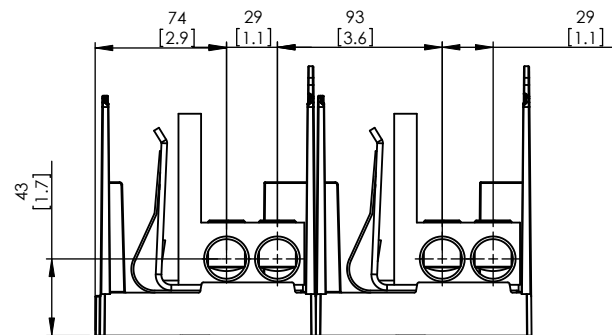
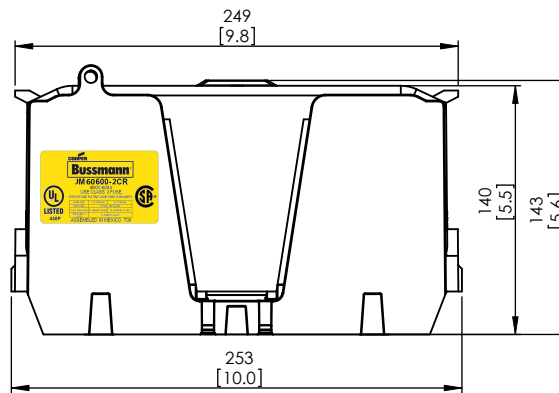
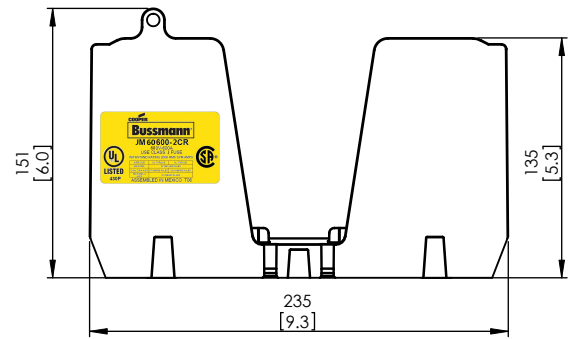
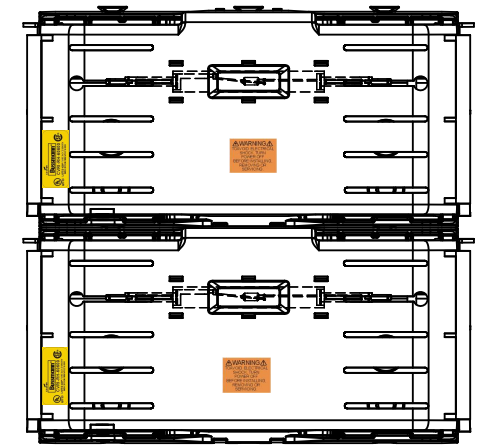

JM60600-3CR

**JM60600-3CR
WITH CVR-J-60600 INSTALLED**

**JM60600-3CR
WITH CVRI-J-60600 INSTALLED**

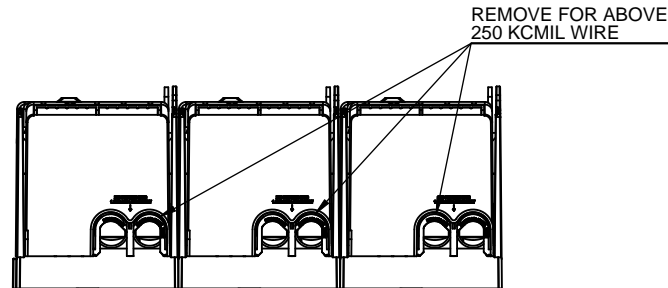
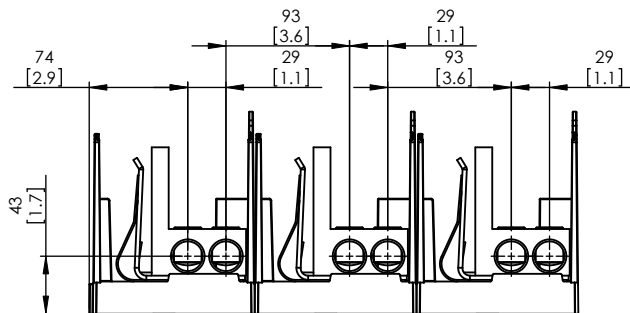
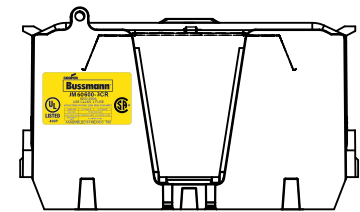
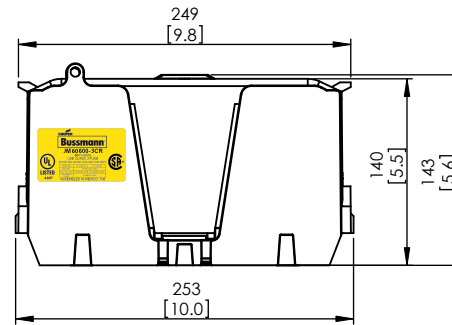
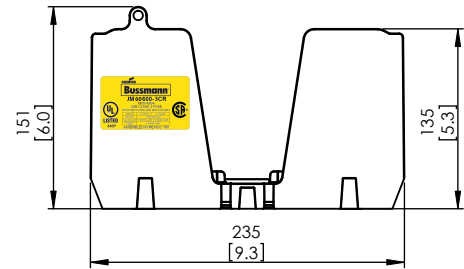
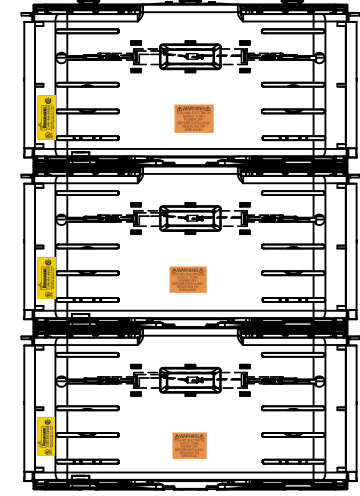
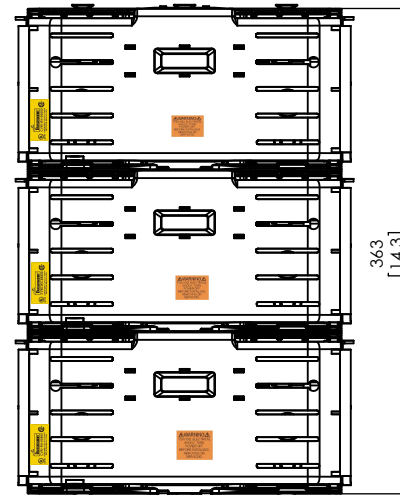
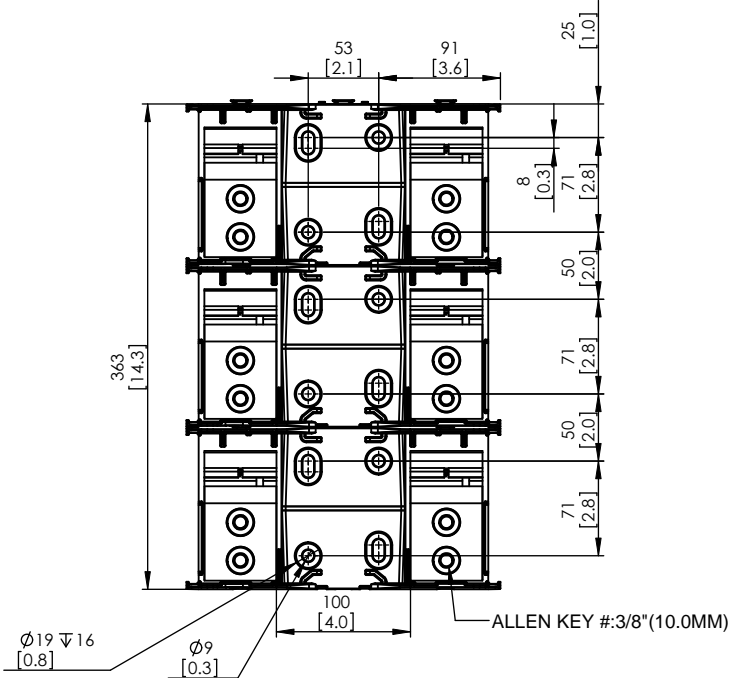

COOPER Bussmann
St. Louis MO 63178

TITLE:
Class J fuse holder-CUST

SCALE: 1:5 SIZE: A3 SHEET: 14 OF 14

www.Bussmann.com

Данный компонент на территории Российской Федерации

Вы можете приобрести в компании MosChip.

Для оперативного оформления запроса Вам необходимо перейти по данной ссылке:

<http://moschip.ru/get-element>

Вы можете разместить у нас заказ для любого Вашего проекта, будь то серийное производство или разработка единичного прибора.

В нашем ассортименте представлены ведущие мировые производители активных и пассивных электронных компонентов.

Нашей специализацией является поставка электронной компонентной базы двойного назначения, продукции таких производителей как XILINX, Intel (ex.ALTERA), Vicor, Microchip, Texas Instruments, Analog Devices, Mini-Circuits, Amphenol, Glenair.

Сотрудничество с глобальными дистрибьюторами электронных компонентов, предоставляет возможность заказывать и получать с международных складов практически любой перечень компонентов в оптимальные для Вас сроки.

На всех этапах разработки и производства наши партнеры могут получить квалифицированную поддержку опытных инженеров.

Система менеджмента качества компании отвечает требованиям в соответствии с ГОСТ Р ИСО 9001, ГОСТ РВ 0015-002 и ЭС РД 009

Офис по работе с юридическими лицами:

105318, г.Москва, ул.Щербаковская д.3, офис 1107, 1118, ДЦ «Щербаковский»

Телефон: +7 495 668-12-70 (многоканальный)

Факс: +7 495 668-12-70 (доб.304)

E-mail: info@moschip.ru

Skype отдела продаж:

moschip.ru

moschip.ru_4

moschip.ru_6

moschip.ru_9